

# Moped Matters

by Centaur

## Improved Panda

THE latest news from the Phillips concern is of an improved version of the Panda known as the Panda Plus (below). The main difference is the addition of telescopic front forks to replace the previous bicycle-type rigid forks. Another new feature is found on the mudguards for both have been deeply valanced. A large headlamp is now fitted and the colour scheme is Winchester Grey and Cherry Red, designed to appeal particularly to teenagers who form an increasingly large part of the modern moped market. The Panda is still available as a standard model single-speeder at 51gns. The Panda Plus costs 54½gns.

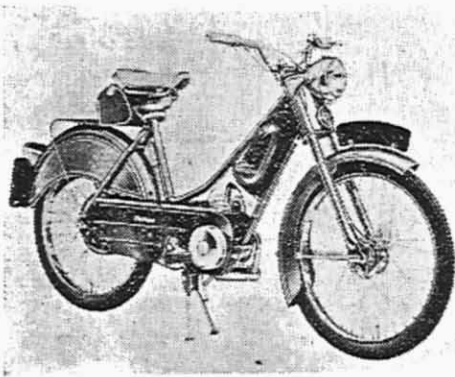

The New Panda

## Saga Suit

MY normal protective clothing on a moped consists of an elaborate motorcycling suit, which at normal retail price costs between £7 and £8. It is effective but it has its disadvantages, the main one being weight and bulk. If the sky threatens and I am forced to take my suit with me it either makes me perspire if I wear it or else creates a bulky package on the carrier. A suit I tested recently was strong enough to afford me full protection in the rain, light enough to make an inconspicuous bundle and also cheap. At 79s. 6d. the Saga Suit, made by Saga Garments Ltd., Whinbank Road, Aycliffe Trading Estate, near Darlington, is the ideal suit for the moped rider. Fully guaranteed it is manufactured from anti-tear, rayon based P.V.C. and is zip fronted with a large overlap.

## Aquamarine

THERE will be no mistaking Shell Mex and B.P. two-stroke oils in future. The company is introducing an identification dye into the two brands and the mixture will be identified by its aquamarine colour visible in the sight glass of the dispenser. This will also be a handy identification if you keep a supply in your garage where oil used on other vehicles is stored.

## LIGHTING-UP TIMES

June	W.	Th.	F.	Sa.	Su.	M.	Tu.
Lights off (a)	8	9	10	11	12	13	14
a.m.	4.14	4.14	4.13	4.13	4.13	4.13	4.12
Lights on (b)							
p.m.	9.44	9.45	9.46	9.46	9.47	9.47	9.48

Lights off (a) and lights on (b) are for London.  
 Corrections as for June 11: Bristol (a) + 10 min.; (b) + 10 min. Birmingham (a) + 1 min.; (b) + 13 min. Manchester (a) - 3 min.; (b) + 21 min. Newcastle (a) - 16 min.; (b) + 28 min. Glasgow (a) - 11 min.; (b) + 45 min. Belfast (a) + 5 min.; (b) + 43 min.

# THE ITOM TORINO POWER-UNIT

An exploded drawing of the 49 c.c. engine fitted to a popular German moped

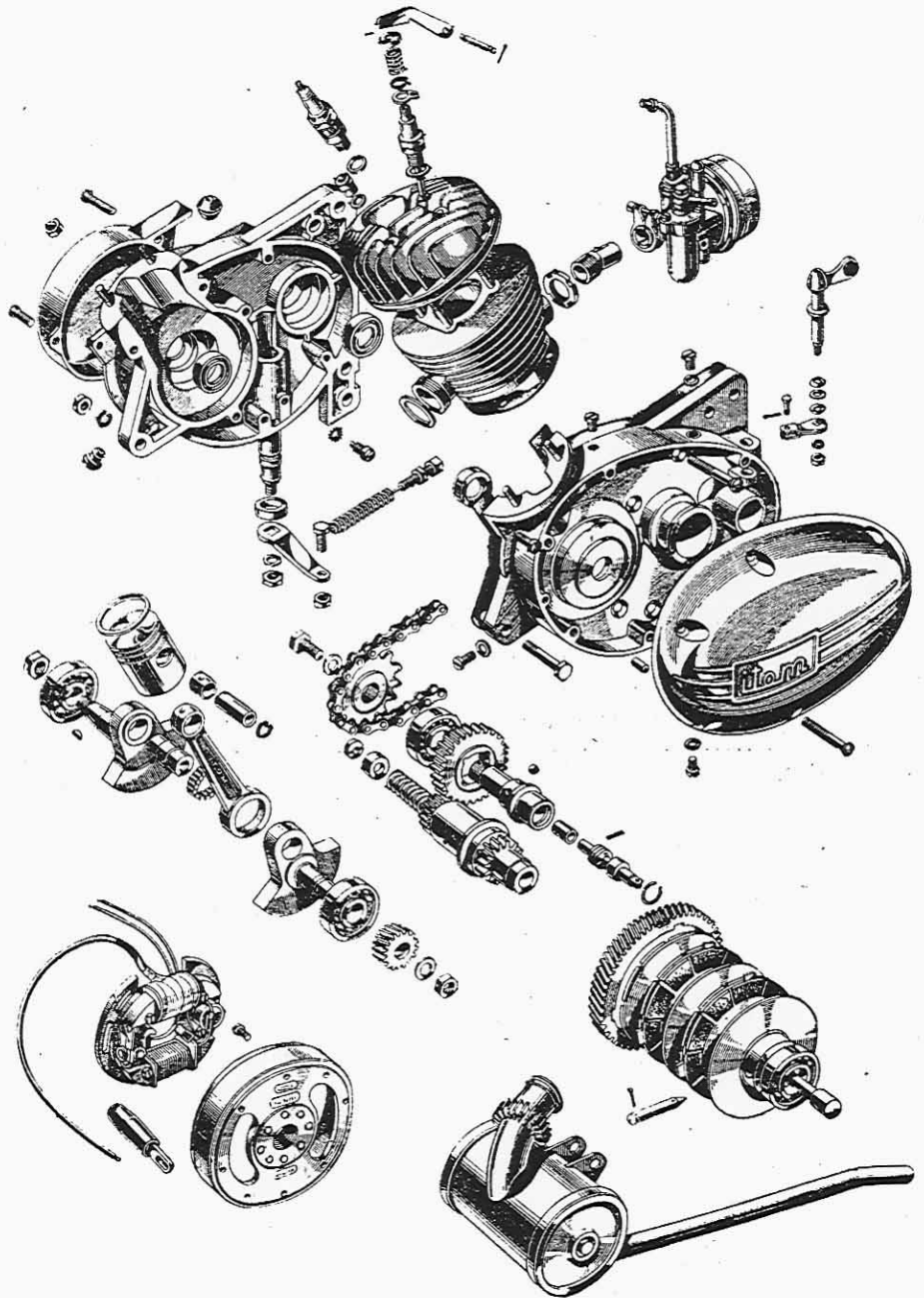

## The Magneclair Magneto

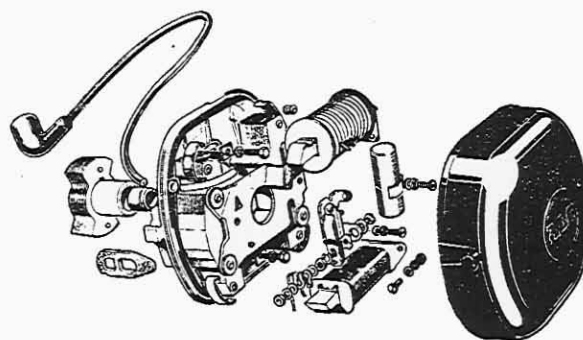

### DO YOU KNOW . . .

. . . that routine maintenance on the bicycle parts of the N.S.U. Quickly should be carried out at the following intervals? Pedal bearings, every 2,500 miles; steering head bearings, every 5,000 miles; chain, every 600 miles; lubrication of handlebar levers, brake, gear and clutch cables, every 1,200 miles.

This and other essential items of information relating to mopeds in general can be obtained from THE CYCLE-MOTOR MANUAL, a Temole Press publication, available price 6s. net, from booksellers, or 6s. 8d. post free direct from these offices.

# IceniCAM Information Service



[www.icenicam.org.uk](http://www.icenicam.org.uk)