

Spare Parts List
FOR
STURMEY-ARCHER
GEAR HUBS, BRAKE HUBS
AND DYNOHUBS

Published by
STURMEY-ARCHER GEARS LTD.
NOTTINGHAM, ENGLAND

FOR TRADE USE ONLY



A Complete Range of Hub Gears, Brakes and Dynohubs

BRAKE HUBS

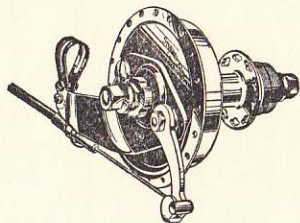

BRC Rear Single Speed Hub with hand-operated internal expanding brake.

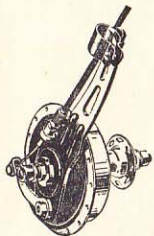

BFC Front Hub, incorporating hand-operated internal expanding brake.

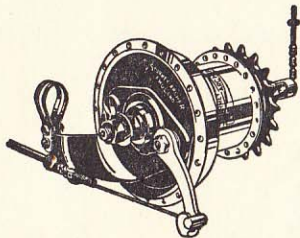

ABC Three-speed Wide Ratio incorporating hand-operated internal expanding brake.

THREE-SPEED

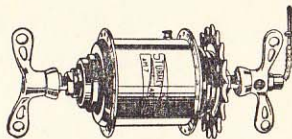

AM Three-speed Medium Ratio, 15.55% increase, 13.46% decrease from Normal. Ideally suitable for Sports machines.

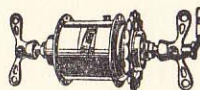

ASC The only three-speed fixed hub manufactured in the world to-day. 10% and 25% decrease from direct drive.

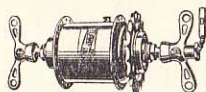

AC Three-speed Ultra Close Ratio; 6.66% increase and 7.7% decrease from Normal.

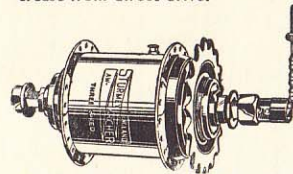

AW Three-speed Wide Ratio 33.33% increase, 25% decrease from Normal. Specially suitable for Roadster machines.

FOUR-SPEED

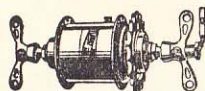

FM Four-speed Medium Ratio, 12.5% increase, 14.3% and 33.33% decrease from Normal. Unquestionably the best all-round Club gear.

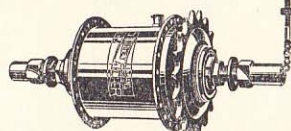

FW Four-speed Wide Ratio. The great advantage of this Hub as against the corresponding three-speed, lies in the fact that there are two Normal gears. Ratios give 26.6% increase and 21% and 33% decrease from Normal. There is no doubt that this is THE hub of the future, as far as Roadster machines are concerned.

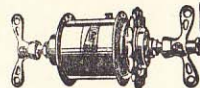

FC Four-speed Close Ratio, 9.1% increase, 10% and 25% decrease from Normal. Specially designed for Massed Start Races.

Patent "Flick" Trigger Control. The Sturmey-Archer Patent "Flick" Trigger Control provides an instantaneous change of gear by the flick of a finger.



AM, ASC, AC, FM, FC. These hubs have the following exclusive refinements: **ALLOY SHELL**—one-third the weight of steel. **SPLINED SPROCKET**—which enables you to alter gear range easily and quickly. **WING NUTS, QUICK RELEASE FITTINGS.**

DYNOHUBS

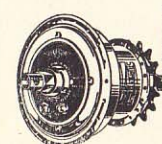

AG AW Wide Ratio Three-speed combined patent 6-volt Dynohub.

FG FW Wide Ratio Four-speed combined patent 6-volt Dynohub. By combining the gear and Dynohub in one unit, a great saving in weight is made.

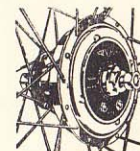

GH6 Patent 6-volt Dynohub. Like all our Dynohubs, it is mechanically frictionless.

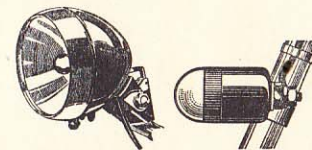

HEADLAMP AND REAR LAMP The headlamp is fully enclosed and of pleasing shape. It is supplied in either Black or Silver finish. The Rear Light is unique in its simplicity and appearance.

DRY BATTERY UNIT

This is available with any of the Dynohubs illustrated above. It provides, with the aid of three batteries, a light when stationary.



STURMEY-ARCHER

The Original and Best

AW. Wide-Ratio 3-SPEED HUB

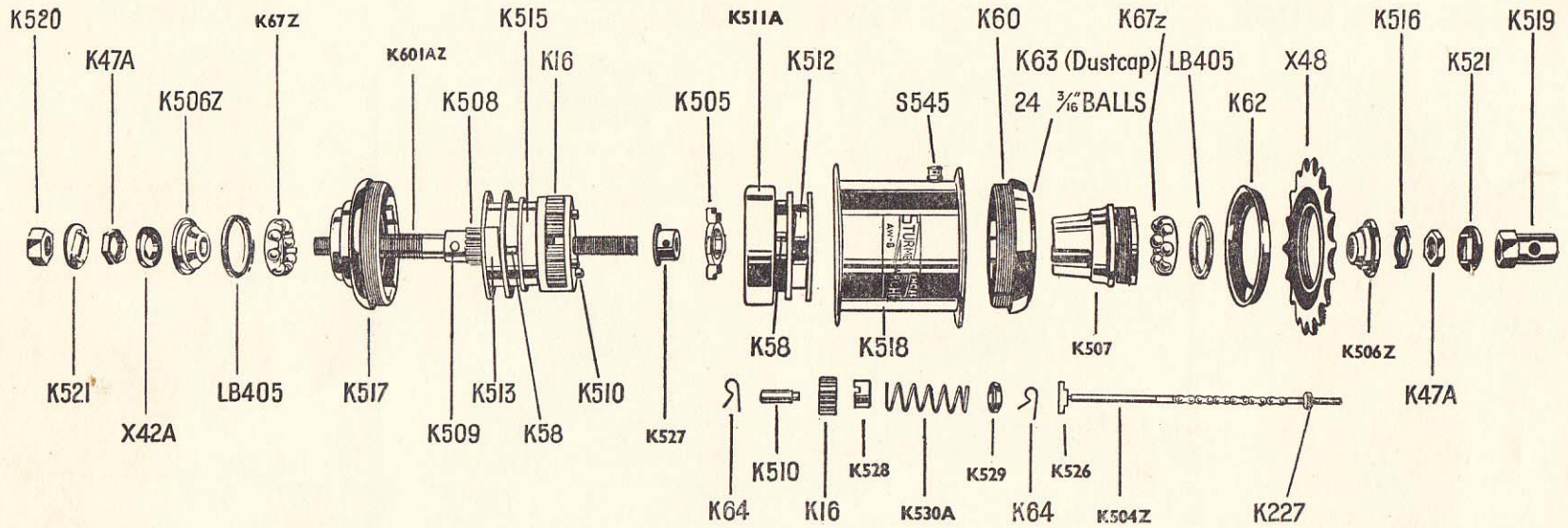

FW. Wide-Ratio 4-SPEED HUB

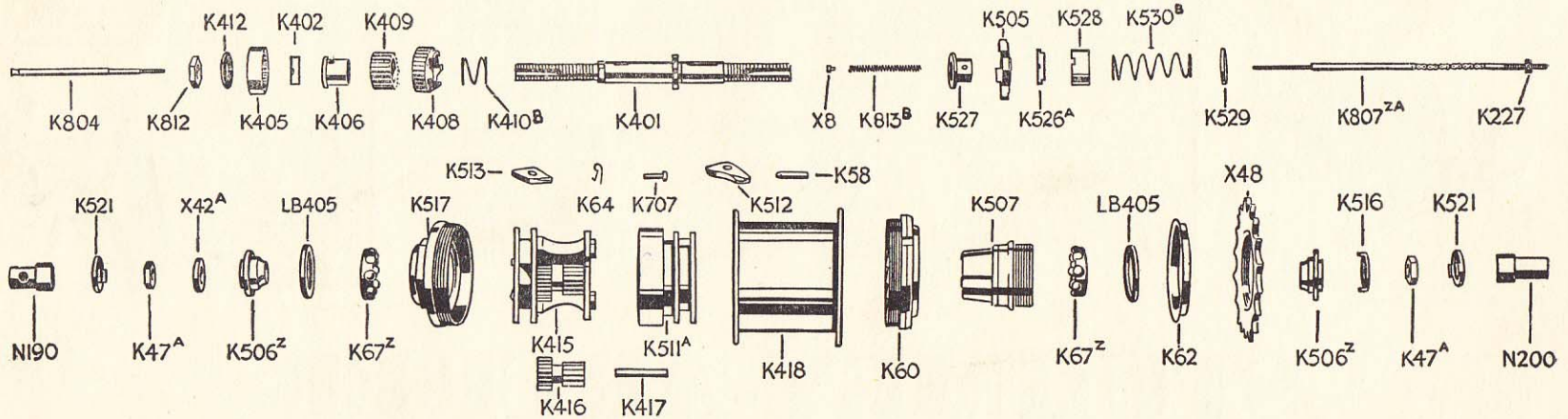

AM. Medium-Ratio 3-SPEED HUB

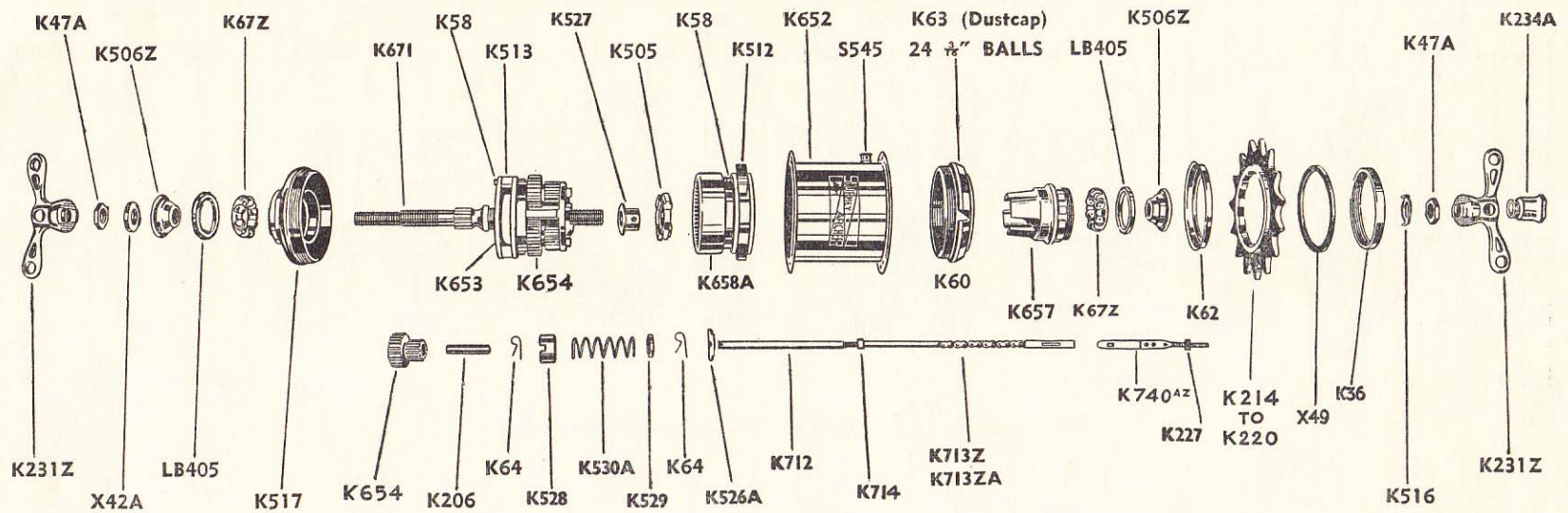

FM. Medium-Ratio and FC. Close-Ratio 4-SPEED HUBS

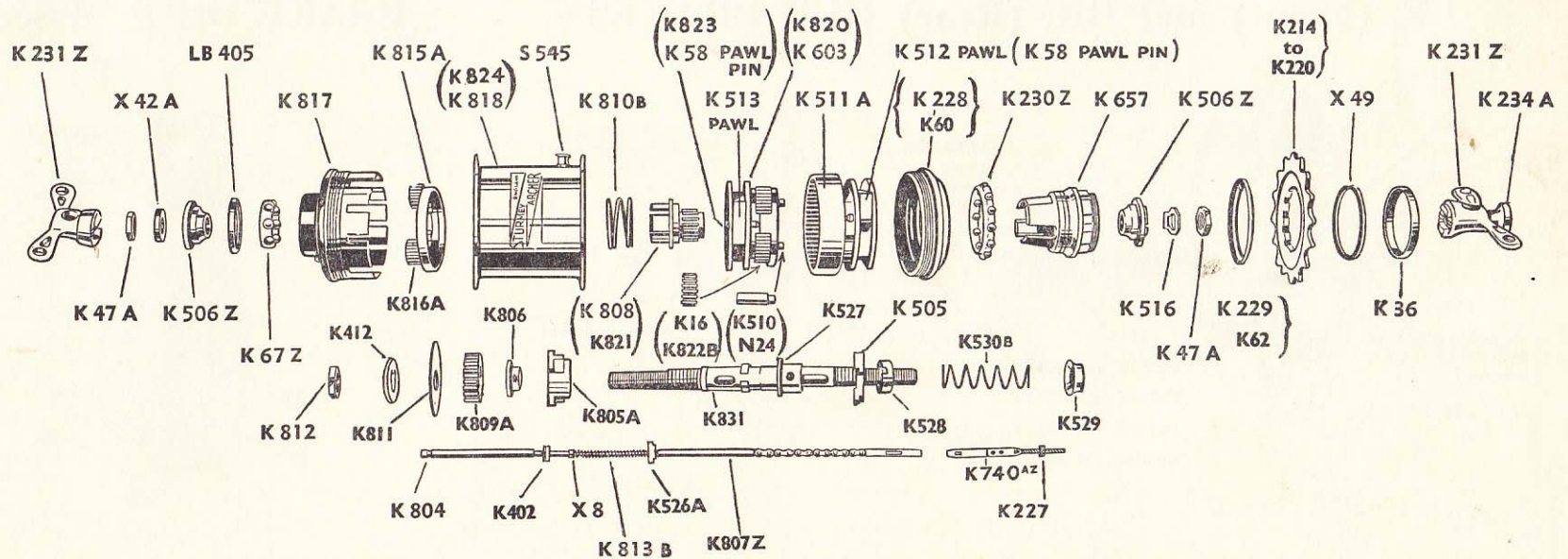

AB. Wide-Ratio 3-SPEED with HUB BRAKE

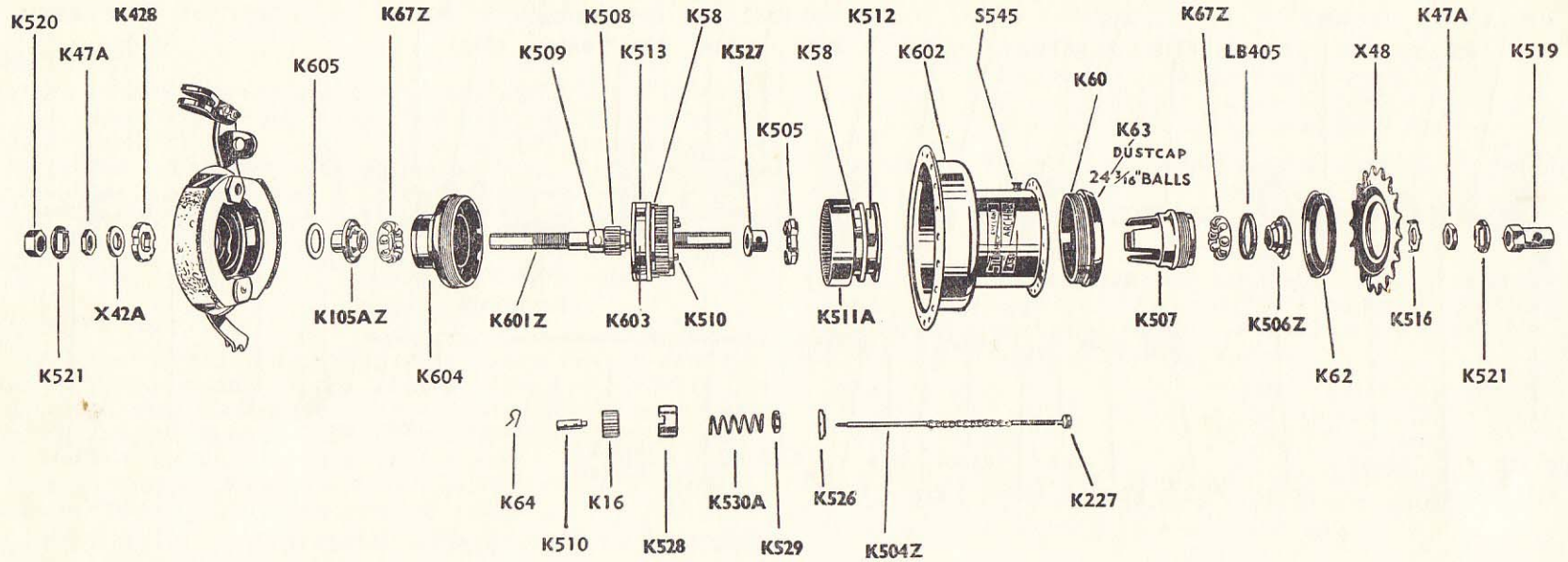

BF. (Front) and BR. (Rear) HUB BRAKES

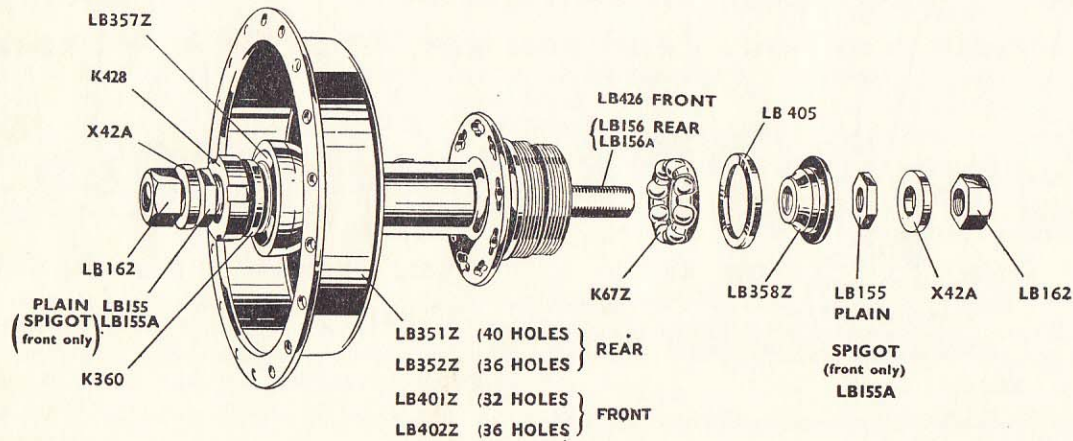

BRAKE SHOE Assembly

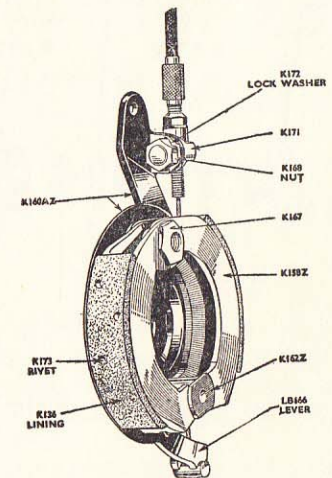

Front BRAKE Parts

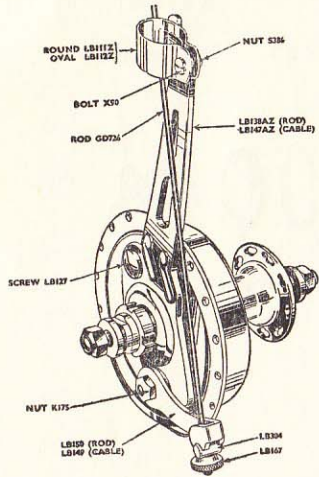

Rod-Operated BRAKE CONTROLS

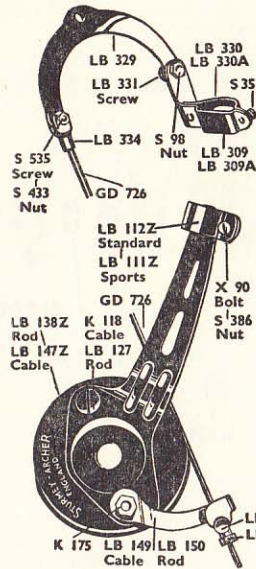

Clip on Pattern
LB 326AZ LH
LB 326BZ RH
LB 327A Clip
LB 332 Bolt
S 443 Nut

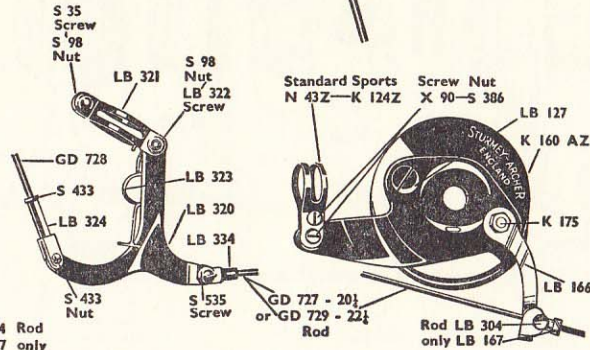
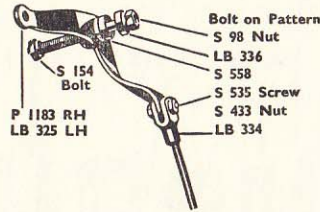

Top Tube GEAR CONTROL

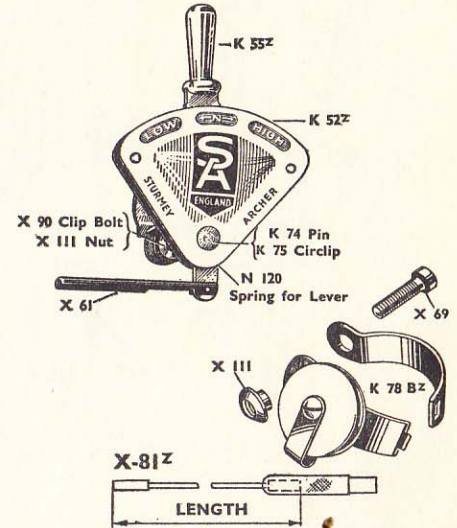

Cable-Operated BRAKE CONTROLS

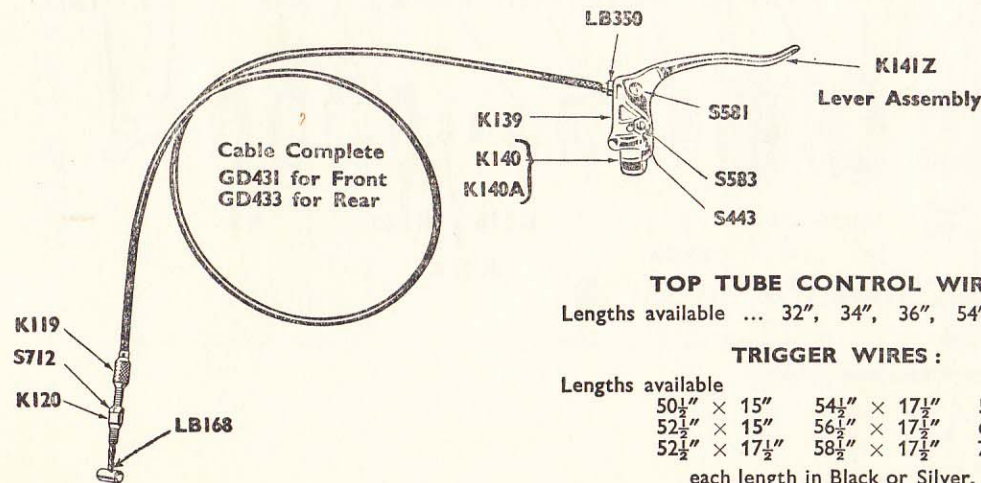

TOP TUBE CONTROL WIRES :

Lengths available ... 32", 34", 36", 54", 58", 78"

TRIGGER WIRES :

Lengths available

50 1/2" × 15"	54 1/2" × 17 1/2"	58 1/2" × 21 1/2"
52 1/2" × 15"	56 1/2" × 17 1/2"	60 1/2" × 17 1/2"
52 1/2" × 17 1/2"	58 1/2" × 17 1/2"	74 1/2" × 21 1/2"

each length in Black or Silver.

TRIGGER GEAR CONTROLS

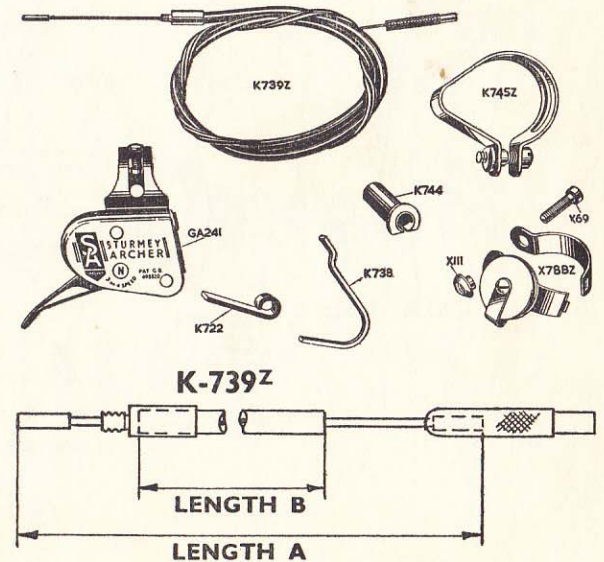

ASC. Close-Ratio 3-SPEED FIXED GEAR HUB

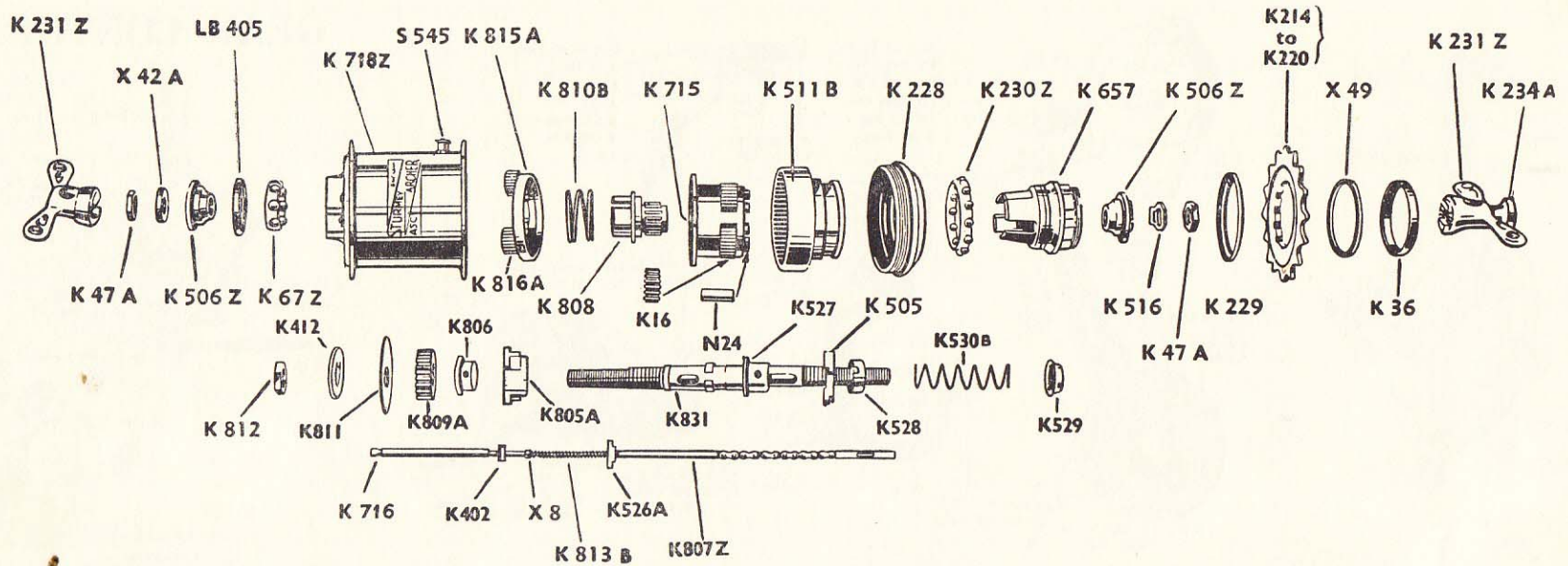

AC. Ultra-Close-Ratio 3-SPEED HUB

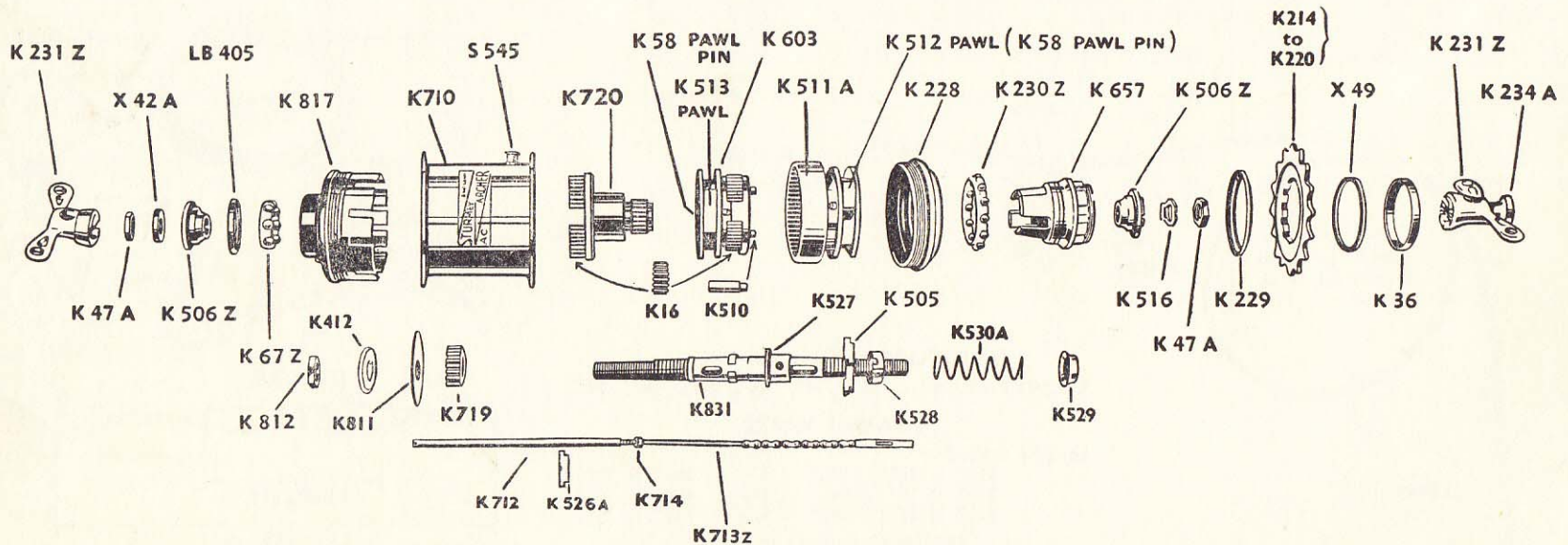

AG. Wide-Ratio 3-SPEED DYNOHUB

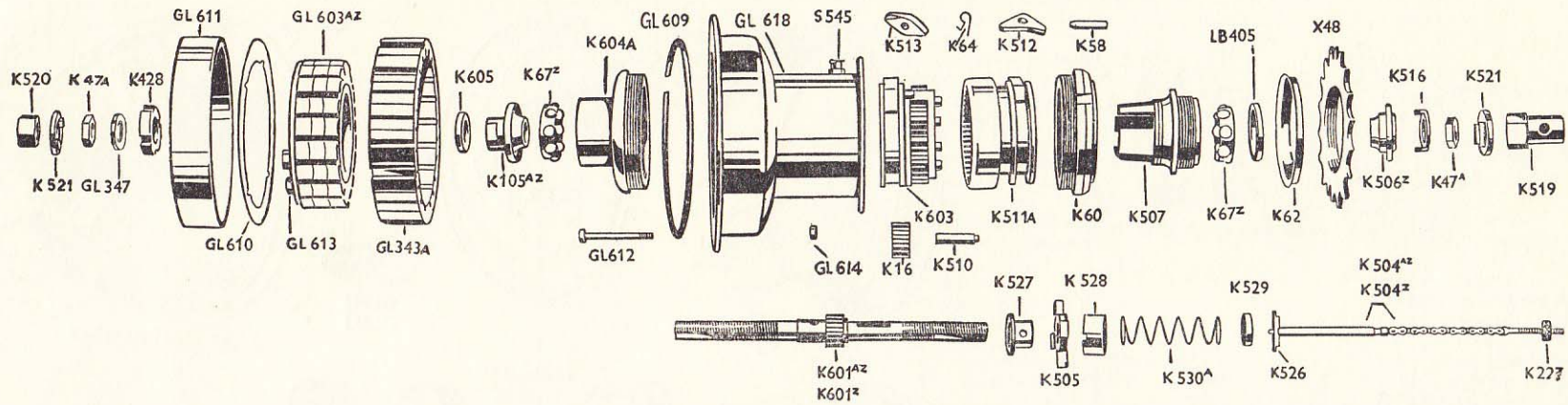

DBU. DRY BATTERY UNIT

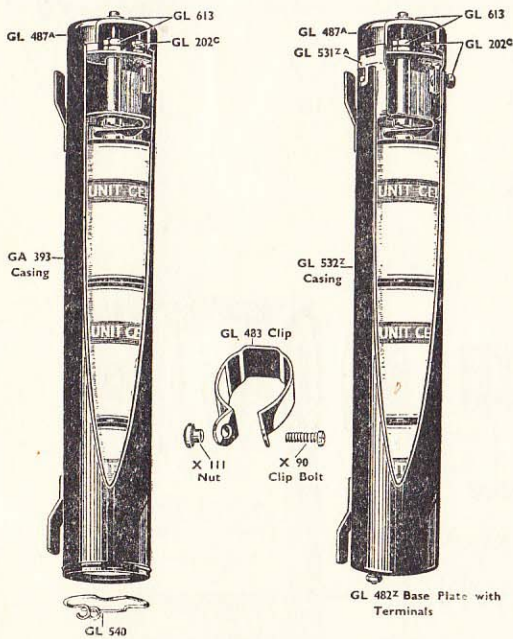

FLEX WIRE Details

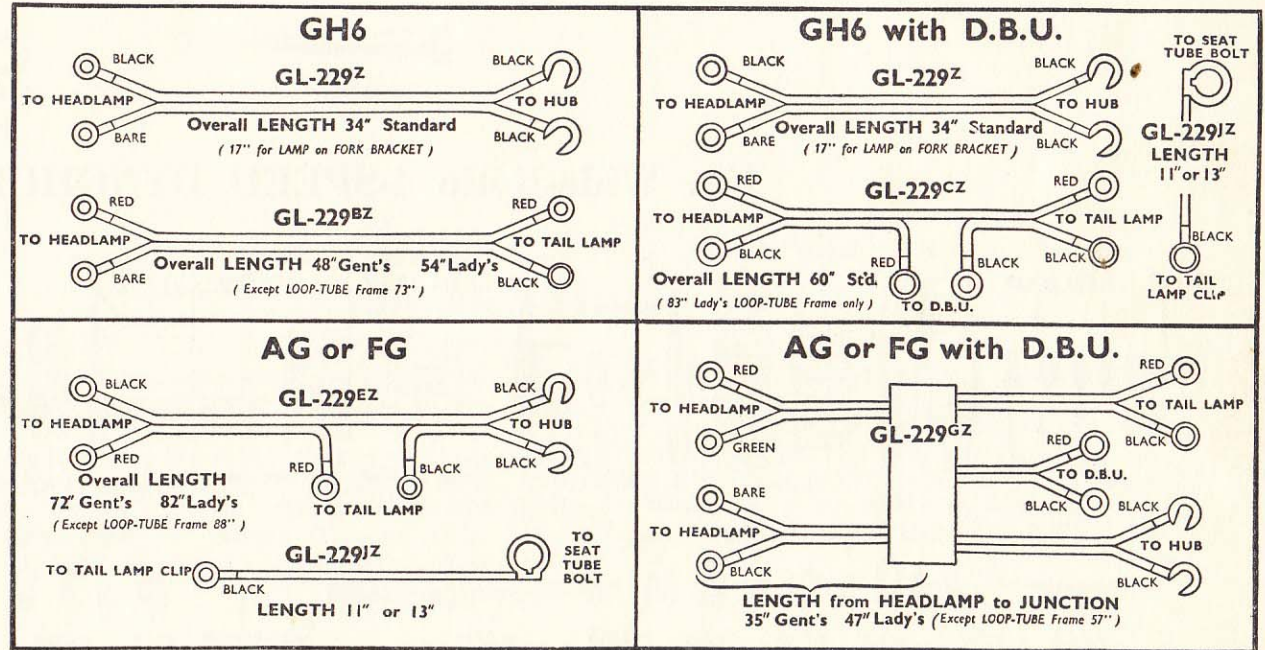

GH6. Front DYNOHUB

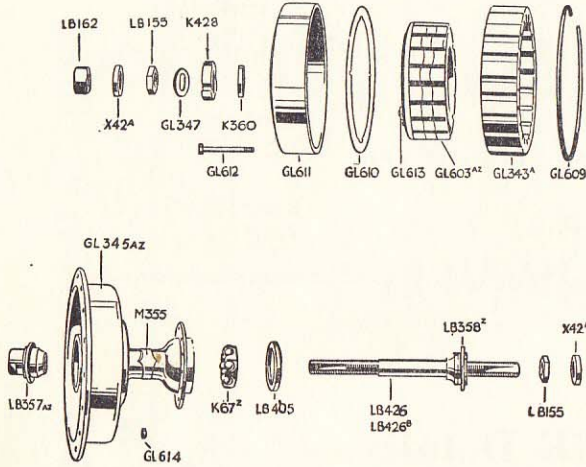

HEADLAMP and TAIL LAMP

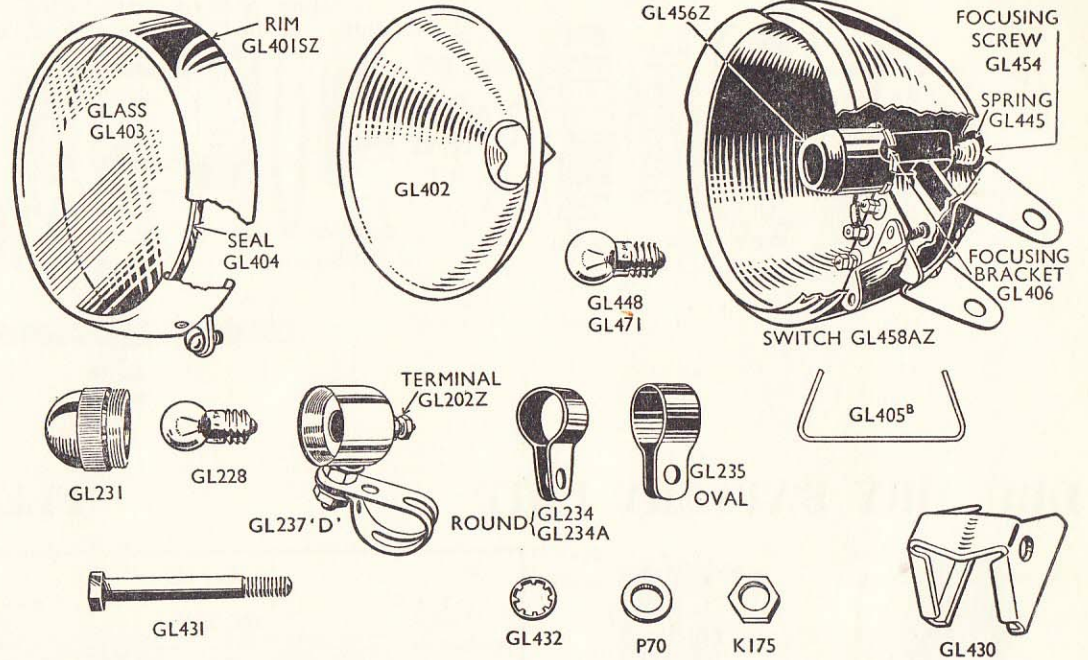

FG. Wide-Ratio 4-SPEED DYNOHUB

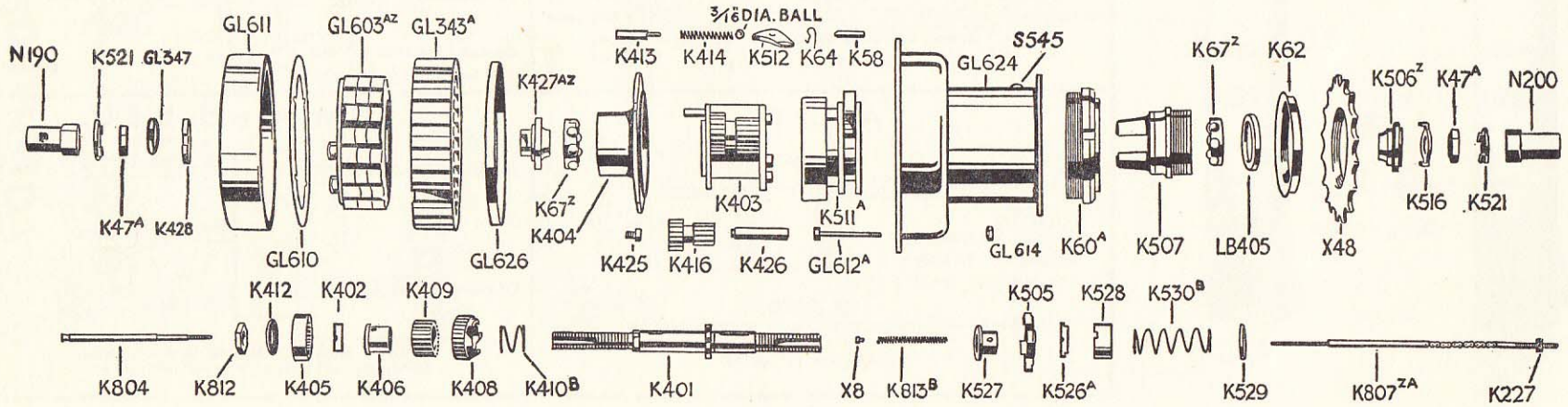

TOOLS

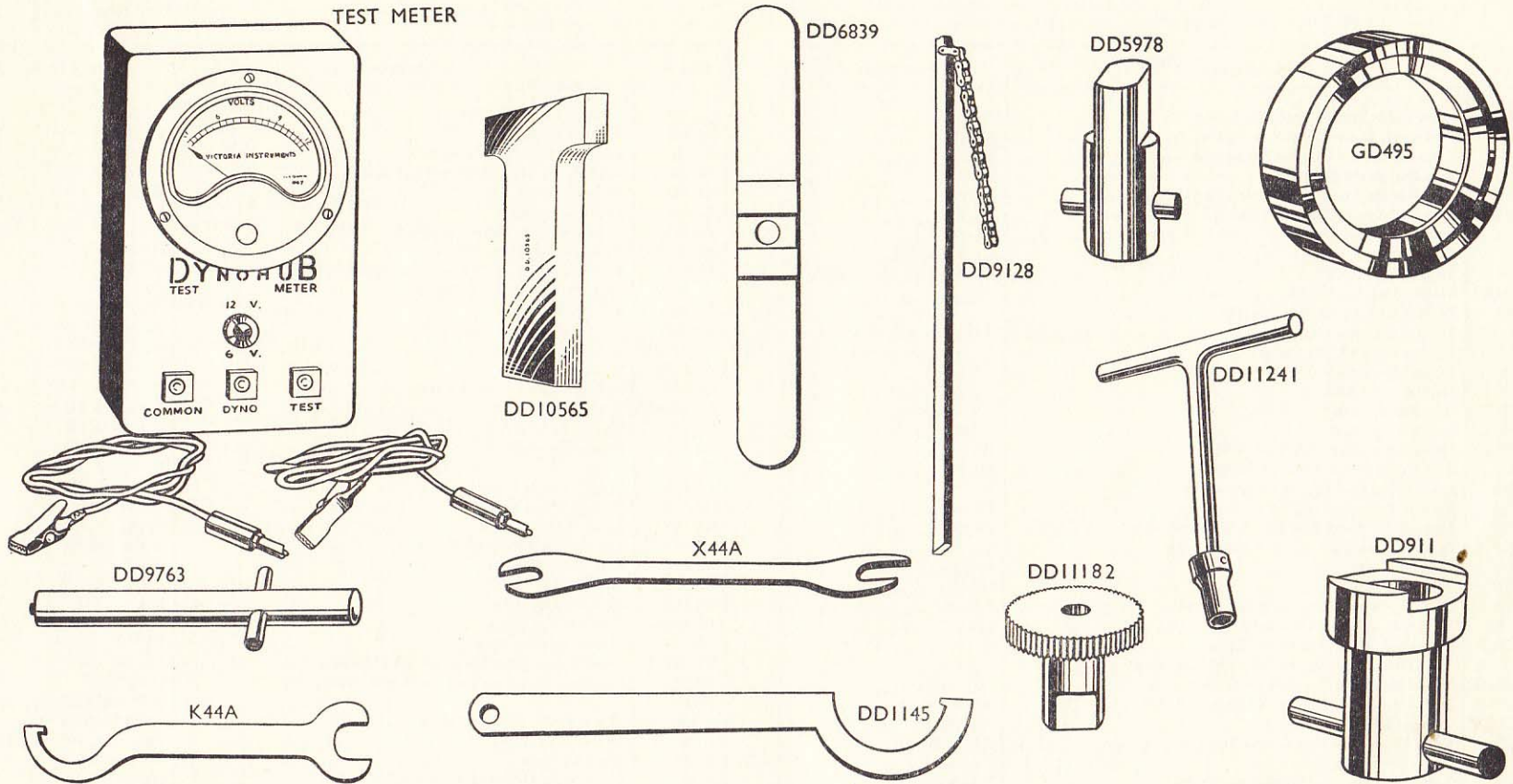

DYNOHUB

DD9763	Universal Test Meter
DD6839	Tube Spanner (6 B.A.)
GD495	Spanner for tightening fixed cone...
DD11241	Keeper Ring
	Box Spanner for Ball Cup Fixing Screws, FG

3- & 4-SPEED GEARS

DD9128	Sprocket Chain Wrench
K44A	Spanner for Axle Nuts and Brake Cone Adjuster
X44A	Spanner for Axle Nuts and Plain Cones
DD911	Tool for removing Left-Hand Ball Cup (3-speed)
DD10565	Tool for removing Left-Hand Ball Cup (3-speed) slotted type...
DD1182	Tool for removing Left-Hand Ball Cup (4-speed) (originally GD514)
DD5978	Tool for Sprocket removal (4 prong driver)
DD1145	"C" Spanner for Right-Hand Ball Ring

STURMEY-ARCHER SPARES LIST

In Alphabetical and Numerical order, with reference to description and illustration in Spare Parts List

Part No.	Description	Hub Types
BC 1F	Front Cable Brake Control complete	BF
BC 1R	Rear Cable Brake Control complete	BR, AB
BC 2	Front Rod Brake Control Fittings	BF
BC 3BR	Rear Rod Brake Control - Bolt-on R H operation	BR, AB
BC 3BL	Rear Rod Brake Control - Bolt-on L H operation	BR, AB
BC 3CR	Rear Rod Brake Control - Clip-on R H operation	BR, AB
BC 3CL	Rear Rod Brake Control - Clip-on L H operation	BR, AB
DU 96	Cable Fixing Band	GH 6, AG, FG
GA 241	Trigger Unit for GC 2	All gear hubs except ASC
GA 241A	Trigger Unit for GC 2A	ASC
GA 393	Battery Casing complete less clips	
GC 1	T T Control complete	AW, AB, AC, AM, AG
GC 2	Trigger Control, less Pulley	All gear hubs except ASC
GC 2A	Trigger Control, less Pulley	ASC
GD 331Z	Front Brake Cable	K pattern only
GD 332Z	Rear Brake Cable	K pattern only
GD 333Z	Lady's Rear Cable	K pattern only
GD 431	Front Brake Cable (Black or Silver)	BF
GD 433	Rear Brake Cable (Black or Silver)	BR, AB
GD 726	Front Brake Rod 16½" & 1 Connection	BF
GD 727	Bottom Brake Rod 20¼" & 1 Connection	BR, AB
GD 728	Down Tube Brake Rod 20¼" & 2 Connections	BR, AB
GD 729	Bottom Brake Rod 22" & 1 Connection	BR, AB
GL 202C	Terminal Nut	H/Lamp T/Lamp
GL 202Z	Terminal complete	H/Lamp T/Lamp
GL 228	Bulb 6v. .04 amp. (Purchase Tax extra)	T/Lamp
GL 229Z	Twin Flex. Hub to Headlamp	GH 6
GL 229BZ	Twin Flex. Headlamp to Tail Lamp	GH 6
GL 229CZ	Twin Flex. Headlamp to DBU and Tail Lamp	GH 6
GL 229DZ	Twin Flex. Rear Dynohub to Battery Unit	FG
GL 229EZ	Twin Flex. Headlamp to Tail Lamp and Hub	AG or FG
GL 229GZ	Wiring Assembly for DBU	AG, FG
GL 229JZ	Earth Wire Tail Lamp Clip to Seat Lug	GH 6, AG, FG
GL 231	Dome for Tail Lamp	T/Lamp
GL 234	Tail Lamp Clip for ⅝" diam. round tube	T/Lamp
GL 234A	" " " for ⅜" diam. round tube	T/Lamp
GL 235	" " " for oval tube	T/Lamp
GL 237	" " " for "D" shaped tube	T/Lamp
GL 316	Nut for Magnet Fixing Screw etc. (Replaced by GL 614)	GH 6, AG, FG
GL 328A	Wire Tag 2 B.A.	GH 6, AG, FG
GL 329	Wire Tag 6 B.A. for Headlamp etc.	GH 6, AG, FG
GL 333	Spring Washer for GL 316 (Not used on Latest Dynohubs)	H/L, T/L, DBU
GL 343A	Magnet (Magnetized with Keeper Ring)	GH 6, AG, FG
GL 345Z	Steel Shell 32 Holes	GH 6
GL 345AZ	Steel Shell 36 Holes	GH 6
GL 401SZ	Lamp Rim with Screw	H/Lamp
GL 402	Reflector	H/Lamp
GL 403	Lamp Glass	H/Lamp
GL 404	Seal for Lamp Glass	H/Lamp
GL 405B	Reflector Securing Spring	H/Lamp
GL 406	Focusing Bracket	H/Lamp

Part No.	Description	Hub Types
GL 430	Lamp Bracket Adaptor	H/Lamp
GL 431	Bracket Fixing Bolt	H/Lamp
GL 432	Spring Washer for Fixing Bolt	H/Lamp
GL 448	Bulb 6v. .25 amp. (Purchase Tax extra)	AG or FG
GL 454	Focusing Screw	H/Lamp
GL 455	Focusing Spring	H/Lamp
GL 456Z	Headlamp Bulb Holder complete	H/Lamp
GL 458AZ	Switch Assembly complete	H/Lamp
GL 471	Headlamp Bulb 6v. .3 amp. (Purchase Tax extra)	GH 6
GL 482Z	Base Plate for Battery Casing	DBU
GL 483	Casing Fixing Clip	DBU
GL 487	Cover for Battery Cap	DBU
GL 531ZA	Battery Cap Assembly	DBU
GL 532Z	Battery Case only	DBU
GL 540	Spring Ring for Battery Casing	DBU
GL 603AZ	Armature complete	GH 6, AG, FG
GL 609	Magnet Spacing Disc	GH 6, AG, FG
GL 610	Patent Number Disc	GH 6, AG, FG
GL 611	Cover Plate	GH 6, AG, FG
GL 612	Magnet Fixing Screw	GH 6
GL 612A	Magnet Fixing Screw	AG, FG
GL 613	2 B.A. Terminal Nut	GH 6, AG, FG
GL 614	Nut for Magnet Fixing Screw	GH 6, AG, FG
GL 618	Hub Shell 40 Holes	AG
GL 618A	Hub Shell 36 Holes	AG
GL 624	Hub Shell 40 Holes	FG
GL 624A	Hub Shell 36 Holes	FG
GL 626	Magnet Spacing Ring	FG
HF 625	Headlamp complete with 6v. .25 amp. Bulb	AG, FG
HF 63	Headlamp complete with 6v. .3 amp. Bulb	GH 6
K 16	Planet Pinion	AW, AB, ASC, AC, AG, FC
K 16A	Planet Pinion (NCCB Steel)	AW (Tandem)
K 36	Sprocket Lockring	AM, ASC, AC, FM, FC
K 47A	Cone Locknut	All gear hubs
K 48	Lip Washer (Alternative to K 521)	All gear hubs
K 52Z	Top Tube Quadrant 1"	AW, AB, AC, AM, AG
K 52AZ	Top Tube Quadrant ⅞"	All 3-speeds except ASC
K 52BZ	Top Tube Quadrant 1¼"	All 3-speeds except ASC
K 55Z	Top Tube Quadrant Lever	All 3-speeds except ASC
K 58	Pawl Pin	All gear hubs except ASC
K 60	RH Ball Ring. See also K 228	AW, AB, AM, AG, FW, FM, FC
K 60A	RH Ball Ring	FG
K 62	RH Outer Dust Cap. See also K 229	AW, AB, AM, AG, FW, FM
K 63	RH Inner Dust Cap	AW, AB, AM, AG, FW, FM
K 64	Pawl Spring	All gear hubs except ASC
K 67Z	Ball Retainer	All hubs
K 74	Quadrant Stud	3-speed top tube control
K 75	Circlip	3-speed top tube control
K 105AZ	LH Cone	AB or AG
K 118	Brake Wire Guide for Front Hub	BF
K 119	Wire Stop Screw	BF, BR, AB

Part No.	Description	Hub Types
K 120	Cable Adjuster Nut	BF, BR, AB
K 124Z	Brake Arm Clip complete	BF, BR, AB
K 136	Brake Lining and Rivets	BF, BR, AB
K 138A	Ferrule for Brake Cable	BF, BR, AB
K 139	Brake Lever Fulcrum (Cable)	BF, BR, AB
K 140	Fulcrum Clip for $\frac{7}{8}$ " Bar (Cable)	BF, BR, AB
K 140A	Fulcrum Clip for 1" Bar (Cable)	BF, BR, AB
K 141Z	Cable Brake Lever complete	BF, BR, AB
K 158Z	Brake Shoes complete to 1951. See also K 458Z	BF, BR, AB
K 159	Brake Shoe and Cap to 1951	BF, BR, AB
K 160AZ	Rear Steel Brake Arm to 1951. See also K 460AZ	BR, AB
K 162/114	Brake Shoe Cam with Washer to 1951. See also K 452	BF, BR, AB
K 166	Brake Shoe Spring	BF, BR, AB
K 167	Fulcrum Sleeve to 1951. See also K 456	BF, BR, AB
K 168	Wire Guide Nuts	BR, AB
K 171	Wire Guide for Rear Hub	BR, AB
K 172	Locking Washer	BR, AB
K 175	Nut for Cam Lever or H/Lamp Bracket... ..	BF, BR, AB, H/Lamp
K 206	Pinion Pin	AM
K 214	Sprocket 14T 12 splines	AC, ASC, AM, FM, FC
K 215	Sprocket 15T 12 splines	AC, ASC, AM, FM, FC
K 216	Sprocket 16T 12 splines	AC, ASC, AM, FM, FC
K 217	Sprocket 17T 12 splines	AC, ASC, AM, FM, FC
K 218	Sprocket 18T 12 splines	AC, ASC, AM, FM, FC
K 219	Sprocket 19T 12 splines	AC, ASC, AM, FM, FC
K 220	Sprocket 20T 12 splines	AC, ASC, AM, FM, FC
K 227	Locknut	All gear hubs
K 228	RH Ball Ring	AC, ASC, AM, FM, FC
K 229	RH Dust Cap	AC, ASC, AM, FM, FC
K 230Z	Ball Retainer	AC, ASC, AM, FM, FC
K 231Z	Wingnuts	AC, ASC, AM, FM, FC
K 234A	Chain Guide for RH Wingnut	AC, ASC, AM, FM, FC
K 360	Packing Washer	BF, BR
K 401	Axle $5\frac{3}{4}$ " long	FW, FG
K 401A	Axle $6\frac{1}{2}$ " long	FW, FG
K 402	Low Gear Key	FW, FM, FC, FG, ASC
K 403	Planet Cage	FG
K 404	Ball Cup	FG
K 405	Dog Ring	FW, FG
K 406	Pinion Sleeve	FW, FG
K 408	Primary Sun Pinion	FW, FG
K 409	Secondary Sun Pinion	FW, FG
K 410B	Low Gear Spring (with K 530B and K 813B)	FW, FG
K 411	Washer for Dog Ring (up to 1949). See also K 528A	FW, FG
K 412	Tab Washer	AC, ASC, FW, FM, FC, FG
K 413	LH Pawl	FG
K 414	Pawl Spring	FG
K 415	Planet Cage	FW
K 416	Double Planet Pinion	FW or FG
K 417	Pinion Pin	FW
K 418	Shell 40 Holes	FW
K 418A	Shell 36 Holes	FW
K 425	Fixing Screw	FG
K 426	Pinion Pin	FG
K 427AZ	LH Cone	FG
K 428	Washer	AB, BF, BR, AG, FG, GH 6

Part No.	Description	Hub Types
K 452	Brake Operating Cam. See also K 162	AB, BF, BR
K 456	Fulcrum Sleeve (For brake shoes). See also K 167	AB, BF, BR
K 458AZ	Brake Shoe Assembly. See also K 158Z	AB, BF, BR
K 460AZ	Rear Brake Arm complete. See also K 160AZ	AB, BR
K 462	Driver (3-splined type)	All gear hubs
K 463	Spring Ring	All gear hubs
K 464	Sprocket 14T 3 splines	AC, ASC, FM, FC
K 465	Sprocket 15T 3 splines	AC, ASC, FM, FC
K 466	Sprocket 16T 3 splines	All gear hubs
K 467	Sprocket 17T 3 splines	All gear hubs
K 468	Sprocket 18T 3 splines	All gear hubs
K 469	Sprocket 19T 3 splines	All gear hubs
K 470	Sprocket 20T 3 splines	All gear hubs
K 504Z	Indicator $2\frac{3}{8}$ " long, for K 601Z	AW, AB, AG
K 504AZ	Indicator $2\frac{3}{8}$ " long for K 601AZ	AW, AB, AG
K 505A	Sliding Clutch	All gear hubs
K 506Z	Axle Cone	All gear hubs
K 507	Driver to 1951. See also K 462	AW, AB, AG, FW, FG
K 508	Sun Pinion	AW, AB, AG
K 509	Dowel for Sun Pinion	AW, AB, AG
K 510	Planet Pinion Pin	AW, AB, AC, AG, FC
K 511A	Gear Ring	All gear hubs except ASC, AM
K 511B	Gear Ring	ASC
K 512	Gear Ring Pawl	All gear hubs except ASC
K 513	Low Gear Pawl	AW, AB, AC, AM, AG, FW, FM, FC
K 515	Planet Cage	AW
K 516	Locking Washer	All gear hubs
K 517	LH Ball Cup	AW, AM, FW
K 518	Shell 40 Holes	AW
K 518A	Shell 36 Holes	AW
K 519	RH Nut	AW, AB, AG
K 520	LH Nut	AW, AB, AG
K 521	Washer	AW, AB, AG, FW, FG
K 526	Axle Key	AW, AB, AG
K 526A	Axle Key	AM, ASC, AC, FW, FM, FC, FG
K 527	Clutch Sleeve	All gear hubs
K 528A	Thrust Ring with Washer K 411 (Replaces K 528)	All gear hubs
K 529	Cap for Clutch Spring	All gear hubs
K 530A	Clutch Spring	AW, AM, AG, AB
K 530B	Clutch Spring (See K 810B Sets)	AC, ASC, FM, FC
	(See K 410B Sets)	FW, FG
K 601Z	Axle $5\frac{3}{4}$ " long	AW, AB, AG
K 601AZ	Axle $6\frac{1}{2}$ " long	AW, AB, AG
K 602	Shell 40 Holes	AB
K 602A	Shell 36 Holes	AB
K 603	Planet Cage	AB, AC, FC, AG
K 604	LH Ball Cup with Flats	AB
K 604A	LH Ball Cup slotted type	AG
K 605	LH Packing Washer	AB, GH 6
K 652	Shell 40 Holes (Steel)	AM
K 652A	Shell 36 Holes (Steel)	AM
K 653	Planet Cage	AM
K 654	Planet Pinion 25T x 14T	AM
K 657	Driver for Splined Sprocket to 1951. See also K 462	AC, ASC, AM, FM, FC

Part No.	Description	Hub Types
K 658A	Gear Ring	AM
K 671	Axle 5 $\frac{3}{4}$ " long	AM
K 707	LH Pawl Pin	FW
K 710	Shell 40 Holes (Alloy)	AC
K 710A	Shell 36 Holes (Alloy)	AC
K 712	Indicator	AM, AC
K 713ZA	Coupling Spindle complete	AM
K 713Z	Coupling Spindle complete. Quick release type	AM, AC
K 714	Collar for Coupling Spindle K 713	AM, AC
K 715	Primary Planet Cage	ASC
K 716	Indicator	ASC
K 718Z	Hub Shell and Ball Cup. 40 Holes	ASC
K 718ZA	Hub Shell and Ball Cup. 36 Holes	ASC
K 719	Secondary Sun Pinion 20T... ..	AC
K 720	Compound Cage	AC
K 722	Pawl	Latest trigger control
K 723	Trigger Lever	Latest trigger control
K 724C	Medallion for Trigger Control	All trigger controls except ASC
K 724D	Medallion for Trigger Control	ASC only
K 731A	Pivot Pin	All trigger controls
K 732	Pawl	Early trigger control
K 733A	Spring	Early trigger control
K 734	Cable Guide... ..	Early trigger control
K 735Z	Trigger Cable complete	Early trigger control
K 738	Pawl Spring	Latest trigger control
K 739Z	Trigger Cable complete	Latest trigger control
K 740AZ	Quick Release Connection	AC, ASC, AM, FM, FC
K 744	Fulcrum Sleeve for K 745Z Clip	All trigger controls
K 745Z	Fulcrum Clip complete 1"	All trigger controls
K 745AZ	Fulcrum Clip complete $\frac{7}{8}$ "	All trigger controls
K 745BZ	Fulcrum Clip complete 1 $\frac{1}{8}$ "	All trigger controls
K 754	Sun Pinion (NCCH. Steel)	AW (Tandem)
K 755	Sliding Clutch (NCCH. Steel)	AW (Tandem)
K 804	Indicator	FW, FM, FC, FG
K 804A	Indicator	FW, FM, FC, FG
K 805A	Low Gear Dog	ASC, FM, FC
K 806	Dog Sleeve	ASC, FM, FC
K 807Z	Coupling Spindle with Connection Plate—Quick Release Type... ..	ASC, FM, FC
K 807ZA	Coupling Spindle complete	FW, FG
K 808	Primary Sun Pinion	ASC, FC
K 809A	Secondary Sun Pinion	ASC, FM, FC
K 810B	Low Gear Spring with K 530B and K 813B	ASC, FM, FC
K 811	Locating Plate for K 809	ASC, AC, FM, FC
K 812	Locknut	ASC, AC, FW, FM, FC, FG
K 813B	Compensating Spring. (See K 410B and K 810B sets)... ..	
K 815A	Secondary Planet Cage	ASC, FM, FC
K 816A	Secondary Planet Pinion	ASC, FM, FC
K 817	LH Ball Cup	FM, FC, AC
K 818	Shell 40 Holes (Alloy)	FC
K 818A	Shell 36 Holes (Alloy)	FC
K 820	Primary Planet Cage	FM
K 821	Primary Sun Pinion	FM
K 822B	Planet Pinion	FM
K 823	Pawl Pin	FM
K 824	Shell 40 Holes (Alloy)	FM
K 824A	Shell 36 Holes (Alloy)	FM

Part No.	Description	Hub Types
K 831	Axle 5 $\frac{3}{4}$ " long	AC, ASC, FM, FC
LB 111Z	Brake Arm Clip for Round Fork	BF
LB 112Z	Brake Arm Clip for Oval Fork	BF
LB 121	Washer. (Now replaced by K 428 with X42 Washer)	BF, BR, AB
LB 126Z	Brake Arm Clip for 'D' Fork	BF
LB 127	Fulcrum Screw for Brake Shoe	BF, BR, AB
LB 130Z	Brake Arm Clip for Duplex Forks	BF
LB 138AZ	Front Brake Plate (Rod) to 1951. See also LB 415AZ... ..	BF
LB 140Z	Brake Arm Clip $\frac{1}{2}$ " dia. Taper Forks	BF
LB 145Z	Brake Arm Clip for Raleigh small section Taper Forks	BF
LB 147AZ	Front Brake Plate (Cable) to 1951. See also LB 416AZ	BF
LB 149	Cam Lever (Cable)... ..	BF
LB 150	Cam Lever (Rod)	BF
LB 155	Locknut	BF, BR, GH 6
LB 155A	Locknut (Spigot)	BF, GH 6
LB 156	Axle 5 $\frac{3}{4}$ " long	BR
LB 156A	Axle 6 $\frac{1}{2}$ " long	BR
LB 159	Thin Spacing Washer (not always used)	AG, FG
LB 161Z	Wingnuts	BF, BR, GH 6
LB 162	Axle Nuts	BF, BR, GH 6
LB 164	Axle 6 $\frac{1}{8}$ " long	BR
LB 166	Cam Lever	BR, AB
LB 167	Brake Rod Adjusting Nut... ..	BF, BR, AB
LB 168A	Roller Nipple for Brake Cable	BF, BR, AB
LB 304	Swivel Pin	BF, BR, AB
LB 309	Inner Clip for 'D' or Duplex Fork	BF
LB 309A	Inner Clip for Oval Fork	BF
LB 320	Bottom Bracket Brake Link	BR, AB
LB 321	Seat Tube Clip	BR, AB
LB 322	Swivel Bolt for Brake Link	BR, AB
LB 323	Brake Link Spring	BR, AB
LB 324	Long Connection for Brake Rod	BR, AB
LB 325	LH Side Action Bellcrank	BR, AB
LB 326AZ	LH Bellcrank with Fulcrum	BR, AB
LB 326BZ	RH Bellcrank with Fulcrum	BR, AB
LB 327A	Fulcrum Half Clip for LB 326A	BR, AB
LB 329	Front Stirrup for Rod Control	BF
LB 330	Outer Clip for 'D' or Oval Forks	BF
LB 330A	Outer Clip for Duplex Forks	BF
LB 331	Fulcrum Bolt	BF
LB 332	Fulcrum Bolt for Bellcranks	BR, AB
LB 334	Top Connection for Brake Rod	BF, BR, AB
LB 350	Cable Guide... ..	BF, BR, AB
LB 351Z	Shell 40 Holes	BR
LB 352Z	Shell 36 Holes	BR
LB 357AZ	LH Cone	BF, BR, GH 6
LB 358Z	RH Cone	BF, BR, GH 6
LB 401Z	Shell 32 Holes	BF
LB 402Z	Shell 36 Holes	BF
LB 404	Cone Dust Cap	All hubs
LB 405	Dust Cap	All hubs
LB 415AZ	Front Brake Arm (Rod). See also LB 138AZ	BF
LB 416AZ	Front Brake Arm (Cable). See also LB 147AZ	BF
LB 426	Axle 5" long	BF, GH 6
LB 426B	Axle 4 $\frac{3}{4}$ " long	BF, GH 6
M355	Lubricator	BF, BR, GH 6

Part No.	Description	Hub Types
N 24	Pinion Pin	FM, ASC
N 43Z	Brake Arm Clip complete	BR, AB
N 120	Quadrant Lever Spring	Top tube controls
N 126	Indicator Spring	K pattern only
N 190	LH Nut	FW, FG, FM, FC, AC, AM, ASC
N 200	RH Nut	FW, FG, FM, FC, AC, AM, ASC
P 70	Plain Washer for Headlamp Fixing Bolt	H/Lamp
P 159	Sprocket Washer $\frac{1}{8}$ " thick. See also X 49	Rear hubs
P 1151	Frame Cable Clip (Black only)	BR, AB
P 1183	RH Side Action Bellcrank	BR, AB
S 35	Clip Screw	BF, BR, AB
S 98	Nut for Fulcrum Bolt	BF, BR, AB
S 154	Fulcrum Bolt for Rear Rod Bellcrank	BR, AB
S 386	Clip Screw Nut	BF, BR, AB
S 433	Nut for Brake Rod Connection	BF, BR, AB
S 535	Screw for Brake Rod Connection	BF, BR, AB
S 545	Lubricator	All gear hubs
S 558	Bush for Bolt-On Bellcrank	BR, AB
S 581	Nipple for Brake Wire	BF, BR, AB
S 583	Bolt for Fulcrum Clip	BF, BR, AB
S 637	Clip Bolt for $\frac{3}{8}$ " Bar	BF, BR, AB
S 638	Clip Bolt Nut	BF, BR, AB
S 712	Locknut	BF, BR, AB
TL 6R	Tail Lamp, Oval Clip but less flex	T/Lamp
TL 6D	Tail Lamp, 'D' Shaped Clip but less flex	T/Lamp
TL 6S	Tail Lamp, $\frac{3}{8}$ " Round Clip but less flex	T/Lamp

Part No.	Description	Hub Types
TL 6T	Tail Lamp, $\frac{1}{2}$ " Round Clip but less flex	T/Lamp
X 4	Knurled Connection	All gear hubs
X 8	Collar	ASC, FW, FM, FC, FG
X 42	Axle Nut Spacing Washer $\frac{1}{8}$ " thick	All hubs
X 42A	Axle Nut Spacing Washer $\frac{1}{8}$ " thick	All hubs
X 48	Sprocket 18T Screwed	AW, AB, AG, FW, FG
X 48C	Sprocket 17T Screwed	AW, AB, AG, FW, FG
X 48D	Sprocket 19T Screwed	AW, AB, AG, FW, FG
X 48E	Sprocket 16T Screwed	AW, AB, AG, FW, FG
X 48F	Sprocket 20T Screwed	AW, AB, AG, FW, FG
X 49	Sprocket Washer $\frac{1}{8}$ " thick. See also P 159	All gear hubs
X 61	Quadrant Connection	Top tube control
X 62	Quadrant Connection Pin	Top tube control
X 69	Clip Bolt	All gear controls
X 78	Pulley Wheel	All gear controls
X 78BZ	Pulley complete $1\frac{1}{2}$ "	All gear controls
X 79	Pulley Arm	All gear controls
X 80	Pulley Arm Screw	All gear controls
X 81Z	T.T. Control Wire 32", 34" or 36"	Top tube controls
X 81Z	T.T. Control Wire 54" or 58"	Top tube controls
X 81Z	T.T. Control Wire 79"	Top tube controls
X 90	Clip Bolt	All gear controls
X 109	Pulley Half Clip	All gear controls
X 110	Pulley Clip with Bush	All gear controls
X 111	Clip Bolt Nut (Black)	All gear controls
X 111A	Clip Bolt Nut (Chrome)	All gear controls

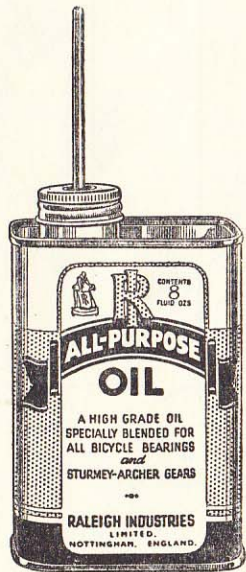

LUBRICATION

When a new hub is put into use see that one teaspoonful of oil is added, and the rider should be advised to add a quarter to half this quantity at least once every fortnight afterwards. See that the cover is properly closed after lubrication. Occasionally oil the trigger control inner wire and moving parts of control mechanism. Remember that oil will not damage Dynohub parts, therefore over-oiling need not be feared, although it

should be avoided because it attracts dirt to the outside of the hub and detracts from its appearance. It is important to remember that the dust and water excluding devices on the hub rely upon a film of oil always being within them; therefore, if the hub is allowed to run dry for any time this protection is lost. The right oil for all Sturmey-Archer hubs is R.I. "All Purpose" Oil.

AXLE CHART for BF., BR., and GH 6. HUBS

LAY AXLE ALONG THIS CHART. COMPARISON OF OVERALL LENGTH AND LENGTH OF FLATS AT EACH END WILL GIVE CORRECT SYMBOL NUMBER

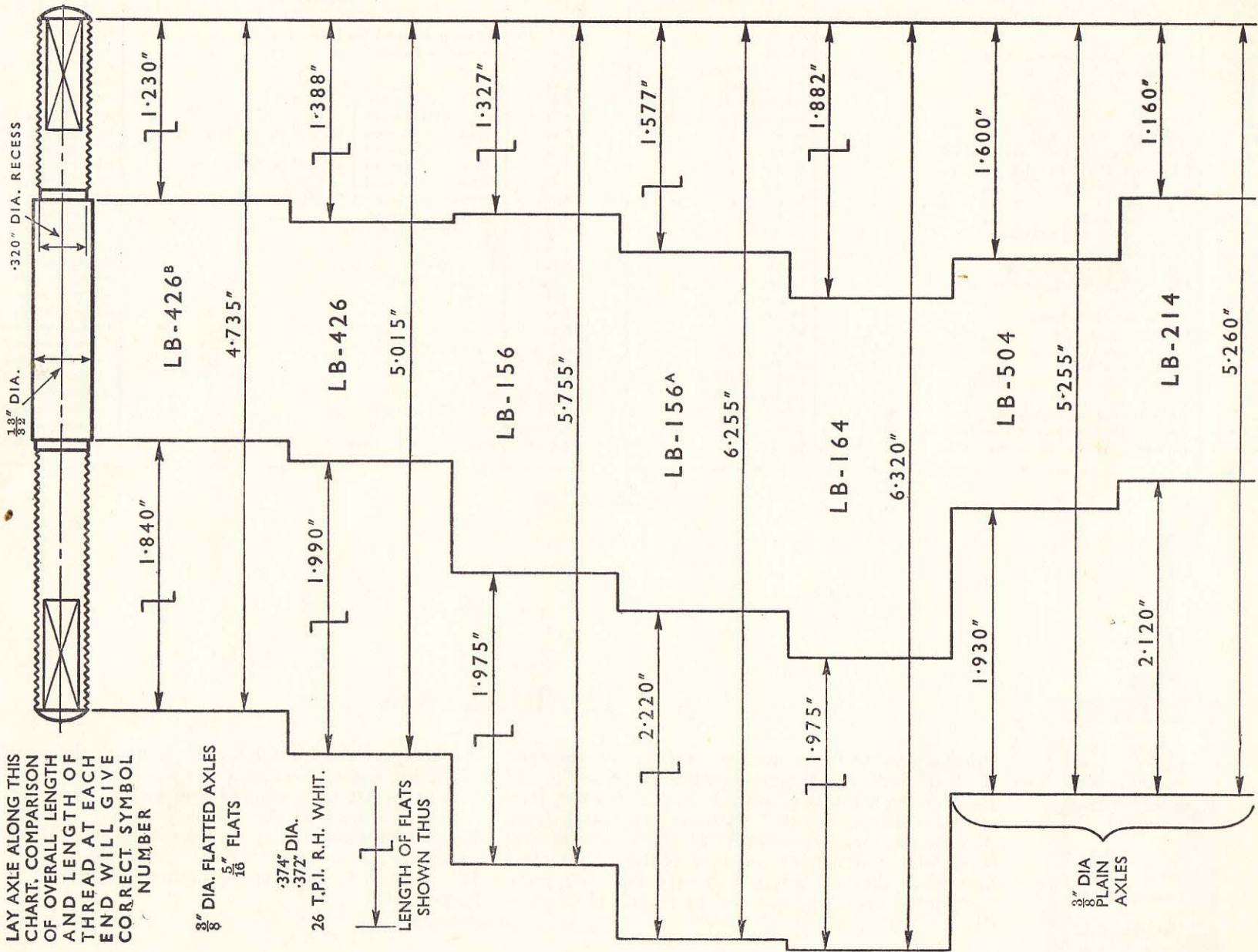

AXLE CHART FOR 3- and 4-SPEED HUBS

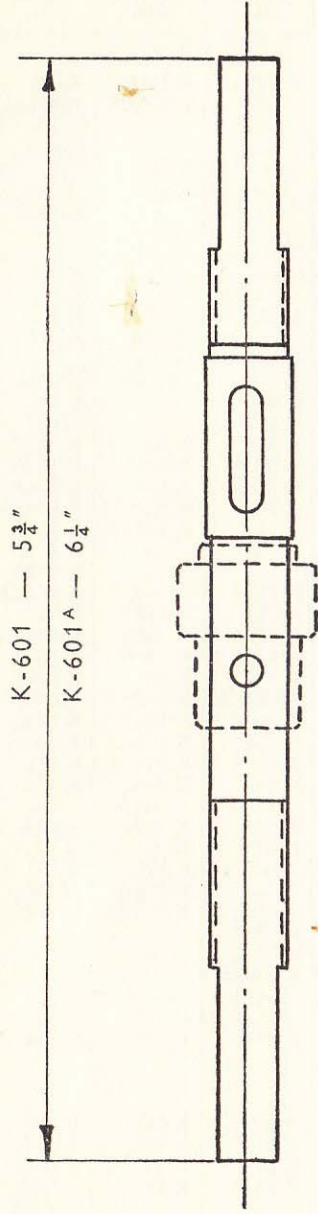

AW AB AG

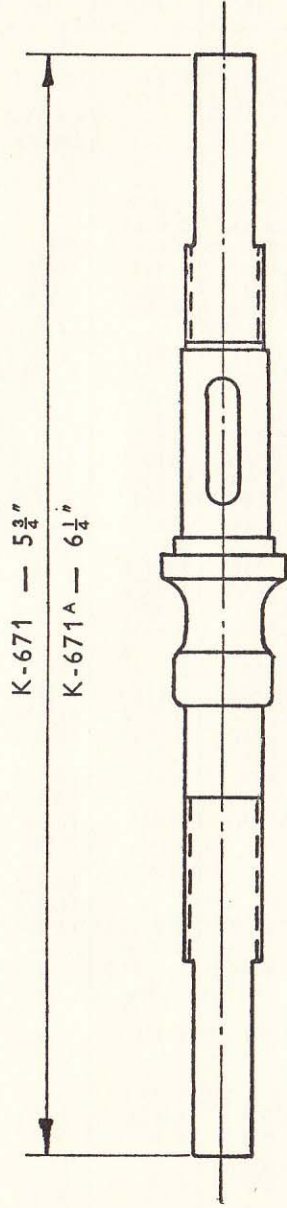

AM

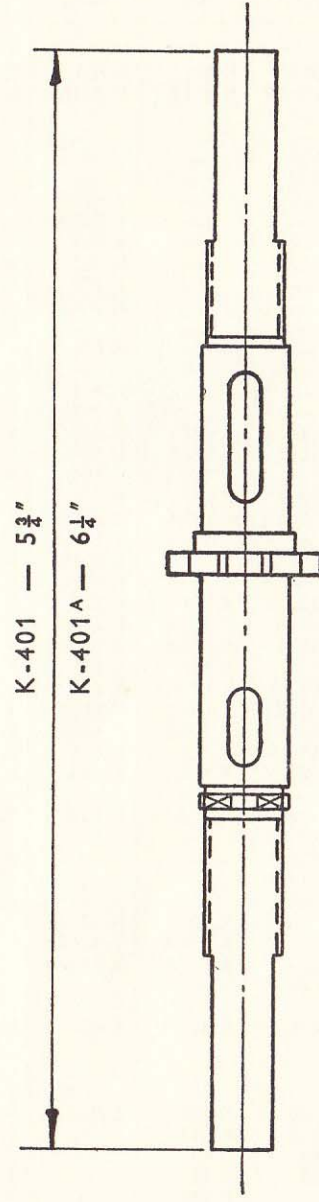

FW FG

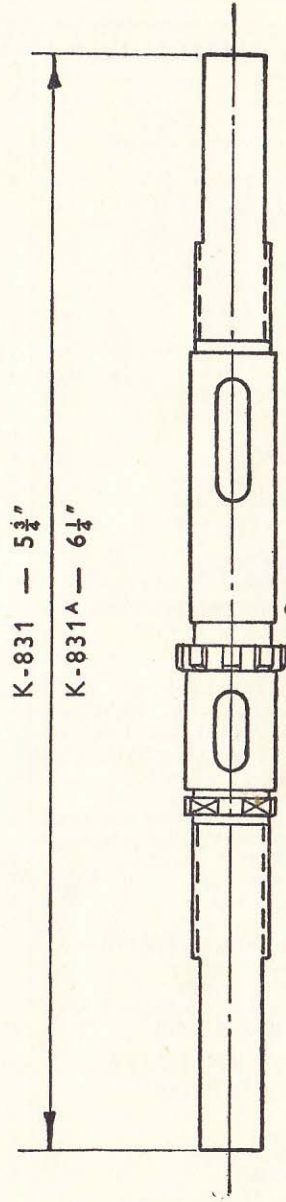

AC ASC FC FM

INTERCHANGEABILITY OF PARTS

	AW.	AB.	AM.	ASC.	FW.	FM.	FC.	BF.	BR.	AC.	AG.	FG.	GH 6.
Gear Ring Pawl	K 512	K 512	K 512	—	K 512	K 512	K 512			K 512	K 512	K 512	
Gear Ring Pawl Pin	K 58	K 58	K 58	—	K 58	K 58	K 58			K 58	K 58	K 58	
Pawl Spring	K 64	K 64	K 64	—	K 64	K 64	K 64			K 64	K 64	K 64	
Secondary Planet Cage	—	—	—	K 815A	—	K 815A	K 815A			—	—	—	
Secondary Planet Pinion	—	—	—	K 816A	—	K 816A	K 816A			K 16	—	—	
Shell, 40 Holes	K 518	K 602	K 652	K 718Z	K 418	K 824	K 818	—	LB 351Z	K 710	GL 618	GL 624	
Shell, 36 Holes	K 518A	K 602A	K 652A	K 718AZ	K 418A	K 824A	K 818A	LB 402Z	LB 352Z	K 710A	GL 618A	GL 624A	
Compound Cage	—	—	—	—	—	—	—	—	—	K 720	—	—	
Shell, 32 Holes	—	—	—	—	—	—	—	LB 401Z	—	—	—	—	
Lubricator	S 545	S 545	S 545	S 545	S 545	S 545	S 545	M 355	M 355	S 545	S 545	S 545	
Right-hand Ball Ring	K 60	K 60	K 60	—	K 60	K 60	K 60			—	K 60	K 60A	
Ball-bearings $\frac{3}{16}$ in. (24 in set)	329	329	329	—	329	329	329			—	329	329	GL 345AZ
Right-hand Inner Dust Cap	K 63	K 63	K 63	—	K 63	K 63	K 63			K 63	K 63	K 63	
Driver	K 507	K 507	K 657	K 657	K 507	K 657	LB 657			K 657	K 507	K 507	GL 345Z
Dust Cap	LB 405	LB 405	LB 405	LB 405	LB 405	LB 405	K 405	LB 405	LB 405	LB 405	LB 405	LB 405	M 355
Left-hand Ball Cup	K 517	K 604	K 517	—	K 517	K 817	K 817			K 817Z	K 604	K 404	
Right-hand Outer Dust Cap	K 62	K 62	K 62	—	K 62	K 62	K 62			K 62	K 62	K 62	
Sprocket Available sizes shown													
18 Teeth under appropriate hubs	X 48	X 48	K 218	K 218	X 48	K 218	K 218			K 218	X 48	X 48	
Sprocket Washer	X 49	X 49	X 49	X 49	X 49	X 49	X 49			X 49	X 49	X 49	LB 405
Sprocket Lockring	—	—	K 36	K 36	—	K 36	K 36			K 36	—	—	
Right-hand Ball Ring	—	—	K 228	K 228	—	K 228	K 228			K 228	—	—	
Ball Cage with $\frac{3}{16}$ in. Balls	—	—	K 230Z	K 230Z	—	K 230Z	K 230Z			K 230Z	—	—	
Outer Dust Cap for K 228	—	—	K 229	K 229	—	K 229	K 229			K 229	—	—	
BRAKE Parts													
Steel Brake Plate and Arm (Cable)		K 160AZ						LB 147AZ	K 160AZ				
Steel Brake Plate and Arm (Rod)		K 160AZ						LB 138AZ	K 160AZ				
Brake Shoes complete with Linings		K 158Z						K 158Z	K 158Z				
Brake Linings with Rivets		K 136						K 136	K 136				
Brake Shoe Spring		K 166						K 166	K 166				
Operating Cam and Washer		K 162Z						K 162Z	K 162Z				
Fulcrum Screw		LB 127						LB 127	LB 127				
Brake Cam Lever (Rod)		LB 166						LB 150	LB 166				
Brake Cam Lever (Cable)		LB 166						LB 149	LB 166				
Cam Lever Nut		K 175						K 175	K 175				
Wire Guide (Cable Control only)		K 171						K 118	K 171				
Locking Washer for Wire Guide		K 172						—	K 172				
Locknut for Wire Guide		K 168						—	K 168				
Adjusting Washer $\frac{1}{4}$ " thick		K 106						K 106	K 106				
Adjusting Washer $\frac{3}{16}$ " thick		LB 121						LB 121	LB 121				
Packing Washer		K 605						K 360	K 360				
Brake Arm Clip (Round)		K 124						LB 111	K 124				
Brake Arm Clip (Oval)		N 43						—	N 43				
Brake Arm Clip (Oval)		—						LB 112	—				
Brake Arm Clip ("D")		—						LB 126	—				
Brake Arm Clip (Duplex)		—						LB 130	—				
Clip Screw		X 69						X 90	X 69				
Nut for Clip Screw		S 386						S 386	S 386				
DYNO Parts													
Armature, complete											GL 603AZ	GL 603AZ	GL 603AZ
Magnet											GL 343A	GL 343A	GL 343A
Spacing Ring											GL 609	GL 626	GL 609
Patent No. Disc											GL 610	GL 610	GL 610
Cover Plate											GL 611	GL 611	GL 611
Magnet Fixing Screw											GL 612	GL 612A	GL 612
Nut for Magnet Fixing Screw											GL 614	GL 614	GL 614

SERVICING NOTES

K Range Hubs

We have now ceased manufacture of spares for these hubs, and when the few remaining parts become exhausted, the hubs will be obsolete.

AW and AB Hubs

Prior to 1940 a different type of axle (K 501Z) was used. Most of these have already been converted to present pattern, but a few may still be in service. The main difference is that the original axle key (K 502) was square section, whilst the present one (K 526) is round. The conversion set for these hubs consists of:—

K 601Z Axle with Sun Pinion	K 528A Thrust Ring with K 411 Washer
K 526 Axle Key	K 529 Cap for Clutch Spring
K 527 Sleeve	K 530A Clutch Spring

AB, BF and BR Hubs

Up to 1936 these hubs were fitted with brake arms and shoes in aluminium. These are not interchangeable with the present pattern arms and shoes. The original aluminium shoes can be re-lined if returned to us, but if they are beyond re-lining, the complete assembly must be replaced by the present pattern shoes and brake arm in steel. New aluminium brake arms only are still available at the same price as steel arms. The brake shoe fulcrum sleeve (K 117) and Brake Cam and Washer (K 112Z) are no longer available.

Slightly different type of fitting was used on brake cables, and the brake cables are as follows:—

GD 331Z Brake Cable for front hub
GD 332Z Brake Cable for rear gent's hub
GD 333Z Brake Cable for rear ladies' hub

Steel Brake Parts

These are re-designed for 1951, and the new symbol numbers are:—

K 452 Brake Shoe Cam	K 460AZ Rear Brake Arm complete
K 456 Fulcrum Sleeve	LB 415AZ Front Brake Arm „ (Rod)
K 458AZ Brake Shoes	LB 416AZ Front Brake Arm „ (Cable)

The above are not individually interchangeable with the original steel brake parts, but where a complete set is required, the new parts can be fitted to the existing hub shell.

BF and BR Spindles and Cones

Early BF hubs had $\frac{5}{16}$ " spindles, which are no longer available. In the 1932 hubs, $\frac{3}{16}$ " ball bearings were used and no alternative can be offered. In later BF hubs, $\frac{5}{16}$ " spindles with $\frac{1}{4}$ " ball bearings were used and the present pattern $\frac{3}{8}$ " spindle, complete with cones, nuts and washers, can be substituted.

Early BR hubs used loose $\frac{1}{4}$ " ball bearings, and the correct parts, whilst still available are:—

LB 156 Spindle $5\frac{3}{4}$ " long	LB 157 L.H. cone	S 419 Dust Cap
LB 156A Spindle $6\frac{1}{4}$ " long	LB 158A R.H. cone	

Rod Brake Controls

Note that these can be supplied in four patterns, and full description is therefore necessary on all orders for these fittings. Types are:—

- Bolt-on Bell Crank, Left-hand operation
- Bolt-on Bell Crank, Right-hand operation
- Clip-on Bell Crank, Left-hand operation
- Clip-on Bell Crank, Right-hand operation

We supply the first-named as standard in all cases where no details are given when ordering.

AM Hubs

Hubs sold up to 1940 used a different axle and axle key, but these are not now available. The present Clutch Spring (K 530A) and Spring Cap (K 529) can be used with the original axles, but if a new axle, axle key or sleeve is required, the following conversion set must be fitted:—

K 671 Axle	K 528A Thrust Ring with K 411 Washer
K 526A Key	K 529 Cap for Clutch Spring
K 527 Sleeve	K 530A Clutch Spring

Also a small number of pre-war AM hubs were made with the K 504Z (AW) indicator, and if a new axle is required in these cases, the above conversion set and its appropriate indicator must be substituted.

Trigger Controls

The early pattern with exposed pawl spring is still repairable, and spares are available on demand.

Stocks of X 116Z Fulcrum Clip are exhausted, but the new K 745Z may be used, with K 744 Sleeve in its place. It is only necessary to remove the ferrule from the end of the trigger cable.

The cable guide at the front end of the casing of this control must *not* be loosened or removed. It is slotted for removal of trigger wire, and to enable new ones to be fitted.

A service exchange scheme for the trigger unit is available, through our wholesale depots.

Alternative wire lengths are available to suit different frames.

Drivers and Sprockets

During 1951 we changed over to a 3-splined fitting listed under symbol numbers K 462 to K 470. The sprocket is secured by means of a spring ring or circlip, and it is easily removable for exchange or replacement by merely prising off this circlip. At time of going to print this change is in progress, but it will eventually be applied to all gear hubs.

In due course it will be possible to convert existing hubs by fitting the driver and sprocket as a complete unit, including spacing washers and circlip.

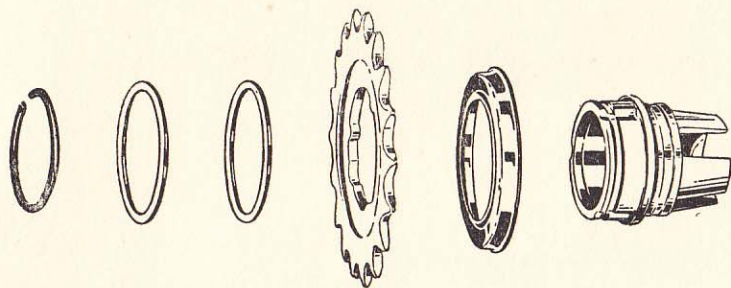

Sliding Clutch Assembly

Modification took effect during 1951 to K 505 Clutch, K 527 Sleeve and K 528 Thrust Ring. The sleeve has smaller diameter flange, but the new part can be used in any earlier hub without other alteration. The symbol number is not altered.

The Clutch has a smaller recess. The new symbol number is K 505A and since this necessitates fitting the new sleeve as well, these two parts are, for the time being, cartoned together. No more K 505 will be made, so that when an old one needs replacing, a new clutch and sleeve must be fitted.

The new Thrust Ring K 528A is shorter than the old one, and is used in conjunction with K 411 Washer to take the thrust of K 530A Clutch Spring. The Ring and Washer are supplied in pairs at same price as original K 528.

Gear Rings

The original K 511 and K 658 each had two separate sets of dogs, one for middle gear and one for low gear, so that eight splines could be seen when looking through the part. These two sets of splines have now been brought into line with each other, and K 511A and K 658A have therefore only four splines of double the length of those in the earlier parts.

K 511A is interchangeable with K 511, and K 658A with K 658, and we shall therefore supply the new pattern against all future orders.

FM and FC Hubs

The pre-war FM and AF (now known as FC) hubs used an axle different from the present pattern. If a new axle is required, the following conversion set must be used:—

K 831	Axle	K 528A	Thrust Ring with K 411 Washer
K 526A	Key	K 529	Cap for Clutch Spring
K 527	Sleeve	K 530A	Clutch Spring
(or K 530B—see note about springs following)			

Modifications have also been made at the low gear end as follows:—

K 805A	Low Gear Dog	replaces K 805
K 806	Dog Sleeve	replaces K 803 Thrust Washer
K 402	Low Gear Key	replaces K 802
K 809A	Secondary Sun Pinion	replaces K 809

These parts as a complete set, can be used in the pre-war FM and AF hubs

without other alterations. This conversion will be required whenever any one of the old parts needs renewal.

Springs in Four-Speed Gears

We have been using weaker springs K 530B, K 410B, K 810B and K 813B in all four-speed gears from 1950, in order to reduce the pull on the control wire necessary to engage bottom gear.

There are three springs in each hub, and they must either all be of the original strong pattern, or all of the above weaker type. The weaker springs may be fitted to any earlier hub where desired, so long as the complete set is changed, and for this reason we are for the time being only cartoning these springs in sets. They are listed under symbols K 410B (for FW and FG) and K 810B (for FM and FC).

FM and FC Hubs

Up to 1940 these hubs were fitted with planet pinions having 15 teeth. Since then the pinions have been cut with only 14 teeth. The diameters are the same, so that a stronger tooth is provided.

The early planet pinions are no longer available, but the later 14T sizes are interchangeable. Note however, that on no account must these two sizes of planet pinions be mixed in the same hub.

FM, FC, ASC and AC Hubs

The X 38 Lubricator in the Left-hand Ball Cup K 817 has been discontinued from 1951.

FW Hubs

The low gear Pawl Pin, K 707, was originally left loose, and a thin shim washer fitted to protect the head from being worn by the pinion teeth. Since early 1949 this shim washer has been discontinued and the pawl pin has been riveted in position.

If Dealers are called upon to undertake repairs to any hub which has not been brought up to date in this respect, they should arrange to make the alteration as part of such repair. The slight end play allowed to the planet pinions by removal of this washer is of no consequence whatever, and will not in any way affect the operation of the gears.

D.B.U. Container

During 1951 a new D.B.U. container has been introduced, the batteries now being inserted from the bottom and held in position by a spring ring. Both containers are illustrated and spares for the old type will be available for some time. The only part which is interchangeable is the GL 487 Cap.

Note particularly that on the new type spring ring, the groove and spring must be cleaned to obtain proper earthing.

GUARANTEE

Sturmey-Archer Hubs (which expression shall include spare parts thereof) are guaranteed against defects of manufacture for a period of 12 months from the date of sale providing they are still the property of the first retail purchaser. This guarantee is subject to the conditions specified below.

With all Hubs we give a special guarantee instead of the guarantee implied by statute or otherwise as to the quality or fitness for the purpose of cycling of hubs supplied by us, any such implied guarantee being in all cases excluded.

We guarantee, subject to the conditions mentioned below, that all precautions which are usual and reasonable have been taken by us to secure excellence of materials and workmanship, but damage for which we make ourselves responsible under this guarantee is limited to the free supply of a new part in exchange for the part of the hub which may have proved defective, and does not include the cost of fitting. The purchaser shall not be entitled to claim any damage whatever save replacement of the defective parts. This guarantee does not apply to defects caused by wear, misuse or neglect.

If a defective part should be found in any of our hubs, it must be sent carriage paid, accompanied by an intimation from the sender that he desires to have it replaced free of charge under our guarantee, and he must also furnish us at the same time with the date of purchase. Failing compliance with the above no notice will be taken of anything which may arrive, but such articles will lie at the risk of the senders and this guarantee will not be enforceable.

We guarantee only new hubs. A hub bought second-hand is not guaranteed by us.

STURMEY-ARCHER WHOLESALE DEPOTS

are strategically placed throughout the British Isles to provide Factors and Dealers with prompt and efficient service.

Orders for Gears and Spare Parts should be placed by Dealers
with their usual Factor or appropriate Wholesale Depot

LONDON and HOME COUNTIES

Raleigh House, Great West Road, Brentford, Middlesex
Tel. Ealing 6721.

46, Ashburnham Road, Bedford. Tel. 4913.

LANCASHIRE, CHESHIRE and NORTH WALES

288-294, Eccles New Road,
Weaste, Salford, 5, Lancs.
Tel. Pendleton 2251-2-3.

Delamere Street, Chester. Tel. 23906.

EAST MIDLANDS

199, Lenton Boulevard, Nottingham.
Tel. 77539.

86, Charlotte Road, Sheffield, 1.
Tel. 21603.

Mars St., Smallthorne, Stoke-on-Trent.
Tel. 84421.

EASTERN COUNTIES

Castle Hill, Norwich.
Tel. 23894.

WEST OF ENGLAND

Asher Lane, Redcross Street, Bristol, 2.
Tel. 24825.

Alphington Street, Exeter.
Tel. 54477.

SCOTLAND

90, Salkeld Street, Glasgow, C.5.
Tel. South 2692.

62-66, Leadside Road, Aberdeen.
Tel. 27171.

YORKSHIRE DISTRICT

421, Kirkstall Road, Leeds, 4.
Tel. 38050.

24, Park Street, Hull. Tel. 36052.

MIDLANDS

377, Bolton Road, Small Heath,
Birmingham, 10.
Tel. Victoria 2268/9.

NORTHERN COUNTIES

38, St. Mary's Place,
Newcastle-on-Tyne, 1.
Tel. 22988.

SOUTHERN COUNTIES

Back of the Walls, Southampton.
Tel. 2227.

387, Cowley Road, Oxford. Tel. 7391.

NORTHERN IRELAND

57, Linenhall Street, Belfast.
Tel. 20086.

SOUTH WALES DISTRIBUTORS

W. E. A. Kennard,
195-201, Richmond Road, Cardiff.
Tel. 1333.

HEAD OFFICES

STURMEY - ARCHER GEARS LTD.

LENTON BOULEVARD, NOTTINGHAM, ENGLAND

TEL. NOTTINGHAM 75154.

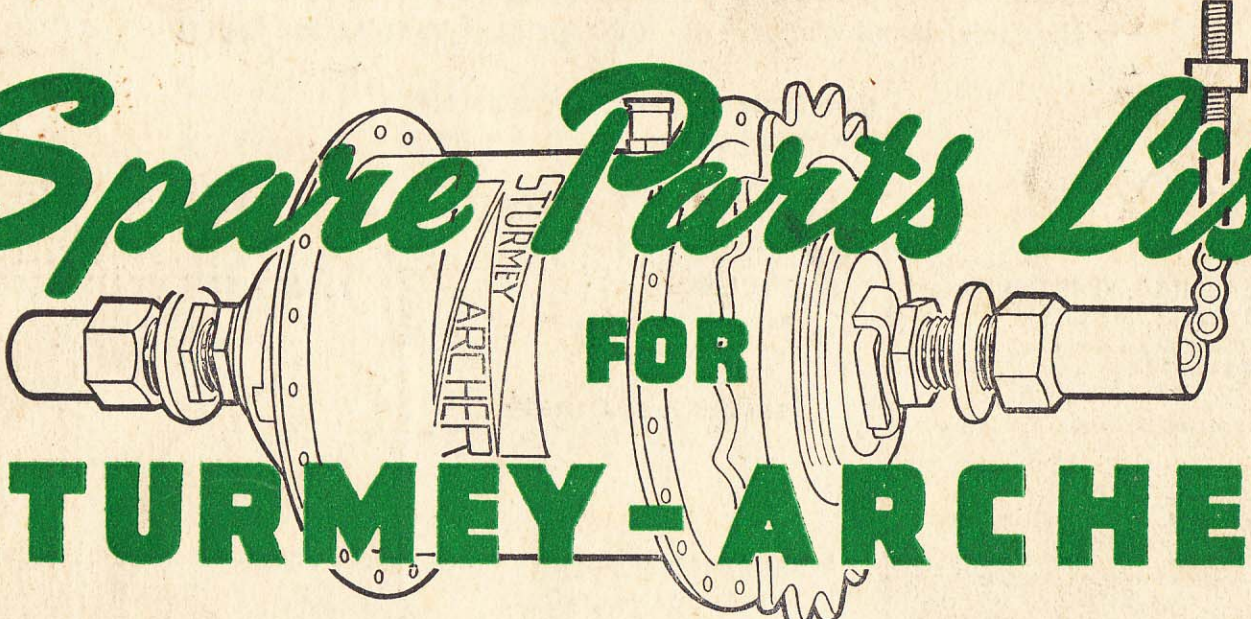

Spare Parts List
FOR
STURMELEY-ARCHER
GEAR HUBS, BRAKE HUBS
AND DYNOHUBS

Published by
STURMELEY-ARCHER GEARS LTD.
NOTTINGHAM, ENGLAND

FOR TRADE USE ONLY

IceniCAM Information Service

