

IceniCAM Information Service

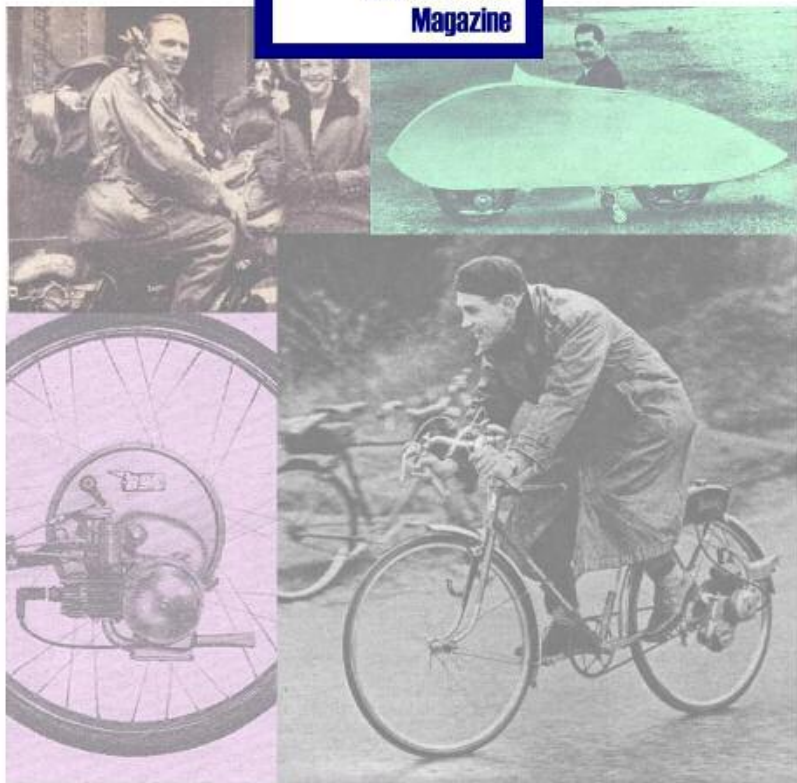

www.icenicam.org.uk

A LIST OF
Spare & Replacement Parts

FOR THE

ROYAL ENFIELD

350 c.c. SIDE VALVE

MOTOR CYCLE

MODEL **WD/C**

THE
ENFIELD CYCLE CO. LTD.

JANUARY, 1942.

Price 1/-

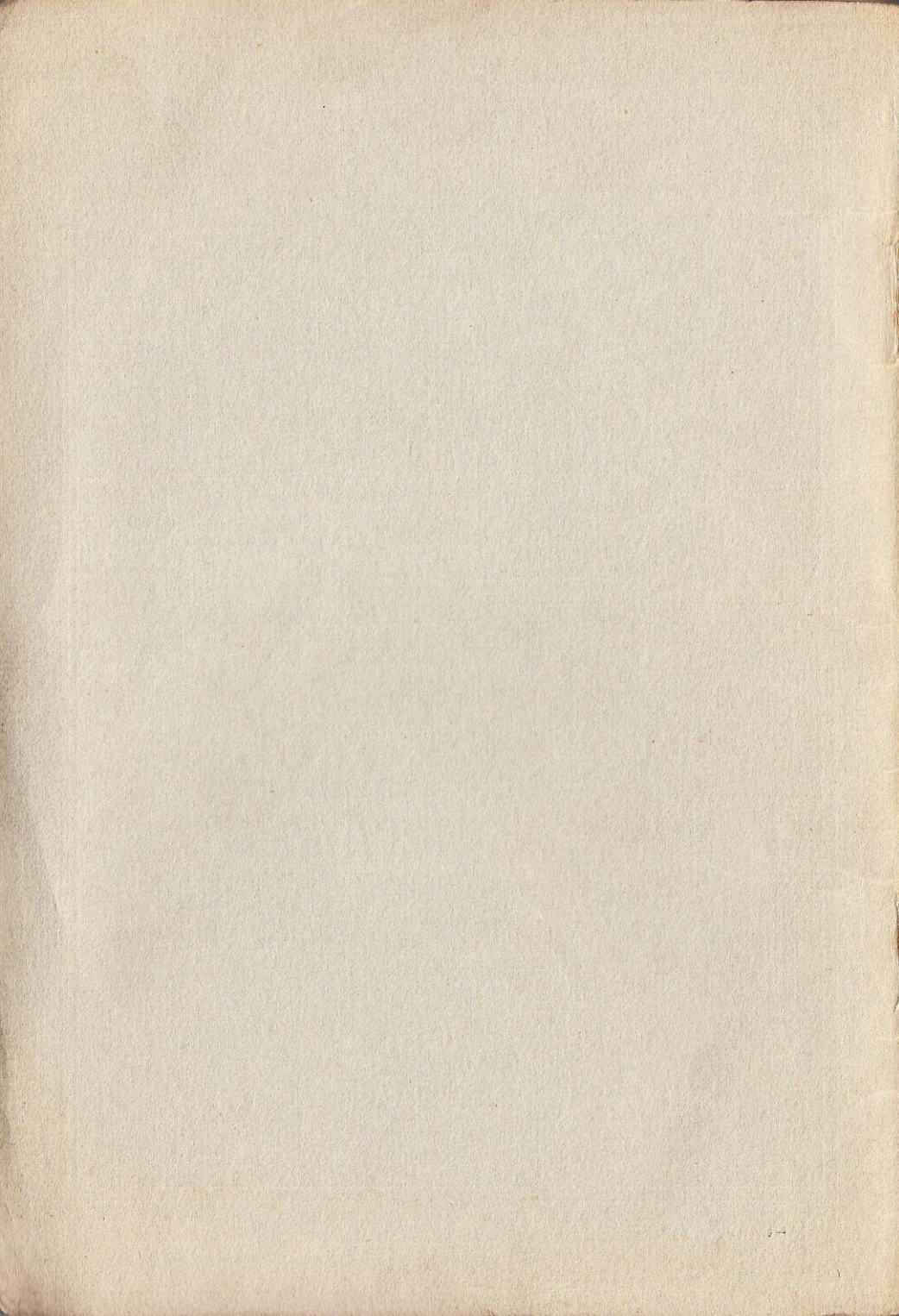

In accordance with a decision of the
Manufacturers' Union the price of all
motor cycle spare parts is increased
from 1st September, 1945.

Spare and Replacement Parts

ROYAL ENFIELD

350 c.c. SIDE VALVE
MOTOR CYCLE
MODEL **WD/G**

*Units when demanding Spares for "B"
and "R.A.S.C." Machines will quote
Proprietary or M.T. Part Nos. where
applicable.*



THE ENFIELD CYCLE CO. LTD.

THE ROYAL ENFIELD 350c.c. SIDE VALVE MODEL WD/C.

ROYAL ENFIELD ENGINE

Illus. No.	No. of part.	Description.	No. per set	M.T. or Proprietary No.	£	s.	d.
	28300	346c.c. S.V. engine, with magneto and carburettor	1	<i>Price on application.</i>			
1	28267	Crankcase assembly with fixed fittings	1	6	5	0
2	16291 bearing bush (timing side)	1	0	1	8
3	21187 roller race (timing side)	1	0	2	9
4	21189 cage	1	0	3	8
5	23515 race (driving side)	1	0	3	4
6	24569 cage	2	0	2	9
7	24570 distance piece (driving side)	1	0	0	2
8	SE342 bearing roller, price per doz.	30	MT7/6624	0	2	9
9	21191 end washer	2	0	0	6
10	21448 thrust washer	2	0	0	9
11	24796 cylinder stud $\frac{5}{16}$ " dia.	4	0	0	2
12	7216 nut	4	0	0	2
13	24173 oil plug and filter	2	0	2	0
14	24178 washer	2	0	0	1
15	13919 filter stud	2	0	0	6
16	13995 gauze and ring	2	0	0	6
17	19670 filler cap	1	0	2	3
18	18275 collar	1	0	1	0
19	22198 non-return valve plug	1	0	0	3
20	22199 spring	1	0	0	2
21	$\frac{3}{16}$ " dia.	.. ball	1	MT7/162	0	0	1
22	26649 breather body	1	0	2	3
23	26648 screw (long)	2	0	0	2
24	26664 (short)	1	0	0	2
25	26651 disc valve	2	0	0	2
26	23517 stud $\frac{5}{16}$ " dia. $2\frac{9}{16}$ " long	1	0	0	3
27	13413 $3\frac{7}{16}$ " "	1	0	0	3
28	17476 $5\frac{3}{8}$ " "	2	0	0	3
29	27304 nut	7	0	0	2
30	8634 washer	7	0	0	1
31	23516 $\frac{1}{4}$ " dia. $4\frac{15}{16}$ " long	3	0	0	2
32	22681 $5\frac{1}{2}$ " "	6	0	0	3
33	26998 nut	18	0	0	1
34	82 washer	18	MT5/9727	0	0	1

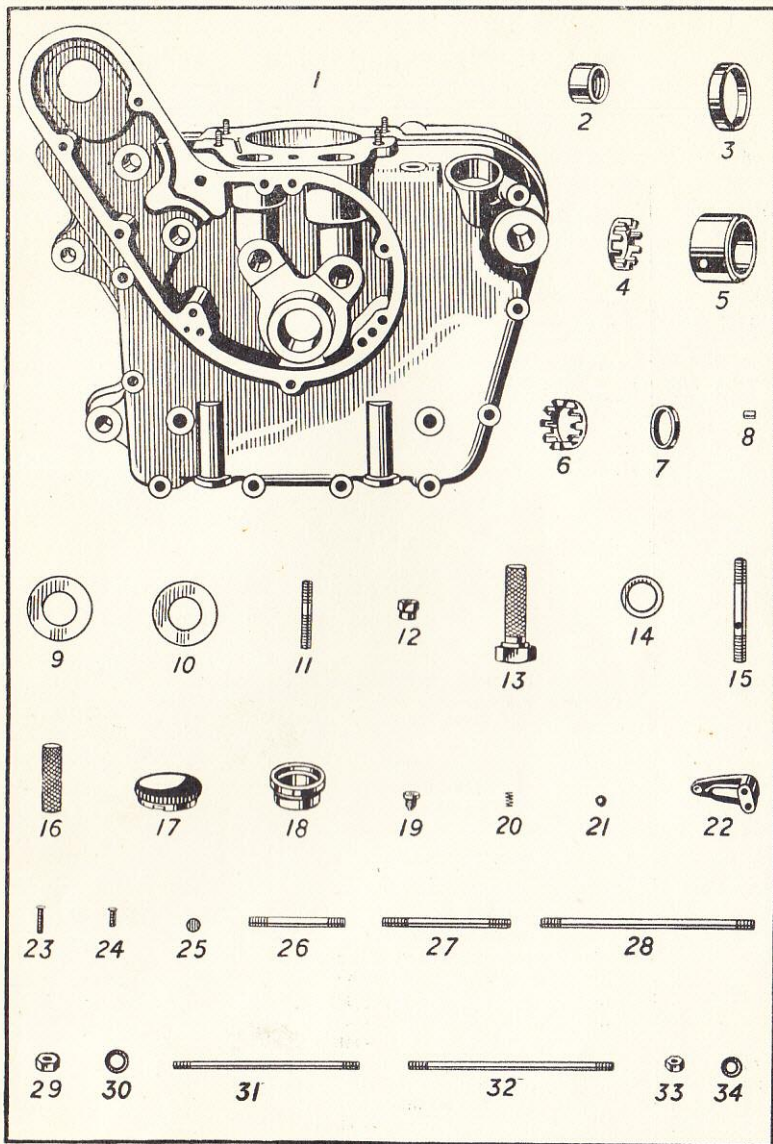

See opposite page for description and price.

THE ROYAL ENFIELD 350c.c. SIDE VALVE MODEL WD/C.

ROYAL ENFIELD ENGINE—Contd.

Illus. No.	No. of part.	Description.	No. per set	M.T. or Proprietary No.	£	s.	d.
1	19195	Tappet (inlet)	1	0	4	6
2	19196	" (exhaust)	1	0	4	6
3	19193	" guide (inlet)	1	0	2	9
4	19194	" " (exhaust)	1	0	2	9
5	14496	" body	2	0	0	9
6	19486	" head	2	0	0	9
7	14403	" locknut	2	0	0	2
8	20024	Cam (inlet) with bushes	1	0	13	6
9	20025	" (exhaust) " "	1	0	13	6
10	19835	" bush (long)	2	0	1	0
11	19836	" " (short)	2	0	1	0
12	23505	" spindle	2	0	3	4
13	28249	Timing gear cover	1	1	17	6
14	22605	" " " joint washer	1	0	0	8
15	13998	" " " stud $\frac{1}{16}$ " dia.	1	0	0	2
		2 $\frac{1}{16}$ " long	1	0	0	2
16	27981	" " " " $\frac{1}{4}$ " dia.	6	0	0	2
		1 $\frac{3}{8}$ " long	6	0	0	2
17	13477	" " " " $\frac{1}{4}$ " dia.	2	0	0	2
		1 $\frac{3}{8}$ " long	2	0	0	2
18	27982	" " " " $\frac{1}{4}$ " nut	9	0	0	2
19	13754	" pinion	1	0	2	9
20	9410	" " key	1	0	0	2
21	28253	Oil cleaner element	1	0	6	0
22	28259	" " spring	1	0	0	2
23	28254	" " cup	1	0	0	3
24	28255	" " stud $\frac{3}{8}$ " dia. 6 $\frac{1}{2}$ " long	1	0	0	6
25	26996	" " " locknut	1	0	0	2
26	13785	" " " washer	1	0	0	1
27	28256	" " cap	1	0	1	0
28	28258	" " " washer	1	0	0	3
29	28257	" " " nut	1	0	0	9
30	6194	" " " " washer	1	0	0	1
31	18793	" " felt washer	1	0	0	1
32	8894	" " thrust washer	1	0	0	1
33	22617	Magdyno drive idler pinion with bush	2	0	5	0
34	19200	" " " " bush	2	0	1	0
35	23506	" " " " spindle	2	0	1	4
36	19552	" " " " thrust washer	4	0	0	3
37	18575	" " pinion	1	0	5	0
38	14538	" " nut	1	0	0	3
39	21423	" " felt washer	1	0	0	3
40	18993	" " " " retainer	1	0	0	2
41	19352	" " corrugated washer	1	0	0	6

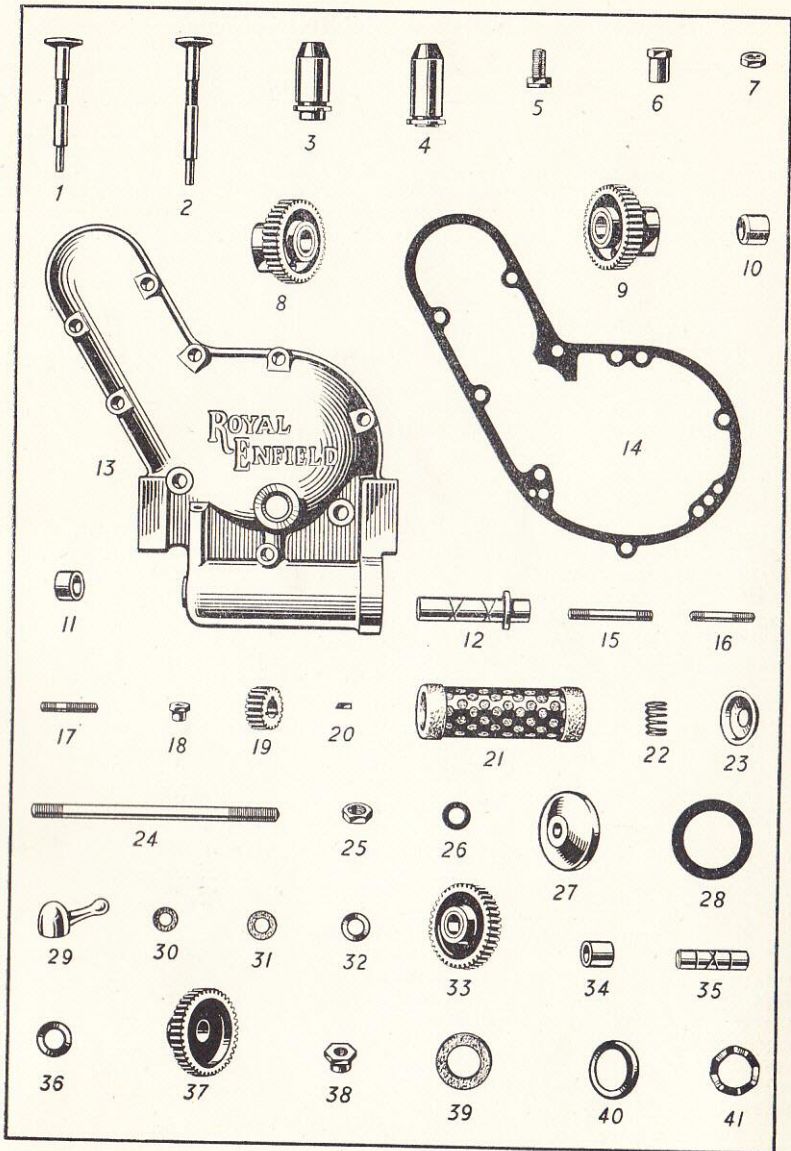

See opposite page for description and price.

THE ROYAL ENFIELD 350c.c. SIDE VALVE MODEL WD/C.

ROYAL ENFIELD ENGINE—Contd.

Illus. No.	No. of part.	Description.	No. per set	M.T. or Proprietary No.	£	s.	d.
1	22899	Magdyno strap	1	0	2	0
2	19068	" " trunnion (plain) ..	1	0	0	3
3	19069	" " " (tapped) ..	1	0	0	4
4	19202	" " " stud $\frac{1}{4}$ " dia. ..	1	0	0	3
5	12881	" " " " " nut ..	1	0	0	3
6	23584	" " " anchor stud ..	1	0	0	2
		(crankcase)	1	0	0	2
7	19065	" " dowel	2	0	0	2
8	24470	Cylinder barrel with valve guides ..	1	3	5	0
9	24494	" " " joint washer ..	1	0	0	2
10	24785	" " " head	1	1	5	0
11	15475	" " " joint washer ..	1	0	2	0
12	15600	" " " stud $2\frac{5}{16}$ " long ..	6	0	0	3
13	15601	" " " " $2\frac{1}{4}$ " " " ..	2	0	0	3
14	16748	" " " " nut $1\frac{1}{2}$ " long ..	4	0	0	3
15	16749	" " " " " 1" " " ..	2	0	0	3
16	7216	" " " " " $\frac{1}{2}$ " " " ..	2	0	0	2
17	16714	" " " " " plug	1	0	0	2
18	16715	" " " " " washer ..	1	MT5/17009 ..	0	0	1
19	16566	Valve (inlet)	1	0	5	6
20	15488	(exhaust)	1	0	6	6
21	13321	" " " guide	2	0	2	6
22	150097	" " " spring	2	0	1	0
23	8724	" " " collar (top) ..	2	0	0	6
24	13324	" " " " (bottom) ..	2	0	0	6
25	15489	" " " split collar	2	0	0	6
26	23083	" " " spring cover	1	0	1	0
27	21834	" " " " joint washer ..	1	0	0	6
28	24258	" " " " stud	1	0	0	3
29	17385	" " " " " nut	1	0	0	6
30	8634	" " " " " $\frac{5}{16}$ " steel ..	1	0	0	1
		washer	1	0	0	1
31	25990	" " " " " fibre washer ..	1	MT1/37010 ..	0	0	1
32	25567	" " " " " lifter	1	0	2	6
33	21836	" " " " " spindle	1	0	0	3
34	12679	" " " " " spring	1	0	0	1
35	26761	Piston complete with rings and gud- geon pin	1	1	5	0
	26761B	" " " " (.015" oversize) ..	1	1	5	0
	26761C	" " " " (.030" " ") ..	1	1	5	0
36	12375	" " " " " ring (compression) ..	2	0	1	0
	12375B	" " " " (.015" oversize) ..	2	0	1	0
	12375C	" " " " (.030" " ") ..	2	0	1	0
37	26239	" " " " " (slotted scraper) ..	1	0	1	6
	26239B	" " " " " (" " " ") ..	1	0	1	6
	26239C	" " " " (.015" oversize) ..	1	0	1	6
		(slotted scraper	1	0	1	6
		.030" oversize)	1	0	1	6
38	22595	Gudgeon pin	1	0	2	9
39	20363	" " " " " keeper ring	2	0	0	2

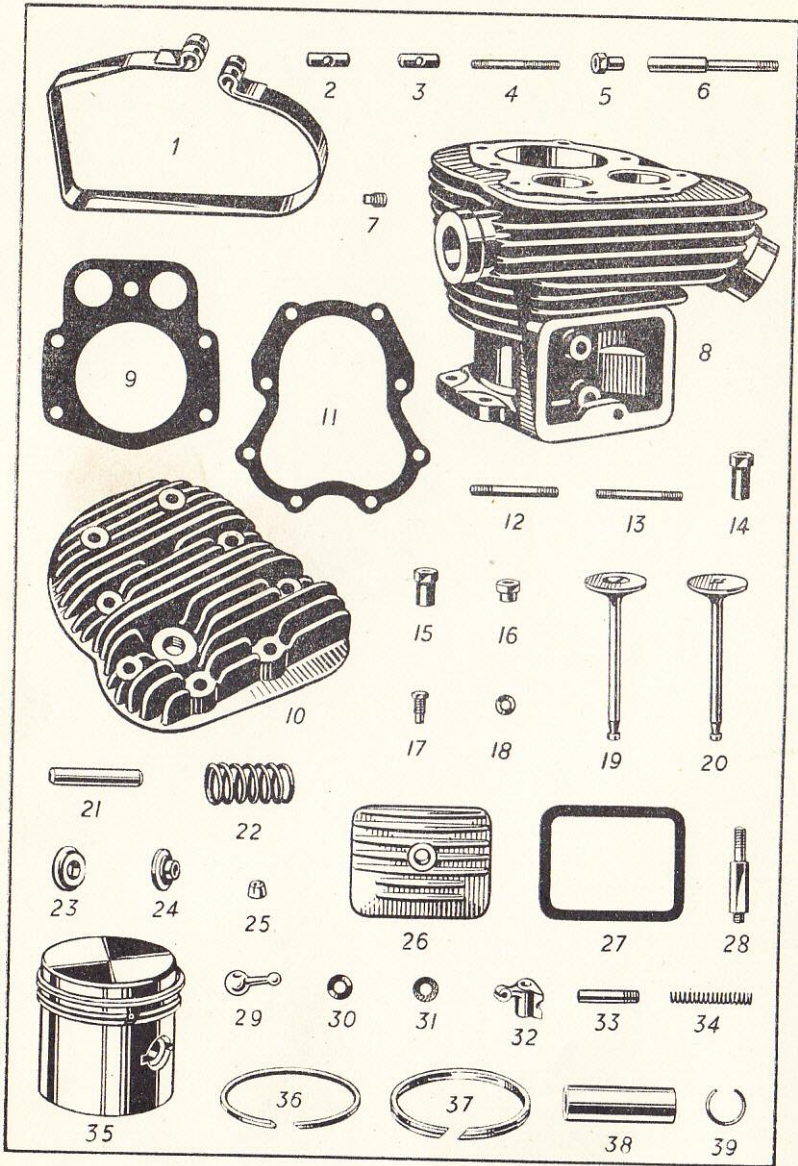

See opposite page for description and price.

THE ROYAL ENFIELD 350c.c. SIDE VALVE MODEL WD/C.

ROYAL ENFIELD ENGINE—Contd.

Illus. No.	No. of part.	Description.	No. per set	M.T. or Proprietary No.	£	s.	d.
	37011	Connecting rod and crankpin assembly	1	2	5	0
1	33046 with bushes	1	1	4	6
2	22029 small end bush	1	0	2	3
3	10051 large end bush	1	Not serviced	0	6	6
4	19885 floating bush	1	0	7	6
5	24593	Crank pin	1	0	10	0
6	27082 nut	2	0	0	6
7	16476 keeper screw	2	0	0	2
8	26707 thrust washer	2	0	1	0
9	26901	Driving shaft	1	0	7	0
10	141545 nut	1	0	0	6
11	145633 key (flywheel)	1	0	0	3
12	26705	Timing shaft	1	0	7	6
	141545 nut (as illus. 10)	1	0	0	6
13	16576 key (flywheel)	1	0	0	2
14	26703 oil release plug	1	0	0	3
15	26704 " " " " " " spring	1	0	0	1
16	$\frac{5}{16}$ " dia. " " " " " " ball	1	MT7/168	0	0	1
17	8718	Keeper screw for shaft nuts	2	0	0	1
18	24747	Flywheel (timing side)	1	1	2	0
	27244 (driving side)	1	1	2	0
19	24284	Oil pump worm	1	0	1	0
20	16704 " " " " plug	1	0	0	2
21	26328 spindle	1	0	7	6
22	13904 disc (feed)	1	0	2	9
23	27452 (return)	1	0	2	9
24	7326 spring	2	0	0	2
25	13906 plunger (feed)	1	0	1	0
26	14461 (return)	1	0	1	0
27	14456 cover	2	0	0	3
28	14786 washer	2	0	0	1
29	27196 screw	12	0	0	1
30	24297 feed plug	1	0	0	3
31	24177 washer	1	0	0	1
32	27312 pipe to cylinder barrel complete	1	0	2	0
33	22213 union and nut	3	0	0	3
34	22212 nipple	3	0	0	2
35	23868	Induction pipe	1	0	1	6
36	8701 lock nut	1	0	1	0
37	27172	Engine sprocket 18 T.	1	0	7	6
38	28330 nut	1	0	0	6
	145633 key (as illus. 11)	1	0	0	3

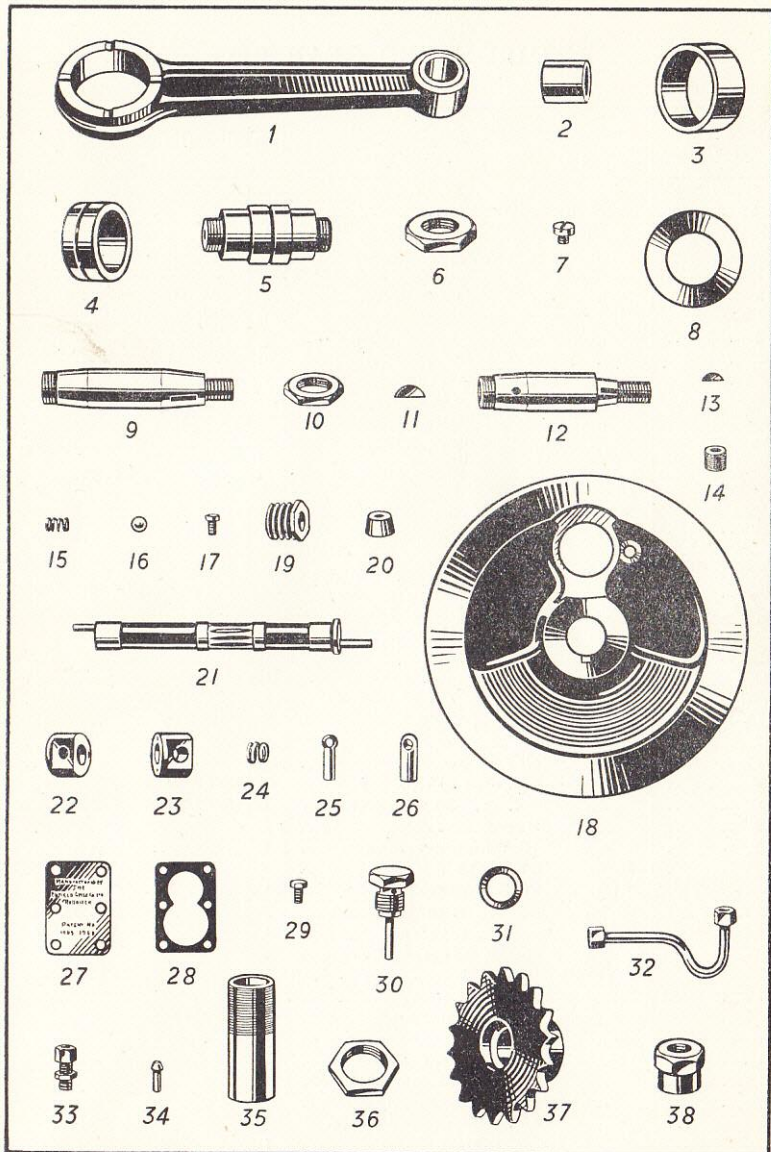

See opposite page for description and price.

THE ROYAL ENFIELD 350c.c. SIDE VALVE MODEL WD/C.

FOUR-SPEED GEAR BOX

Illus. No.	No. of part.	Description.	No. per set	M.T. or Proprietary No.	£	s.	d.
	27357	Gearbox complete	1		8	10	0
1	26625	cover	1		1	7	6
2	H60	" " $\frac{3}{16}$ " pin	2		0	0	3
3	HJ54A	" " $\frac{1}{4}$ " bolt, $2\frac{1}{4}$ " long	1		0	0	4
4	HJ54B	" " " $2\frac{3}{32}$ " "	2		0	0	4
5	HJ54C	" " " " 1" "	1		0	0	4
6	HJ2	case	1		1	7	6
7	F13	felt washer	1		0	0	4
8	F14	dished washer	1		0	0	4
9	12238	attachment stud, (top, $\frac{1}{2}$ " dia.)	1		0	0	6
10	7598	" " $\frac{1}{2}$ " nut	2		0	0	3
11	15511	" " locking collar	2		0	0	3
12	25333	" " distance piece	1		0	0	9
13	25185	" " (bottom, $\frac{5}{8}$ " dia.)	1		0	0	6
14	8350	" " $\frac{5}{8}$ " nut	2		0	0	4
15	8351	" " " washer	1		0	0	1
16	25334	" " distance piece	1		0	0	9
17	23619	adjusting pin	1		0	0	3
18	25197	" " " trunnion	1		0	1	0
19	26997	" " " $\frac{5}{16}$ " locknut	1		0	0	2
20	E140	oil filler plug	1		0	0	6
21	HJ7	Mainshaft	1		1	7	6
22	HJ71	oil thrower	1		0	1	6
23	F15	ball race $2\frac{1}{4}$ " \times 1" \times $\frac{5}{8}$ "	1	MT7/6019	0	10	9
24	F16	" " $35 \times 15 \times 11$ mm.	1	MT7/6069	0	7	9
25	HJ8	sleeve	1		1	0	0
26	HJ9	15 T high gear pinion	1		0	7	9
27	HJ11	21 T \times 18 T sliding gear	1		1	2	0
28	HJ12	26 T. low gear pinion	1		0	12	6
29	HJ55	nut (R.H. thread)	1		0	0	6
30	HJ56	" (L.H. thread)	1		0	0	6
31	HJ57	spring washer	1		0	0	2
32	HJ13	Layshaft	1		0	17	6
33	HJ14	bush (case end)	1		0	2	6
34	HJ15	" (footstart end)	1		0	2	6
35	HJ15A	washer	1		0	0	4
36	HJ17	16 T. low gear pinion	1		0	9	6
37	HJ18	21 T. second gear pinion	1		0	17	6
38	HJ19	24 T. third gear pinion	1		0	18	6
39	HJ20	27 T. high gear and footstart wheel	1		0	17	8

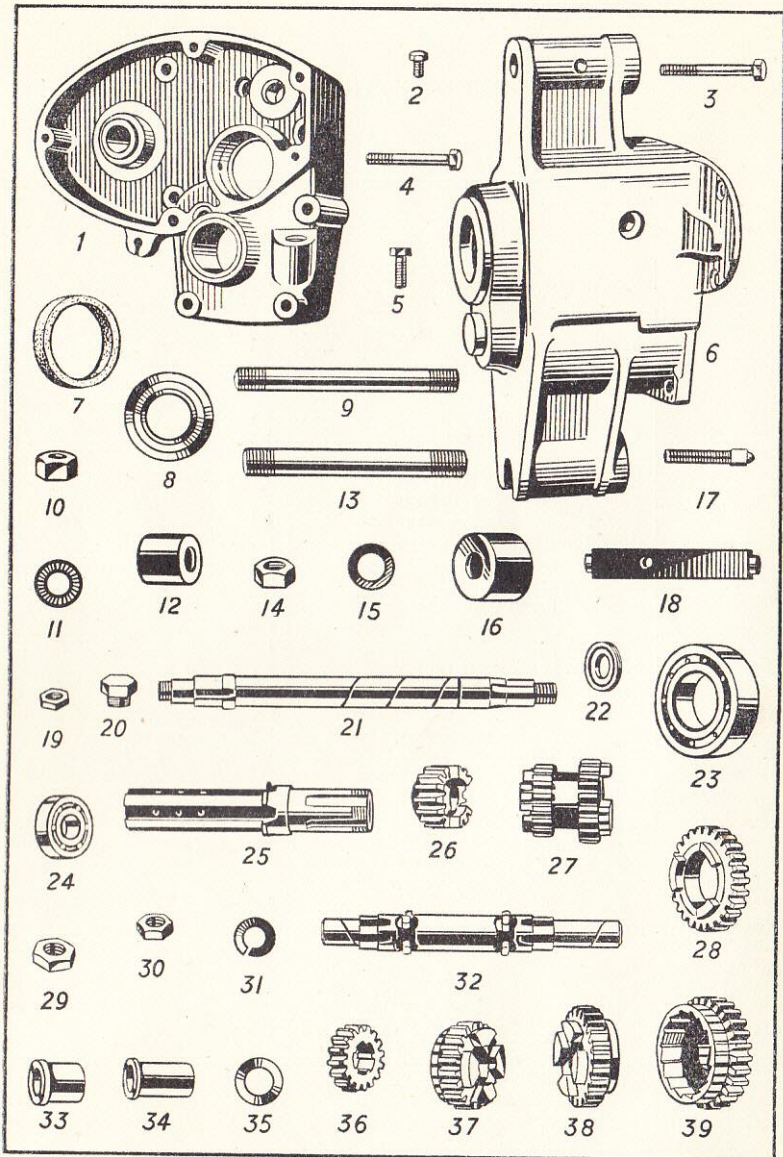

See opposite page for description and price.

THE ROYAL ENFIELD 350c.c. SIDE VALVE MODEL WD/C.

FOUR-SPEED GEAR BOX—Contd.

Illus. No.	No. of part.	Description.	No. per set	M.T. or Proprietary No.	£	s.	d.
1	HJ21	Footstarter sleeve	1	0	17	6
2	HJ22 pawl	1	0	2	6
3	HJ22A plunger	1	0	0	6
4	HJ23 " " spring	1	0	0	4
5	HJ25 " " stop plate	1	0	1	3
6	HJ26 " " " locating pin	1	0	0	3
7	HJ27 shaft bush	1	0	4	0
8	E137 return spring	1	0	1	3
9	E138 " " cover	1	0	2	3
10	G42 crank	1	0	7	6
11	G43 " " cotter pin, nut and washer	1	0	0	6
12	HJ33	Operator (inside)	1	0	5	6
13	HJ34 fork	1	0	4	6
14	HJ36 anchor pin	2	0	0	6
15	HJ32 locating plunger	1	0	0	8
16	HJ63 " " spring	1	0	0	4
17	HJ61 " " " " box	1	0	1	6
18	E133	Final drive sprocket 18 T.	1	0	9	6
19	F146 " " nut	1	0	1	6
20	H51 " " locking screw	1	0	0	1
21	HJ53 " " distance collar	1	0	1	0
22	HJFC/1A35	Foot control cover	1	0	12	6
23	FC57/HJ/L " " pin 2 $\frac{3}{8}$ " long	1	0	0	4
24	FC57/HJ/S " " " " 9"	1	0	0	3
25	FC1/35 " " ratchet (male)	1	0	4	6
26	FC4/34 " " (female)	1	0	3	6
27	FC/44 " " operating pin	1	0	0	6
28	FC/55 " " " " bush	1	0	0	3
29	FC/51 " " " " spring	1	0	0	6
30	FC/41 " " adjuster plate	1	0	2	6
31	FC/43 " " " " pin	2	0	0	6
32	FC/58 " " " " bush	2	0	0	2
33	H113 " " " " nut	2	0	0	1
34	FC/45 " " " " spring stop	1	0	1	2

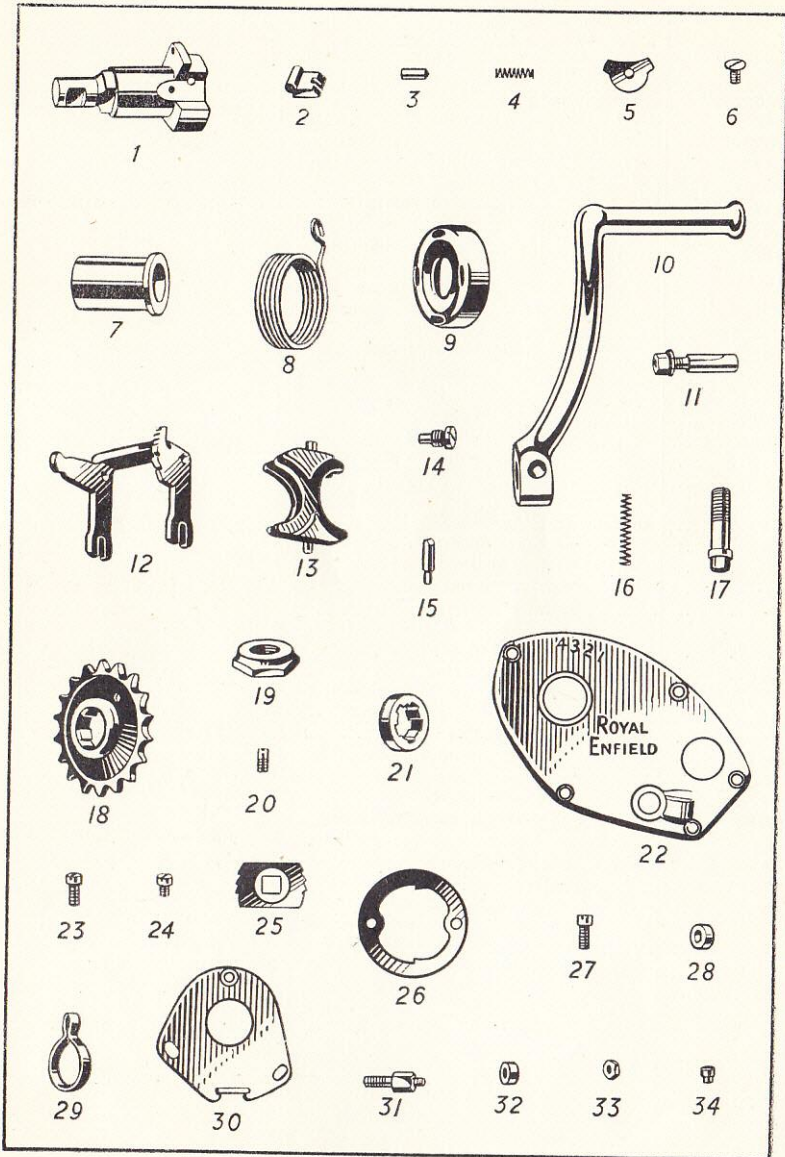

See opposite page for description and price.

THE ROYAL ENFIELD 350c.c. SIDE VALVE MODEL WD/C.

FOUR-SPEED GEAR BOX (Contd.) AND CLUTCH

Illus. No.	No. of part.	Description.	No. per set	M.T. or Proprietary No.	£	s.	d.
1	FC/53	Foot control plate	1		0	2	0
2	FC/46	" " " " spring stop .. .	1		0	0	4
3	FC/55	" " " " " " bush .. .	1		0	0	2
4	FC/42	" " stop plate and spring retainer	1		0	2	6
5	FC/47	" " operator shaft with lever	1		0	4	6
6	FC/50	" " " " " " bush .. .	1		0	2	0
7	FC/24	" " " " " " securing pin	1		0	0	6
8	FC/7	" " " " " " recessed washer	1		0	0	6
9	FC/56	" " gear indicator	1		0	0	8
10	FC/48	" " lever (short, inside) .. .	1		0	4	0
11	FC/52	" " " " return spring .. .	1		0	1	0
12	FC/30	" " " " " "	1		0	5	6
13	27081	" " " " rubber	1		0	1	3
14	FC/30A	" " " " clip bolt	1		0	0	2
15	FC/49	" " " " fulcrum pin .. .	1		0	1	0
16	PZ6	" " " " grease nipple .. .	1		0	0	3
	28105	Clutch assembly	1		3	10	0
17	27535	" " sprocket and drum assembly	1		2	10	0
18	H81	" " drum	1		0	8	6
19	H82-FDA C10	" " ferodo disc	2		0	4	0
		" " " " rivet, price per set .. .	5		0	0	6
20	G74	" " ball cage	2		0	3	0
21	G68/3	" " ring	1		0	0	5
	G66	" " retaining rivet, price per set .. .	15		0	0	4
	G76	" " balls, " " " " .. .	54	MT7/162	0	1	3
22	G68/123 ..	" " centre drum and back plate assembly	1		1	7	6
23	H89	" " plate with inserts	3		0	3	6
24	G67/F1 .. .	" " ferodo insert, price per doz.	72	Not serviced	0	2	6
25	G72	" " stud distance tube	3		0	0	4
26	G69	" " centre	1		0	12	6
27	G70	" " " " cush rubber (large) price per set .. .	3		0	1	9
28	G70A	" " " " " " (small) price per set .. .	3		0	1	9
29	G71	" " " " " " retaining ring	1		0	2	9
30	G78	" " spring	3		0	0	4
31	G80	" " screw	3		0	0	3
32	G77	" " front plate	1		0	6	0
33	G75	" " intermediate plate (flat)	1		0	4	0
34	G75A	" " " " (dished)	2		0	4	0
35	G79	" " cap	1		0	3	0
36	HJ66A	" " operating rod	1		0	0	10
37	HJ66B	" " pad	1		0	0	6
38	E141	" " lever	1		0	2	9
39	E142	" " " " adjusting screw and nut .. .	1		0	0	6
40	E143	" " " " cotter	1		0	0	4

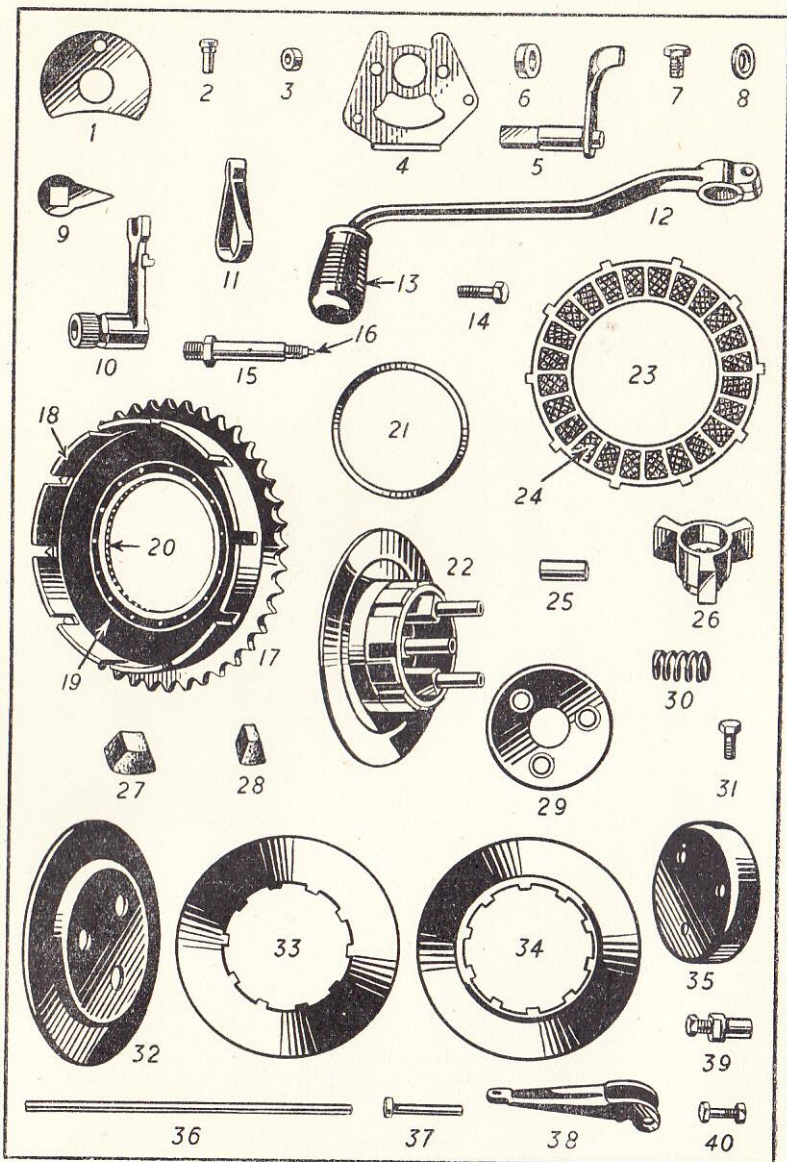

See opposite page for description and price.

THE ROYAL ENFIELD 350c.c. SIDE VALVE MODEL WD/C.

HANDLEBAR AND CONTROLS

Illus. No.	No. of part.	Description.	No. per set	M.T. or Proprietary No.	£	s.	d.
1	106/320B	Handlebar bend	1		0	18	0
2	27408	lug	2		0	6	0
3	28290	" " $\frac{3}{8}$ " pin	2		0	0	3
4	8712	" " $\frac{3}{8}$ " nut	2		0	0	2
5	27918	" " $\frac{3}{8}$ " Shakeproof washer	2	MT5/9724	0	0	1
6	15632	" " $\frac{5}{16}$ " pin	4		0	0	2
7	16/069	dummy grip	1		0	1	9
	18/455	Clutch lever complete	1		0	7	0
8	18/130	" " only	1		0	4	0
9	18/234	" " bracket	1		0	4	0
10	12/040	" " clamp	1		0	0	8
11	18/300	" " screw	2		0	0	4
12	18/087	" " fulcrum pin	1		0	0	4
13	18/053	" " " " nut	1		0	0	4
	18/453	Exhaust lever complete	1		0	4	0
14	18/162	" " only	1		0	1	9
15	18/161	" " bracket	1		0	1	6
	12/040	" " clamp (as illus. 10)	1		0	0	8
	18/300	" " screw (as illus. 11)	2		0	0	4
16	11/014	" " fulcrum pin	1		0	0	4
17	18/060	" " " " nut	1		0	0	4
	12/131	Magneto control complete	1		0	7	0
18	12/017	" " lever only	1		0	3	0
19	12/004-19-28	" " body and clips	1		0	4	0
20	12/022	" " clip screw	1		0	0	4
21	12/029	" " bolt	1		0	0	4
22	12/031	" " cap	1		0	0	6
23	12/033	" " spring washer	1		0	0	2
	16/117	Throttle twist grip complete	1		0	8	6
24	16/014-54	" " sleeve and rotor	1		0	4	0
25	16/070	" " rubber	1		0	1	3
26	16/060	" " body, top half	1		0	3	9
27	16/061	" " " " bottom half	1		0	3	9
28	11/013	" " " " screw	1		0	0	4
29	16/011	" " cable stop	1		0	0	6
30	16/009	" " fulcrum screw	1		0	0	6
31	16/010	" " " " nut	1		0	0	2
32	16/008	" " " " spring	1		0	0	8
	18/455	Front brake lever complete	1		0	7	0
	18/130	" " only (as illus. 8)	1		0	4	0
	18/234	" " bracket (as illus. 9)	1		0	4	0
	12/040	" " clamp (as illus. 10)	1		0	0	8
	18/300	" " screw (as illus. 11)	2		0	0	4
	18/087	" " fulcrum pin (as illus. 12)	1		0	0	4
	18/053	" " fulcrum pin nut (as illus. 13)	1		0	0	4

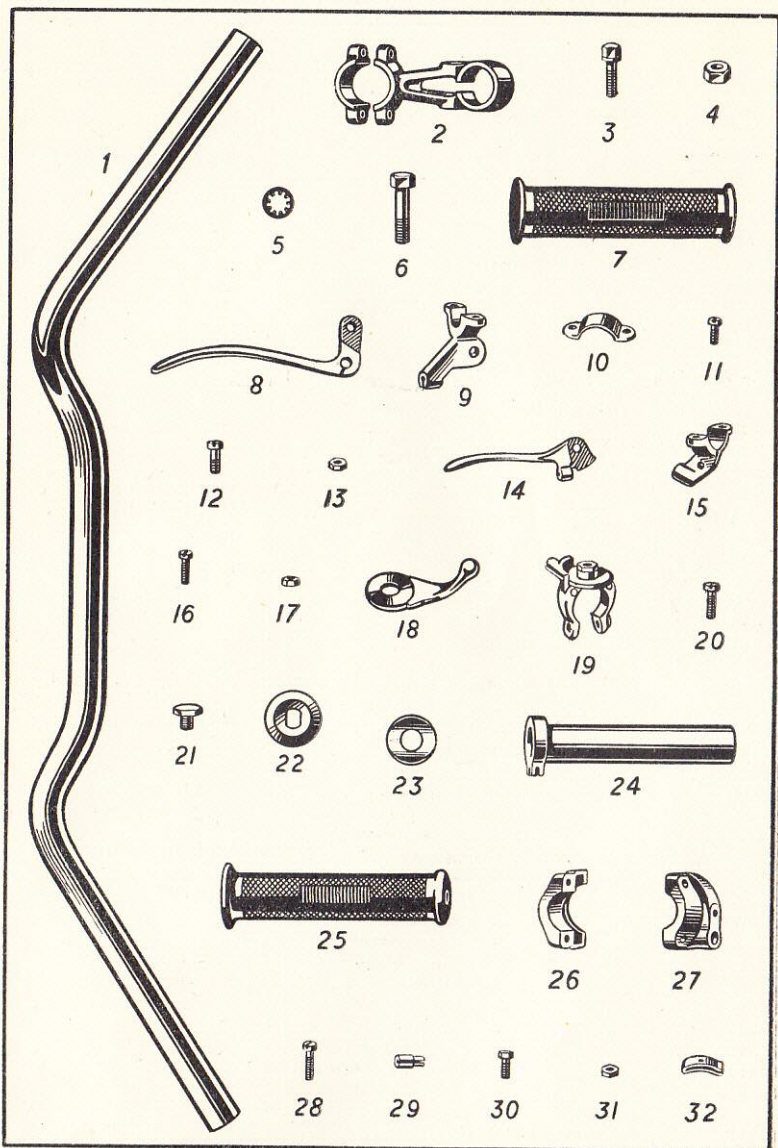

See opposite page for description and price.

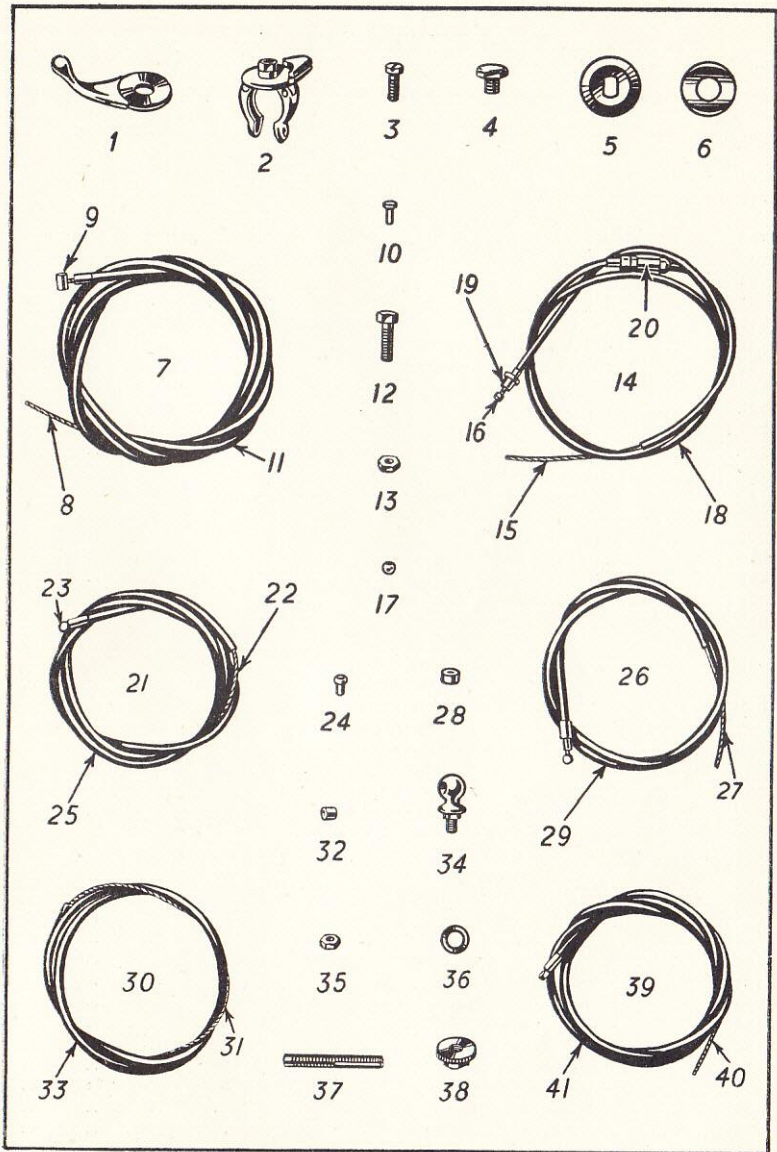

See opposite page for description and price.

THE ROYAL ENFIELD 350c.c. SIDE VALVE MODEL WD/C.

FRONT FORK

Illus. No.	No. of part.	Description.	No. per set	M.T. or Proprietary No.	£	s.	d.
	28370	Front fork assembly (fully brazed) with steering damper	1	6	4	0
1	28203	Front fork girder (fully brazed)	1	3	10	0
2	20745	Spring	1	0	5	6
3	28761	pin	1	0	0	3
4	26995 3/8" nut	1	0	0	2
5	27918 3/8" Shakeproof washer	1	MT5/9724	0	0	1
6	26734	Top link with bushes	1	0	7	6
7	19120	Bottom link (R.H. thread)	1	0	3	6
8	19121 (L.H. thread)	1	0	3	6
9	28708	Swivel pin (top)	1	0	1	0
10	26766 (bottom)	1	0	1	0
11	26764 (crown)	1	0	1	6
12	26763 (ball head clip)	1	0	1	0
13	7732 nut (R.H. thread, 1/2" thick)	3	0	0	2
	7733 (L.H.)	2	0	0	2
14	26078 (R.H.)	1	0	0	2
	26079 (L.H.)	1	0	0	2
15	26744 bush	8	0	0	6
16	26770	Shock absorber friction disc	2	0	0	3
17	26052 spring	2	0	1	3
18	26769 anchor plate	2	0	0	9
19	26048 adjusting knob (R.H. thread)	1	0	2	0
	26049 adjusting knob (L.H. thread)	1	0	2	0
20	22900 adjusting knob plunger	2	0	0	2
21	26196 adjusting knob plunger spring	2	0	0	1
22	27331	Steering stem and crown with bushes	1	0	17	6
23	19122	Crown distance washer	2	0	0	2
24	20632 rubber buffer	2	0	0	8
25	27247	Ball head clip	1	0	12	6
26	26745 bolt	1	0	0	3
27	26168 nut	1	0	0	2
28	26746 sleeve	1	0	0	2
29	15436 locknut	1	0	1	0
30	27248 race (head clip)	1	0	1	6
31	27249 (crown)	1	0	1	0
32	26454 (frame)	2	0	1	6
	1/4" dia.	Balls, price per doz.	38	MT7/165	0	0	2
33	PZ6	Grease nipple (straight)	6	MT1/TT/P6/1/4"B.S.F.	0	0	3
34	27069	Lamp bracket (top)	2	0	0	6
35	25003 (bottom)	2	0	0	6
36	251 1/2" pin, 1/2" long	4	0	0	2
37	26998 nut	4	0	0	1
38	27916 Shakeproof washer	4	MT5/24861	0	0	1

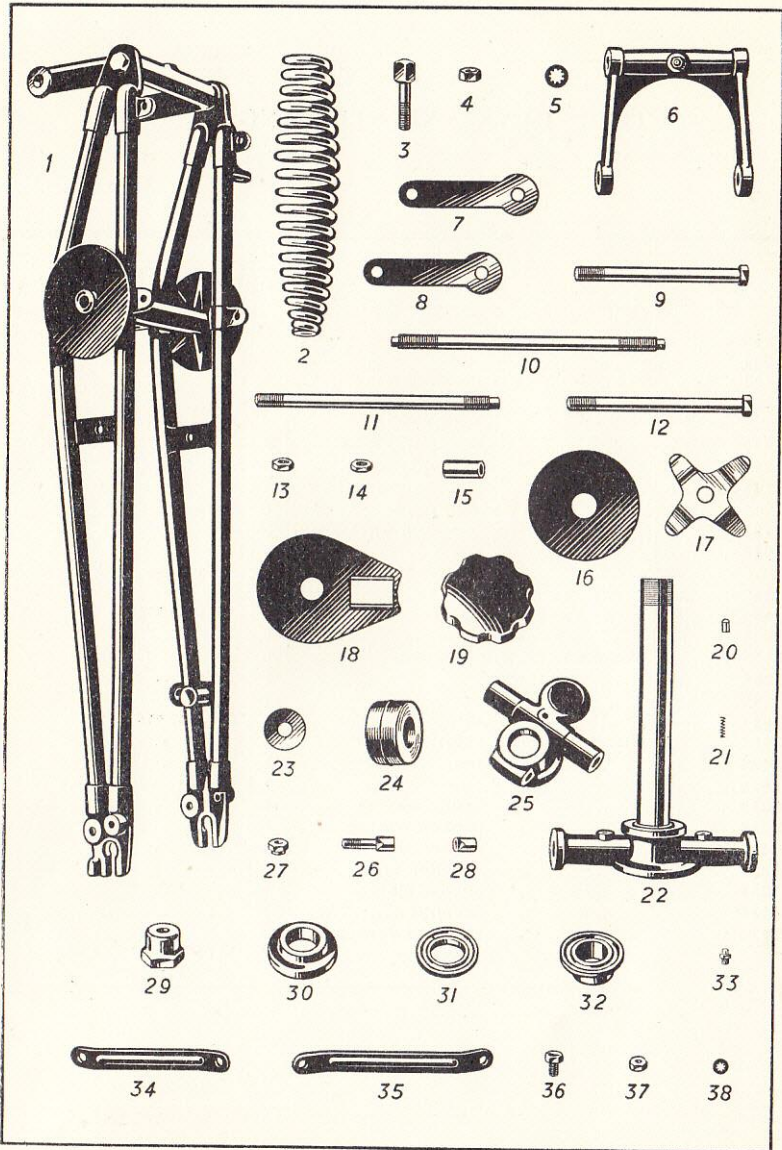

See opposite page for description and price.

THE ROYAL ENFIELD 350.cc. SIDE VALVE MODEL WD/C.

PETROL TANK AND STEERING DAMPER

Illus. No.	No. of part.	Description.	No. per set	M.T. or Proprietary No.	£	s.	d.
1	27246 ..	Petrol tank, bare	1	4	8	0
2	15941 ..	" " filler cap	1	0	2	9
3	23717 ..	" " attachment pin ..	4	0	0	2
4	5025 ..	" " " " " " " " washer ..	4	MT5/9725	0	0	1
5	28346 ..	" " rubber buffer	8	0	0	2
6	27394A ..	" " attachment bracket ..	2	0	2	0
7	10745 ..	" " " " " " " " bolt ..	1	0	0	3
8	26995 ..	" " attachment bracket ..	1	0	0	2
9	27918 ..	" " " " " " " " Shakeproof washer ..	1	MT5/9724	0	0	1
10	26512 ..	" " tap	2	0	2	9
11	5662 ..	" " fibre washer	2	MT1/18634	0	0	1
12	28988 ..	" " pipe complete	1	0	5	0
13	23095 ..	Knee grip (R.H.) with plate ..	1	0	5	0
14	23096 ..	" " (L.H.) " "	1	0	5	0
15	24145 ..	" " " " " " " " pin	2	0	0	2
16	27917 ..	" " " " " " " " Shakeproof washer ..	2	MT5/15414	0	0	1
17	23731 ..	Steering damper adjusting knob ..	1	0	3	0
18	15439 ..	" " rod	1	0	0	6
19	15438 ..	" " centre	1	0	2	0
20	15252 ..	" " spring washer	1	0	0	6
21	15248 ..	" " friction washer	1	0	0	6
22	15437 ..	" " anchor plate	1	0	0	6
23	15249 ..	" " coupling plate	1	0	0	6
24	251 ..	" " anchor plate 1/4" pin ..	1	0	0	2
25	4281 ..	" " coupling " " " " ..	1	0	0	2
26	27916 ..	" " plate pin Shakeproof washer	2	MT5/24861	0	0	1

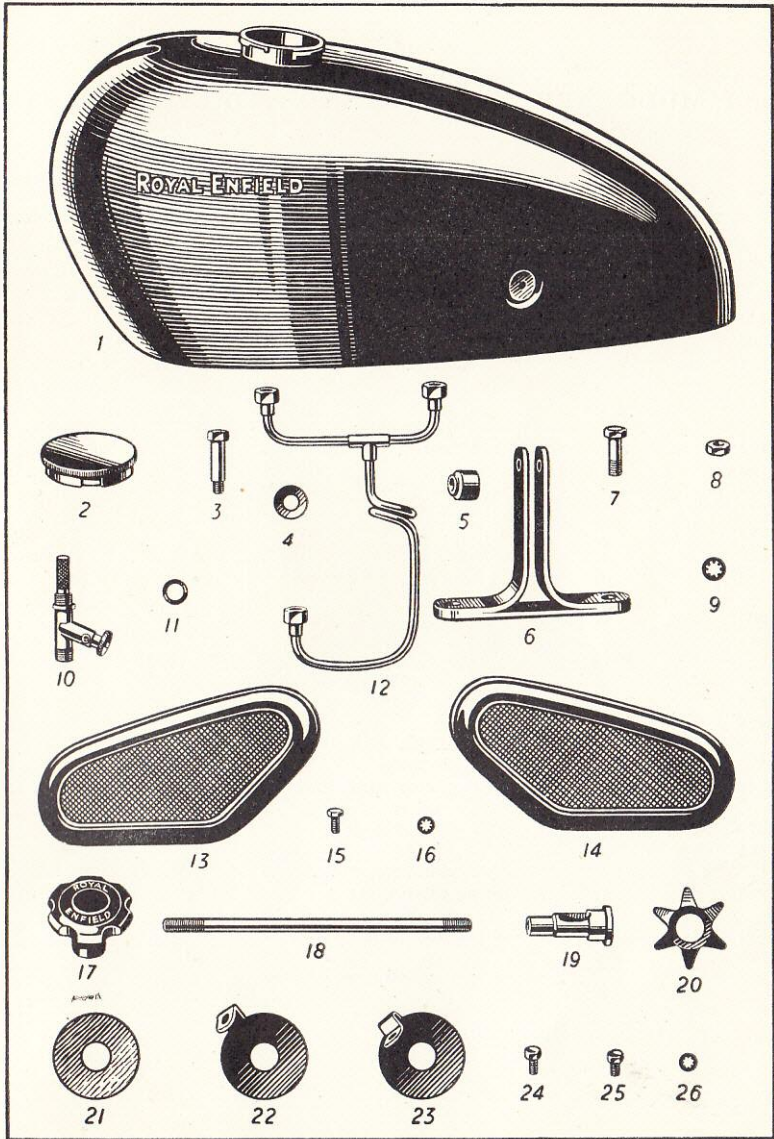

See opposite page for description and price.

THE ROYAL ENFIELD 350c.c. SIDE VALVE MODEL WD/C.

FRONT MUDGUARD, FRONT STAND AND CENTRAL STAND

Illus. No.	No. of part.	Description.	No. per set	M.T. or Proprietary No.	l. s. d.
1	27461	Front mudguard only	1	0 13 9
2	28084	" " stay	1	0 1 6
3	251	" " " 1" pin, 1/2" long	5	0 0 2
4	252	" " " " " 3/4" "	1	0 0 2
5	14791	" " " " " " distance piece	1	0 0 2
6	26998	" " " 1/2" nut	2	0 0 1
7	27460	stand	1	0 7 6
8	20192	" " pivot pin	2	0 0 2
9	15771	" " " " locknut	2	0 0 2
10	15641	" " " " washer	2	0 0 1
11	21914	" " clip stud	1	0 0 6
12	6148	" " " " 5/16" shouldered nut	1	0 0 2
13	27001	" " " " 5/16" locknut	1	0 0 2
14	27917	" " " " 5/16" Shakeproof washer	1	MT5/15414	0 0 1
15	6198	" " " " split ring	1	0 0 1
16	27198	Central stand	1	0 10 6
17	25578	" " spring	2	0 0 9
18	27342	" " " catch with stud (R.H.)	1	0 0 9
19	27343	" " " catch with stud (L.H.)	1	0 0 9
20	27274	" " " catch pivot	2	0 0 2
	26998	" " " " " 1/4" locknut (as illus. 6)	4	0 0 1
21	5916	" " " spring catch pivot	2	0 0 1
	27051	" " " 1/2" washer	2	0 0 1
22	26998	" " " spring post	2	0 0 1
		" " " 1/2" nut (as illus. 6)	2	0 0 1

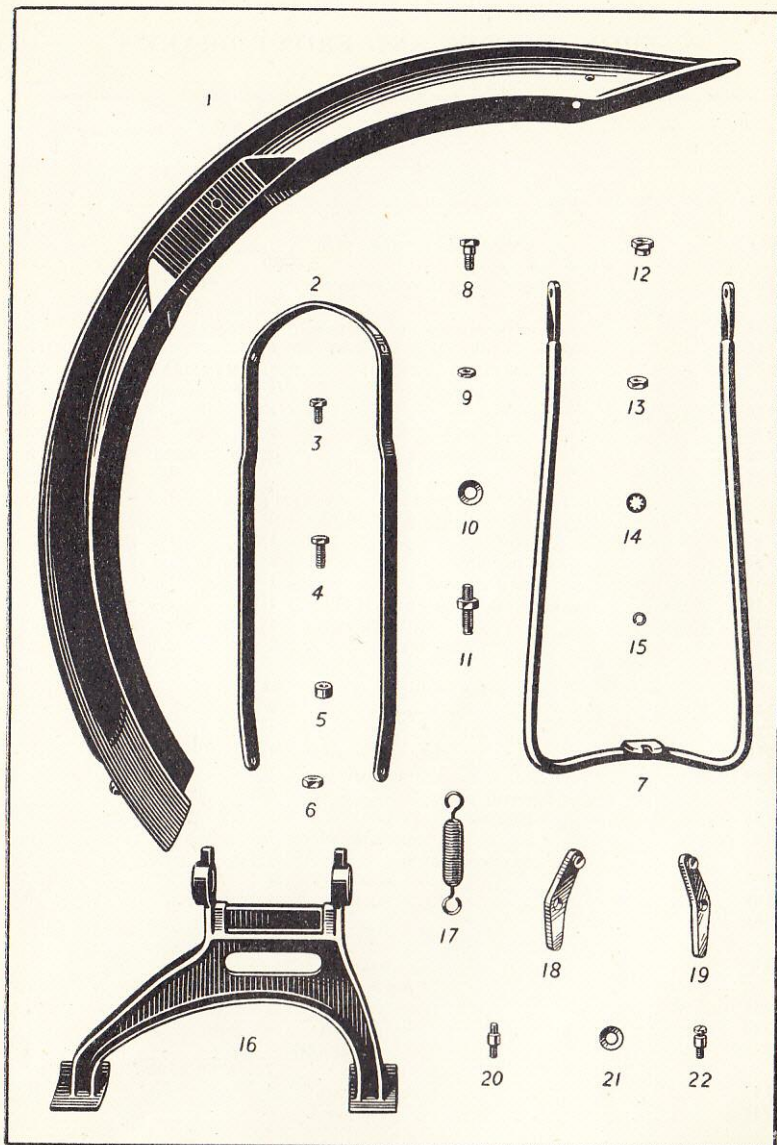

See opposite page for description and price.

THE ROYAL ENFIELD 350c.c. SIDE VALVE MODEL WD/C.

FRONT WHEEL AND FRONT BRAKE

Illus. No.	No. of part.	Description.	No. per set	M.T. or Proprietary No.	£	s.	d.
1	28372	Front wheel with hub brake, less tyre	1	4	0	0
2	15954	" " rim	1	0	11	0
3	28658	" " spokes 7 $\frac{9}{16}$ " long, price per set	20	0	2	0
4	28661	" " spokes 8 $\frac{3}{8}$ " long, price per set	20	0	2	0
	16021	" " spoke nipples, price per set	40	0	1	9
5	28718	hub with lubricator	1	0	12	6
6	27332	" " lubricator	1	MT1/17308	0	0	4
7	27190	" " brake drum	1	Not serviced	0	9	0
8	11940	" " spindle	1	0	2	9
9	28070	" " nut	2	0	0	6
10	16562	" " journal bearing	2	MT7/6063	0	9	3
11	11936	" " distance washer	1	0	0	1
12	11937	" " journal bearing retaining nut	1	0	0	3
13	9838	" " oil retainer	2	0	0	2
14	21930	" " dust excluder	1	0	0	4
15	27449A	brake shoe with lining (R.H.)	1	0	5	0
	27449B	" " " " (L.H.)	1	0	5	0
16	26835	" " lining (each)	2	0	2	0
17	9526	" " rivet, price per doz.	12	0	0	6
18	27347	" " return spring	2	0	0	6
19	27276	" " pin	1	0	0	3
20	20018	" " distance washer	1	0	0	1
21	10314	" " $\frac{7}{16}$ " locknut	1	0	0	2
22	28124	" " cover plate	1	0	2	0
23	28125	" " torque	1	0	2	6
24	28127	" " distance piece	1	0	0	4
25	27067	" " operating cam	1	0	2	6
26	27407	" " washer	1	0	0	2
27	28126	" " bush	1	0	2	0
28	26309	" " $\frac{1}{4}$ " pin	2	0	0	2
29	7916	" " bush	2	0	0	1
		$\frac{1}{4}$ " pin nut	2	0	0	1
30	27346	" " lever	1	0	0	9
31	10314	" " $\frac{7}{16}$ " nut	1	0	0	2
32	27919	" " $\frac{7}{16}$ " Shake-proof washer	1	MT5/9705	0	0	1
		lever knuckle	1	0	0	3
33	13745	" " connec- tion pin	1	0	0	1
34	13746	" " anchor plate	1	0	0	9
35	27275	" " $\frac{7}{16}$ " pin	1	0	0	2
36	28856	" " $\frac{7}{16}$ " Shakeproof washer	1	MT5/9705	0	0	1
37	27919	" " (as illus. 32).	1	0	0	1

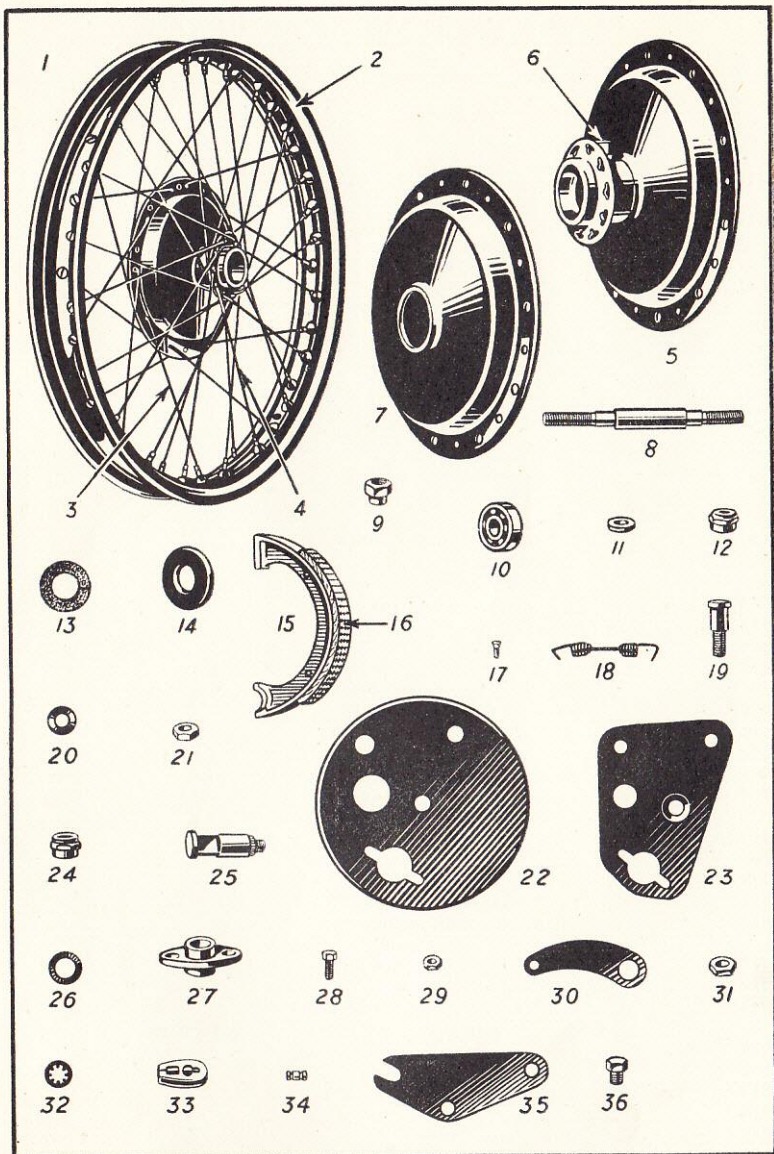

See opposite page for description and price.

THE ROYAL ENFIELD 350c.c. SIDE VALVE MODEL WD/C.

REAR WHEEL AND REAR BRAKE

Illus. No.	No. of part.	Description.	No. per set	M.T. or Proprietary No.	£	s.	d.
1	28373	Rear wheel with cush drive and brake (less tyre)	1	5	10	0
2	15954 rim	1	0	11	0
3	28660 spokes, 8" long, price per set	20	0	2	0
4	28661 " 8 $\frac{3}{4}$ " long, price per set	20	0	2	0
	16021 spoke nipples, set of 40 ..	40	0	1	9
5	27155	hub brake drum and sprocket	1	1	0	0
6	28717 with lubricator	1	0	15	0
7	27332 lubricator	1	MT1/17308	0	0	4
8	27153 spindle	1	0	3	6
9	10512 nut	2	0	0	6
10	5025 washer	2	MT5/9730	0	0	1
11	16562 journal bearing	2	MT7/6063	0	9	3
12	11936 " distance washer	1	0	0	1
13	11937 journal bearing retaining nut	1	0	0	3
14	9838 oil retainer	2	0	0	2
15	21930 dust excluder	1	0	0	4
16	16623 cush drive locking	1	0	1	3
17	27156 " stud	3	0	0	6
18	14691 " " $\frac{5}{16}$ " washer	3	0	0	1
19	26158 " " $\frac{5}{16}$ " nut	3	0	0	3
20	10467 " " rubber block	6	0	0	6
21	27690A brake shoe with lining (R.H.)	1	0	5	0
	27690B " " (L.H.)	1	0	5	0
22	26835 " " lining (each)	2	0	2	0
23	9526 " " rivet (per dz.)	12	0	0	6
24	27691 " " return spring (aluminium shoe)	2	0	0	6
25	27066 " " pin	1	0	0	4
26	20018 " " distance washer	1	0	0	1
27	3570 " " $\frac{7}{16}$ " locknut	1	0	0	2
28	27976 " " cover plate	1	0	2	0
29	27977 " " torque plate with anchor stud	1	0	3	0
30	27978 " " distance piece	1	0	0	4
31	10314 anchor stud nut	1	0	0	3
32	27919 " " $\frac{7}{16}$ " Shakeproof washer	1	MT5/9705	0	0	1
33	27086 operating cam	1	0	2	6
34	27980 " " bush	1	0	2	0
35	26309 " " " $\frac{1}{8}$ " pin	2	0	0	2
36	7916 " " " nut	2	0	0	1
37	27684 " " lever	1	0	1	6
	10314 " " $\frac{7}{16}$ " nut (as illus. 31)	1	0	0	2
	27919 " " $\frac{7}{16}$ " Shake- proof washer (as illus. 32)	1	MT5/9705	0	0	1

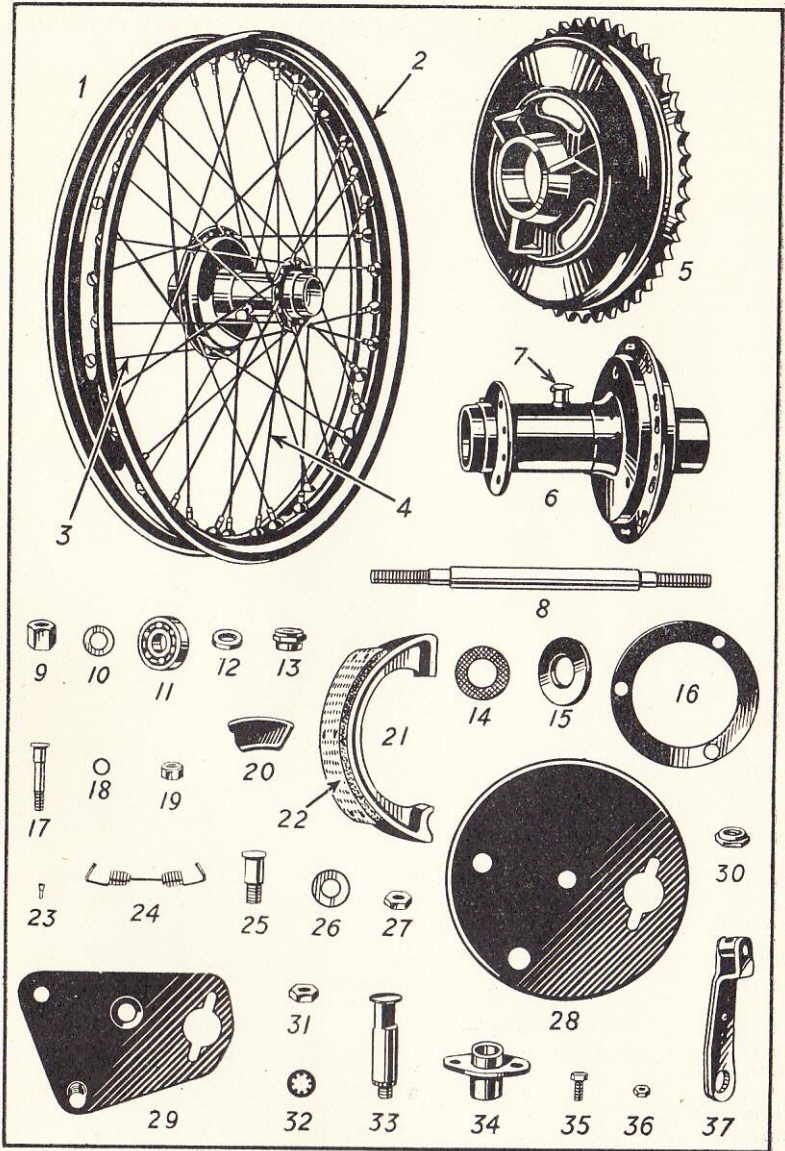

See opposite page for description and price.

THE ROYAL ENFIELD 350c.c. SIDE VALVE MODEL WD/C.

REAR BRAKE CONTROL, SILENCER AND FOOTRESTS

Illus. No.	No. of part.	Description.	No. per set	M.T. or Proprietary No.	£	s.	d.
1	25837	Rear brake foot pedal	1	0	5	6
2	25894	" " " " rubber pad	1	0	1	0
3	25973	" " " " fulcrum stud	1	0	1	0
4	26995	" " " " " " nut	2	0	0	2
5	15641	" " " " fulcrum stud	1	0	0	1
		" " " " $\frac{3}{8}$ " washer	2	0	0	1
6	252	" " " " $\frac{1}{4}$ " stop pin	1	0	0	2
7	27000	" " " " " " locknut	1	0	0	1
8	26348	" " " " return spring	1	0	0	6
9	PZ6	" " " " grease nipple	1	MT1/TT/P6/ $\frac{1}{4}$ " B.S.F.	0	0	3
10	29055	" " " " operating rod	1	0	0	9
11	14691	" " " " $\frac{5}{16}$ " washer	1	0	0	1
12	$\frac{3}{4}$ " x $\frac{1}{16}$ "	" " " " split pin	1	MT1/5654	0	0	1
13	17691	" " " " adjusting nut	1	0	0	6
14	27168	" " " " anchor link	1	0	0	9
15	27268	" " " " pin (frame)	1	0	0	2
16	26995	" " " " " " nut	1	0	0	2
17	27918	" " " " " " $\frac{3}{8}$ " Shakeproof washer	1	MT5/9724	0	0	1
18	27358	Silencer	1	1	12	6
19	12882	" " clip	1	0	1	0
20	4860	" " pin	1	0	0	2
21	12881	" " nut	1	0	0	3
22	16320	" " attachment pin	1	0	0	2
23	27918	" " " " " " $\frac{3}{8}$ " Shakeproof washer	1	MT5/9724	0	0	1
24	27341	Exhaust pipe	1	0	17	6
25	26281	" " clip (top)	1	0	2	6
26	22550	" " stud	1	0	0	2
27	7216	" " " " nut	1	0	0	2
28	$\frac{5}{16}$ " dia.	" " " " spring washer	1	0	0	1
29	28713	" " " " (footrests)	1	0	1	6
30	7201	" " " " $\frac{1}{4}$ " pin $\frac{21}{32}$ " long	1	0	0	2
31	26998	" " " " nut	1	0	0	1
32	27916	" " " " " " Shakeproof washer	1	MT5/24861	0	0	1
33	23392	Footrest support bar	1	0	1	0
34	10315	" " " " nut	2	0	0	2
35	6740	" " " " washer	2	0	0	1
36	27366	" " " " tube $2\frac{1}{16}$ " long	1	0	0	9
37	15750	" " " " $3\frac{1}{2}$ " "	1	0	0	9
38	22723	" " " " $3\frac{9}{16}$ " "	1	0	0	9
39	25839	" " arm	2	0	2	6
40	25838	" " rubber	2	0	1	6
41	22697	" " distance washer (large)	1	0	0	2
42	22684	" " " " (small)	1	0	0	2

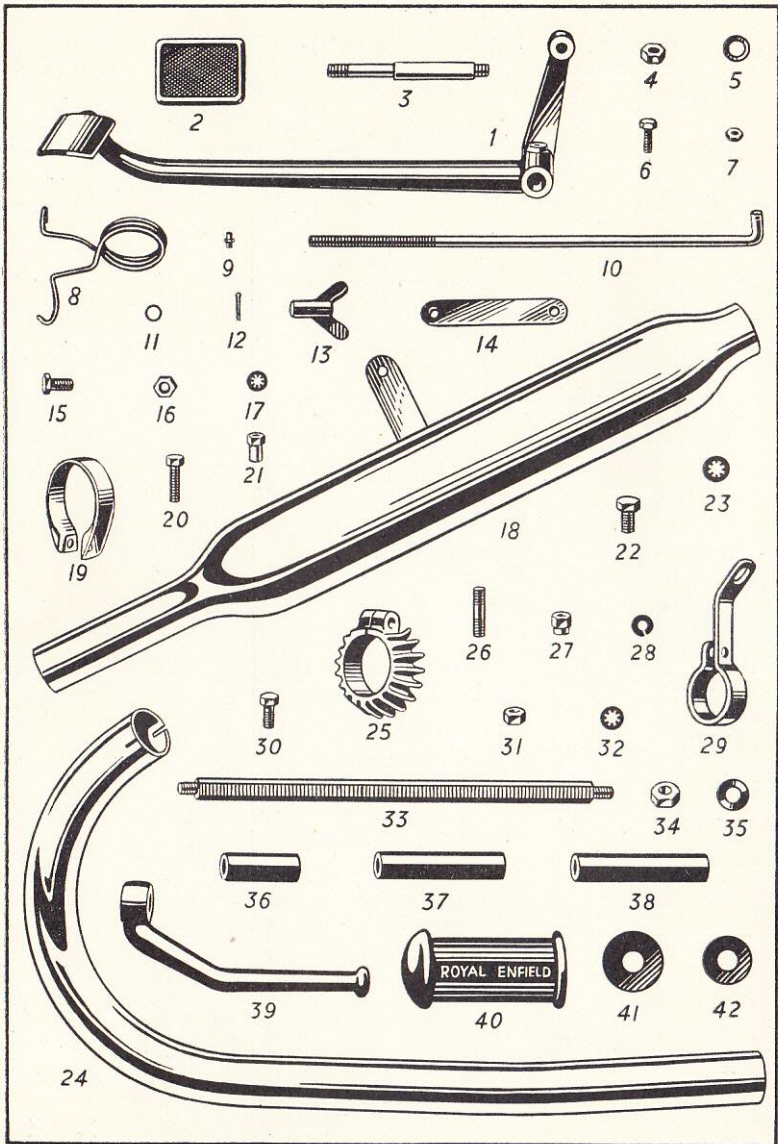

See opposite page for description and price.

THE ROYAL ENFIELD 350c.c. SIDE VALVE MODEL WD/C.

FRAME, ENGINE ATTACHMENT STUDS
AND BATTERY CARRIER

Illus. No.	No. of part.	Description.	No. per set	M.T. or Proprietary No.	£	s.	d.
	28947	Frame assembly less loose fittings, comprising Frame front 28309, Frame rear portion (R.H.) 28319 and (L.H.) 28320, connecting bolts, nuts and head races (pressed in) ..	1		9	0	0
	28309	Frame, front portion only ..	1		5	0	0
	28319	rear portion (R.H.) ..	1		2	15	0
	28320	rear portion (L.H.) ..	1		2	17	6
1	27145	engine plate ..	2		0	4	0
2	9429	backstay stud, $\frac{7}{16}$ " dia. ..	1		0	0	3
3	1898	nut ..	2		0	0	3
4	1848	washer ..	2		0	0	1
5	20121	hanger for battery and toolbox ..	1		0	2	6
6	10264	and backstay bridge stud, $\frac{3}{8}$ " dia. ..	1		0	0	3
7	26995	and backstay bridge stud nut ..	2		0	0	2
8	27918	and backstay bridge stud, $\frac{3}{8}$ " Shakeproof washer ..	2	MT5/9724	0	0	1
9	22686	stud, $\frac{1}{2}$ " dia., $2\frac{1}{2}$ " long, for cradle tubes ..	1		0	0	6
10	402	$\frac{1}{2}$ " nut ..	2		0	0	3
11	7914	washer ..	2		0	0	1
12	25958	(rear, top, $\frac{5}{8}$ " dia.) ..	1		0	0	6
13	22687	(bottom, $\frac{5}{8}$ " dia.) ..	1		0	0	9
14	8350	nut ..	4		0	0	3
15	8351	washer ..	4		0	0	1
16	25962	distance piece, $1\frac{1}{8}$ " dia., 1" long ..	1		0	0	4
17	27147	distance piece, $1\frac{1}{8}$ " long ..	1		0	0	6
18	27148	" " " " " " " " ..	1		0	0	4
19	25363	" " " " tube $3\frac{1}{2}$ " ..	1		0	1	0
20	8804	Engine attachment stud $\frac{3}{8}$ " dia., $4\frac{1}{2}$ " long ..	2		0	0	3
21	26995	" " " " nut ..	4		0	0	1
22	27918	" " " " Shakeproof washer ..	4	MT5/9724	0	0	1
23	25331	" " " " distance piece, 1" long ..	2		0	0	6
24	28399	lug stud (front) $\frac{9}{16}$ " dia., $5\frac{3}{8}$ " long ..	1		0	0	6
25	20198	" " " " nut ..	2		0	0	3
26	8426	" " " " washer ..	2		0	0	1
27	23900	" " " " distance piece, $\frac{3}{4}$ " long ..	1		0	0	8
28	7819	Chain adjuster screw ..	2		0	0	4
29	26998	" " " " $\frac{1}{2}$ " lock nut ..	2		0	0	1
30	23446	Bracket for voltage control box ..	1		0	0	6
31	9795	screw ..	2		0	0	2
32	26998	" " " " $\frac{1}{2}$ " nut ..	2		0	0	1
33	27916	" " " " Shakeproof washer ..	2	MT5/9724	0	0	1
34	22894	Stop for front fork ..	2		0	0	6
35	27340	Battery carrier complete ..	1		0	15	0
36	SE300	" " attachment pin (long) ..	1		0	0	3
37	27298	" " " " distance piece ..	1		0	0	3
38	14445	" " " " attachment pin (short) ..	2		0	0	2
39	27001	" " " " nut ..	2		0	0	1
40	27917	" " " " $\frac{5}{16}$ " Shakeproof washer ..	2	MT5/15414	0	0	1

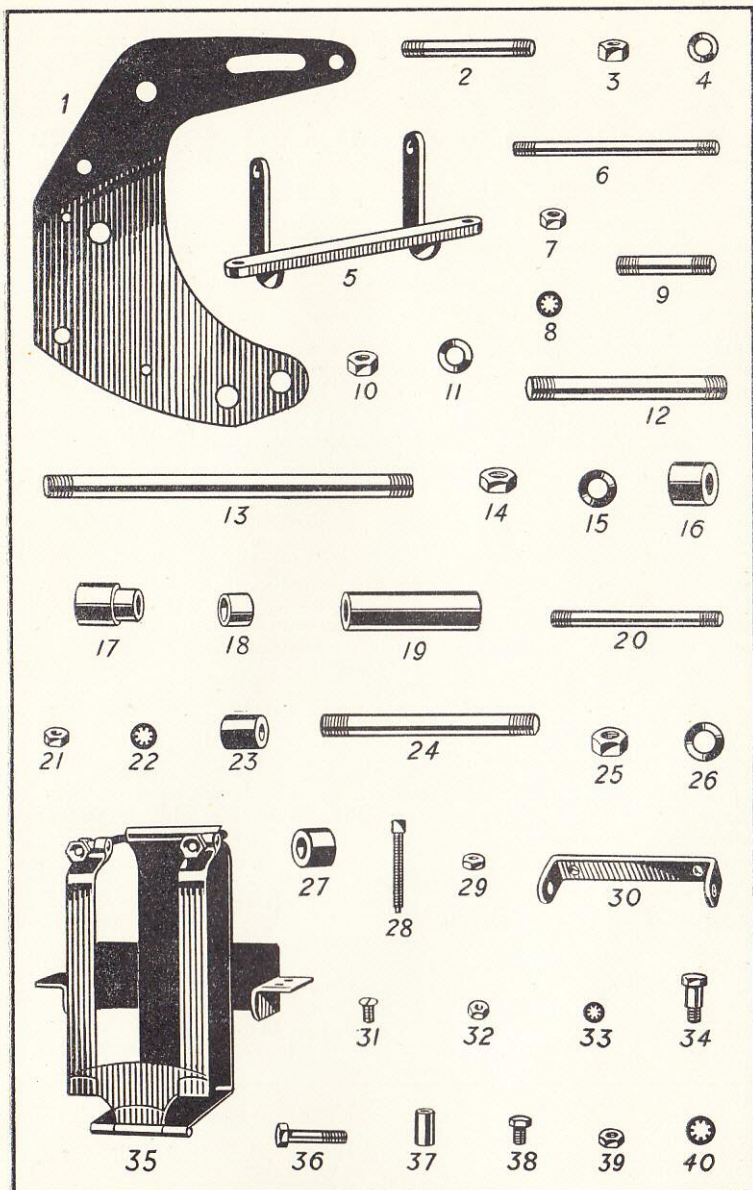

See opposite page for description and price.

THE ROYAL ENFIELD 350C.C. SIDE VALVE MODEL WD/C.

REAR MUDGUARD, CARRIER AND PROP STAND

Illus. No.	No. of part.	Description.	No. per set	M.T. or Proprietary No.	£	s.	d.
1	27291A ..	Rear mudguard (fixed half) with strap ..	1	0	6	6
2	25995A ..	" " (detachable half) ..	1	0	10	6
3	24876 ..	" " backstay strap pin (fixed half) ..	2	0	0	2
4	27001 ..	" " " " " " $\frac{5}{16}$ " nut ..	2	0	0	1
5	F193 ..	" " " " " " " " washer ..	2	0	0	1
6	14826 ..	" " " " " " " " packing collar ..	2	0	0	1
7	24878 ..	" " " " " " stud (top) ..	2	0	0	6
8	20971 ..	" " " " " " nut (shouldered) ..	2	0	0	1
9	27001 ..	" " " " " " " " (plain, $\frac{5}{16}$ " dia.) ..	2	0	0	1
10	23143 ..	" " " " " " " " (bottom) ..	2	0	0	6
11	6148 ..	" " " " " " nut ..	2	0	0	2
12	7345 ..	" " " " " " locknut ..	2	0	0	2
13	6198 ..	" " " " " " spring ring ..	2	0	0	1
14	251 ..	" " " " " " $\frac{1}{4}$ " pin, $\frac{1}{2}$ " long ..	4	0	0	2
15	26998 ..	" " " " " " nut ..	4	0	0	1
16	27916 ..	" " " " " " Shakeproof washer ..	4	MT5/24861 ..	0	0	1
17	27254 ..	Carrier complete ..	1	0	18	0
18	10218 ..	" " $\frac{1}{4}$ " pin $\frac{9}{16}$ " long ..	4	0	0	2
19	26998 ..	" " " " nut (as illus. 15) ..	4	0	0	1
19	7674 ..	" " " " plain washer ..	4	0	0	1
19	27916 ..	" " " " Shakeproof washer (as illus. 16) ..	4	MT5/24861 ..	0	0	1
20	27445 ..	Prop stand ..	1	0	8	6
21	27283 ..	" " eye bolt ..	1	0	1	6
22	3570 ..	" " " " $\frac{7}{16}$ " nut ..	1	0	0	2
23	27919 ..	" " " " Shakeproof washer ..	1	MT5/9705 ..	0	0	1
24	15253 ..	" " pivot pin ..	1	0	0	3
25	27001 ..	" " " " $\frac{5}{16}$ " lock nut ..	1	0	0	1
26	27258 ..	" " " " spring clip ..	1	0	1	0
27	252 ..	" " " " $\frac{1}{4}$ " pin $\frac{3}{4}$ " long ..	1	0	0	2
27	26998 ..	" " " " nut (as illus. 15) ..	1	0	0	1
27	27916 ..	" " " " Shakeproof washer (as illus. 16) ..	1	MT5/24861 ..	0	0	1

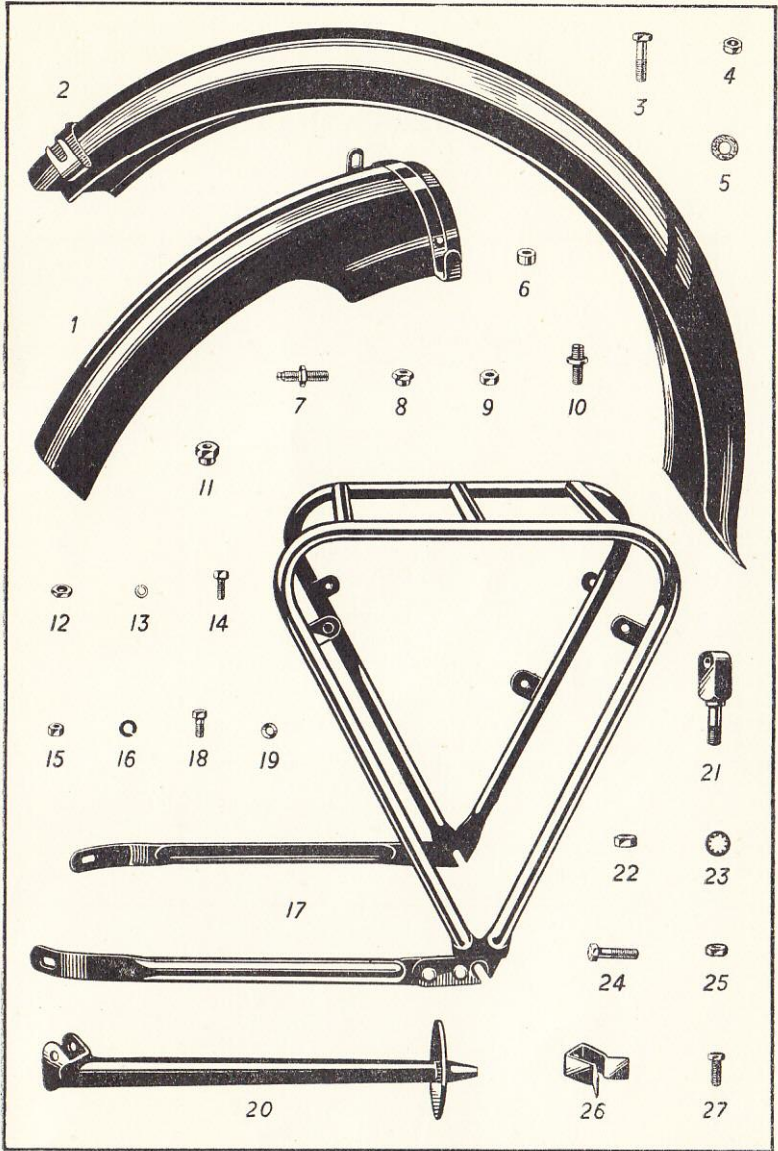

See opposite page for description and price.

THE ROYAL ENFIELD 350C.C. SIDE VALVE MODEL WD/C.

CHAIN COVERS AND CHAINS

Illus. No.	No. of part.	Description.	No. per set	M.T. or Proprietary No.	£ s. d.
	23901/2	Front chain case assembly	1		3 16 0
1	23901	" " " (inner portion)	1		1 12 0
2	23902	" " " (outer ")	1		1 15 0
3	28002	" " " drain plug	1	MT1/17302	0 0 6
4	28003	" " " washer	1	MT1/37033	0 0 2
5	26696	" " " main joint washer (rubber)	1		0 4 6
6	23940	" " " spigot washer (rubber)	1		0 1 0
7	27080	" " " inspection cover	1		0 1 0
8	22708	" " " " washer	1		0 0 3
9	22992	" " " felt washer	1		0 0 4
10	14091	" " " $\frac{5}{16}$ " attachment pin	1		0 0 2
11	22937	" " " " steel washer	1		0 0 1
12	22938	" " " " leather "	1		0 0 1
13	23941	" " " " packing collar	1		0 0 1
14	27236	" " " " locking plate	1		0 0 1
15	24084	" " " " packing collar (rear)	1		0 0 6
16	27288	Rear chainguard (top)	1		0 10 0
17	3699	" " " $\frac{5}{16}$ " pin, $\frac{3}{4}$ " long	1		0 0 3
18	12445	" " " " distance piece	1		0 0 1
19	27265	" " " " (bottom)	1		0 3 6
20	2545	" " " $\frac{5}{16}$ " pin (front, $\frac{3}{4}$ " long)	1		0 0 3
	12445	" " " " packing collar (as illus. 18)	1		0 0 1
21	12659	" " " " " (rear, $\frac{1}{2}$ " long)	1		0 0 2
22	27344	Front chain $\frac{1}{2}$ " P \times .305" W \times .335" R 103 links	1	MT11/17163	0 10 0
23	27345	Rear chain, " " " 74 "	1	MT11/10306	0 17 6

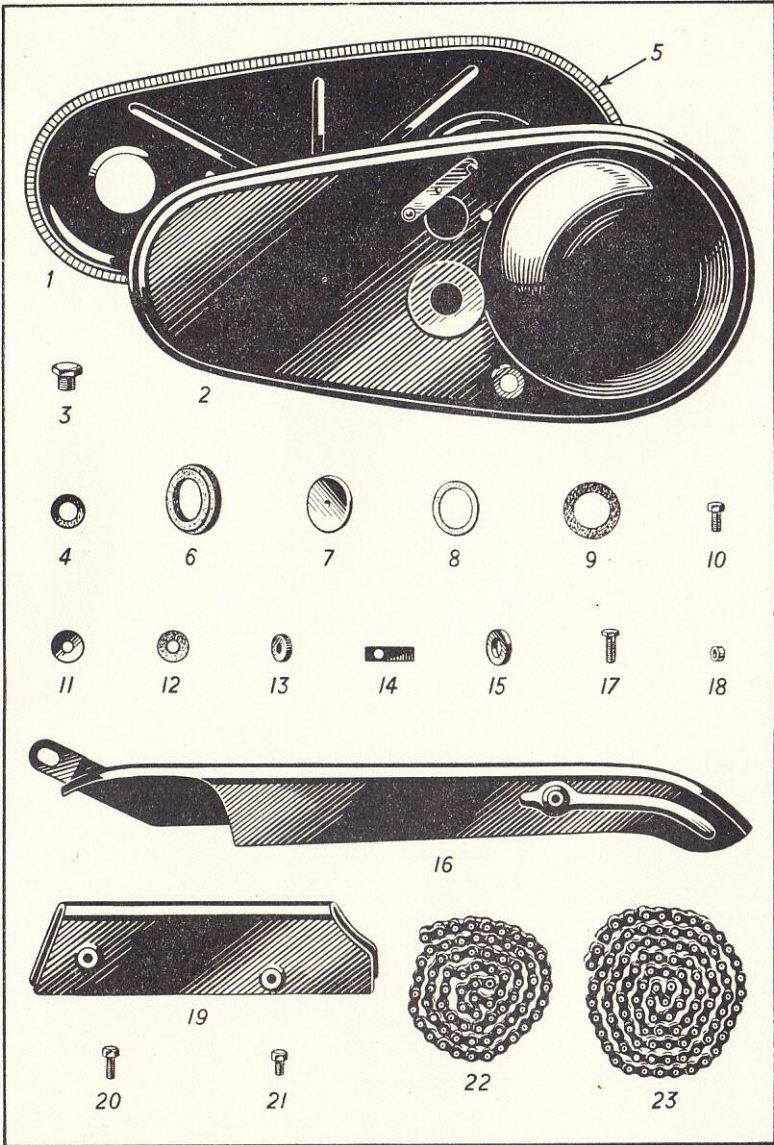

See opposite page for description and price.

THE ROYAL ENFIELD 350c.c. SIDE VALVE MODEL WD/C.

SADDLES AND TOOLBOXES

Illus. No.	No. of part.	Description.	No. per set	M.T. or Proprietary No.	£ s. d.
1	25142	Terrv saddle complete	1	MT1/TE/S787	
2	28693	" " waterproof top	1	MT1/TE/S787/2	
3	28694	" " frame	1	Not serviced ..	
4	28695	" " rear compression spring ..	2	MT1/TE/S787/4	
5	27001	" " " " " " nut	2		
6	28684	" " seat spring (long)	13		
7	28696	" " " " (short)	7		
8	28697	" " " " nose plate	1		
9	28698	" " pivot boit	1		
10	28699	" " " " nut	1		
11	28970	" " " " washer	1		
12	29175	Dunlop complete	1		
13	29176	" " waterproof top	1		
14	29072	" " frame	1		
15	29073	" " compression spring	2		
16	29074	" " " " bolt	2		
17	29076	" " " " " " nut	2		
18	29075	" " " " " " washer	2		
19	29070	" " pivot bolt	1		
20	29071	" " " " nut	1		
21	24859	Saddle attachment bracket (R.H.) ..	1		0 1 3
22	24860	" " " " (L.H.)	1		0 1 3
23	24882	" " " " $\frac{5}{16}$ " stud, $1\frac{3}{32}$ " long ..	2		0 0 2
24	27304	" " " " nut	2		0 0 2
25	27917	" " " " Shakeproof washer ..	2	MT5/15414 ..	0 0 1
26	28882	Toolbox (triangular)	1		0 12 6
27	251	" $\frac{1}{4}$ " pin, $\frac{1}{2}$ " long	2		0 0 2
28	26998	" " " " nut	2		0 0 1
29	27916	" " " " Shakeproof washer ..	2	MT5/24861 ..	0 0 1
30	15736	" " attachment clip	1		0 0 6
31	7201	" " " " $\frac{1}{4}$ " pin, $\frac{21}{32}$ " long ..	1		0 0 2
	26998	" " " " nut (as illus. 28) ..	1		0 0 1
32	7674	" " " " " " washer	1		0 0 1
33	28133	" " (rectangular)	1		0 9 6
34	10142	" $\frac{5}{16}$ " pin, $\frac{11}{16}$ " long	1		0 0 2
35	14445	" " " " $\frac{1}{2}$ " long	1		0 0 2
	27001	" " " " nut (as illus. 5)	2		0 0 2
	27917	" " " " Shakeproof washer (as illus. 25)	2	MT5/15414 ..	0 0 1

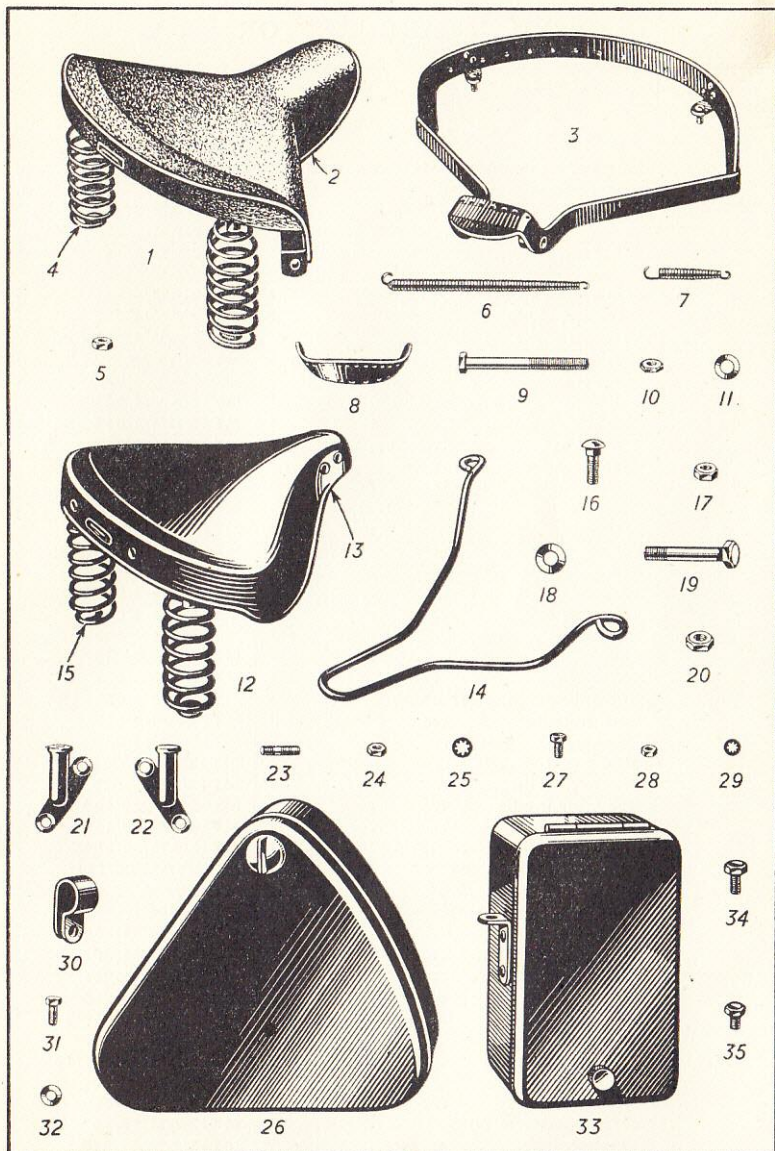

See opposite page for description and price.

THE ROYAL ENFIELD 350c.c. SIDE VALVE MODEL WD/C.

AMAL CARBURETTOR

Illus. No.	No. of part.	Description.	No. per set	M.T. or Proprietary No.	£	s.	d.
		Carburettor complete less controls					
		and cables	1	MT12/AM/274B/1A			
2		Body, mixing chamber	1	MT12/AM/274/022R			
3		Top, " "	1	MT12/AM/4/032			
4		Cap, " "	1	MT12/AM/4/031			
5		Spring, Cap	1	MT12/AM/4/235			
6		Screw, Cap spring	1	MT12/AM/4/241			
7		Adjuster, cable	2	MT12/AM/4/035			
8		Valve, throttle	1	MT12/AM/4/052/No. 5			
9		Spring, " valve	1	MT12/AM/4/037			
10		Cotter, " "	1	MT12/AM/4/060			
11		Valve, air	1	MT12/AM/4/045			
12		Spring, air valve	1	MT12/AM/4/046			
13		Guide, " "	1	MT12/AM/4/047			
14		Nipple, cable	2	MT12/AM/1482			
15		Screw, throttle adjusting	1	MT12/AM/4/063			
16		Nut, " " screw	1	MT12/AM/16/010			
17		Screw, air adjusting	1	MT12/AM/13/129			
18		Spring, " " screw	1	MT12/AM/4/148			
19		Block, jet, complete	1	MT12/AM/204/059R			
20		Washer, jet block	1	MT12/AM/4/040			
21		Jet, needle	1	MT12/AM/4/061			
22		Needle, jet	1	MT12/AM/4/065			
23		Clip, " needle	1	MT12/AM/4/230			
24		Jet, main	1	MT12/AM/4/042/85			
25		Nut, mixing chamber union	1	MT12/AM/4/062			
26		Bolt, holding	1	MT12/AM/4/043			
27		Washer, " bolt	2	MT12/AM/4/053			
28		Clip, outlet	1	MT12/AM/4/207			
29		Pin, " clip	1	MT12/AM/4/048			
30		Body, air intake	1	MT12/AM/30/109			
31		Gauze, " "	3	MT12/AM/30/110			
32		Clip, air intake gauze, spring	1	MT12/AM/30/060			
33		Ring, split, air intake	1	MT/12/AM/30/111			
34		Adaptor, " "	1	MT/12/AM/30/129			
		Chamber, float, complete	1	MT12/AM/1A			
35		Body, float chamber	1	MT12/AM/64/156			
36		Cover, " "	1	MT12/AM/14/208			
37		Screw, lock, cover	1	MT12/AM/14/021			
38		Float	1	MT12/AM/14/015			
39		Spring, bow, float	1	MT12/AM/14/014			
40		Needle, valve	1	MT12/AM/14/024			
41		Tickler assembly	1	MT12/AM/22/021/14/ 032/033			
42		Stop, tickler	1	MT12/AM/14/210			
43		Screw, platform plug	1	MT12/AM/13/153			
44		Washer, " " screw	1	MT12/AM/14/039			
45		Locknut, seating	1	MT12/AM/14/178			
46		Washer, " locknut	1	MT12/AM/14/175			
47		Nut, petrol union	1	MT1/18851			
48		Nipple, " " nut	1	MT1/19110			

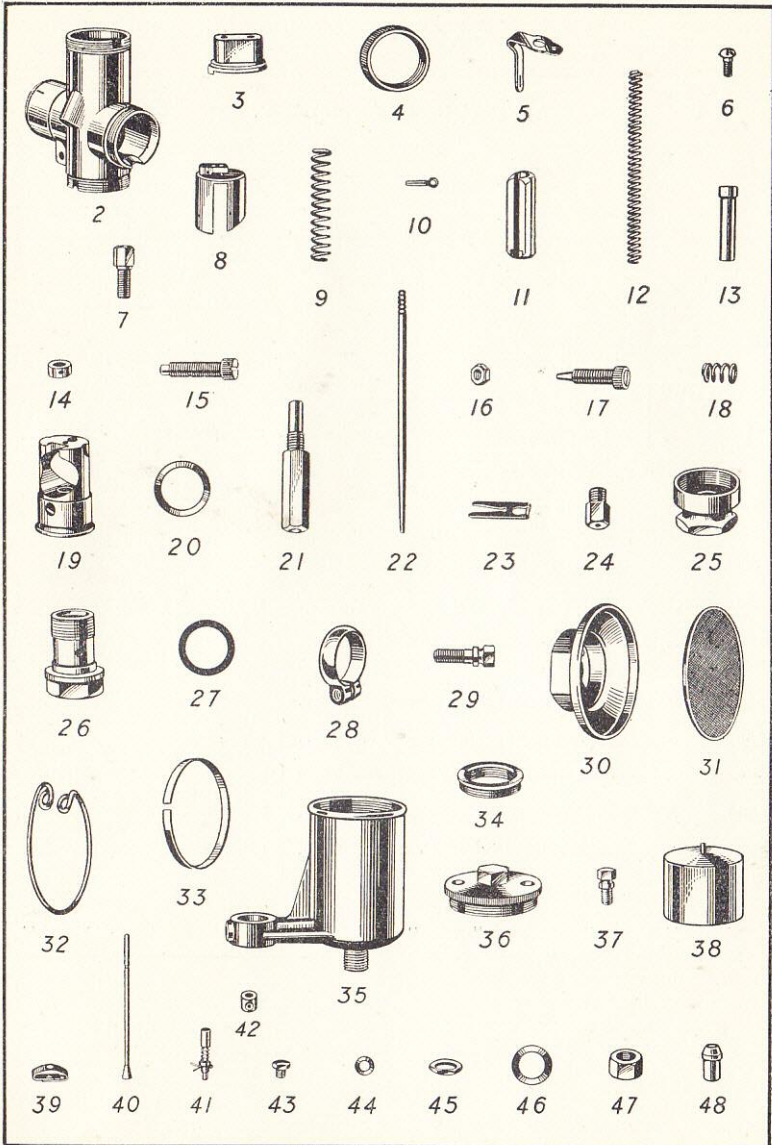

See opposite page for description and price.

SMITH'S SPEEDOMETER

Illus. No.	No. of part.	Description.	No. per set	M.T. or Proprietary No.	£ s. d.
1	S433/B/EX ..	Speedometer head 80 miles non-trip non-illuminated	1	MT1/SM/S433B/Ex ..	1 7 6
2	P25519/5413	Bracket for speedometer head ..	1	MT1/SM/25519 ..	0 2 9
3	N1115 ..	Nut for fixing bracket to head ..	1	MT5/15915 ..	0 0 2
4	W7216 ..	Spring washer for head fixing stud (per doz.)	1	MT5/49947 ..	0 0 6
	SK 52149 ..	Flexible drive complete 1ft. 9in. ..	1	MT1/SM/52149/22 ..	0 13 3
5	P53386 ..	" " outer cable assembly ..	1	Not serviced ..	0 6 8
6	P53385 ..	" " inner " " ..	1	MT1/SM/53385/22 ..	0 6 8
7	S2081 ..	Screw for securing inner cable to speedometer	1	MT1/SM/S2031 ..	0 0 2
8	X25384/5413	Reduction gear box complete ..	1	0 13 9
9	P25200 ..	Lock nut for gear box	1	0 0 4
	27494 ..	Speedometer gear box positioning nut	1	0 0 4
10	W7259 ..	Spring washer for gear box	1	0 0 1
11	27193 ..	Speedometer driving wheel	1	0 2 6
12	27191 ..	" driven " "	1	0 2 0
13	13810 ..	" " " taper pin	1	0 0 6

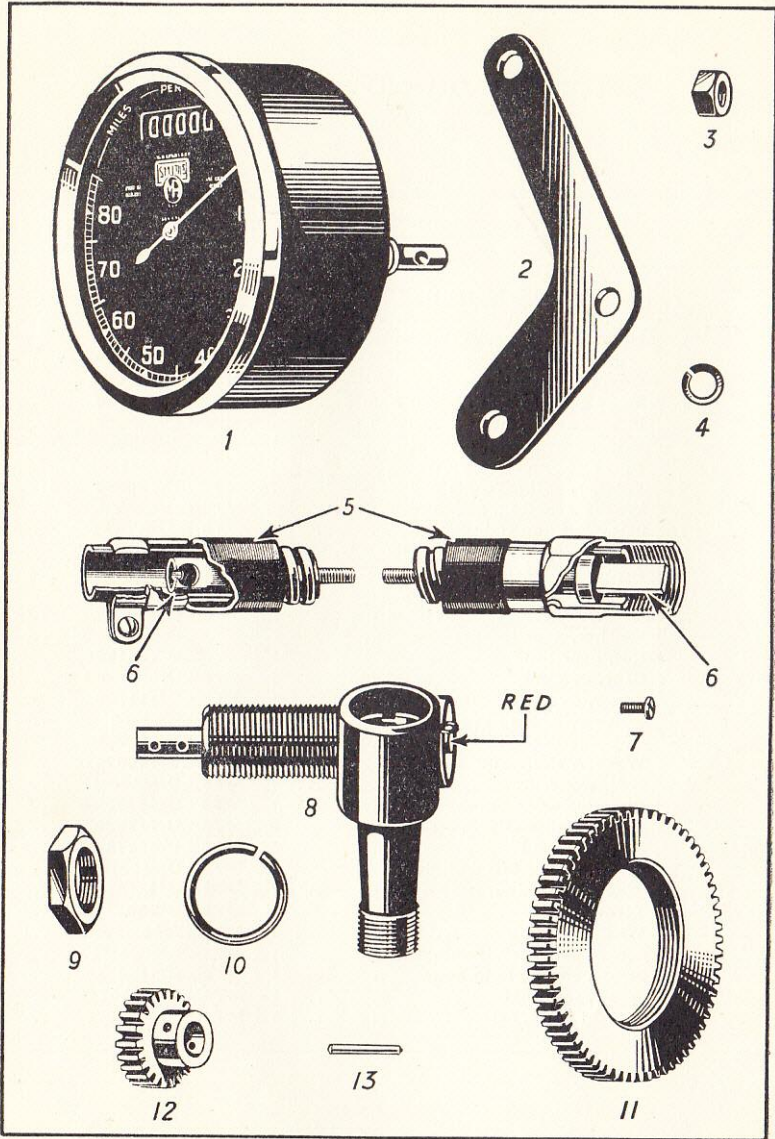

See opposite page for description and price.

LUCAS "MAGDYNO" EQUIPMENT

Illus. No.	No. of part.	Description.	No. per set	M.T. or Proprietary No.	£ s. d.
		Magdyno, type Mo1/4.H3	1	MT8/LU/465112 ..	
		Cup, insulation	1	MT8/LU/463932 ..	
		Holder, earth brush, c/w brush and spring	1	MT8/LU/460380 ..	
		Brush and spring earth	1	MT8/LU/451323 ..	
		Washer, fibre earth brush holder	1	MT8/LU/162674 ..	
		Pickup assembly	1	MT8/LU/463066 ..	
		Brush and spring, pickup	1	MT8/LU/451260 ..	
		Nut, pickup cable	1	MT8/LU/M3156/4 ..	
		Washer, spring, cable end	1	MT8/LU/185008 ..	
		Washer, seating, pickup	1	MT8/LU/455622 ..	
		Screw, pickup fixing	2	MT8/LU/110064 ..	
		Washer, pickup fixing screw	2	MT5/49945 ..	
		Armature assembly	1	MT8/LU/463988 ..	
		Bearing, ball, complete	2	MT8/LU/189294 ..	
		Gears, set of	1	MT8/LU/462863 ..	
		Washer, gear locking	1	MT8/LU/463113 ..	
		Nut, gear locking	1	MT8/LU/463117 ..	
		Gear, dynamo	1	MT8/LU/M1951/1A ..	
		Screw, dynamo gear	1	MT8/LU/111700 ..	
		Washer, locking dynamo gear	1	MT8/LU/M353/1 ..	
		Nut, shaft	1	MT8/LU/M2635/2 ..	
		Washer, shaft nut	1	MT8/LU/140074 ..	
		Key, woodruff	1	MT8/LU/M450/1 ..	
		Plate, drive end cover	1	MT8/LU/463989 ..	
		Screw, fixing D/E cover plate	4	MT8/LU/113229 ..	
		Plate C/B end	1	MT8/LU/463982 ..	
		Screw, fixing C/B end plate	2	MT8/LU/M2976/4 ..	
		Washer, packing, fibre	1	MT8/LU/451379 ..	
		Terminal	1	MT8/LU/186471 ..	
		Washer, spring	1	MT5/49946 ..	
		Screw, grub, for terminal	1	MT4/CB/5335/91 ..	
		Screw, end plate to body	1	MT4/LU/115580 ..	
		Screw, terminal	1	MT8/LU/M3207/2 ..	
		Control parts, sets	1	MT8/LU/463107 ..	

THE ROYAL ENFIELD 350c.c. SIDE VALVE MODEL WD/C.

LUCAS "MAGDYNO" EQUIPMENT—Contd.

Illus. No.	No. of part.	Description.	No. per set	M.T. or Proprietary No.	£ s. d.
		Nipple, control	1	MT8/LU/455788 ..	
		Cap, rubber	1	MT8/LU/M2841/4 ..	
		Cam	1	MT8/LU/463853 ..	
		Ring, jump, for cam	1	MT8/LU/M2646/1 ..	
		Cover C/B	1	MT8/LU/M2648/1 ..	
		Spring and pin assembly	1	MT8/LU/463907 ..	
		Contact breaker, complete	1	MT8/LU/MLCB1 ..	
		Bush, insulating C/B centre	1	MT8/LU/M2679/4 ..	
		Contact set	1	MT8/LU/484098 ..	
		Tappet	1	MT8/LU/M2687/1 ..	
		Screw, fixing C/B	1	MT8/LU/M1290/1 ..	
		Washer, lock, for C/B fixing screw	1	MT8/LU/M2689/1 ..	
		Strap, fixing dynamo	1	MT8/LU/M3517/1 ..	
		Dynamo	1	MT8/LU/200285 ..	
		Screw, fixing pole piece	1	MT4/LU/L2146/5 ..	
		Coil, field	1	MT8/LU/200188 ..	
		Cover band assembly	1	MT8/LU/200238 ..	
		Bracket assembly, drive end	1	MT8/LU/200353 ..	
		Plate, bearing	1	MT8/LU/200262 ..	
		Screw, bearing plate fixing	2	MT8/LU/M940/2 ..	
		Screw, fixing dynamo to magdyno	1	MT8/LU/123063 ..	
		Nut for Dynamo fixing screw	1	MT8/LU/169010 ..	
		Armature	1	MT8/LU/200304 ..	
		Bearing, ball, drive end	1	MT7/6069 ..	
		Nut D/E bearing	1	MT8/LU/200224 ..	
		Key, woodruff	1	MT8/LU/M450/1 ..	
		Bracket assembly, C/E complete with bush	1	MT8/LU/200269 ..	
		Bush, bearing C/E	1	MT8/LU/200231 ..	
		Plate, insulation c/w brush boxes	1	MT8/LU/200253 ..	
		Screw, fixing spring and lever arm	2	MT8/LU/106130 ..	
		Brushes, sets	1	MT8/LU/200290 ..	
		Springs, brush sets	1	MT8/LU/200079 ..	
		Cover, commutator end	1	MT8/LU/200354 ..	
		Screw, fixing C/E cover	1	MT8/LU/100000 ..	
		Screw, locating C/E cover	1	MT8/LU/103513 ..	

LUCAS "MAGDYNO" EQUIPMENT—Contd.

Illus. No.	No. of part.	Description.	No. per Set	M.T. or Proprietary No.	£	s.	d.
		Terminal	2	MT8/LU/200229	..		
		Nut, terminal	4	MT5/16599	..		
		Sleeve, terminal	2	MT3/LU/188818	..		
		Plate, terminal clamp	1	MT8/LU/200212	..		
		Screw, " " plate	1	MT8/LU/109667	..		
		Bolt, through fixing	2	MT8/LU/200227	..		
		Nut " " bolt	2	MT8/LU/168788	..		
		Sparking plug	1	MT4/9324	..		
		" " washer	1	MT1/37628	..		
		Cable H.T.	A/R	MT4/7930	..		
		Terminal, H.T. cable end	1	MT4/1823	..		
		Resistor, plug type	1	MT4/21386	..		
		Immobiliser	1	MT4/18869	..		
		Cable, lighting and charging circuit	A/R	MT4/18683	..		
		Control box, type MCR1/L15	1	MT4/LU/390715	..		
		Plate assembly, terminal clamping	1	MT4/LU/390723	..		
		Screw, plate fixing	1	MT4/LU/100713	..		
		Sleeve, terminal	4	MT3/LU/188818	..		
		Cover, cutout	1	MT4/LU/390460	..		
		Clip, spring, cutout cover	1	MT4/LU/390461	..		
		Battery, secondary 6V.12a. hrs. type					
		PUW 7E-5	1	MT4/80230	..		
		Plug, vent	3	MT4/LU/S2254/1	..		
		Cover, moulded	1	MT4/LU/S2171/1B	..		
		Connector, positive cable	1	MT4/LU/B906	..		
		Bolt, U type c/w nuts	1	MT4/LU/SW784P	..		
		Nut for U bolt	2	MT4/LU/B918	..		
		Connector, battery, positive	1	MT4/LU/B900	..		
		Horn c/w bracket	1	MT3/LU/701418	..		
		Bracket (replacement unit)	1	MT3/LU/701064	..		

LUCAS LAMPS

Illus. No.	No. of part.	Description.	No. per set	M.T. or Proprietary No.	£ s. d.
HEADLAMP.					
		Headlamp assembly	1	MT3/LU/DU42/MAG
		Body	1	MT3/LU/515677
		Screw, lamp fixing	2	MT3/LU/112209
		Washer, " " screw	2	MT3/LU/137141
		Cord, rubber	1	MT3/LU/NB398/8
		Clasp assembly c/w stud, rim fixing	1	MT3/LU/516047
		Wire, clasp fixing	1	MT3/LU/NB398/3
		Screw, panel	3	MT3/LU/106798
		Washer, " " screw	3	MT5/49945
		Reflector assembly	1	MT3/LU/NB398/36
		Wire, back shell fixing	1	MT3/LU/NB398/10
		Reflector, back shell assembly	1	MT3/LU/515650
		Holder assembly, main bulb	1	MT3/LU/504801
		Adaptor, pilot bulb holder assembly	1	MT3/LU/504803
		Clip and screw, bulb holder, retaining	1	MT3/LU/N890
		Screw, bulb holder clip	1	MT3/LU/NC301/34
		Bulb, main	1	MT3/12534
		" pilot	1	MT3/47174
		Mask, W.O. pattern	1	MT3/84604
		*Rim assembly less glass	1	MT3/LU/515678
		Wire, glass fixing	4	MT3/LU/NB317/41
		Bead, langite, glass joint	1	MT3/LU/NC309/6
		*Glass, difusa	1	MT3/LU/NG13/110
		Panel complete	1	MT3/LU/308370
		Ammeter	1	MT3/LU/364461
		Ring, rubber	1	MT3/LU/364010
		Switch, lighting	1	MT3/LU/351590
		Screws for terminals	7	MT3/LU/120514
		Ring, rubber	1	MT3/LU/NB2404/24
		Spring, switch fixing	1	MT3/LU/308234
		Rotor assembly	1	MT3/LU/351593
		Handle, with fixing screw	1	MT3/LU/351567
		Screw, handle fixing	1	MT4/LU/105751
		Sleeve, cable ends, for regulator and head lamp connections	A/R	MT3/LU/188818
		Clips, cable fixing	A/R	MT4/24605
TAIL LAMP.					
		Lamp, tail, complete	1	MT3/WDMCT1
		Case complete with ruby	1	MT3/LU/525890
		Spring, case retaining	1	MT3/LU/525886
		Bulb	1	MT3/47174
		Interior, bulb holder, set of parts	1	MT3/LU/525897
		Connector complete with cover	1	MT3/LU/SA147

* Parts marked thus not required if W.O. mask part No. MT3/84604 is fitted.

*This List is
compiled and published by*
THE ENFIELD CYCLE CO. LTD.



