

IceniCAM Information Service



Description Price
£ s. d.

* 98	Crankcase	2 4 6
* 99	Crankcase End Cap	9 0
99/B	Crankcase End Cap Securing Bolt	2
99/W	Washer for 99/B	1
* 100	Crankcase End Cap Gasket	5
101	Grease Nipple	1 0
102	Grease Nipple Washer	1 0
103	Engine Stud	1 0
104	Rear Handle	8 1
105	Rear Handle Securing Screw	1
106	Washer for 105	1
107	Rubber Packing Piece for 104	8
108	Mounting Tray	9 7
109	Mounting Tray Securing Screw	2
110	Washer for 109	1
111	Mounting "L" Bracket	7 9
112	Hinge Pin	1 6
* 113	Taber Pin for 112	1
114	Engaging Gate	4 0
115	Engaging Gate Packing Piece	1 3
116	Rivet for 115	2
117	Mounting Backplate	2 5
117/F	Flat Mounting Backplate	2 5
118	Mounting Backplate Securing Bolt	3
118/X	Extended Bolt for 117	4
119	Nut for 118	1
120	Rubber Stay Tubes	11
121	Cylinder Barrel	1 17 10
122	Cylinder Barrel Gasket	5
125	Cylinder Head	19 0
126	Cylinder Head Securing Nut	2
	Washer for 126	1
	Cylinder Head Cable Holding Clip	1 10
129	Securing Rivet for 128	1
* 130	Decompressor Clip	2 1
131	Decompressor Clip Pivot Pin	4
132	Split Pin for 131	1
133	Decompressor Clip Cable Holding Nipple	6
134	Cable Securing Screw for 133	1
135	Decompressor Tension Spring	5
* 136	Decompressor Valve	3 5
* 137	Decompressor Valve Seat	3 5
138	Decompressor Valve Spring	5
139	Decompressor Valve Cap	4
140	Decompressor Valve Split Pin	1
* 141	Driving Roller	13 9
142	Driving Roller Locking Screw	1 2
143	Driving Roller Locking Screw Washer	3
144	Driving Roller Locking Screw Split Pin	1
145	D.R.H. Main Bearing	10 6
147	D.R.H. Oilseal (Large)	2 7
149	D.R.H. Large Circlip	11
150	D.R.H. Distance Collar	3 3
* 151	Magneto (see also Dealers' List)	4 0 0
151/L	Magneto H.T. Lead	2 0
151/S	Magneto H.T. Lead Sleeve	1
152	Magneto Retaining Screw	1
153	Washer for 152	1
154	Magneto Holding Nut	3
* 155	Magneto Mounting Endplate	9 0
156	Magneto Mounting Endplate Felt Washer	3
157	Magneto Mounting Endplate Retaining Screw	2
157/F	Magneto Mounting Endplate Locating Pin	2
* 158	Magneto Timing Cam	2 6
160	Woodruff Key	3
161	Crankcase Main Bearing	18 0
162	Crankcase Mild Steel Washer	1 0
* 163	Crankcase Oilseal	1 6
* 164	Crankshaft	2 11 0
165	Big End Bearing Outer Track	11 5
166	Big End Bearing Inner Track	
169	Big End Bearing Needle Rollers, 3/6 per set	
167	Big End Bearing Thrust Washer (O.Type)	1 9
168	Big End Bearing Thrust Washer (D.Type)	1 9
* 170	Big End Bearing Small Circlip	2 9
* 171	Connecting Rod	10 9
172	Little End Bearing	1 7

★ MEANS THAT MORE THAN ONE TYPE HAS BEEN USED. IF IN DOUBT RETURN THE OLD PART TOGETHER WITH ENGINE NUMBER



★ MEANS THAT MORE THAN ONE TYPE HAS BEEN USED. IF IN DOUBT RETURN THE OLD PART TOGETHER WITH ENGINE NUMBER

Spare Parts List

PLEASE QUOTE PART NUMBER, ENGINE NUMBER AND DESCRIPTION

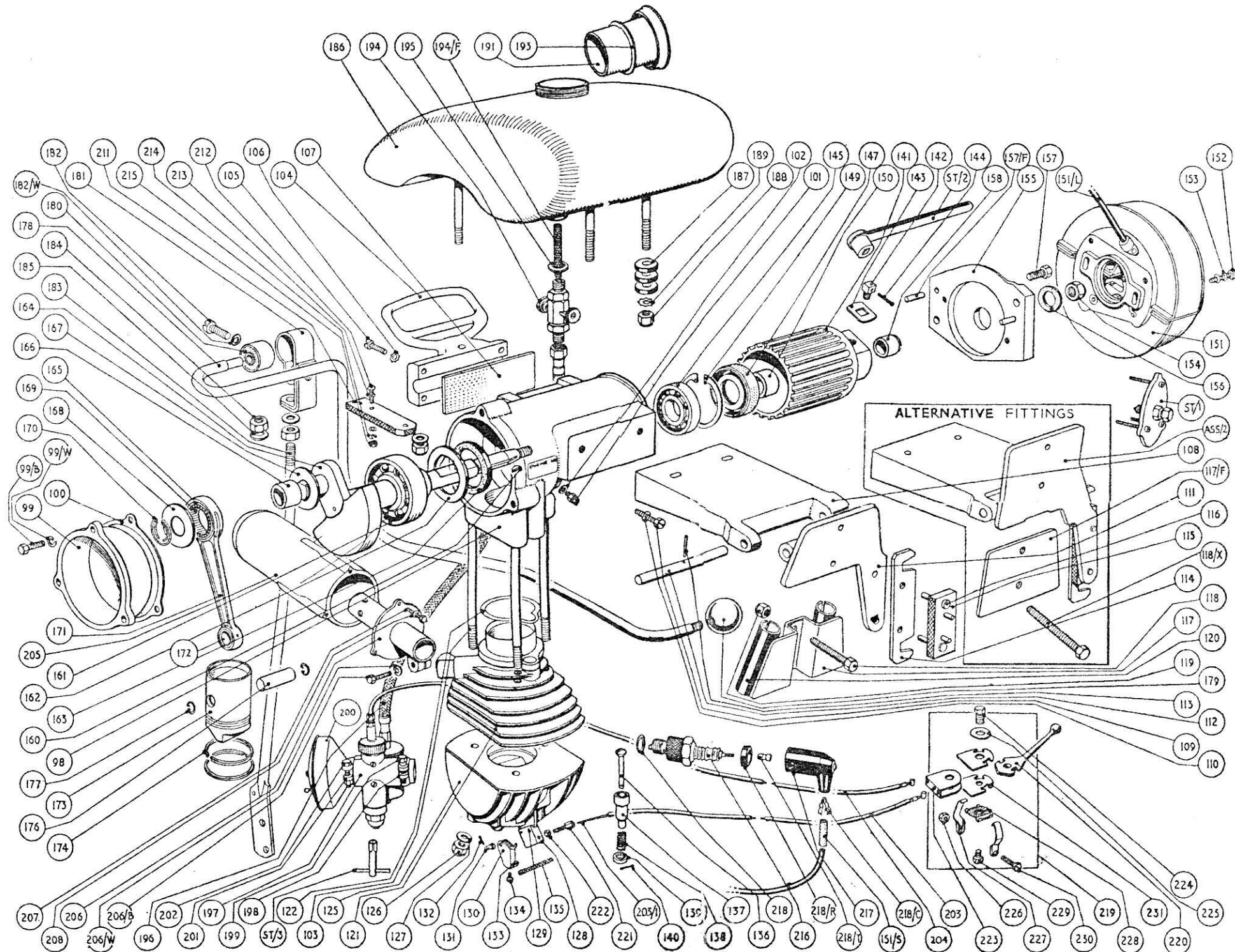

Part No.	Description	Price £ s. d.
173	Piston	12 7
174	Piston Ring	2 0
175	Piston Ring Peg	2
176	Piston Gudgeon Pin	2 0
177	Piston Gudgeon Pin Circlip	2
178	Engaging Lever	15 10
179	Engaging Lever Knob	1 9
180	Silentbloc	3 3
181	Silentbloc Clip	8 8
182	Silentbloc Clip Securing Screw	2
182/W	Washer for 182	1
183	Motor Stay Rod	11 9
184	Motor Stay Rod Adjusting Nut	1
185	Washer for 184	1
186	Petrol Tank	2 16 0
187	Petrol Tank Rubber Distance Washer	2
188	Petrol Tank Securing Nut	2
189	Washer for 188	1
191	Petrol Filler Cap	4 6
193	Petrol Filler Cap Leather Washer	3
* 194	Petrol Tap with Filter	6 11
194/F	Petrol Tap Filter only	1 8
195	Petrol Tap Fibre Washer	1
* 196	Petrol Supply Pipe	6 7
197	Carburettor (see also Dealers' List)	1 11 6
198	Carburettor Retaining Clip	2 0
199	Bolt for 198	6
200	Carburettor Air Filter	10 0
201	Carburettor Air Filter Retaining Clip	1 0
202	Bolt and Nut for 201	2
203	Decompressor Inner and Outer Cable	2 3
203/I	Decompressor Inner Cable	
204	Throttle Inner and Outer Cable	
205	Silencer Housing	7 3
206	Silencer Backplate Assembly	7 3
206/B	Silencer Backplate Assembly Bolt	2
206/W	Silencer Backplate Assembly Washer	1
207	Silencer Backplate Assy. Securing Screw	2
208	Washer for 207	1
211	Mudguard Rubber Hinge Piece	1 2
212	Screw for 211	
213	Brass Washer for 211	2
214	Spring Washer for 211	
215	Nut for 211	
216	Sparkling Plug	5 0
217	Sparkling Plug Cover	1 6
218	Sparkling Plug Washer	1
218/R	Sparkling Plug Rubber Washer	1
218/T	Sparkling Plug Terminal	2
218/C	Sparkling Plug Tag	1
* 219	Control Lever Assembly	10 6
220	Control Lever only	3 9
221	Decompressor Cable Adjustor	7
222	Decompressor Cable Adjustor Nut	1
223	Control Lever Body	2 6
224	Control Lever Centre Bush	1 6
225	Control Lever Bush Plate	4
226	Nut for Control Lever Clamp	1
227	Control Lever Clamp	2 0
228	Control Lever Base Plate	9
229	Control Lever Bush Bolt	3
230	Control Lever Base Bolts	2
231	Control Lever Stop Plates	1 4
COMPLETE ASSEMBLIES		
ASS/1	Mounting L Bracket/Tray Ass.	1 7 6
ASS/2	Extended Mounting L Bracket/Tray Assembly	1 7 6
ASS/3	Piston Assembly	19 6
ASS/4	Complete Silencer Assembly including Bolt	16 0
ASS/5	Cylinder Head Assembly	15 6
ASS/6	Con. Rod/Bearing Assembly	1 7 0
SERVICE TOOLS		
ST/1	Magneto Withdrawal Tool	5 0
ST/2	Driving Roller Key	5 0
ST/3	Jet Spanner	1 6
MISCELLANEOUS		
	Transfers	1 0
	Instruction Book	1 0
	Spares Chart	1 0