

# IceniCAM Information Service

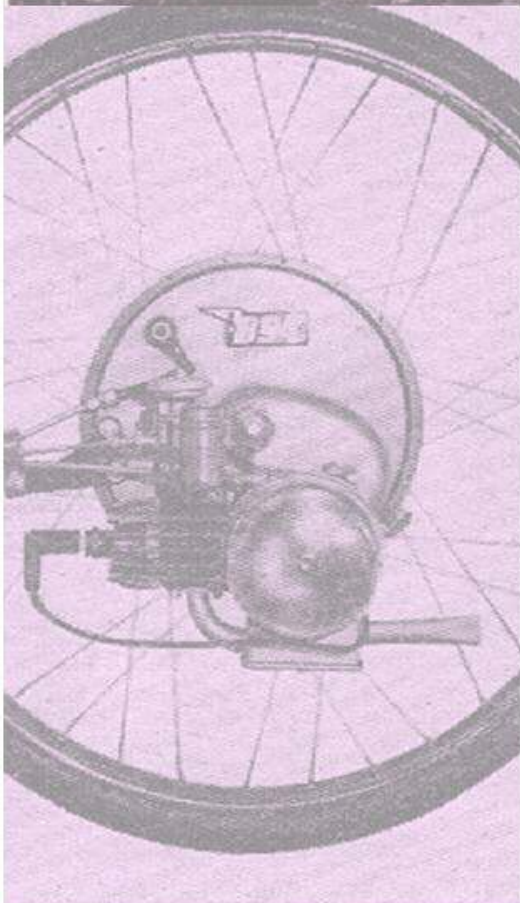

# Easy-Rider

# Easy-Rider

## SPARE PARTS LIST

For

# Easy-Rider

ER4L & ER4TL 4-SPEED MANUAL GEAR CHANGE MOPEDS

This list covers the 4-speed Engine and Gearbox unit, the Carburettor, and Air Cleaner, with an accompanying illustration.

Cycle parts are listed when they differ from Easy Rider moped model ER1.

Parts which do not appear in this list are shown in Model ER1 Parts List, Publication No. 09-0379.



**NVT Motorcycles Limited**

Lynn Lane, Shenston  
Lichfield Staffordshire WS14 0EA  
Telephone: 0543-480633  
Telex: 339478 Norshen Shenstr

Publication No. 09-0713

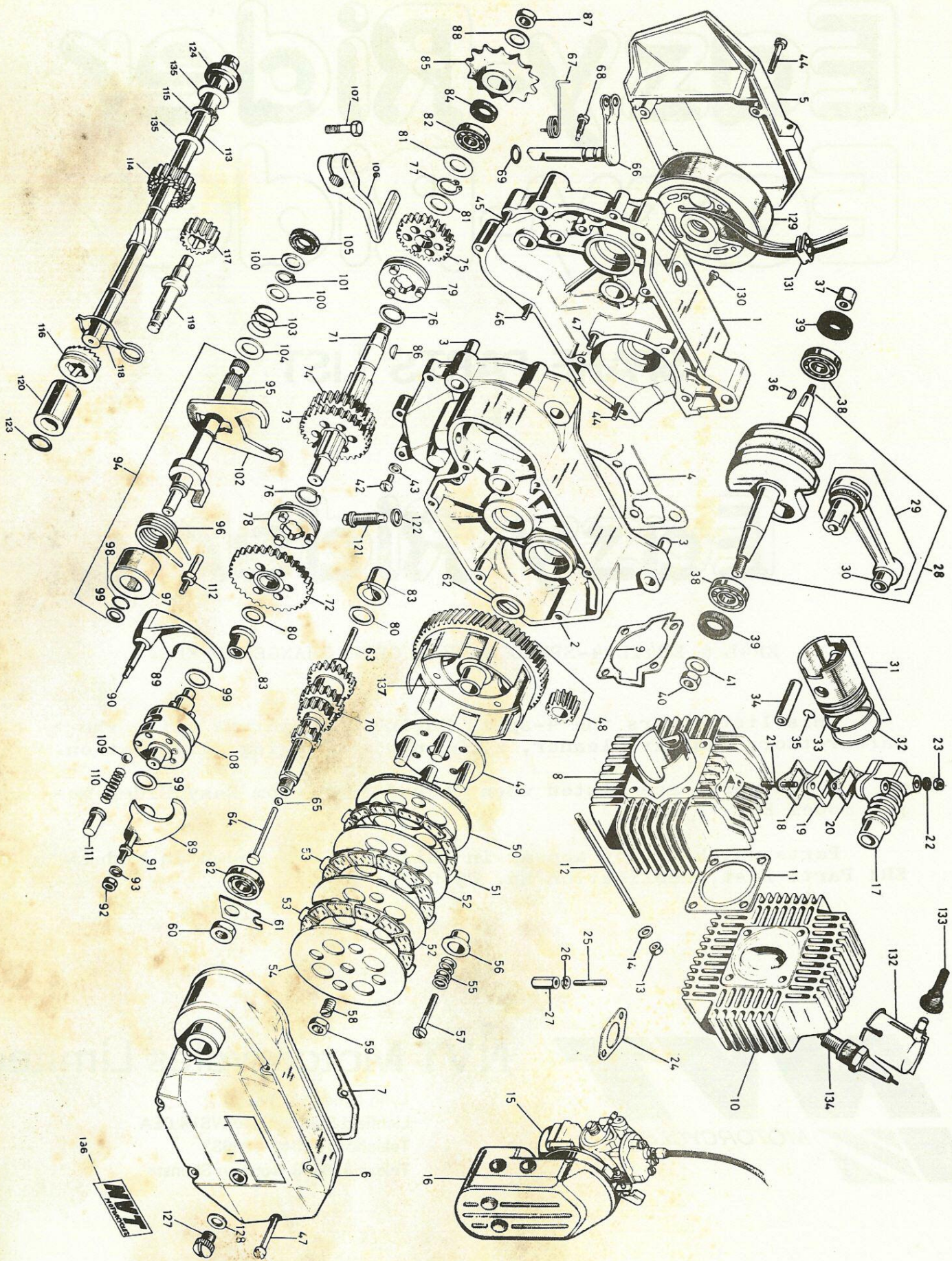

NVT Easy-Rider  
ER4L & ER4TL 4-speed  
Engine Spare Parts

Illustration Number	Part Number	Description	Quantity
1	09-0624	Crankcase half L.H.	1
2	09-0625	Crankcase half R.H.	1
3	09-0626	Dowel	2
4	09-0627	Gasket, crankcase	1
5	09-0628	Side cover, L.H.	1
6	09-0629	Side cover, R.H.	1
7	09-0630	Gasket, R.H. side cover	1
8	09-0631	Cylinder	1
9	09-0019	Gasket, cylinder base	1
10	09-0005	Cylinder head	1
11	09-0021	Gasket, cylinder head	1
12	09-0015	Stud, cylinder	4
13	23-2002/004	Nut, 6 mm	4
14	23-1556/004	Washer, 6 mm, plain	4
15	09-0632	Carburettor, (See separate page)	
17	09-0027	Inlet manifold	1
18	09-0024	Gasket, manifold, lower	1
19	09-0026	Distance piece	1
20	09-0025	Gasket, manifold, upper	1
21	09-0011	Stud, inlet manifold	2
22	23-1555/004	Washer, 5 mm	2
23	23-2001/004	Nut, 5mm	2
24	09-0020	Gasket, exhaust flange	1
25	09-0013	Stud, exhaust	2
26	23-1604/004	Spring washer	2
27	09-0558	Exhaust stud nut	2
28	09-0633	Crankshaft assembly	1
29	09-0036	Con rod c/w small-end bush and big-end bearing	1
30	09-0035	Small-end bush	1
31	09-0039	Piston c/w rings (std.)	1
	09-0332	Piston c/w rings (+.2 mm)	1
	09-0345	Piston c/w rings (+.4 mm)	1
33	09-0040	Ring (std.)	2
	09-0333	Ring (+.2mm)	2
	09-0346	Ring (+.4mm)	2
34	09-0037	Gudgeon pin	1
35	09-0038	Circlip	2
36	09-0043	Woodruff key (for magneto)	1
37	09-0044	Rotor nut	1
38	09-0041	Main bearing (17x40x12)	2
39	09-0042	Crankcase seal	2
	09-0704	Engine/gearbox seal kit, complete	
40	09-0057	Nut, crankshaft	1
41	23-1558/004	Washer, crankshaft, 10 mm	1
42	09-0634	Oil drain plug	1
43	09-0033	Washer	1
44	09-0635	Screw, 6 x 30 mm	6
45	09-0008	Screw, 6 x 35 mm	2
46	09-0009	Screw, 6 x 40 mm	2
47	09-0010	Screw, 6 x 45 mm	8

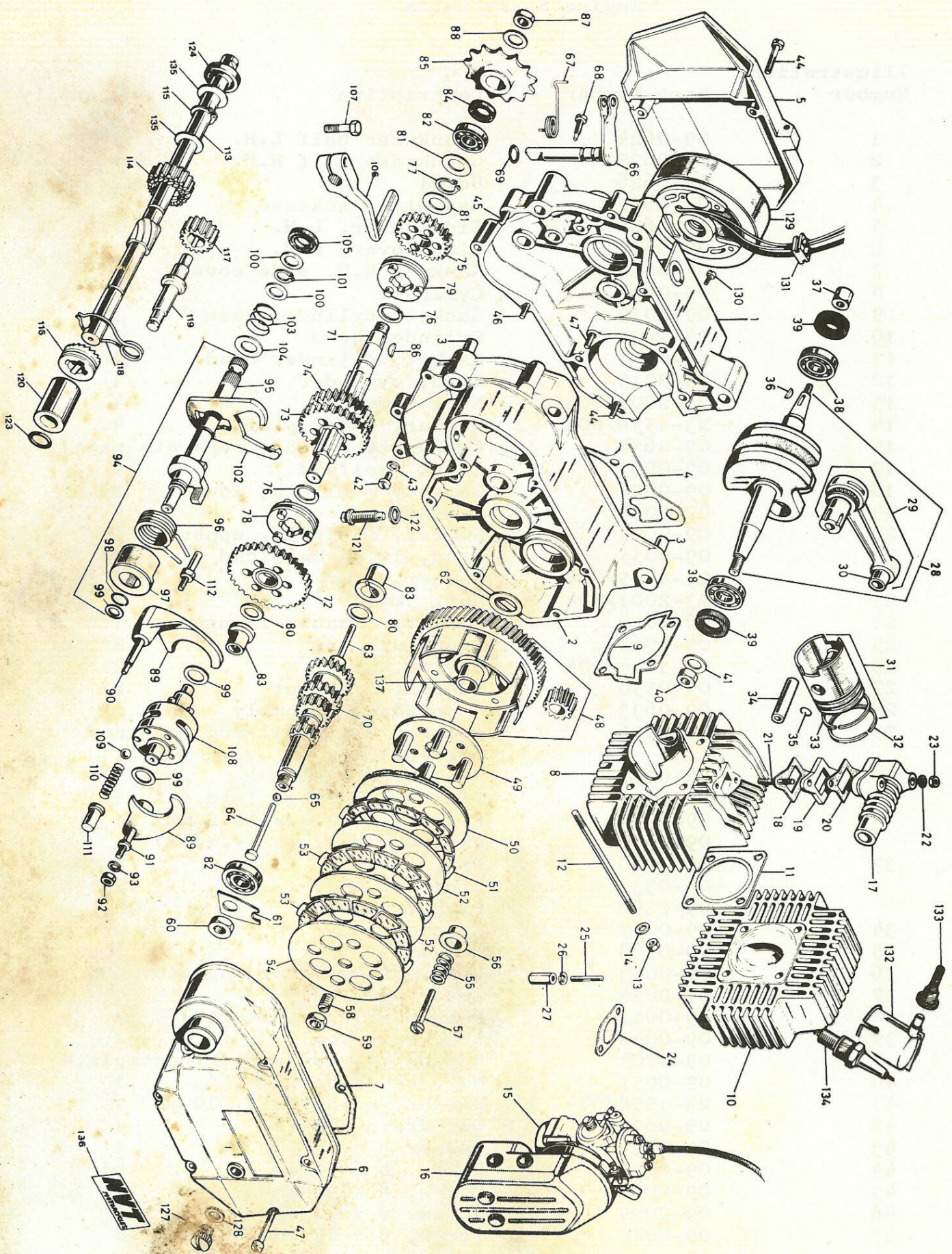

Illustration Number	Part Number	Description	Quantity
48	09-0636	Transmission gear set	1
49	09-0637	Clutch center	1
50	09-0638	Clutch base plate	1
51	09-0639	Clutch inner friction plate	1
52	09-0640	Clutch plain plate	2
53	09-0641	Clutch friction plate	2
54	09-0642	Pressure plate	1
55	09-0643	Clutch spring	4
56	09-0644	Clutch spring cup	4
57	09-0645	Clutch spring screw	4
58	09-0646	Adjuster screw	1
59	09-0647	Adjuster locknut	1
60	09-0648	Clutch center nut	1
61	09-0649	Lockplate	1
62	09-0064	Spacing washer	1
63	09-0650	Clutch pushrod	1
64	09-0651	Pushrod extension	1
65	09-0652	Pushrod ball 3/16	1
66	09-0653	Clutch actuating lever	1
67	09-0655	Lever return spring	1
68	09-0705	Lever retaining screw	1
69	09-0063	"O"-ring	1
70	09-0654	Mainshaft w/gears 10-15-18-20 t	1
71	09-0656	Layshaft	1
72	09-0657	1st gear	1
73	09-0658	2nd gear	1
74	09-0659	3rd gear	1
75	09-0660	4th gear	1
76	09-0661	Spacing ring	2
77	09-0662	Circlip, mainshaft 15 mm	1
78	09-0663	Shift dogs, 1st & 2nd gear	1
79	09-0664	Shift dogs, 3rd & 4th gear	1
80	09-0069	Spacing washer, 13 mm	1
81	09-0064	Spacing washer, 15 mm	1
82	09-0070	Bearing 15x35x11	2
83	09-0665	Gear shaft bushes	2
84	09-0073	Oil seal 15x24x7	1
85	09-0666	Sprocket 14t	1
86	09-0076	Woodruff key (for sprocket)	1
87	09-0075	Nut, sprocket	1
88	09-0667	Washer	1
89	09-0668	Shift forks	2
90	09-0669	Fork guide spindle (rear)	1
91	09-0670	Fork guide spindle (front)	1
92	09-0671	Fork spindle nut, 6 mm	1
93	09-0672	Spring washer, 6 mm	1
94	09-0673	Selector shaft ass'y	1
95	09-0674	Selector shaft	1
96	09-0675	Return spring	1
97	09-0676	Spring cover	1
98	09-0677	"O"-ring	1
99	09-0678	Spacing washer	1
100	09-0537	Spacing washer	2
101	09-0536	Circlip, 12 mm	1
102	09-0679	Selector ratchet plate	1
103	09-0680	Ratchet plate spring	1

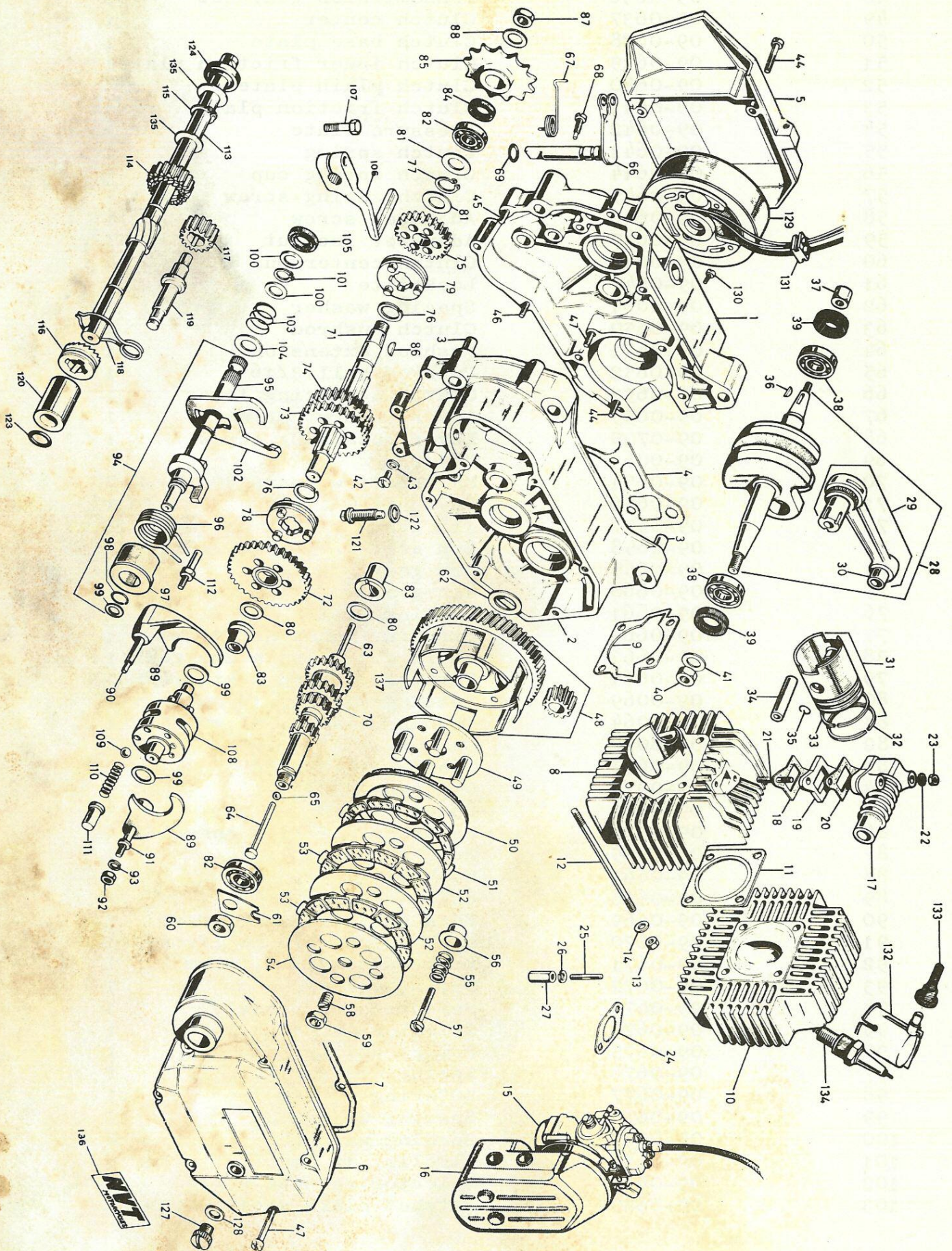

Illustration Number	Part Number	Description	Quantity
104	09-0681	Ratchet washer	1
105	09-0682	Oil seal 12x22x7	1
106	09-0683	Shifter lever	1
107	09-0684	Shift lever clamp bolt	1
108	09-0685	Shift cam & shaft ass'y	1
109	09-0686	Detent ball	1
110	09-0687	Detent spring	1
111	09-0688	Detent guide	1
112	09-0689	Spring pin	1
	09-0690	Pedal shaft group ass'y	1
113	09-0691	Pedal shaft	1
114	09-0692	Scrolled gear	1
115	09-0081	Circlip, 16mm	1
116	09-0693	Ratchet gear	1
117	09-0694	Intermediate gear	1
118	09-0695	Ratchet gear spring	1
119	09-0696	Intermediate gear shaft	1
120	09-0697	Pedal shaft spacer	1
121	09-0698	Pedal stop plug	1
122	09-0699	Washer	1
123	09-0700	"O"-ring	1
124	09-0083	Oil seal 16x24x5	1
127	09-0032	Oil filler plug	1
128	09-0033	Gasket	1
129	09-0089	Magneto (See ER 1 Parts Book)	1
130	09-0701	Screw M4x12	2
131	09-0702	Grommet, wiring	1
132	09-0046	Plug cap	1
133	09-0045	HT lead end cover	1
134	09-0092	Spark plug	1
135	09-0082	Spacing washer 16 mm	2
136	09-0451	Engine Decal "NVT"	1
	09-0703	Gasket set complete, spares pack	1
	09-0704	Oil seal set complete, spares pack	1
137	09-0712	Clutch drum bush	1





## CARBURETTOR AND AIR CLEANER

Ref No.	Part No.	DESCRIPTION	Quantity
1	09-0632	Carburettor complete	1
2	09-0095	Top	1
3	09-0096	Screw, top	2
4	09-0097	Gasket, top	1
5	09-0098	Slide, throttle	1
6	09-0103	Sleeve, insulating	1
7	09-0104	Screw, clamping	1
8	09-0105	Nut, clamping screw	1
9	09-0106	Screw, throttle stop	1
10	09-0107	Spring, throttle stop screw	1
11	09-0108	Float bowl	1
12	09-0109	Screw, float bowl	2
13	09-0110	Sealing ring, float bowl	1
14	09-0111	Float	1
15	09-0112	Pivot pin	1
16	09-0113	Needle, float	1
17	09-0715	Jet, main size	1
18	09-0117	Lever, starting	1
19	09-0118	Screw, lever pivot	1
20	09-0119	Spring, lever	1
21	09-0714	Air cleaner complete	1
22	09-0124	Adjuster, throttle cable	1
23	09-0125	Nut, Cable adjuster	1
24	09-0126	Tap, fuel complete	1
25	09-0127	Lever, extension, tap	1
26	09-0128	Clip, securing	1
27	09-0129	Washer, sealing	1
28	09-0131	Banjo, carburettor filter	1
29	09-0132	Screw, banjo	1
30	09-0133	Washer, banjo	1
31	09-0130	Petrol pipe - 4½ cms long	1
32	09-0115	Banjo filter	1

### FRAME PARTS

Part Number		Description	Qty.
ER4L	ER4TL		
09-0401	09-0401	Frame, 4-speed models	1
09-0411	09-0411	Sub-frame (pivoting)	1
09-0485	09-0485	Sub-frame front fastener clip	1
09-0412	09-0412	Sub-frame front fastener	1
09-0413	09-0413	Fastener buffer (shouldered)	1
09-0414	09-0414	Fastener buffer (flat)	1
23-1173/004	23-1173/004	Pivot bolt for sub-frame	1
23-2113/004	23-2113/004	Pivot bolt nut	1
23-1558/004	23-1558/004	Pivot bolt washer	2
09-0416	09-0416	Sub-frame support stay	1
23-1557/004	23-1557/004	Support stay washer	2
09-0417	09-0417	Support stay pin	1
09-0484	09-0484	Front fastener pop rivet	2
09-0573	09-0573	Sub-frame mounting bracket	1
09-0574	09-0574	Sub-frame rear mounting tube	1
09-0419	09-0419	Rear carrier	1
09-0161	09-0161	Carrier screw	4
09-0450	09-0450	Chainguard	1
09-0409	09-0410	Seat	1
09-0576	09-0576	Seat pan	1
23-2002/004	23-2002/004	Seat nut	4
23-1556/004	23-1556/004	Seat nut washer	4
09-0415	09-0415	Dummy tank	1
09-0161	09-0161	Dummy tank fixing screw, rear	2
23-1556/004	23-1556/004	Fixing screw washer	2
09-0418	09-0418	Tool box	1
09-0311	09-0311	Tool box screw seat inserts	4
09-0313	09-0313	Tool box insert screw	4
23-1554/004	23-1554/004	Tool box insert washer	4
09-0473	09-0473	Toolbox steady strip (rubber)	1
09-0377	09-0377	Decal, "Easy Rider"	2
09-0382	09-0382	Decal, "NVT Motorcycles"	2

### FAIRING AND FITTINGS

Part Number		Description	Qty.
ER4L	ER4TL		
Not Appl.	09-0469	Fairing	1
N/A	09-0470	Fairing bracket	2
N/A	09-0161	Fairing fixing screw	4
N/A	23-1122/004	Bracket bolt	2
N/A	23-2002/004	Fixing screw nut	4
N/A	23-1556/004	Fixing screw washer	4
N/A	09-0472	Fairing grommet	4

### MUDGUARDS

09-0402	09-0402	Mudguard, front	1
09-0403	09-0403	Mudguard, rear	1

### EXHAUST AND FITTINGS

09-0420	09-0420	Silencer	1
09-0422	09-0422	Silencer stay	1
23-1032/004	23-1032/004	Stay bolt	1
23-2002/004	23-2002/004	Stay bolt nut	1
23-1556/004	23-1556/004	Stay bolt washer	1

PEDALS-CRANKS AND FOOTRESTS

Part Number ER4L	Part Number ER4TL	Description	Qty.
09-0425	09-0425	Pedal (pair)	1
09-0593	09-0593	Pedal, right	1
09-0592	09-0592	Pedal, left	1
09-0428	09-0428	Pedal crank, right	1
09-0427	09-0427	Pedal crank, left	1
09-0429	09-0429	Crank spindle cover, left	1
09-0476	09-0476	Footrest pedal	1
09-0477	09-0477	Pedal cap	1
09-0589	09-0589	Pedal cap nut	1
23-1558/004	23-1558/004	Pedal cap washer	1
09-0478	09-0478	Footrest pivot assembly	1
23-1161/004	23-1161/004	Pivot bolt	1
23-2004/004	23-2004/004	Pivot nut	1
23-1558/004	23-1558/004	Pivot washer, plain	1
09-0154	09-0154	Pivot washer, serrated	1
09-0479	09-0479	Pedal stop	1
09-0480	09-0480	Pedal stop rubber	1
23-1161/004	23-1161/004	Pedal stop bolt	1
23-2004/004	23-2004/004	Pedal stop nut	1
23-1558/004	23-1558/004	Pedal stop washer, plain	1
09-0154	09-0154	Pedal stop washer, serrated	1

REAR WHEEL AND BRAKE PARTS

09-0707	09-0707	Rear wheel complete	1
09-0708	09-0708	Rim, hub, and spokes assembly	1
09-0430	09-0430	Hub, rear	1
09-0709	09-0709	Rear sprocket, 32 teeth	1
09-0435	09-0435	Rear brake trunnion	1
09-0433	09-0433	Rear brake rod	1
09-0434	09-0434	Rear brake rod spring	1
09-0436	09-0436	Rear brake rod wing nut	1
23-1556/004	23-1556/004	Rear brake rod washer	2
09-0466	09-0466	Rear brake rod pin	1
09-0437	09-0437	Rear brake pedal	1
09-0467	09-0467	Rear brake pedal sirclip	1
09-0431	09-0431	Tyre, front & rear	2
09-0468	09-0468	Rear chain	1

HANDLEBAR AND CONTROLS

09-0438	09-0439	Handlebar	1
09-0440	09-0440	Brake lever assembly, front	1
09-0459	09-0441	Brake cable, front	1
09-0461	09-0442	Throttle cable	1
09-0464	09-0465	Clutch cable	1
09-0446	09-0446	Fuel tap operating lever	1

ELECTRICS

09-0423	09-0423	Headlamp ass'y with harness & speedo	1
09-0584	09-0584	Headlamp bulb	1
09-0258	09-0258	Main wiring harness	1
09-0259	09-0259	Light wwitch and lead	1
09-0282	09-0282	Horn harness	1
09-0424	09-0424	Speedometer	1
09-0588	09-0588	Speedo "U" clip	1

MISCELLANEOUS

09-0582	09-0582	Rider's handbook	1
---------	---------	------------------	---

