

QUICKLY-CAVALLINO

with
THREE SPEED GEARBOX

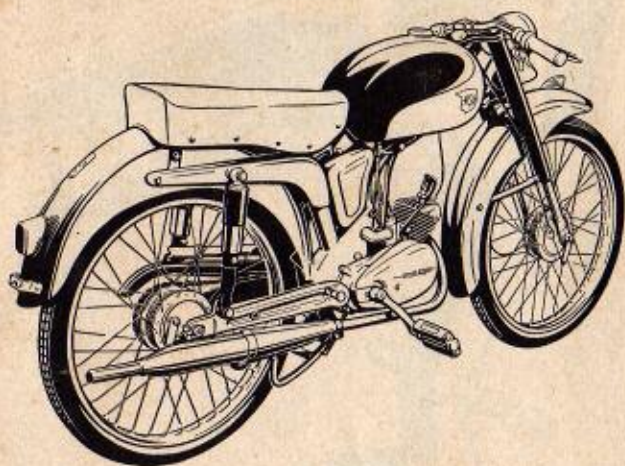

Edition July 1958

TC4 731 a 2 7 8 33
PRINTED IN GERMANY

For engine and gearbox parts not stated herein see spare parts list for Quickly edition
September 1957 resp. supplementary list edition June 1957.

Description	Part-No.	No-used	Remarks
Engine with generator and carburettor	16 00 90 907	1	
Chain cover , compl.	16 01 90 509	1	
Spg. washer	8 6 DIN 137	2	
Bolt	M 6x12 DIN 933	1	
Screw	M 6x15 DIN 91	1	
Bolt	16 01 00 039	2	} for engine mounting
Bolt	16 01 00 047	1	
Lock washer	J 8,4 DIN 6797	4	
Nut	083 871 012	2	
Nut	034 099 167	1	
Brake operating lever	16 10 01 014	1	
Carburettor 1/12/90 w/starting device	16 16 02 504	1	
① Main jet	16 16 00 910	1	normally 64
① Needle jet	16 16 01 909	1	
Wet-air filter	16 16 00 022	1	
Cap on clutch cover	16 16 00 023	1	

① quote number stamped on part

Description	Part-No.	No-used	Remarks	Fig.-No.
Frame	16 31 90 902	1		1
Steering head race	16 31 90 904	2		2
① Nameplate	16 31 90 092	1		3
Grooved stud	2x3 DIN 1476	2		4
Grease nipple	16 31 90 903	1		5
Bush	16 32 90 900	2		6

Centre stand	16 35 90 505	1		7
Screw	16 35 90 901	1		8
Nut	M 10 DIN 934	1		9
Spring	16 35 90 900	1		10

① not supplied without stamped number

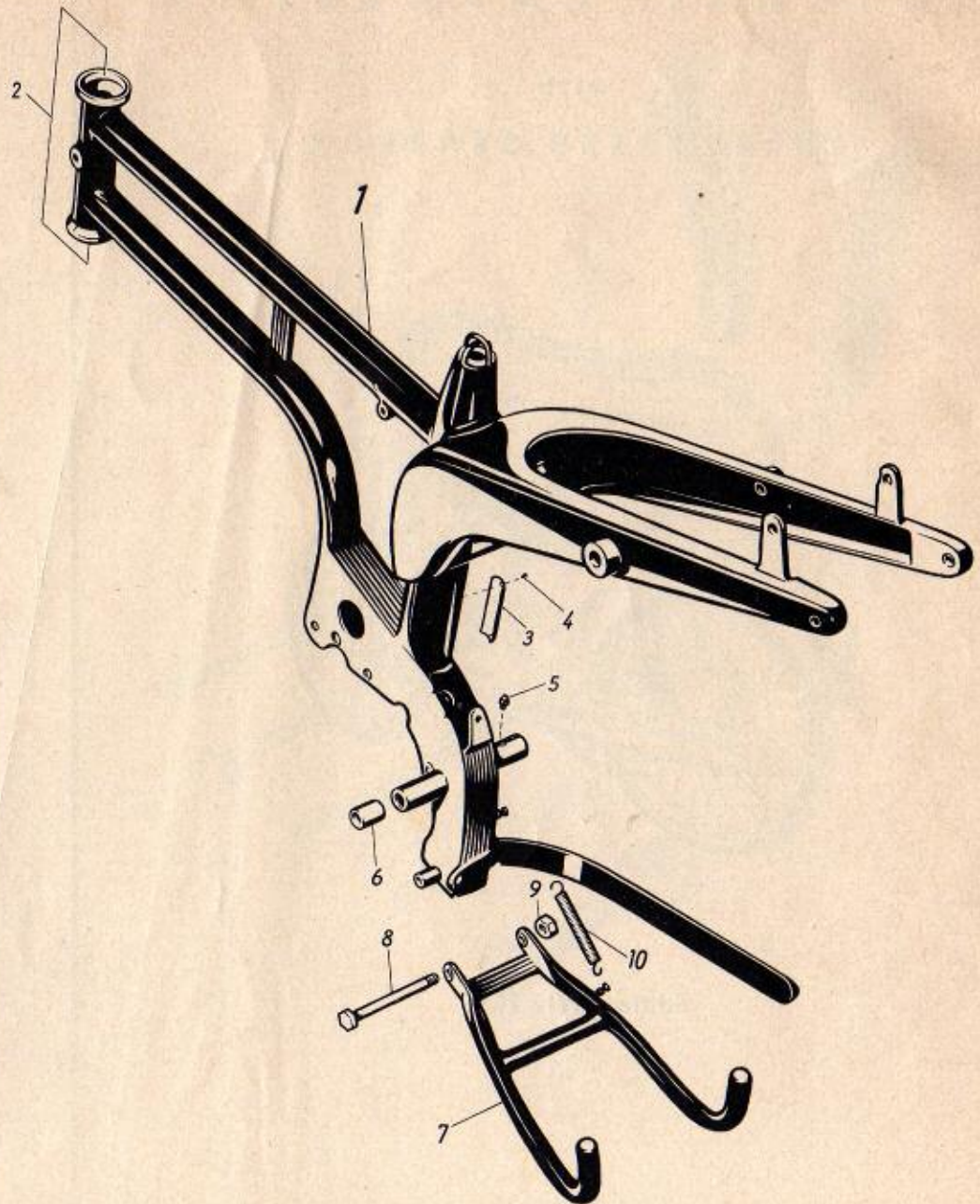

Description	Part-No.	No-used	Remarks	Fig.-No.
Rear fork	16 32 90 903	1		1
Axle	16 32 90 901	1		2
Nut	M 12x1,5 DIN 936	1		3
Shock absorber	16 32 90 905	2		4
Washer	10,5 DIN 125	4		5
Screw	M 10x1x35 DIN 960	4		6
Chain guard	16 32 90 904	1		7
Washer	6,4 DIN 125	1		8
Lock washer	B 6 DIN 127	1		9
Screw	M 6x10 DIN 933	1		10

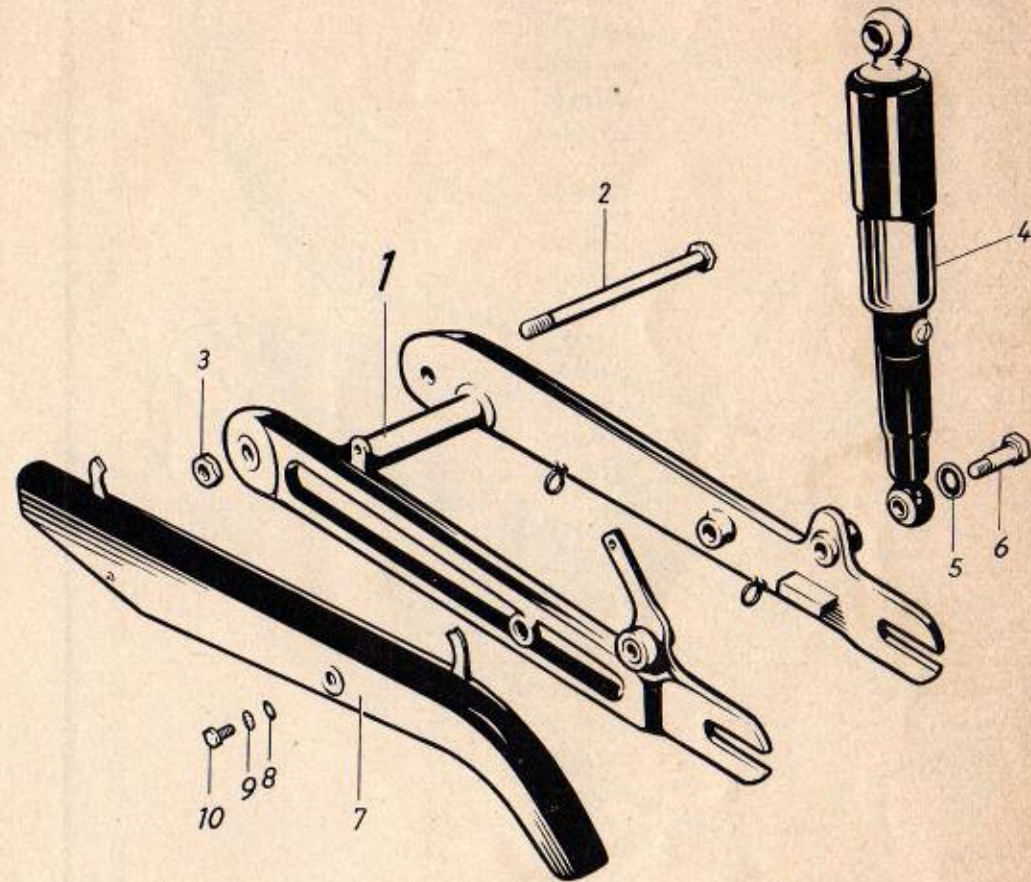

Description	Part-No.	No.-used	Remarks	Fig.-No.
Front mudguard	16 33 90 901	1		1
Stay	16 33 90 902	2		2
Screw	M 6x12 DIN 933	4		3
Washer	6,4 DIN 125	1		4
Lock washer	B 6 DIN 127	4		5
Nut	M 6 DIN 934	4		6
Screw	M 6x12 DIN 933	2		7
Lock washer	B 6 DIN 127	2		8
Nut	M 6 DIN 934	2		9
NSU emblem (blue)	533 085 385	1		10
Spg. washer	A 4 DIN 137	2		11
Nut	M 4 DIN 934	1		12
Rear mudguard	16 34 90 901	1		13
Screw	M 6x12 DIN 933	1		14
Washer	6,4 DIN 125	1		15
Lock washer	B 6 DIN 127	1		16
Nut	M 6 DIN 934	1		17
Rubber sleeve	16 34 90 902	1		18
Washer	6,4 DIN 125	1		19
Lock washer	B 6 DIN 127	1		20
Nut	M 6 DIN 934	1		21
Screw	M 6x25 DIN 933	2		22
Washer	6,4 DIN 125	2		23
Lock washer	B 6 DIN 127	2		24
Nut	M 6 DIN 934	2		25
Bracket	16 31 00 087	1		26
Screw	M 4x10 DIN 85	2		27
Lock washer	B 4 DIN 137	4		28
Nut	M 4 DIN 934	2		29
Screw	M 4x10 DIN 85	2		30
Washer	4,3 DIN 125	2		31
Lock washer	B 4 DIN 127	2		32
Nut	M 4 DIN 934	2		33

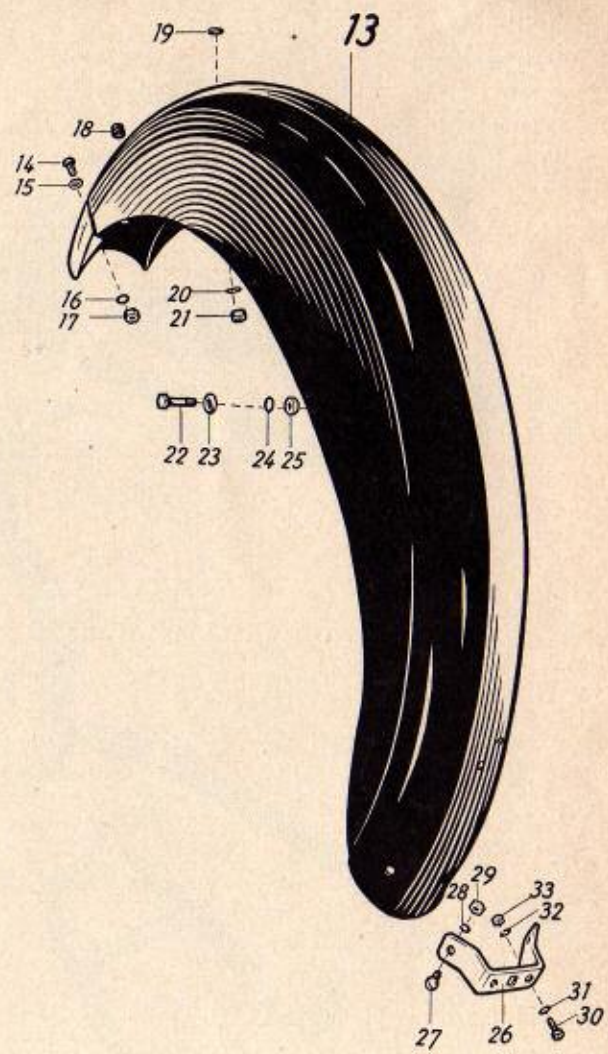
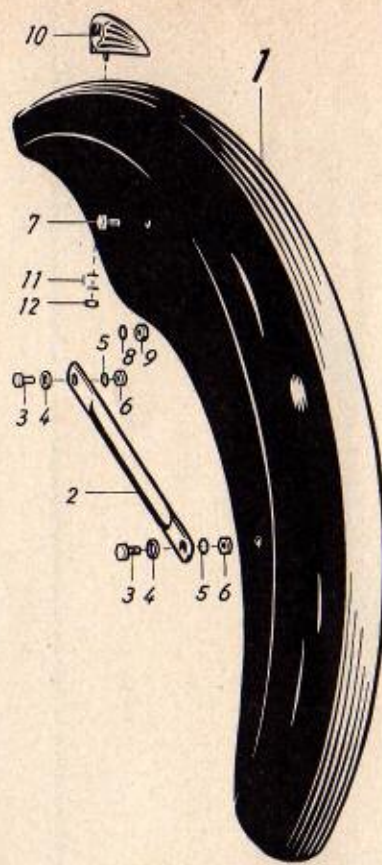

Description	Part-No.	No-used	Remarks	Fig.-No.
Dual seat	16 38 90 505	1		1
① Dual seat, lower part	16 38 90 918	1		2
Dual seat cover	16 38 90 919	1		3
Screw	M 6x18 DIN 933	2		4
Washer	6,4 DIN 125	2		5
Lock washer	B 6 DIN 127	2		6
Nut	M 6 DIN 934	2		7

① not supplied by itself

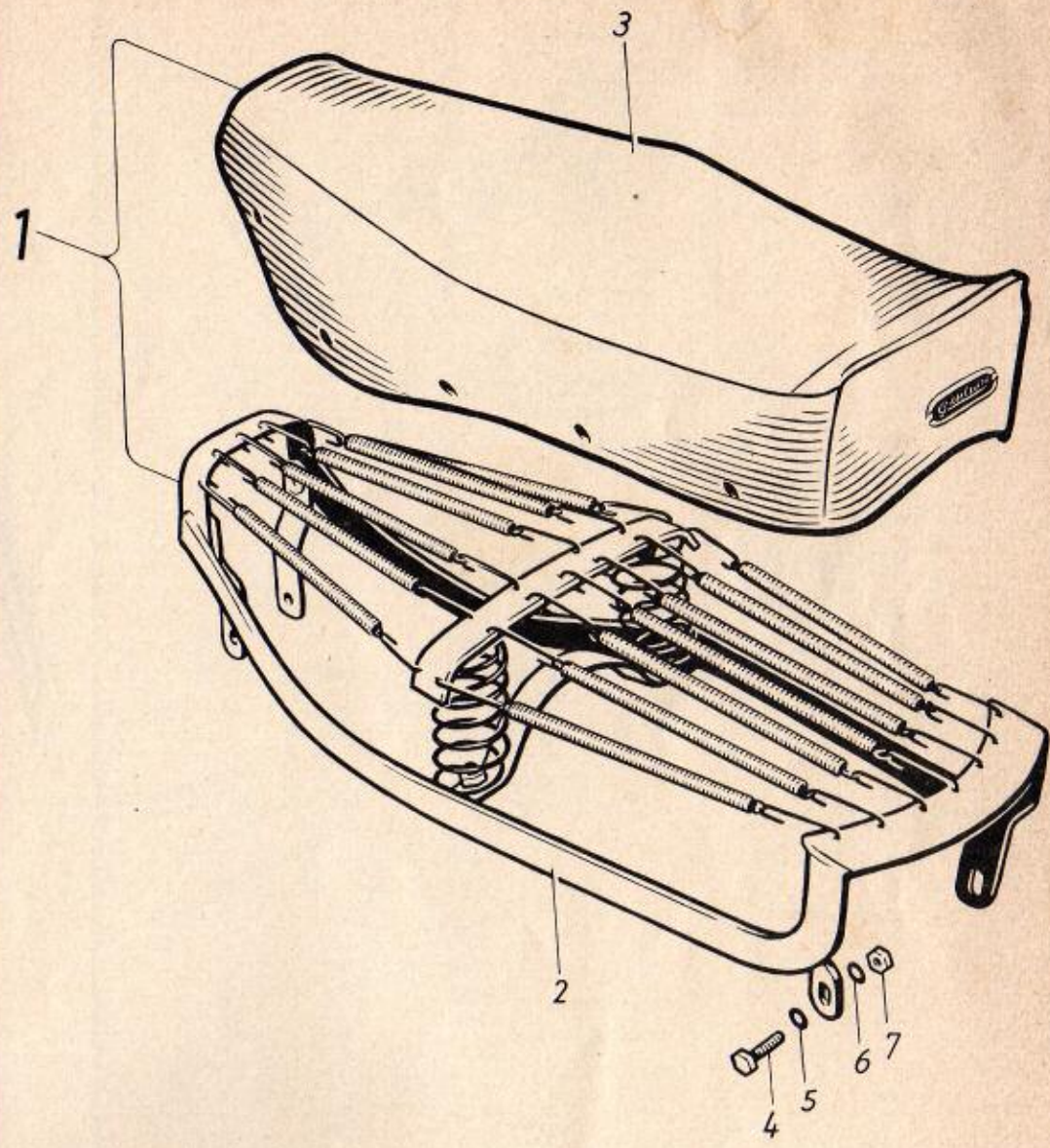

Description	Part-No.	No-used	Remarks	Fig.-No.
Spring fork	16 41 90 517	1		1
Spring fork	16 41 90 907	1		2
Cone, bottom	16 41 90 908	1		3
Ball	034 049 991	46	3/16"	4
Nut	16 41 90 909	1		5
Nut	16 41 90 905	1		6
<hr/>				
Fork tube, R. H. w/brake anchorage resistance	16 41 90 911	1		7
Fork tube, L. H.	16 41 90 915	1		8
Bush	16 41 90 904	4		9
<hr/>				
Retainer	16 41 90 912	4		10
Spring	16 41 90 906	2		11
Washer	8,4 DIN 125	2		13
Nut	M 8 DIN 1587	2		14
<hr/>				
① Steering-head lock	16 41 90 519	1		—
Cover plate	19 41 00 034	1		—
Grooved stud	3x8 DIN 1476	1		—
Spg. washer	A 3 DIN 137	1		—

① order spare keys from manufacturer

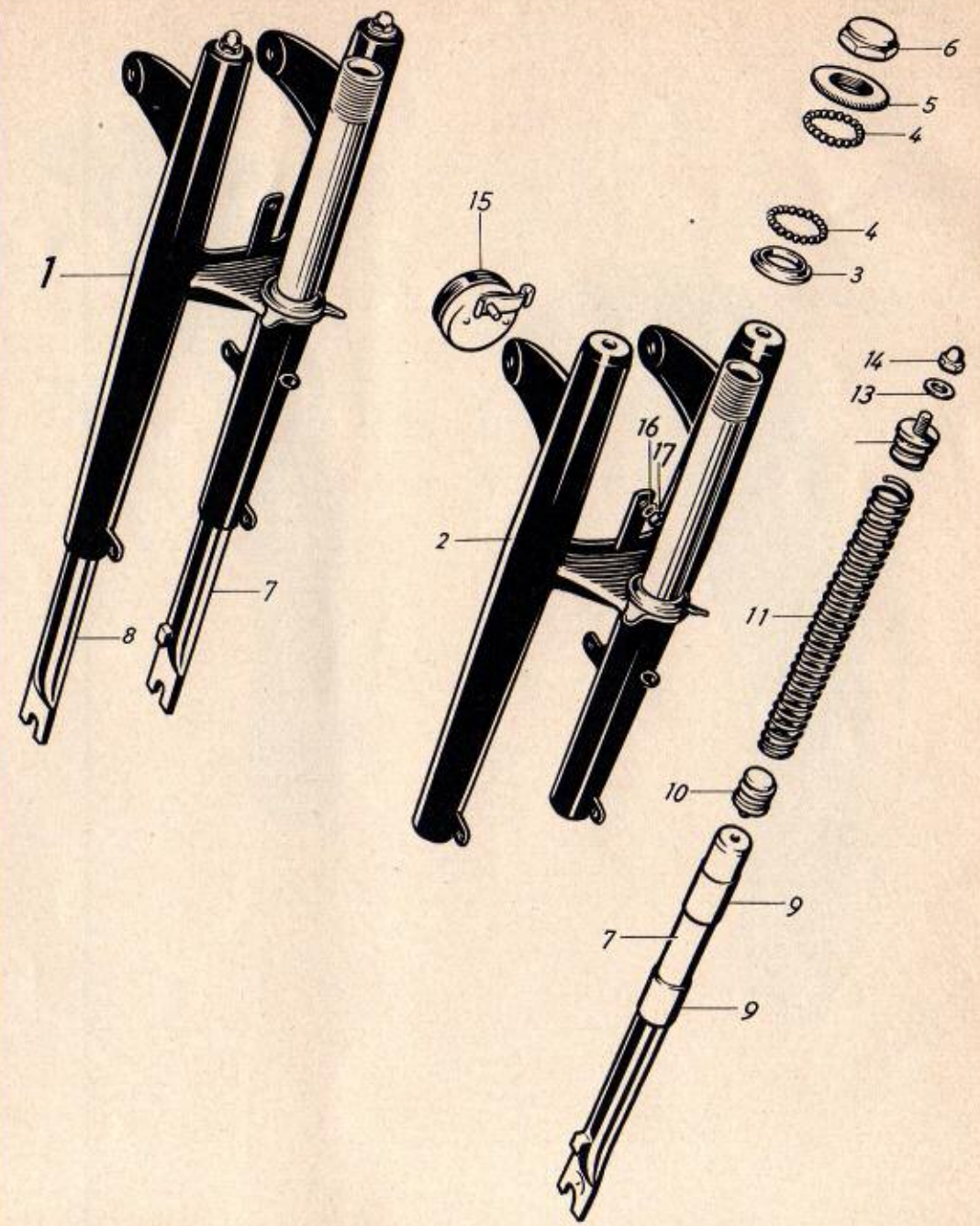

Description	1 2 3 4 5					Part-No.	No.-used	Remarks	Fig.-No.
	1	2	3	4	5				
Handlebar complete, w/fittings						16 43 90 900	1		1
① Nut							1		2
② Washer							2		3
③ Nut							2		4
Handlebar						16 43 90 524	1	→ 696 739/741 874	—
Handlebar w/fittings (adjustable)						16 43 91 900	1		—
Handlebar						16 43 91 524	1	696 740/741 875 →	5
Handlebar support						16 43 90 901	1		6
Pad						16 43 90 902	1		7
Bracket						16 43 90 903	2		8
Washer						6,4 DIN 125	4		9
Nut						M 6 DIN 934	4		10
Throttle twistgrip						16 43 03 502	1	w/o Fig.-No. 22, 23	11
Twistgrip housing						16 44 04 900	1		12
Adjusting screw						16 44 00 929	1	6 mm	13
Nut						M 6 DIN 439	1		14
Screw						044 413 608	1		15
Brake lever						16 44 00 902	1		16
Screw						16 44 00 903	1		17
Lock washer						J 5,3 DIN 6797	1		18
Nut						M 5 DIN 934	1		19
Twistgrip sleeve						16 44 03 901	1		20
Rubber grip						16 44 01 904	1		—
Washer						16 44 02 921	1		21

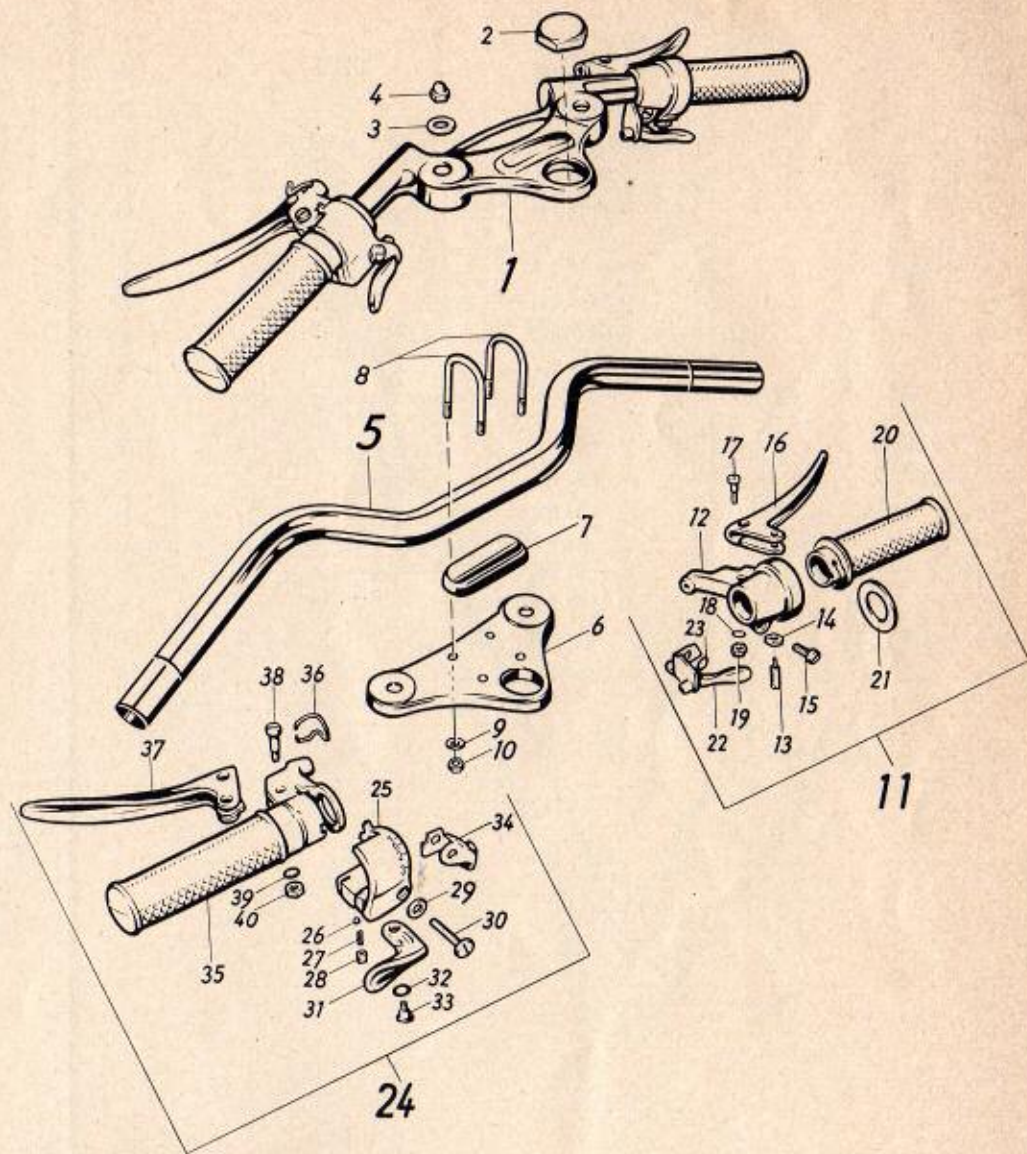

Description	Part-No.	No-used	Remarks	Fig.-No.
Gear change twistgrip with control levers for clutch and decompr.				
	16 43 02 503	1		24
Housing	16 44 04 905	1		25
Ball	11 13 00 780	1	4 mm \varnothing	26
Spring	16 44 00 911	1		27
Grub screw	014 106 433	1	M 5x4	28
Washer	6,4 DIN 125	1		29
Screw	16 44 00 913	1		30
Decompressor lever	16 44 00 909	1		31
Spg. washer	16 44 00 923	1		32
Screw	M 4x4 DIN 923	1		33
Support	16 44 00 916	1		34
Twistgrip sleeve	16 44 04 906	1		35
Rubber grip	16 44 00 904	1		—
Stirrup	16 44 00 910	1		36
Clutch lever	16 44 02 907	1		37
Bolt	16 44 00 908	1		38
Lock washer	J 5,3 DIN 6797	1		39
Nut	M 5 DIN 934	1		40

① see front fork, page 6
fig. 6, 13, 14

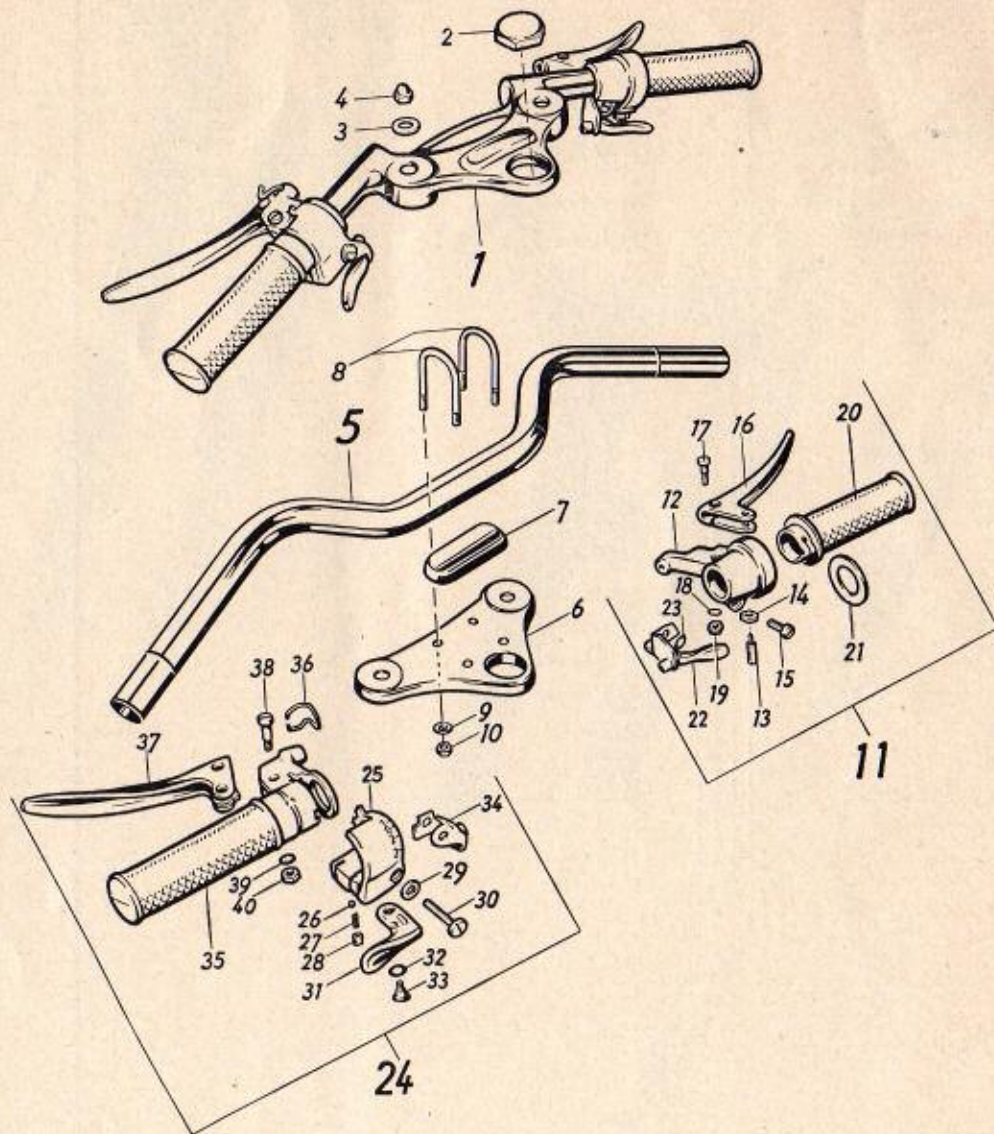

Description	Part-No.	No.-used	Remarks	Fig.-No.
Throttle control cable	16 44 00 519	1		—
Rubber sleeve	16 44 00 025	1		—
Hand-brake control cable	16 44 00 513	1		1
Hose	084 844 015	1		2
Yoke	16 53 00 013	1		3
Pivot pin	16 53 00 010	1		4
Washer	11 53 00 002	1		—
Clip	11 53 00 819	1		5
Screw	16 44 00 930	1		—
Nut	16 44 00 049	1		—
Clutch control cable	16 44 00 502	1		—
Gear change control cable	16 44 05 503	1		—
Nipple, bottom	16 44 00 056	2		—
Decompressor control cable	16 44 00 516	1		—
Nipple	16 44 00 511	1		—

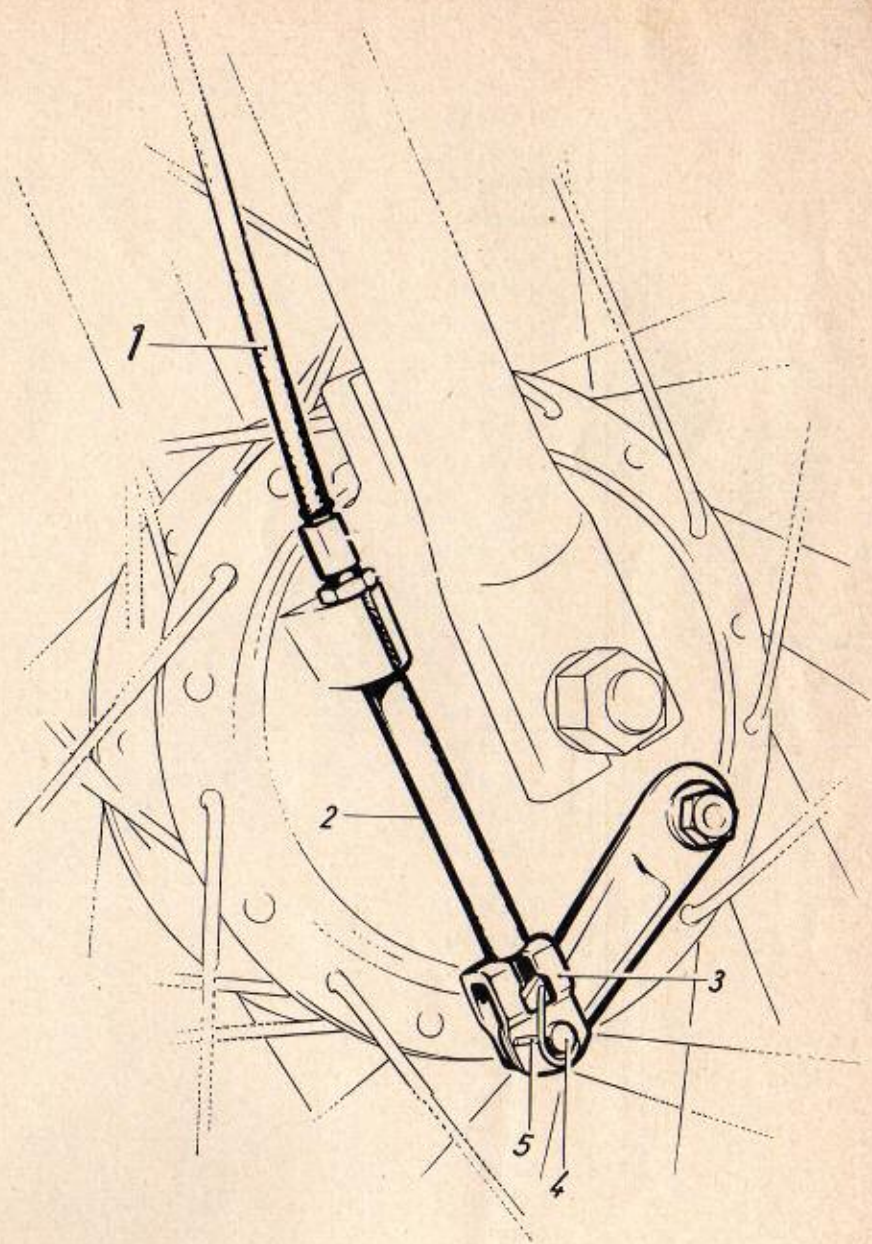

Description	Part-No.	No.-used	Remarks	Fig.-No.
Front wheel, w/o tyre and tube	16 51 90 521	1		—
Front wheel, w/o brake, w/o tyre and tube	16 51 90 916	1		—
Hub, compl.	16 51 90 904	1		—
Hub	16 51 90 907	1		1
Ball race	16 51 90 905	2		2
Ball	035 052 368	20	¼"	3
Washer	16 51 90 914	2		4
Felt ring	16 51 90 912	2		5
Cap	16 51 90 911	2		6
Front wheel axle	16 51 90 908	1		7
Cone	16 52 90 909	2		8
Shim	16 52 90 910	3		9
Nut	16 51 90 913	3		10
① Speedometer drive	—	—		11
Washer	16 52 90 913	2		12
Nut	16 52 90 914	2		13
Front wheel brake	16 51 90 909	1		14
Brake plate	16 51 90 910	1		15
Brake shoe (lower)	16 52 90 928	1		16
Brake shoe (upper)	16 52 90 906	1		—
Brake lining	16 52 90 908	2		17
Rivet	16 52 90 921	8		18
Spring	16 52 90 907	2		19
Brake cam	16 52 90 917	1		20
Washer	16 52 90 918	1		21
Brake lever	16 52 90 919	1		22
Washer	6,4 DIN 125	1		23
Nut	M 6 DIN 934	1		24
Rim	16 52 90 911	1		—
Spoke	16 51 90 906	36		—
Nipple	16 51 90 915	36		—
② Tyre	23x2,25	—		—
③ Inner tube	23x2,25	—		—
④ Well filler	23x2,00	—		—

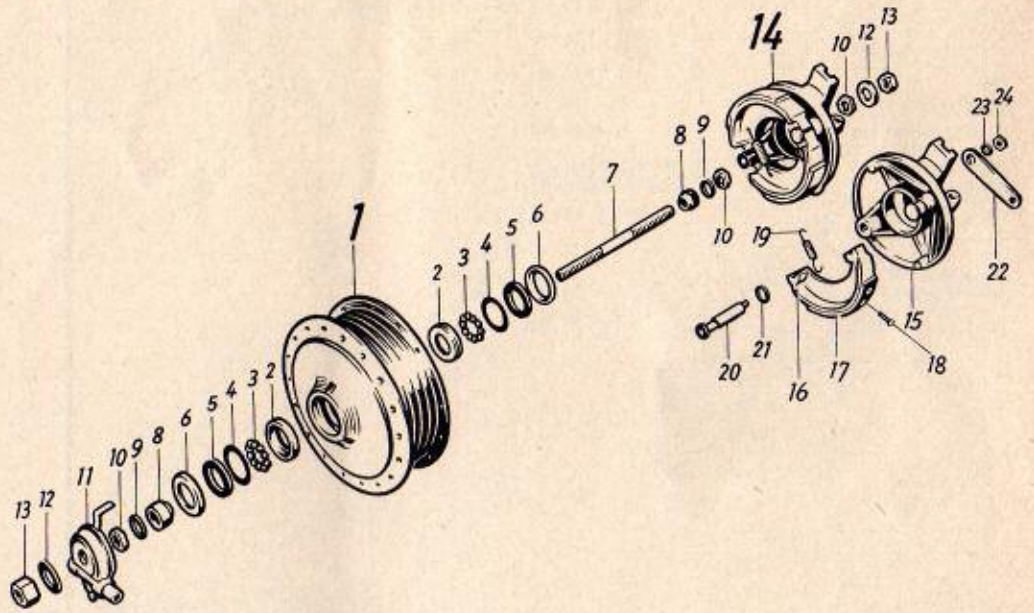

① see page 15
 ② not supplied

Description	Part-No.	No-used	Remarks	Fig.-No.
				1 2 3 4 5
Rear wheel, w/o tyre and tube	16 52 90 525	1		—
Rear wheel, w/o brake, w/o tyre and tube	16 52 90 925	1		—
Hub, compl.	16 52 90 926	1		—
Hub	16 52 90 922	1		1
Sprocket	16 52 90 927	1	T = 34	2
Lock plate	16 52 90 923	1		3
Screw	M 7x25 DIN 931	5		4
Nut	M 7 DIN 934	5		5
Rear wheel axle	16 52 90 924	1		6
Ball race	16 51 90 905	2		7
Ball	035 052 368	20	1/4"	8
Washer	16 51 90 914	2		9
Felt ring	16 51 90 912	2		10
Cap	16 51 90 911	2		11
Cone	16 52 90 909	2		12
Shim	16 52 90 910	3		13
Nut	16 51 90 913	3		14
Chain adjusting screw	16 52 90 912	2	M 6	15
Cap for adjusting screw	16 52 90 920	2		16
Nut	M 6 DIN 934	2		17
Washer	16 52 90 913	2		18
Nut	16 52 90 914	2		19
Rear wheel brake	16 52 90 915	1		20
Brake plate	16 52 90 916	1		21
Brake shoe (lower)	16 52 90 928	1		22
Brake lining	16 52 90 906	1		—
Brake shoe (upper)	16 52 90 908	2		23
Rivet	16 52 90 921	8		24
Spring	16 52 90 907	2		25
Brake spanner	16 52 90 917	1		26

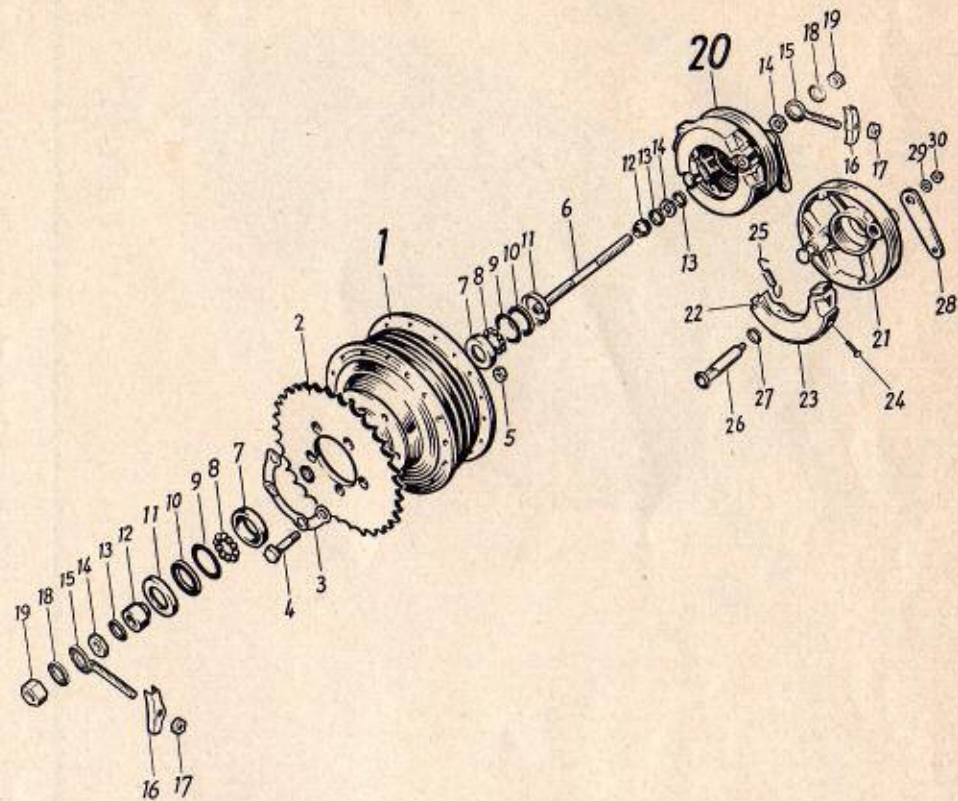

Description	Part-No.	No. used	Remarks	Fig.-No.
Washer	16 52 90 918	1		27
Brake lever	16 52 90 919	1		28
Washer	6,4 DIN 125	1		29
Nut	M 6 DIN 934	1		30
Rim	16 52 90 911	1		—
Spoke	16 51 90 906	36		—
Nipple	16 51 90 915	36		—
① Tyre	23x2,25	—		—
① Inner tube	23x2,25	—		—
① Well filler	23x2,00	—		—
Rear brake control cable	16 53 90 506	1		—
Hose	035 099 491	1	L = 85	—
Hose	16 53 00 018	1	L = 50	—
Yoke	16 53 00 013	2		—
Pivot pin	16 53 00 010	2		—
Washer	11 53 00 002	2		—
Clip	11 53 00 819	2		—
Sleeve	16 53 01 012	1		—
Chain	16 54 90 900	1	106 links 1x12,7x4,88 DIN 8180	—
Connecting link	16 54 01 601	1	1x12,7x4,88	—
Joggled link	16 54 00 603	1	12,7x4,88	—

① not supplied

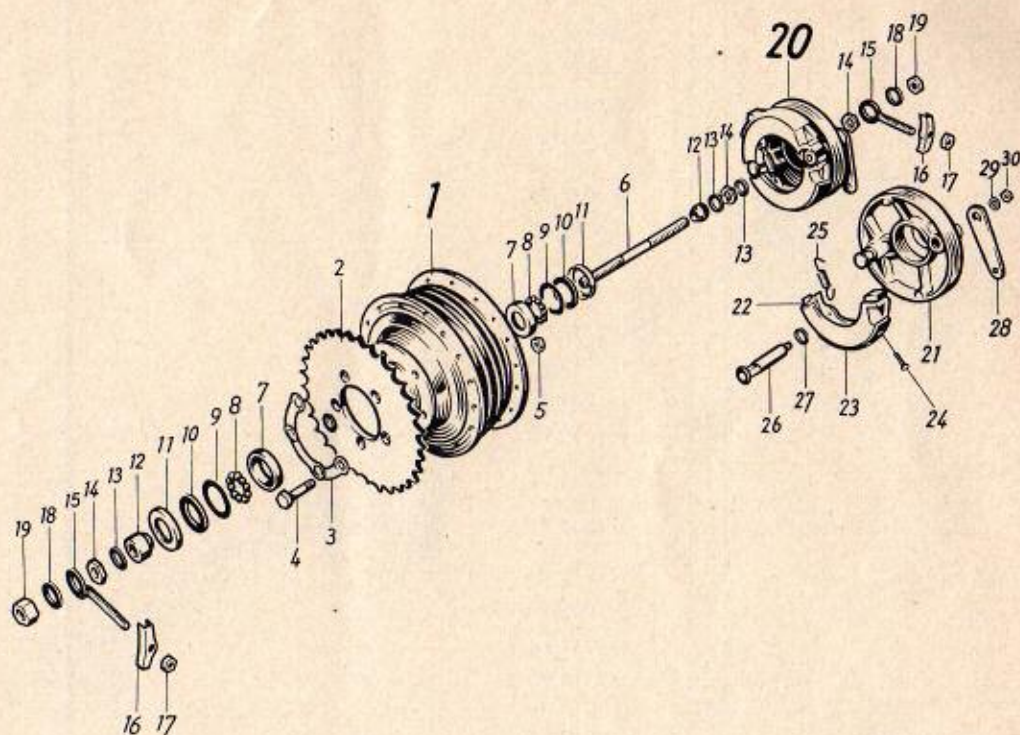

Description	Part-No.	No.-used	Remarks	Fig.-No.
Exhaust pipe	16 71 02 005	1		1
Seal ring	16 71 00 002	2		2
Union	16 71 00 001	1		3
Silencer assy	16 71 03 502	1		1
Silencer body	16 71 02 505	1		1
Baffle	16 71 01 009	1		1
Lock washer	J 4,3 DIN 6798	1		1
Screw	M 4x8 DIN 86	1		1
Silencer bracket	16 71 03 008	1		1
Clip	16 71 00 006	1		1
Screw	M 5x18 DIN 933	1		1
Spg. washer	A 5 DIN 137	2		1
Nut	M 5 DIN 934	1		1
Screw	M 6x20 DIN 933	1		1
Spg. washer	B 6 DIN 137	2		1
Nut	M 6 DIN 934	1		1
Fuel tank	16 72 90 510	1		1
Filler cap	16 72 00 504	1		2
Gasket	16 72 00 024	1		3
Transfer	16 72 90 039	2		1
Base	083 872 018	1		1
Rubber ring	16 72 90 907	4		4
Spacer ring	16 72 90 908	4		5
Washer	6,4 DIN 125	2		6
Lock washer	B 6 DIN 127	2		7
Screw	M 6x18 DIN 933	2		8
Stud	16 72 90 909	1	M 7	9
Washer	7,4 DIN 125	2		10
Nut	M 7 DIN 934	2		11
Fuel tap	16 72 90 516	1		12
Sealing ring	A 10x14 DIN 7603	2		13
Hose	16 72 91 911	1	L = 200	14
Sleeve	023 104 269	2		14

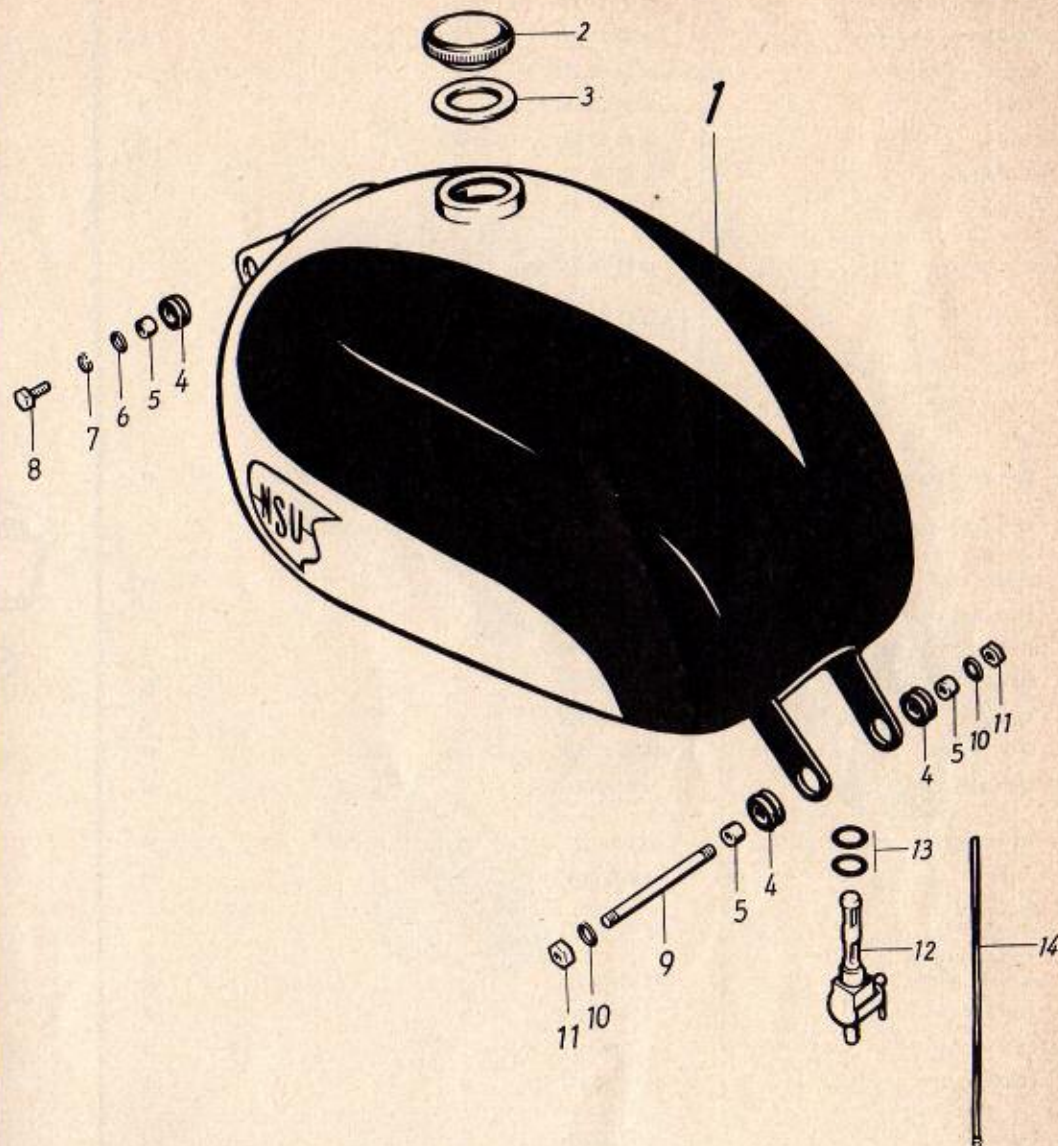

Description	Part-No.	No-used	Remarks	Fig.-No.
	1 2 3			
Headlamp with dipper switch and horn button	16 81 90 529	1		1
Headlamp adapter	16 81 50 945	1		2
Glass retainer ring	16 81 54 914	1		3
Lens	16 81 54 915	1		4
Spring	16 81 50 944	3		5
Reflector	16 81 54 923	1		6
Spring	16 81 50 946	1		—
Spring	16 81 50 947	1		—
Socket	16 81 50 948	1		—
Screw	M 4x5x1,6 DIN 922	4		—
Screw	M 2,6x6 DIN 84	1		—
Bulb for headlamp	016 096 826	1	C 6 V 15/15 W	11
Bulb for headlamp	16 81 00 514	1	C 6 V 15/15 W	—
Switch lever	16 81 52 905	1		12
Insulation plate	16 81 50 933	1		13
Contact-plate	16 81 51 920	1		14
Contact-bridge	16 81 51 906	1		15
Spring	16 81 51 907	1		16
U-washer	16 81 51 908	1		17
Split pin	1x15 DIN 94	1		18
Spring-washer	B 8 DIN 127	2		19
Screw	M 8x12 DIN 933	2		20
Rubber ring for cable	16 81 51 912	2		21
Rubber ring for flexible drive	16 81 50 934	1		22
Angle	16 81 50 910	1		23
Spg. washer	A 4 DIN 137	1		24
Knurled screw	16 81 50 911	1		25
Dipswitch and horn button	16 81 50 904	1		—
Strap for dipswitch	16 81 50 927	1		—
Lead	16 81 50 903	1		—

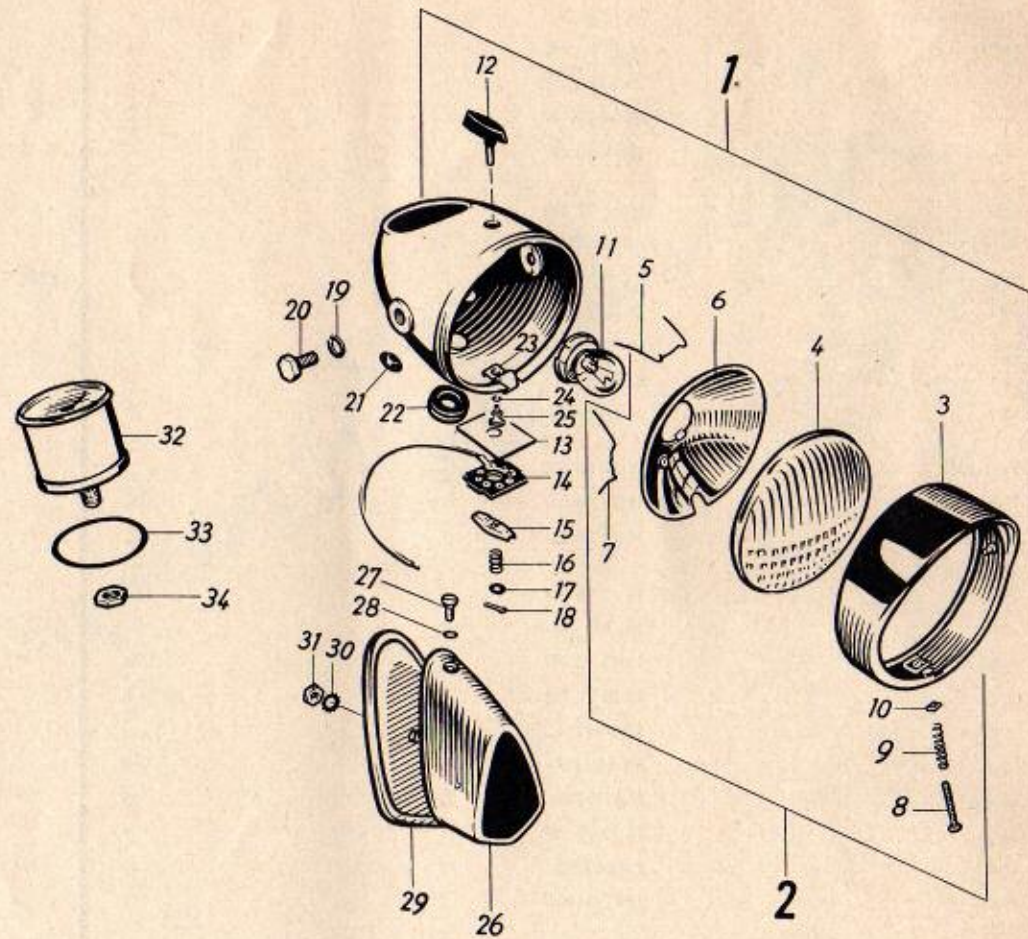

Description	Part-No.	No.-used	Remarks	Fig.-No.
Tail lamp	16 81 02 502	1		—
Cap	16 81 51 901	1		26
Screw for cap	16 81 51 900	1		27
Spring clip	16 81 50 941	1		28
Rubber pead	16 81 02 002	1		29
Lock washer	A 5,3 DIN 6798	1		30
Nut	M 5 DIN 934	1		31
Bulb	026 104 311	1	H 6 V, 2 W	—
Speedometer (miles)	16 92 90 509	1		32
Gasket ring	16 92 91 909	1		33
Nut	16 92 90 910	1		34
Speedometer drive (flexible shaft)	16 92 90 508	1	L = 700	—
① Speedometer drive gear	16 92 90 507	1		—
Cable harness	16 81 90 528	1		—
Protective sleeve	16 81 00 012	1		—
Cable (engine - headlamp)	16 81 00 007	1		—
Cable (headlamp - rearlamp)	16 81 01 001	1		—
Rattle	16 81 90 506	1		—
Cable for rattle	16 81 00 003	1		—
Screw	M 7x15 DIN 933	1		—
Washer	7,4 DIN 125	1		—
Spg. washer	B 7 DIN 137	1		—
Nut	M 7 DIN 934	1		—

① see front wheel, page 10, fig. 11

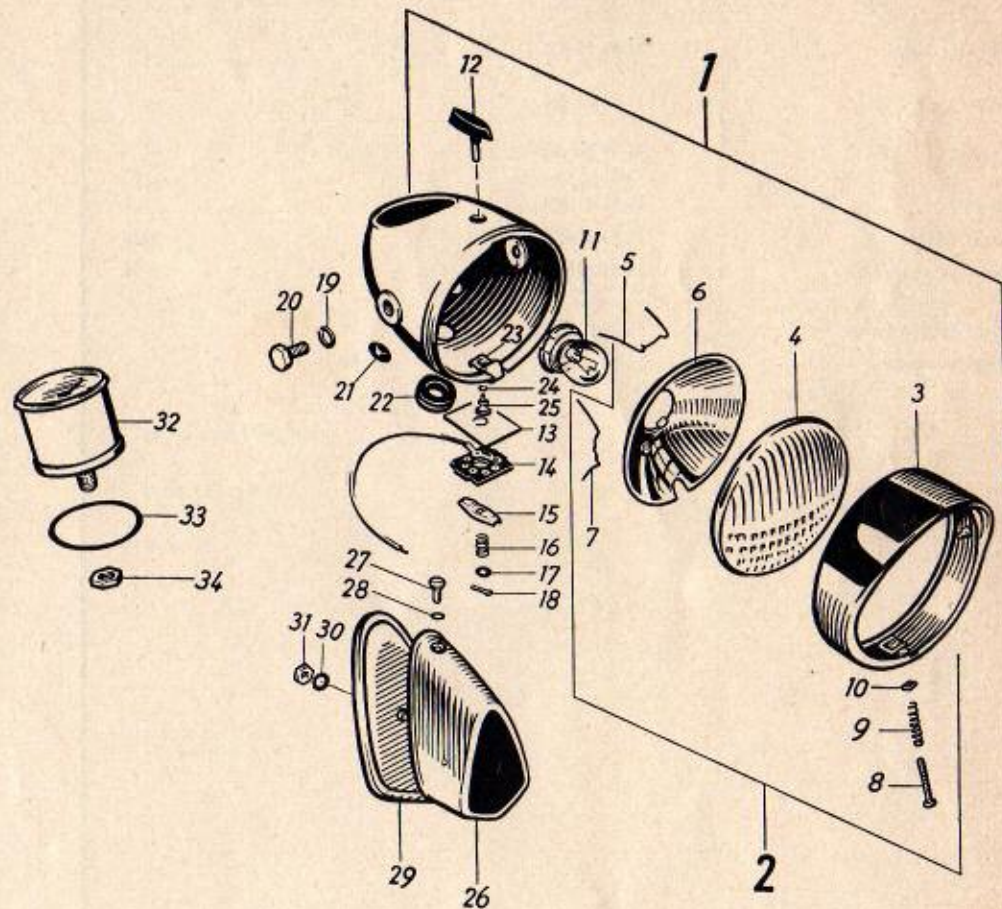

Description	Part-No.	No.-used	Remarks	Fig.-No.
Tool box	16 73 90 504	1		1
Screw for lid	16 73 90 902	1		2
Nut	16 73 90 903	1		3
Screw	M 6x12 DIN 933	2		4
Spg. ring	B 6 DIN 127	2		5
Washer	6,4 DIN 125	2		6
Tool kit, compl.	16 91 90 920	1		—
Spanner	11 91 00 600	1	8x9	7
Spanner	11 91 00 601	1	10x11	8
Spanner	16 91 01 004	1		9
Screw driver	16 91 00 003	1		10
Spark plug spanner	16 91 00 002	1		11
Tyre inflation pump	16 93 01 502	1		—
Luggage carrier	16 93 90 904	1	optinal	—

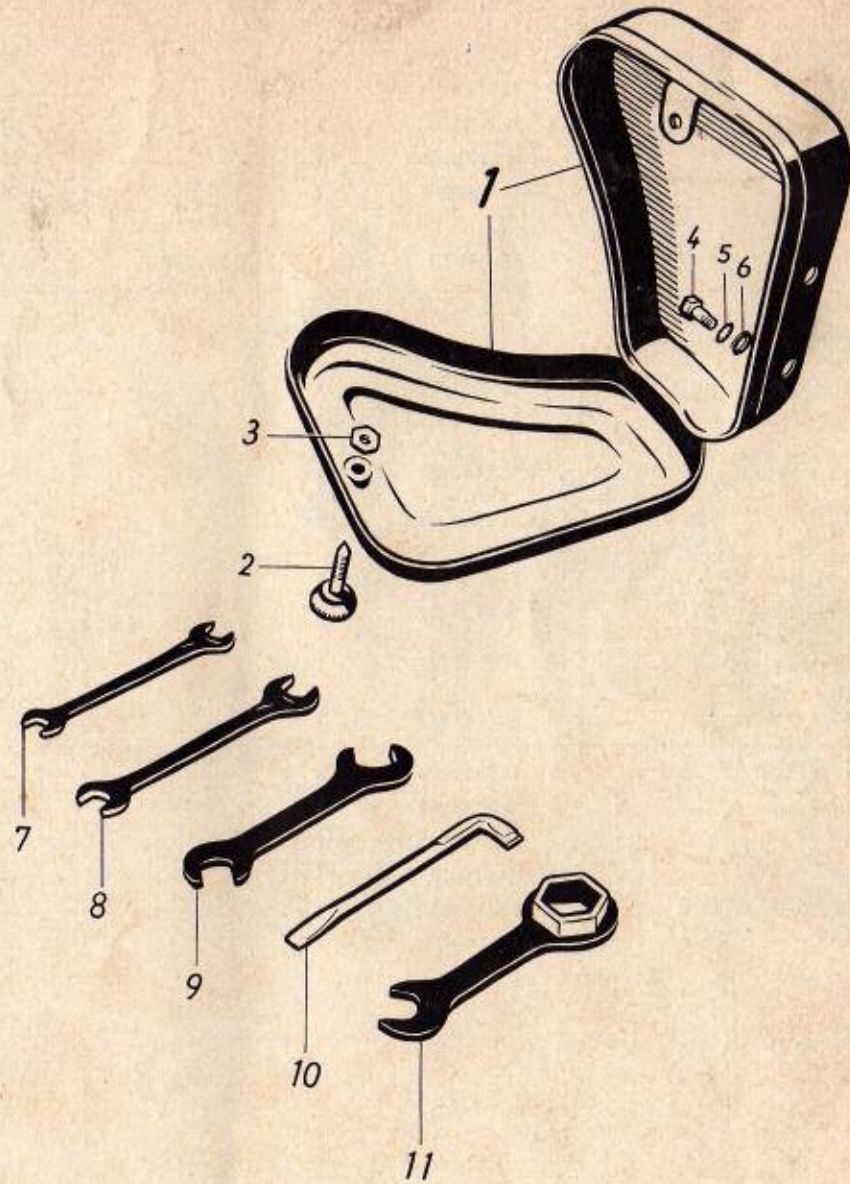

IceniCAM Information Service

