

IceniCAM Information Service



RECEIVED

25 MAY/63.

Hercules *Corvette*

**ILLUSTRATED
SPARE PARTS
PRICE LIST**

Published by

THE HERCULES CYCLE & MOTOR CO. LTD
BRITANNIA WORKS · HANDSWORTH · BIRMINGHAM, 21



When ordering spare parts, please quote list numbers and also the number of the engine for which the parts are required. The engine number is stamped on the crankcase.

When in doubt, send the old part as a pattern. All parts sent as patterns are not returned unless their return is requested on the order.

The cash price of the articles required should accompany all orders together with the cost of postage and packing as follows:—

Orders to the value of £1 and under 1s. 0d.

Order over £1 in value 2s. 0d.

Orders received without cash will be supplied C.O.D. but as the minimum C.O.D. and postal charges amount to 2/8d. per package, it is in customers' interests always to remit cash with orders.

The prices shown in this list are subject to alteration at any time without notice.

THE HERCULES CYCLE & MOTOR CO. LTD.

BRITANNIA WORKS, HANDSWORTH, BIRMINGHAM, 21.

TELEGRAMS CYMO. BIRMINGHAM.

TELEPHONE SMETHWICK 1414

LONDON OFFICE: 3 SOHO SQUARE, LONDON SW1 TEL: GERRARD 7544

INDEX

ENGINE	4-5-6
EXHAUST SYSTEM	6
CLUTCH	7
MAGNETO	8 - 9
CARBURETTOR	10-11
FRAME	12-13
TELESCOPIC FORK	14-15
FAIRINGS and MUDGUARDS	16-17
WHEELS	18-19
HANDLEBAR and CONTROLS	20-21
LAMPS and HORN	22-23

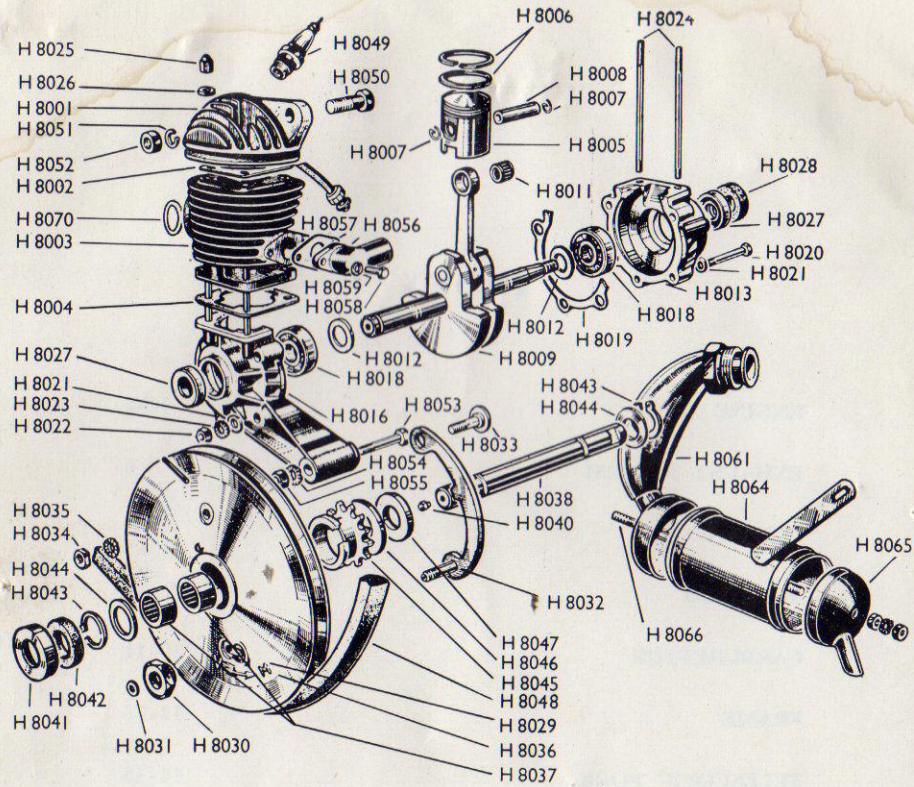

ENGINE

List No.	Description	No. Off	Retail Price Each
			£ s. d.
H.8001	Cylinder head	1	1 1 5
H.8002	Cylinder head gasket	1	10
H.8003	Cylinder	1	3 4 4
H.8004	Cylinder gasket	1	5
H.8005	Piston	1	1 1 7
H.8006	Piston Ring	2	1 8
H.8007	Circlip	2	3
H.8008	Gudgeon pin	1	3 6

ENGINE—continued

List No.	Description	No. Off	Retail Price Each
			£ s. d.
H.8009	Con rod assembly	1	4 16 6
H.8011	Roller bearing	1	5 4
H.8012	Shim	2	3
H.8013	Crankcase R.H. with ball bearing	1	1 5 4
H.8016	Crankcase L.H. with ball bearing	1	1 7 7
H.8018	Ball bearing	2	9 9
H.8019	Crankcase gasket	1	6
H.8020	Studs	5	8
H.8021	Washers	10	2
H.8022	Nuts	5	3
H.8023	Spring Washers	5	2
H.8024	Cylinder studs	4	10
H.8025	Nuts	4	7
H.8026	Washers	4	4
H.8027	Oil seals	2	2 2
H.8028	Felt disc	1	7
H.8029	Pulley assembly, (comp. H.8030—H.8037)	1	2 5 0
H.8030	Knob	1	9
H.8031	Washer	1	2
H.8032	Lever	1	4 1
H.8033	Stud	1	11
H.8034	Nut	1	5
H.8035	Spring washer	1	2
H.8036	Pulley	1	1 9 11
H.8037	Roller bearings	2	4 10
H.8038	Pedal shaft	1	9 11
H.8040	Lubricator	1	9

ENGINE—continued

List No.	Description	No. Off	Retail Price Each		
			£	s.	d.
H.8041	Cover	1		11	
H.8042	Felt	1		4	
H.8043	Circlip	2		7	
H.8044	Shim	2		6	
H.8045	Sprocket	1	8	9	
H.8046	Distance piece	1	1	5	
H.8047	Washer	1		6	
H.8048	V Belt	1	7	5	
H.8049	Sparking plug	1	5	0	
H.8050	Bolt, engine mounting, upper	1	1	0	
H.8051	Spring washer	1		2	
H.8052	Nut	1		7	
H.8053	Bolt, engine mounting, lower	1	1	3	
H.8054	Spring washer	1		2	
H.8055	Nut	1		5	
H.8056	Induction pipe	1	3	9	
H.8057	Induction gasket	1		6	
H.8058	Studs	2		4	
H.8059	Spring washers	2		2	

EXHAUST SYSTEM

List No.	Description	No. Off	Retail Price Each		
			£	s.	d.
H.8060	Exhaust assembly	1	1	5	8
H.8061	Exhaust pipe with nut	1	12	10	
H.8064	Silencer	1	8	2	
H.8065	Silencer outlet	1	3	9	
H.8066	Pin assembly, with nuts and washers	1	1	4	
H.8070	Exhaust joint	1		6	

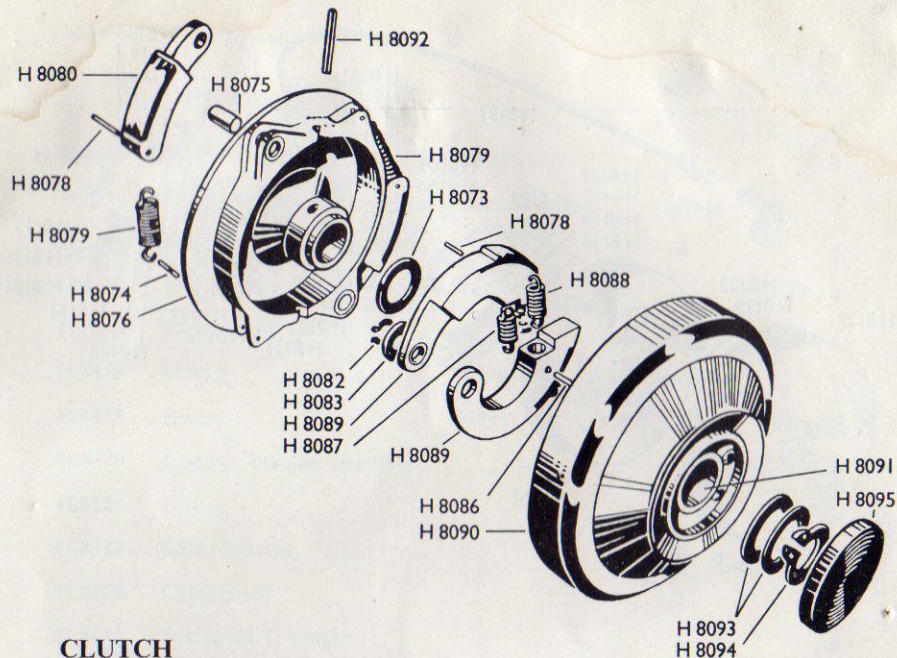

CLUTCH

List No.	Description	No. Off	Retail Price Each		
			£	s.	d.
H.8071	Clutch assembly	1	3	15	9
H.8072	Drive clutch assy, (comp. H.8073—H.8077)	1	1	5	3
H.8073	Washer	1		4	
H.8074	Pins	2		3	
H.8075	Pivots	2		6	
H.8076	Clutch plate	1	10	3	
H.8077	Weights assembly	2	6	9	
H.8078	Pin only for H.8077	2		3	
H.8079	Spring only for H.8077	2		8	
H.8080	Weight only for H.8077	2		6	0
H.8081	Clutch pulley assembly	1	2	8	9
H.8082	Circlip	1		5	
H.8083	Washer	1		3	
H.8084	Locking weight assembly with spring and pin	1	6	10	
H.8085	Starting weight with spring and pin	1	6	10	
H.8086	Pin for H.8084 or H.8085	2		3	
H.8087	Spring for H.8084	1		5	
H.8088	Spring for H.8085	1		5	
H.8089	Weight only for H.8084 or H.8085	2		6	4
H.8090	Pulley assembly	1	1	14	7
H.8091	Roller bearing	1	8	9	
H.8092	Pin	1		4	
H.8093	Shims	1		4	
H.8094	Circlip	1		6	
H.8095	Cover	1		11	

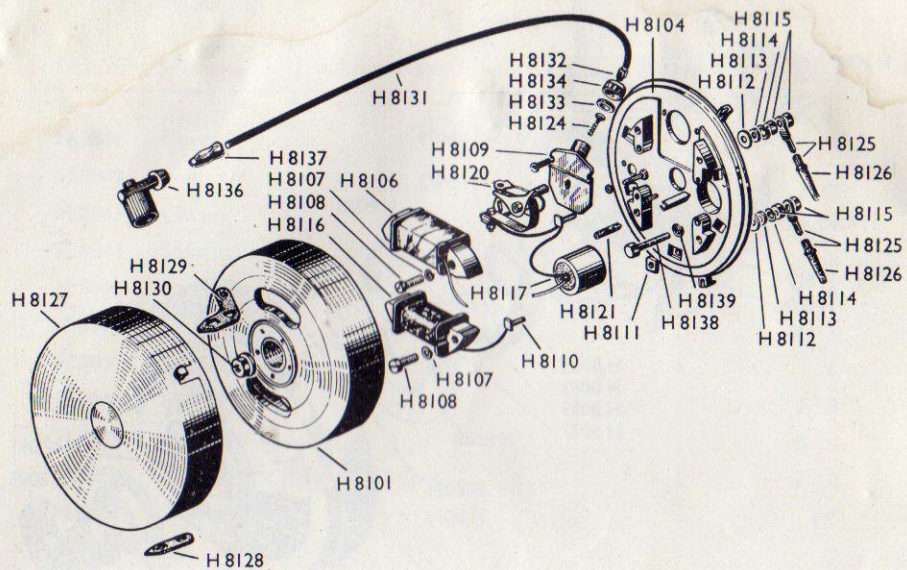

MAGNETO

List No.	Description	No. Off	Retail Price Each		
			£	s.	d.
H.8100	Magneto	1	8	5	2
H.8101	Rotor	1	3	18	8
H.8102	Back plate assembly	1	4	3	8
H.8103	Back plate with pivot	1	9	5	
H.8104	Back plate only	1	8	6	
H.8105	Pivot	1	1	1	
H.8106	H.T. Coil	1	1	12	0
H.8107	Spring washers for coil screws	4			2
H.8108	Screws for coils	4			5
H.8109	H.T. Plug	1	2	2	
H.8110	Terminals (lighting and earth)	2			5
H.8111	Insulators (terminals)	2			3
H.8112	Washers insulating (terminals)	2			2

MAGNETO—continued

List No.	Description	No. Off	Retail Price Each		
			£	s.	d.
H.8113	Washers (terminals and breaker screw)	3			2
H.8114	Spring washers (terminals and breaker screw)	3			2
H.8115	Nuts (terminals)	4			4
H.8116	Coil lighting	1	17		4
H.8117	Condenser	1	8		2
H.8118	Shim	as req'd			2
H.8119	Rivets	2			2
H.8120	Contact breaker assembly	1	11		4
H.8121	Felt	1			2
H.8122	Cable breaker	1			4
H.8123	Cable earth	1			4
H.8124	Spring (H.T. Plug)	1			8
H.8125	Terminals (earth and lighting)	2			5
H.8126	Protecting caps	2			2
H.8127	Cover plastic	1	6		9
H.8128	Attachment rubbers	2			5
H.8129	Attachment rubbers	1			7
H.8130	Nut	1	1		4
H.8131	H.T. Cable comp. H.8132—H.8136	1	3		11
H.8132	Terminal	1			3
H.8133	Joint	1			5
H.8134	Nut	1			6
H.8135	Lead	1			7
H.8136	Plug cap with clip	1	2		1
H.8137	Clip	1			6
H.8138	Screws (back plate)	2			6
H.8139	Spring washers	2			2

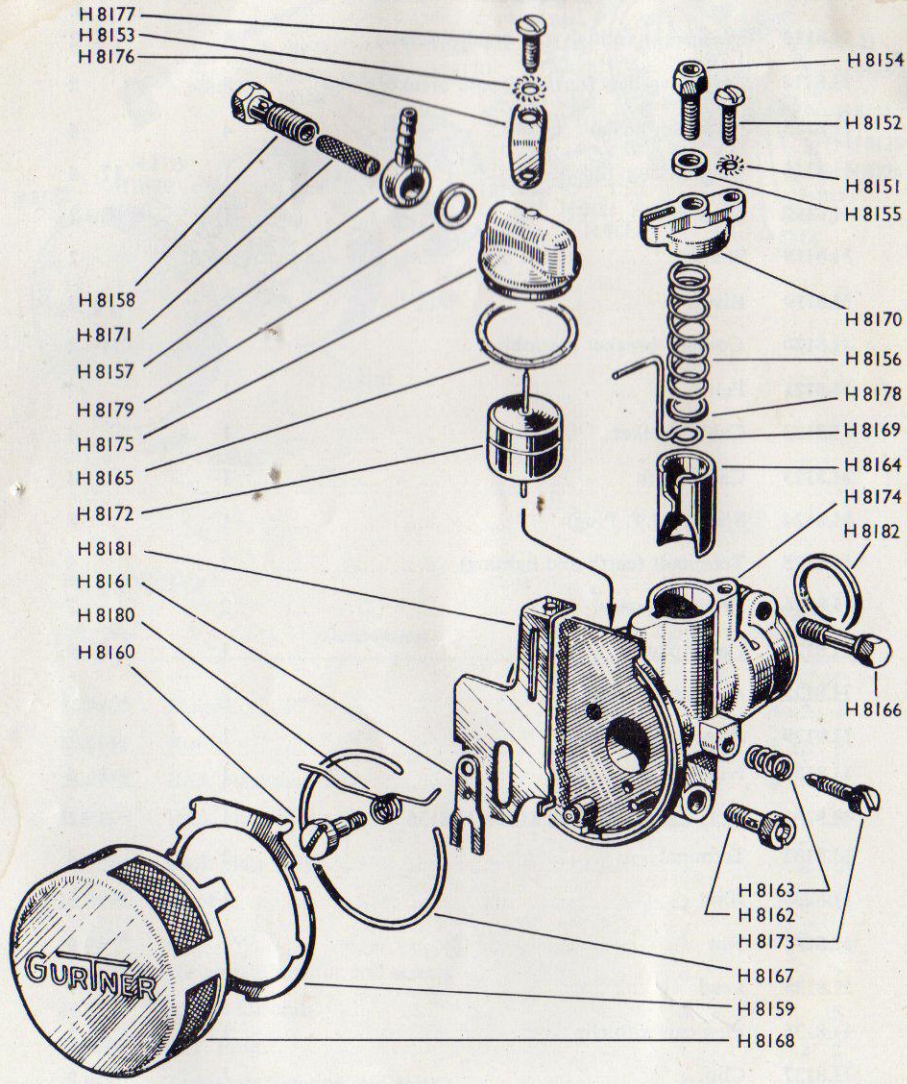

CARBURETTOR

List No.	Description	No. Off	Retail Price Each
			£ s. d.
H.8150	Carburettor	1	2 17 0
H.8151	Washer	1	2
H.8152	Screw	1	3
H.8153	Washer	1	2
H.8154	Screw adjuster	1	8
H.8155	Nut	1	2
H.8156	Spring	1	6
H.8157	Connection banjo	1	2 1
H.8158	Plug	1	2 10
H.8159	Washer	1	3
H.8160	Choke screw	1	4
H.8161	Spring	1	7
H.8162	Jet	1	2 2
H.8163	Spring	1	4
H.8164	Sleeve	1	3 3
H.8165	Gasket	1	4
H.8166	Screw	1	7
H.8167	Snap ring	1	5
H.8168	Air filter	1	5 3
H.8169	Choke lift	1	5
H.8170	Cap	1	3 6
H.8171	Fuel filter	1	11
H.8172	Float	1	4 7
H.8173	Screw	1	11
H.8174	Housing	1	1 2 5
H.8175	Cover	1	4 6
H.8176	Cover block	1	11
H.8177	Screw	1	5
H.8178	Washer	1	2
H.8179	Washer	1	2
H.8180	Spring	1	3
H.8181	Starting choke	1	9
H.8182	Washer	1	3

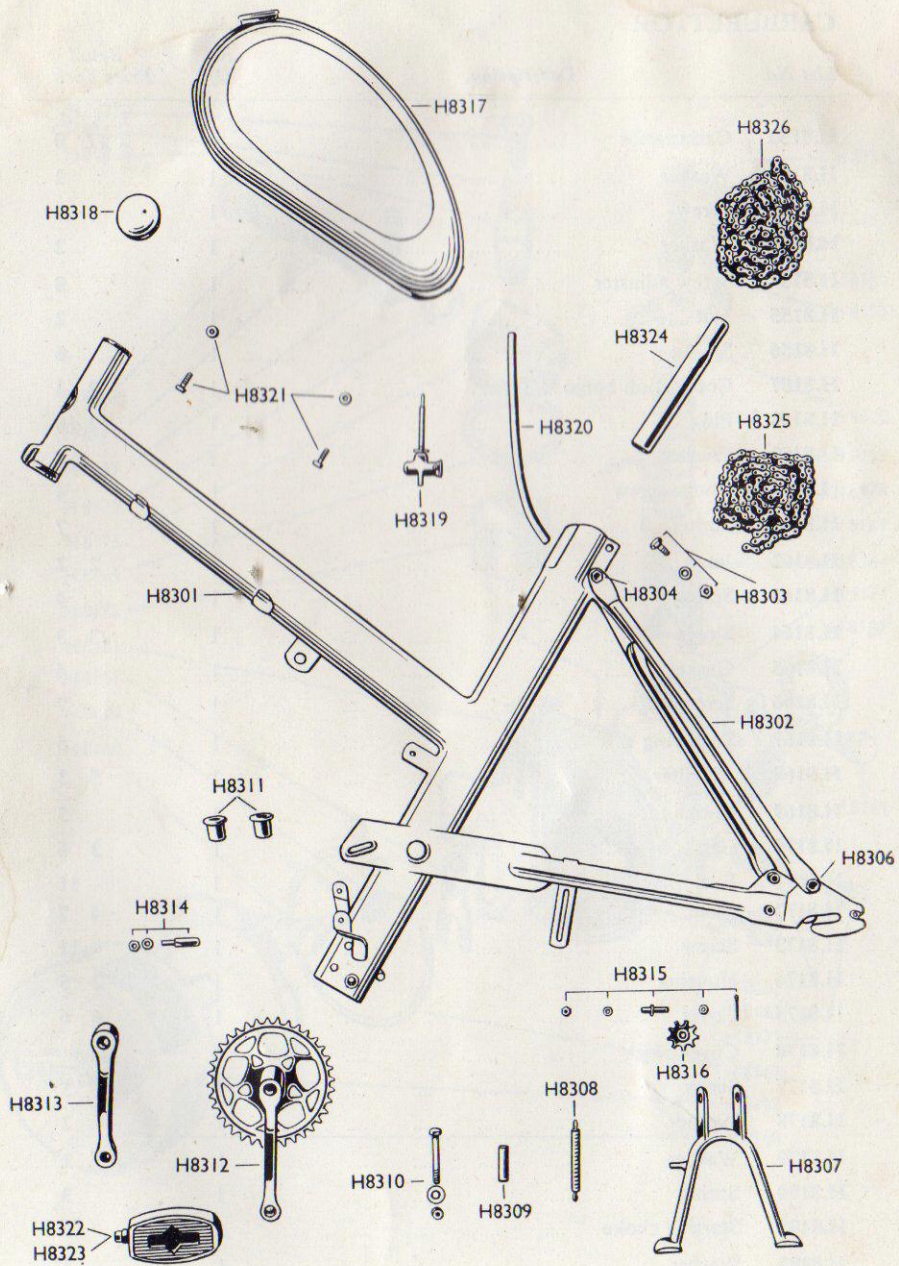

FRAME

List No.	Description	No. Off	Retail Price Each		
			£	s.	d.
H.8301	Skeleton frame, with seat stay	1	7	0	0
H.8302	Seat stay only	1 pr.	13	0	
H.8303	Seat lug pin, nut and washer	1		7	
H.8304	Seat stay pin, nut, washer and bushes	1	1	2	
H.8305	Bush, for seat stay pin unit	2		3	
H.8306	Pin, nut and washer (seat and chain stay)	2		7	
H.8307	Centre stand without loose fittings	1	11	6	
H.8308	Spring, for centre stand	1		7	
H.8309	Bush, for centre stand	1		8	
H.8310	Bolt, nut and washer, for centre stand	1		10	
H.8311	Bracket bush, for pedal shaft	2	1	6	
H.8312	Chainwheel 36T, with R.H. Crank	1 set	13	2	
H.8313	Crank L.H.	1	6	3	
H.8314	Cotter pin with nut and washer	2		5	
H.8315	Pin, nut, washers and split pin for idler sprocket	1	1	0	
H.8316	Idler sprocket	1	1	4	
H.8317	Tank	1	3	0	0
H.8318	Filler cap	1	3	6	
H.8319	Petrol tap	1	7	2	
H.8320	Petrol pipe	1	1	2	
H.8321	Pin and washer, for tank fixing	4		5	
H.8322	Pedal R.H.	1	5	6	
H.8323	Pedal L.H.	1	5	6	
H.8324	Seat pillar	1	2	6	
H.8325	Chain, pedal	1	8	0	
H.8326	Chain, drive	1	15	0	

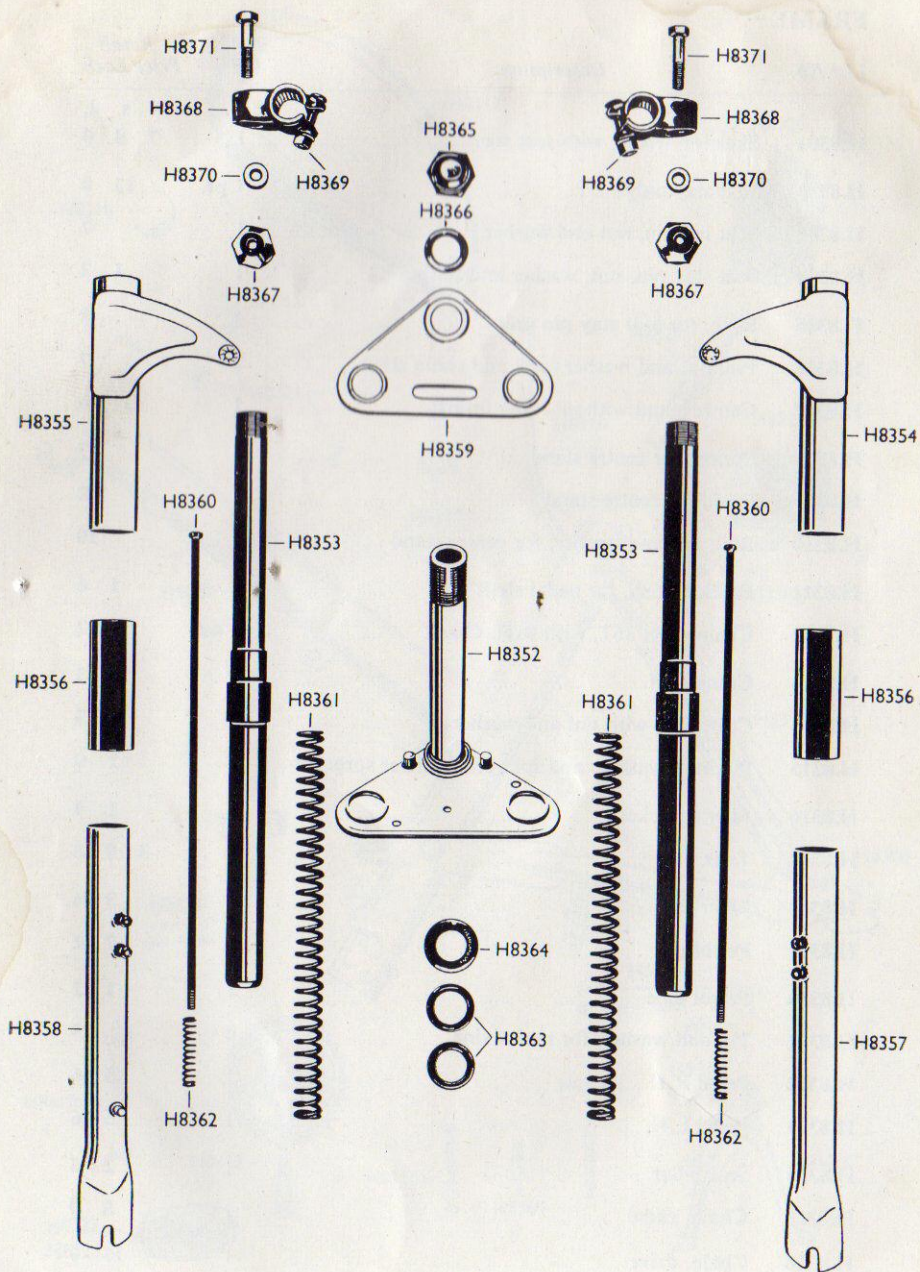

TELESCOPIC FORK

<i>List No.</i>	<i>Description</i>	<i>No. Off</i>	<i>Retail Price Each</i>
			£ s. d.
H.8351	Telescopic fork complete....	1	5 10 0
H.8352	Centre column with crown race....	1	10 0
H.8353	Side column....	2	1 2 0
H.8354	Upper sleeve R.H....	1	5 0
H.8355	Upper sleeve L.H....	1	5 0
H.8356	Lower sleeve....	2	1 11
H.8357	Fork tube R.H....	1	12 0
H.8358	Fork tube L.H....	1	10 6
H.8359	Top plate....	1	2 4
H.8360	Securing rod....	2	1 8
H.8361	Compression spring, large....	2	2 4
H.8362	Compression spring, small....	2	4
H.8363	Ball race....	2	5
H.8364	Screwed race....	1	11
H.8365	Domed nut, centre column....	1	1 2
H.8366	Spacer washer, centre column....	1	4
H.8367	Helmet nut, side column....	2	2 0
H.8368	Handlebar lug, with bolt, nut and washer....	2	5 8
H.8369	Bolt, nut and washer for handlebar lug....	2	7
H.8370	Spacer washer, for handlebar lug....	2	3
H.8371	Fixing bolt for handlebar lug....	2	8
H.8372	Nut for fork tubes, R.H. or L.H....	4	1
H.8373	Washer for fork tubes, R.H. or L.H....	4	1

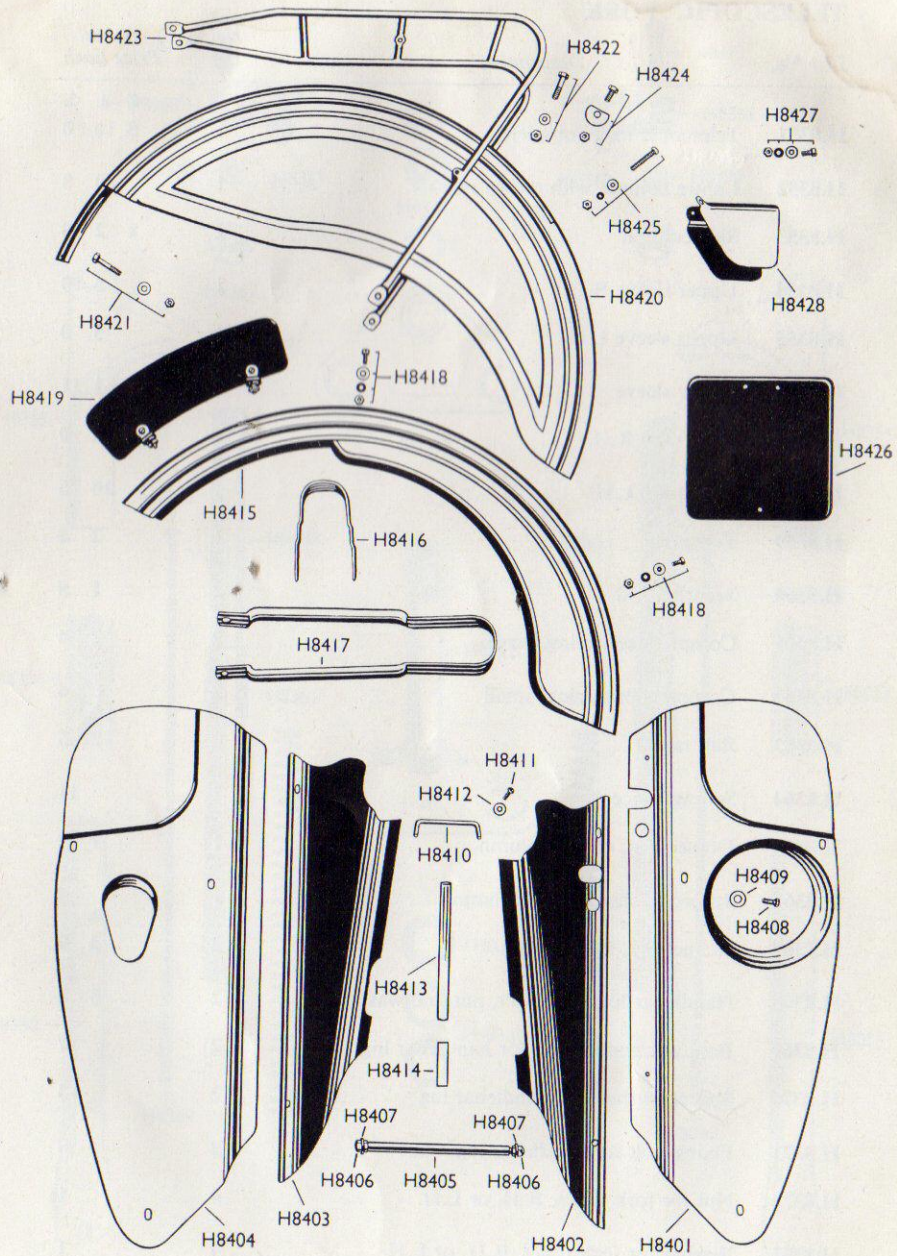

FAIRINGS and MUDGUARDS

List No.	Description	No. Off	Retail Price Each		
			£	s.	d.
H.8401	Fairing, R.H. lower	1	18	0	0
H.8402	Fairing, R.H. upper	1	6	0	0
H.8403	Fairing, L.H. upper	1	6	0	0
H.8404	Fairing, L.H. lower	1	18	0	0
H.8405	Tie rod assembly, lower fairing	1	2	6	0
H.8406	Dome nut for H.8405	2	4	0	0
H.8407	Washer for H.8405	2	1	0	0
H.8408	Pin, for lower fairing fixing	2	3	0	0
H.8409	Washer for H.8408	1	1	0	0
H.8410	Bracket, upper fairings	1	6	0	0
H.8411	Pin for H.8410 and upper fairings	2	1	0	0
H.8412	Washer for H.8410	2	1	0	0
H.8413	Plastic beading, long	1	4	0	0
H.8414	Plastic beading, short	1	2	0	0
H.8415	Mudguard only, front	1	1	1	6
H.8416	Upper stay, front mudguard	1	2	0	0
H.8417	Lower stay, front mudguard	1	3	10	0
H.8418	Pin, nut and washer, front mudguard stay fixing	2	3	0	0
H.8419	Number plate, front (complete)	1	2	8	0
H.8420	Mudguard only, rear	1	1	12	0
H.8421	Bolt, nut and washer, rear mudguard fixing, chain stay bridge	1	7	0	0
H.8422	Bolt, nut and washers, rear mudguard fixing, seat stay bridge	1	8	0	0
H.8423	Rear carrier	1	17	0	0
H.8424	Pin, nut and washer, carrier fixing, top...	1	6	0	0
H.8425	Pin, nut and washer, carrier fixing, mudguard valance	1	3	0	0
H.8426	Rear number plate	1	1	6	0
H.8427	Pin, nut and washers, number plate and tail cover light fixing	5	3	0	0
H.8428	Tail light cover	1	2	8	0

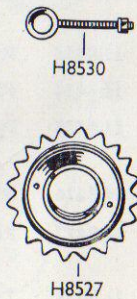
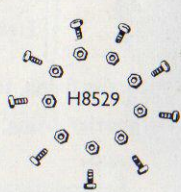
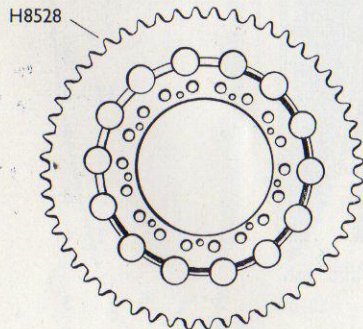
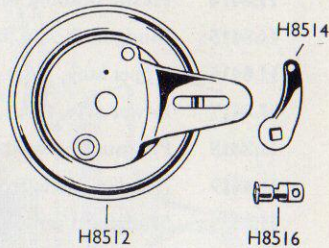
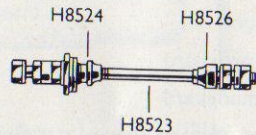
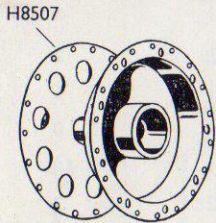
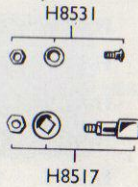
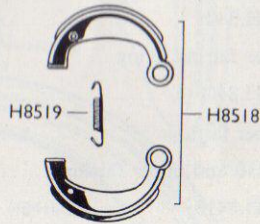
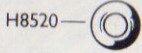
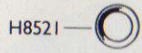
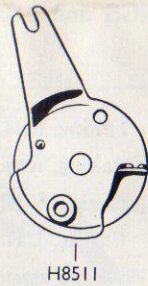
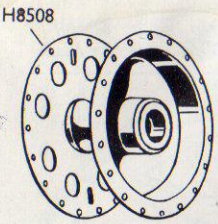

WHEELS

List No.	Description	No. Off	Retail Price Each
H.8501	Wheel complete, front, less tyre and tube	1	£ s. d. 3-10-5 3-15-0
H.8502	Wheel complete, rear (incl. sprocket) less tyre and tube	1	4 13 9
H.8503	Rim, 36H	2	13 2
H.8504	Spokes, with nipples and washers (36 per set)	2 sets	(1 set) 4 10
H.8505	Hub complete, front	1	1-11-11 1-19-3
H.8506	Hub complete, rear	1	2-4-3 2-7-11
H.8507	Hub shell, front	1	16-0 1-0-6
H.8508	Hub shell, rear	1	19-0 1-3-0
H.8509	Anchor plate, front, complete with shoes, linings, anchor and cam arm units	1	15-0 1-6-6
H.8510	Anchor plate, rear, complete with shoes, linings, anchor and cam arm units	1	15-0 1-6-6
H.8511	Anchor plate only, front	1	6-0 4-9
H.8512	Anchor plate only, rear	1	6-0 4-9
H.8513	Cam arm, front	1	5 8 ^d
H.8514	Cam arm, rear	1	6 7 ^d
H.8515	Shoe anchor bolt and nut, front	1	8
H.8516	Shoe anchor bolt and cable adjuster lug, rear	1	1 0
H.8517	Cam pin assembly, front or rear	2	1-6 1-9 PR
H.8518	Shoes and linings, with spring, front or rear	2 (set)	10-0 15/- PR
H.8519	Spring for H.8518, front or rear	2	4 5 ^d
H.8520	Bearing cup, front or rear	4	4 3 ^d
H.8521	Closure washer, front or rear, 3/4" hole	2	3
H.8521A	Closure washer, front or rear, 11/16" hole	2	2
H.8522	Spindle assembly, front	1	4-0 4-9
H.8523	Spindle assembly, rear	1	4-0 4-9
H.8524	Cone, drum side, front or rear	2	9
H.8525	Cone, adjusting, front	1	4 1-3
H.8526	Cone, fixed, rear	1	4 1-3
H.8527	Freewheel, 20T	1	7 6
H.8528	Sprocket, 52T	1	10 9
H.8529	Bolt and nut, sprocket fixing	9	5
H.8530	Chain adjuster, with nut and washer	2 (pr.)	8

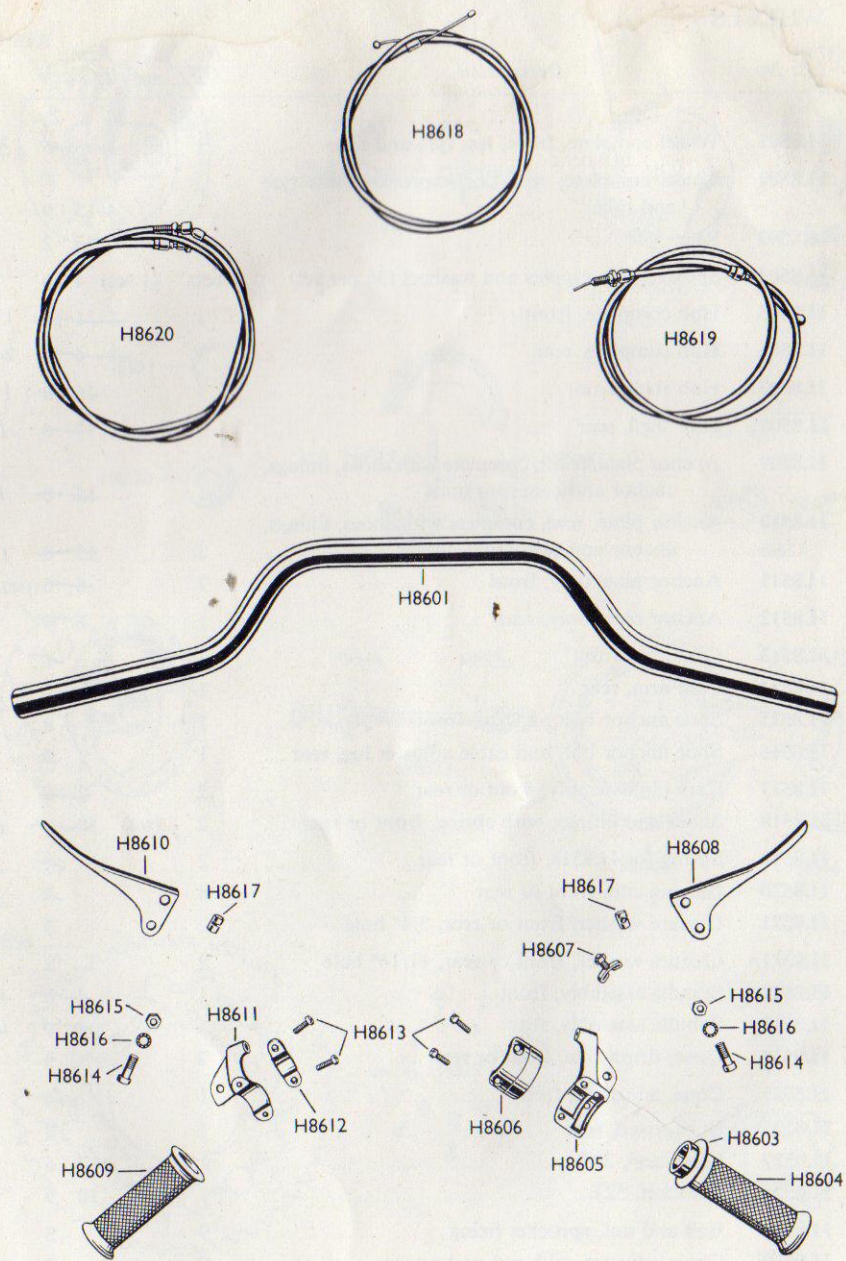

HANDLEBAR and CONTROLS

List No.	Description	No. Off	Retail Price Each		
			£	s.	d.
H.8601	Handlebar bend	1	9	5	
H.8602	Throttle twist grip, with front brake lever complete	1	14	0	
H.8603	Tubular handle with rubber grip	1	3	9	
H.8604	Throttle rubber grip only	1	1	3	
H.8605	Body, lower half	1	5	6	
H.8606	Body, upper half	1	3	0	
H.8607	Adjuster unit	1	1	6	
H.8608	Front brake lever only	1	4	6	
H.8609	Left hand rubber grip only	1	1	6	
H.8610	Rear brake lever only	1	4	6	
H.8611	Bracket for rear brake lever	1	5	0	
H.8612	Half clip for bracket H.8611	1	11		
H.8613	Clamping bolt	4	2		
H.8614	Fulcrum bolt for H.8608 or H.8610	2	3		
H.8615	Fulcrum bolt for H.8608 or H.8610	2	3		
H.8616	Fulcrum washer for H.8608 or H.8610	2	1		
H.8617	Roller for H.8608 or H.8610	2	3		
H.8618	Throttle cable	1	2	8	
H.8619	Front brake cable	1	2	2	
H.8620	Rear brake cable	1	3	0	
H.8621	Throttle Cable Stop	1	8		

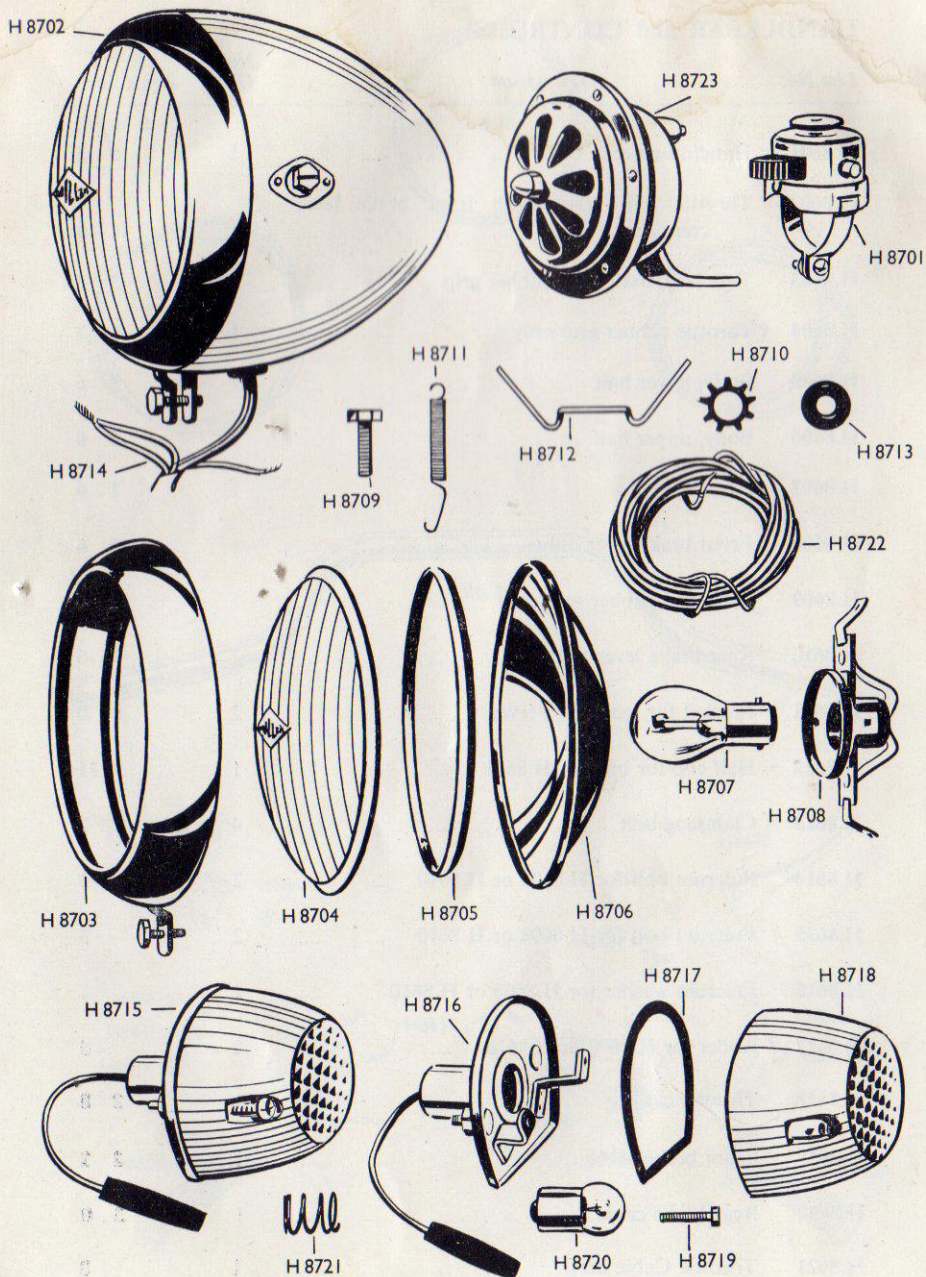

LAMPS and HORNS

List No.	Description	No. Off	Retail Price Each	
			£	s. d.
H.8701	Switch, lighting, horn and cut-out	1	6	0
H.8702	Headlamp complete, with bulb and harness	1	2	8 6
H.8703	Headlamp rim	1	5	6
H.8704	Headlamp glass	1	3	4
H.8705	Headlamp washer	1		7
H.8706	Headlamp reflector	1	8	3
H.8707	Headlamp bulb, 6v 15/15w	1	6	3*
H.8708	Headlamp bulb holder	1	3	4
H.8709	Headlamp securing screw	2		3
H.8710	Headlamp washer for securing screw	2		1
H.8711	Spring for headlamp bulb holder	1		6
H.8712	Wire, lense fixing	1		7
H.8713	Rubber grommet	1		4
H.8714	Headlamp wire harness only	1	8	6
H.8715	Tail lamp complete	1	8	6
H.8716	Tail lamp back plate complete, less bulb	1	3	7
H.8717	Tail lamp gasket	1	1	2
H.8718	Tail lamp moulding	1	3	10
H.8719	Screw for moulding	2		4
H.8720	Tail lamp bulb, 6v 3w	1	1	4*
H.8721	Spring for tail lamp bulb...	1		4
H.8722	Lighting flex (tail to head)	1		6
H.8723	Horn	1	12	6

* Plus Purchase Tax

EQUIPMENT AND ACCESSORIES

List No.	Description	Retail Price Each		
		£	s.	d.
H.8800	Legshields	3	5	0
H.8801	Windscreen	2	9	9
H.8802	Pannier Bags (pair)	2	2	9 2.12.0
		Purchase Tax	7	7.10
H.8803	Speedometer (handlebar fitting)	1	16	0
H.8804	Speedometer (headlamp fitting)	1	16	0
H.8805	Transmission cable for Speedometer 28 $\frac{1}{2}$	7	6	
H.8806	Speedometer drive 23" D.	12	6	
H.8807	Foot Pump	8	2	
H.8808	Parking Light	15	0	
H.8809	Mirror	2	6	
H.8810	Rider's tool kit (comprising: M702 spanner, M.714 spanner, large box spanner, small box spanner, toolroll, and screwdriver)	6	10	
H.8811	Licence holder	2	0	
H.8812	Saddle	1	5	0
H.8813	Saddle bag	7	4	

WORKSHOP TOOLS

List No.	Description	Retail Price Each		
		£	s.	d.
H.8851	Gudgeon pin guide	2	0	
H.8852	Flywheel extractor	11	8	
H.8853	Oil seal insertion tool	1	0	9
H.8854	Timing tool	19	5	
H.8855	Piston ring clamp	2	0	
H.8856	Gudgeon pin extractor	9	6	
H.8857	Main bearing puller	2	10	0
H.8858	Flywheel wrench	7	11	
H.8859	Bearing extractor (clutch and pulley)	7	6	