

# IceniCAM Information Service

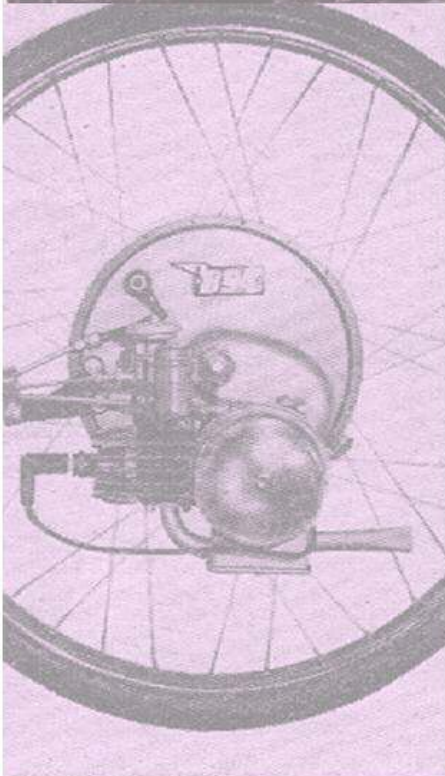

Section 1 (a)

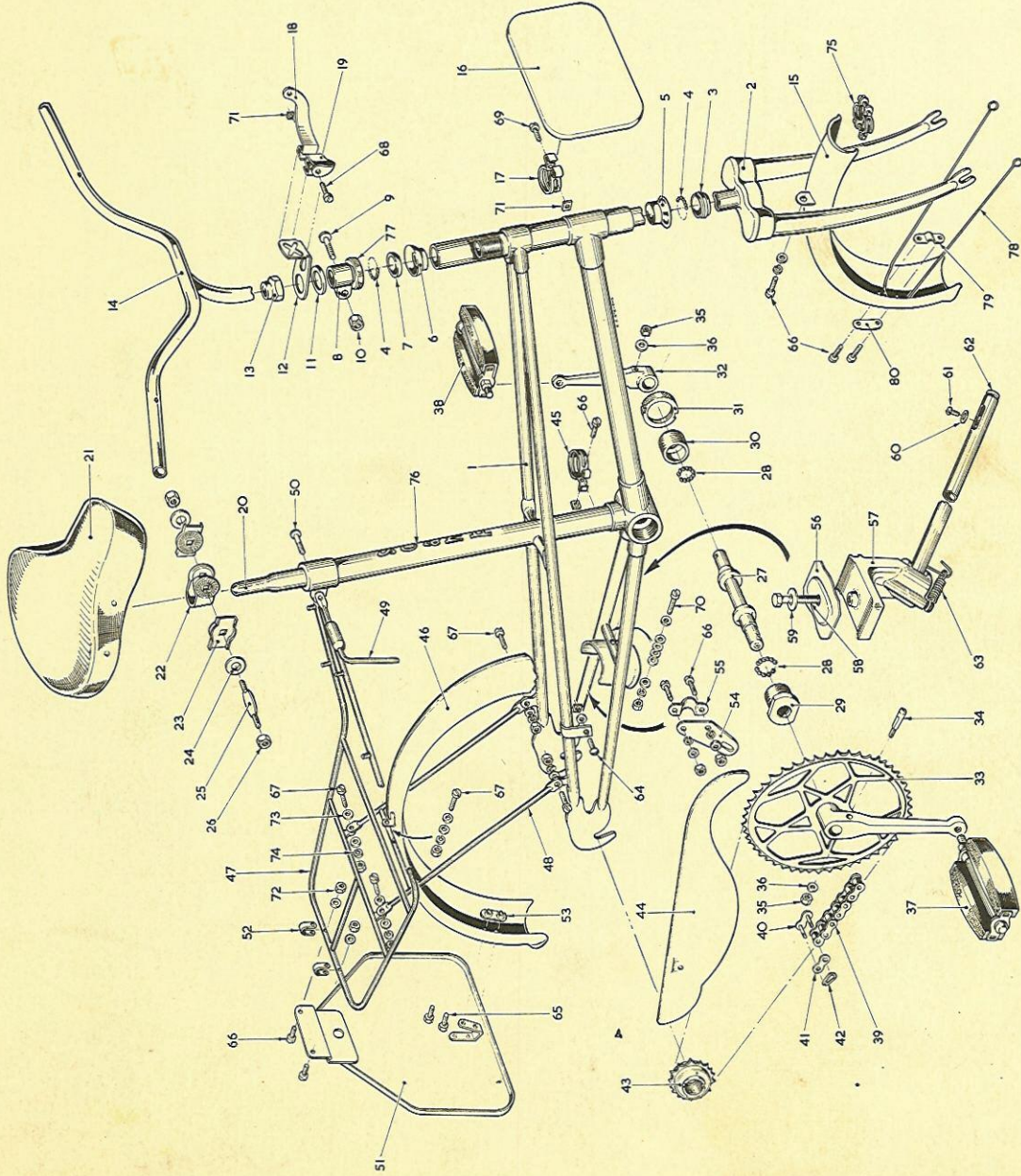

2/3/68

Bicycle Parts

CLARK SCAMP MOPED

2/3/68

Item	Cat.No.	Title	No. Off	Remarks
37	B 4365	Pedal R.H.	1 pr	Separate Pedals not available. Pairs only supplied. Correct length of 96 links but without connecting spring link.
38		Pedal L.H.		
39	B 4367	Chain	1	
40	B 4514	Spring Link	1	
41				
42				
43	B 4523	Free Wheel	1	
44	B 4594	Chainguard	1	
45	B 4595	Chainguard Clip	1	
46	B 4589	Rear Mudguard	1	
47	B 4598	Carrier Frame	1	
48	B 4665	Carrier Stay	1	
49	B 4599	Saddle Clamp Lever	1	
50	B 4603	Bolt	1	
51	4494	Rear Number Plate	1	
52	B 4516	Rear Number Plate Clip	2	
53	4495	Rear Mudguard Backing Plate	1	
54	4580	Engine Fixing Plate	1	
55	4579	Engine Fixing Strap	1	
56	B 4666	Clamp Plate	1	
57	B 4667	Body / Leg Assembly	1	
58	B 4668	Bolt	1	
59	B 984	Washer	1	
60	B 4669	Shakeproof Washer	1	
61	B 4670	Screw	1	
62	B 4671	Adjuster Pad	1	
63	B 4676	Spring	1	
64	B 1509	Screw	1	
65	B 4527	Screw	2	
66	B 1279	Screw	8	
67	B 293	Screw	4	
68	B 987	Screw	1	
69	B 219	Screw	2	

2/3/68

Item	Cat. No.	Title	No. Off	Remarks
1	B 4586	Frame	1	
2	B 4657	Front Fork	1	
3	B 4658	Crown Race	1	
4	B 4207	Steel Balls	2 sets	30 balls per set
5	B 4659	Lower Frame Bearing Race	1	
6	B 4660	Upper Frame Bearing Cup	1	
7	B 4661	Upper Bearing Race	1	
8	B 4662	Handlebar Clamp	1	
9	B 4602	Clamp Bolt	1	
10	B 4604	Domed Nut	1	
11	B 4663	Head Distance Piece	1	
12	B 4600	Headlamp Bracket	1	
13	B 4664	Steering Locknut	1	
14	4159	Handlebars	1	
15	B 4588	Front Mudguard	1	
16	4398	Front Number Plate	1	
17	B 4515	Front Number Plate Clip	1	
18	4402	Headlamp Bracket L.H.	1	
19	4403	Headlamp Bracket R.H.	1	
20	B 4596	Saddle Pillar	1	
21		Saddle	1	
22		Saddle Clamp	1	
23	B 4366	Locking Plate	2	Complete Saddle Assembly
24		Washer	2	
25		Saddle Bracket Bolt	1	
26		Nut	2	
27	B 4593	Bottom Bracket Axle	1	
28	B 4285	Steel Balls	2 sets	11 balls per set
29	B 4590	Left Hand Thread Cup	1	
30	B 4591	Right Hand Thread Cup	1	
31	B 4592	Locking Ring	1	
32	B 4364	L. H. Pedal Crank	1	
33	B 4363	Chain Wheel and Crank	1	
34		Cotter Pin		Separate components not available. Complete cotter pin assembly only.
35	B 4369	Nut	2	
36		Washer		

Bicycle Parts

CLARK SCAMP MOPED

Item	Cat.No.	Title	No. Off	Remarks
70	B 390	Screw	1	Washers (B 43) shown are fitted as packing washers.
71	B 4524	Square Nut	4	
72	B 38	Nut	10	
73	B 43	Plain Washer	20	Standard washer used where shown.
74	B 635	Spring Washer	9	Standard spring washer used where shown.
75	B 4601	Brake Arm Clip Complete	1	
76	4521	Seat Tube Transfer	1	
77	B 4672	Steering Adjusting Race	1	
78	B 4673	Front Mudguard Stay	1	
79	B 4674	Nut Plate	1	
80	B 4675	Stiffening Plate	1	
		The following are also available as complete assemblies:		
	B 4582	Prop Stand complete.		

2/3/68

Bicycle Parts

CLARK SCAMP MOPED

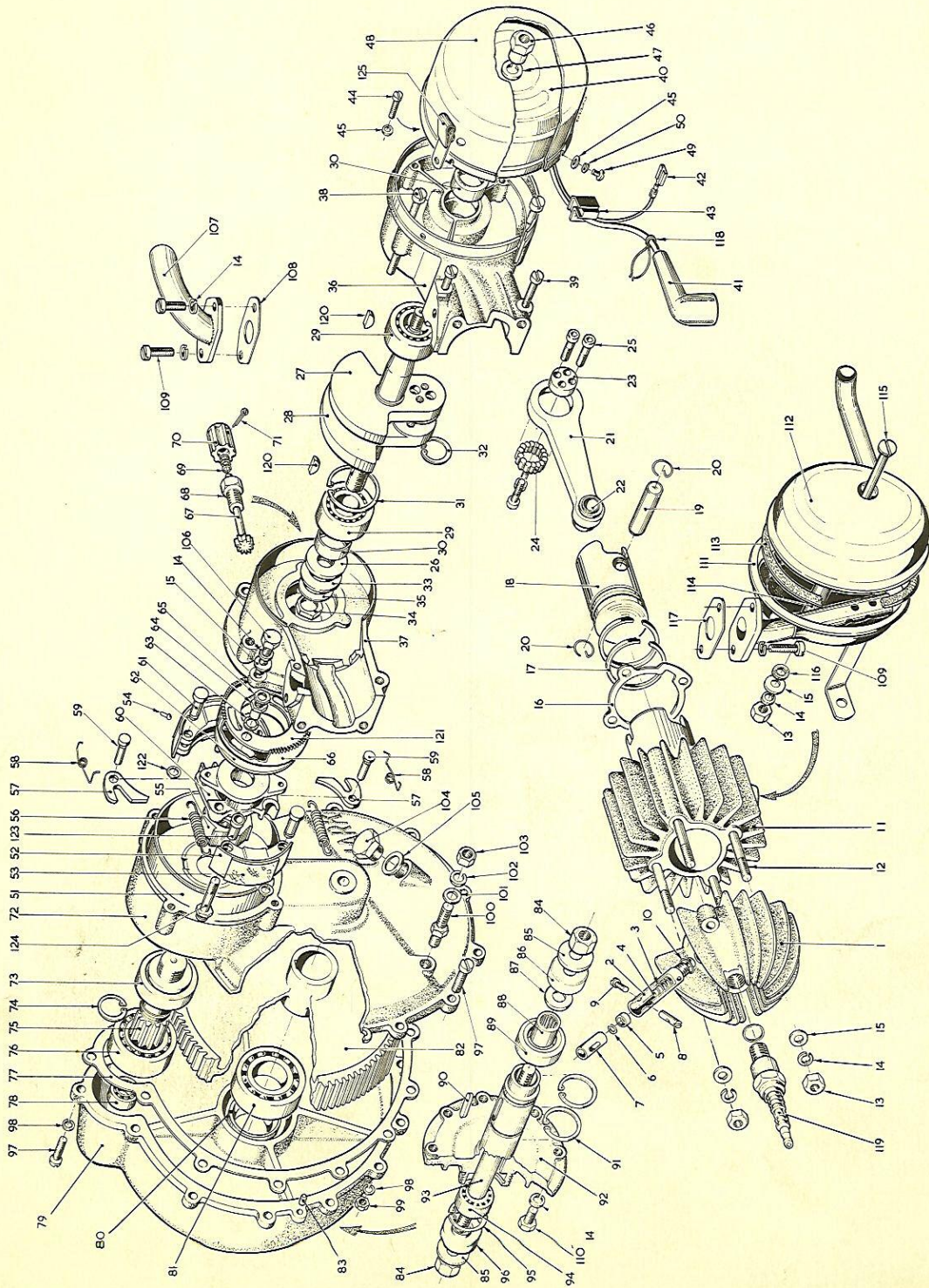

Item	Cat. No.	Title	No. Off	Remarks
1	4424	Cylinder Head	1	
2	4437	Valve Body	1	
3	B 4461	Spring	1	
4	4438	Valve	1	
5	4435	Recessed Washer	1	
6	B 4499	Circlip	1	
7	4439	Plunger	1	
8	4462	Cable Barrel	1	
9	B 718	Screw	1	
10	B 4463	Copper Seal Washer	1	
11	4428	Cylinder	1	
12	4456	Cylinder Stud	4	
13	B 35	Nut	5	
14	B 1418	Spring Washer	21	
15	B 40	Washer	9	
16	4451	Cylinder/Crankcase Gasket	1	
17	B 4449	Piston Ring	2	
18	B 4446	Piston	1	
19	B 4447	Gudgeon Pin	1	
20	B 4448	Circlip	2	
21	4407	Connecting Rod	1	
22	B 4445	Little End Bush	1	
23	4888	Crank Journal	1	
24	B 4444	Bearing Roller	15	
25	B 4897	Socket Screw	4	
26	4891	Drive Collar	1	
27	4427	Crankshaft - Magneto Half	1	
28	4426	Crankshaft - Drive Half	1	
29	B 3418	Ball Bearing	2	
30	B 150	Seal	2	
31	B 4453	Circlip	1	
32	B 228	Circlip	1	
33	4890	Clamp Washer	1	
34	4889	Nut	1	
35	4895	Tab Washer	1	
36	4430	Crankcase - Magneto Half	1	Items 36 & 37 are available as matched pairs only.
37	4429	Crankcase - Clutch Half	1	
38	4455	Crankcase Screw	3	

Item	Cat. No.	Title	No. Off	Remarks
39	4420	Small Crankcase Screw	2	
40	B 4284	Flywheel Magneto	1	
41	B 4292	Suppressor Plug Cover	1	
42	B 4566	Female Terminal	1	
43	4489	H. T. Lead Grommet	1	
44	B 522	Screw	3	
45	B 1354	Washer	5	
46	4532	Crankshaft Nut	1	
47	B 1725	Spring Washer	1	
48	4404	Magneto Cover	1	
49	B 71	Screw	3	
50	B 3113	Spring Washer	3	
51	4414	Clutch Drum	1	
52	4413	Clutch Shoe	2	
53	4465	Clutch Lining	2	
54	B 4466	Rivets	4	
55	4553	Ratchet Nut	1	
56	4457	Clutch Spring	2	
57	4547	Pawl	2	
58	4549	Pawl Spring	2	
59	4548	Pawl Pivot Pin	2	
60	4557	Clutch Body	1	
61	4417	Shouldered Pin	2	
62	4903	Clamp Plate	1	
63	B 4896	Wavey Washer	2	
64	4901	Threaded Bush	2	
65	B 220	Nut	2	
66	4550	Release Gear	1	
67	4554	Disconnect Pinion	1	
68	4555	Disconnect Pinion Bush	1	
69	B 4560	Spring	1	
70	4556	Disconnect Knob	1	
71	B 4836	Split Pin	1	
72	4431	Gearwheel Case - Engine Half	1	- with item 79 available as a matched pair only.
73	B 4470	Seal	1	
74	B 4472	Circlip	1	
75	4422	Drive Pinion	1	
76	B 4471	Ball Bearing	1	

2/3/68

Engine / Transmission Unit

CLARK SCAMP MOPED



Item	Cat. No.	Title	No. Off	Remarks
77	4480	Gearwheel Case Gasket	1	
78	B 1325	Ball Bearing	1	
79	4432	Gearwheel Case - Wheel Half	1	- with item 72 available as matched pair only.
80	B 4474	Seal	1	
81	B 4473	Ball Bearing	1	
82	4408	Main Gearwheel	1	
83	4481	Dowel Pin	2	
84	B 4484	Nut	2	
85	4874	Washer	2	
86	4558	Nearside Spacer	1	
87	B 4479	Washer	1	- This washer is between the shoulder on the rear wheel spindle & the <u>inside</u> face of the gearwheel case.
88	B 4476	Needle Bearing	1	
89	B 3312	Seal	1	
90	4440	Main Drive Key	1	
91	B 4478	Circlip	2	
92	4425	Quill Shaft	1	
93	4423	Rear Wheel Spindle	1	
94	B 4475	Ball Bearing	1	
95	B 4477	Circlip	1	
96	4419	Spacer	1	- This spacer should be assembled with the small dia. shoulder towards the ball race.
97	B 293	Screw	13	
98	B 635	Spring Washer	13	
99	B 38	Nut	10	
100	4569	Engine Fixing Stud	1	
101	B 981	Washer	1	
102	B 1723	Spring Washer	1	
103	B 980	Nut	1	
104	4441	Filler Plug	1	
105	B 1964	Selon Washer	1	
106	B 45	Screw	4	

2/3/68

Engine / Transmission Unit

CLARK SCAMP MOPED

Item	Cat.No.	Title	No. Off	Remarks
107	4458	Induction Pipe	1	
108	4459	Induction Gasket	1	
109	B 4460	Screw	4	
110	B 4526	Screw	8	
111	4617	Silencer Shell - Engine Side	1	
112	4618	Silencer Shell - Tailpipe Side	1	
113	4573	Silencer Gasket	1	
114	4574	Spacer	1	
115	B 4575	Screw	1	
116	B 4572	Fibre Washer	1	
117	4483	Exhaust Gasket	1	
118	4609	H. T. Lead Clip	1	
119	B 4291	Spark Plug	1	
120	B 4498	Woodruff Key	2	
121	4902	Clamp Plate	1	
122	4904	Washer	2	
123	4900	Shouldered Bearing	2	
124	4899	Hinge Pin	2	
125	4910	Friction Tab	1	
<p>In addition to the individual components, the following sub-assemblies or kits of parts are available.</p>				
4502		Decompressor Valve Assy.		Consists of items 2, 3, 4, 5, 6.
4450		Piston Assy.		Consists of items 17, 18, 19, 20.
KP 4653		Con Rod / Big End Overhaul Kit		Consists of items 21, 22, 23, 24, 25.
KP 4654		Clutch Shoe Replacement Kit		Consists of a pair of shoes item 52, with linings, 53 fitted.
KP 4655		Gasket Set		Complete set of gaskets and sealing washers including those for silencer.
4482		Silencer		Does not include attachment screws, 109 or gasket, 113.
<p>For details of Carburettor see Section 4, for breakdown of Flywheel Magneto see Section 3.</p>				

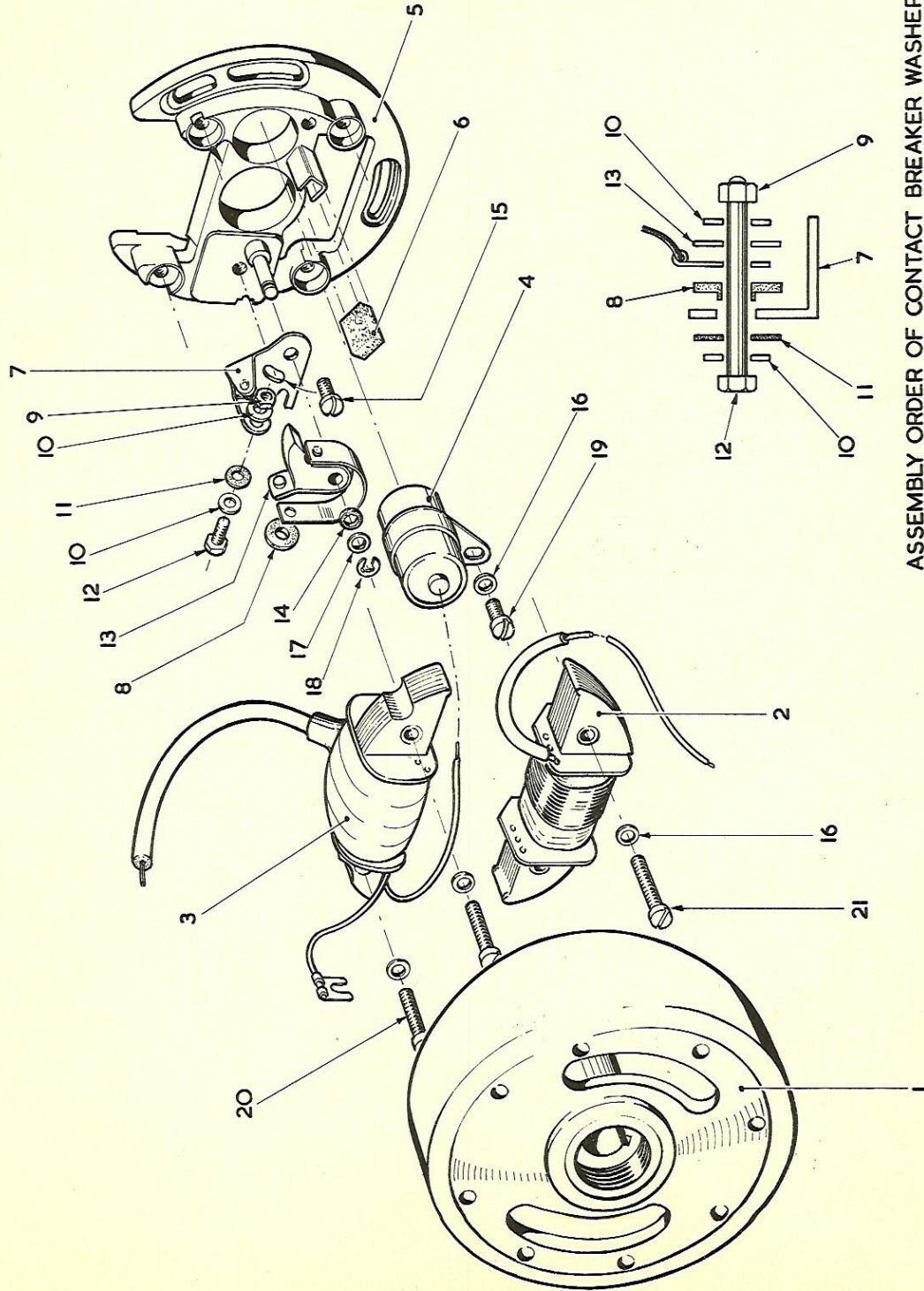

ASSEMBLY ORDER OF CONTACT BREAKER WASHERS

Item	Cat. No.	Title	No. Off	Remarks
1	B 4730	Flywheel	1	
2	B 4731	Lighting Coil	1	
3	B 4732	H. T. Coil	1	
4	B 4733	Condenser	1	
5	B 4734	Stator Plate	1	
6	B 4735	Felt Wiper	1	
7	B 4736	Fixed Contact Plate	1	] Supplied only as Complete Assembly. -See Contact Breaker Set Below.
8	B 4744	Shouldered Insulating Washer	1	
9	B 4738	Thin Nut	1	
10	B 4739	Brass Washer	2	
11	B 4741	Fibre Washer	1	
12	B 4742	Hex. Head Screw	1	
13	B 4743	Contact Breaker Arm	1	
14	B 4745	Fibre Washer	1	
15	B 4737	Securing Screw	1	
16	B 4740	Locking Washer	5	
17	B 4746	Thin Washer	1	
18	B 4747	Circlip	1	
19	B 4748	Screw	1	
20	B 4749	Screw	2	
21	B 4750	Screw	2	
		In addition to the individual components, the following complete assemblies are available.		
	B 4284	Flywheel Magneto - Complete		All above parts.
	B 4752	Contact Breaker Set		Consists of items 7-13 above.

2/3/68

Type DANSI

Flywheel Magneto

CLARK SCAMP MOPED

WATCH IT  
AMAL  
NOW  
FITTED

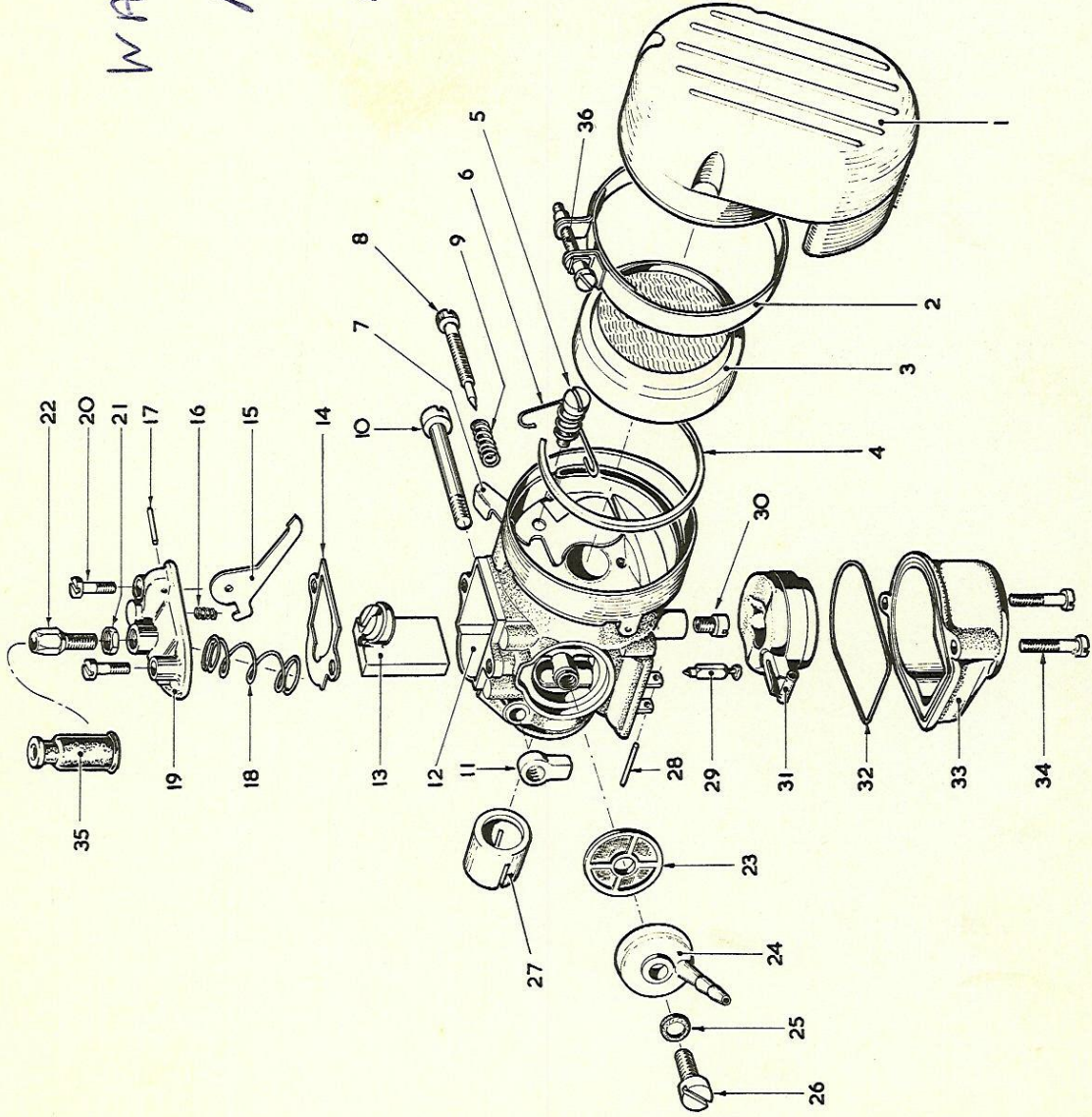

Item	Cat.No.	Title	No. Off	Remarks
1	B 4678	Silencer Cover	1	
2	B 4679	Cover Clip	1	See also item 36
3	B 4680	Air Filter	1	
4	B 4681	Seating Ring	1	
5	B 4682	Shouldered screw	1	
6	B 4683	Spring	1	
7	B 4684	Automatic Choke Lever	1	
8	B 4685	Regulator Screw	1	
9	B 4686	Regulator Spring	1	
10	B 4687	Clamping Screw	1	
11	B 4688	Clamp Nut	1	
12	B 4689	Carburettor Body	1	Not available as spare part.
13	B 4690	Throttle slide	1	
14	B 4691	Gasket	1	
15	B 4692	Choke Release Lever	1	
16	B 4693	" " " spring	1	
17	B 4694	" " " pin	1	
18	B 4695	Throttle Spring	1	
19	B 4696	Throttle Cover	1	
20	B 4697	Fixing Screws	2	
21	B 4698	Locknut	1	
22	B 4699	Throttle Cable Adjuster	1	
23	B 4700	Fuel Filter	1	
24	B 4701	Fuel Connector Cap	1	
25	B 4702	Fibre Washer	1	
26	B 4703	Screw	1	
27	B 4704	Reducing Bush	1	
28	B 4705	Float Hinge Pin	1	
29	B 4706	Float needle	1	
30	B 4707	Jet	1	
31	B 4708	Float	1	
32	B 4709	Sealing Ring	1	
33	B 4710	Float Chamber	1	
34	B 4711	Ch. Hd. Screw	2	
35	B 4712	Rubber Cap	1	
36	B 4713	Screw	1	

2/3/68

Carburettor B 4299 (Dellorto)

CLARK SCAMP MOPED

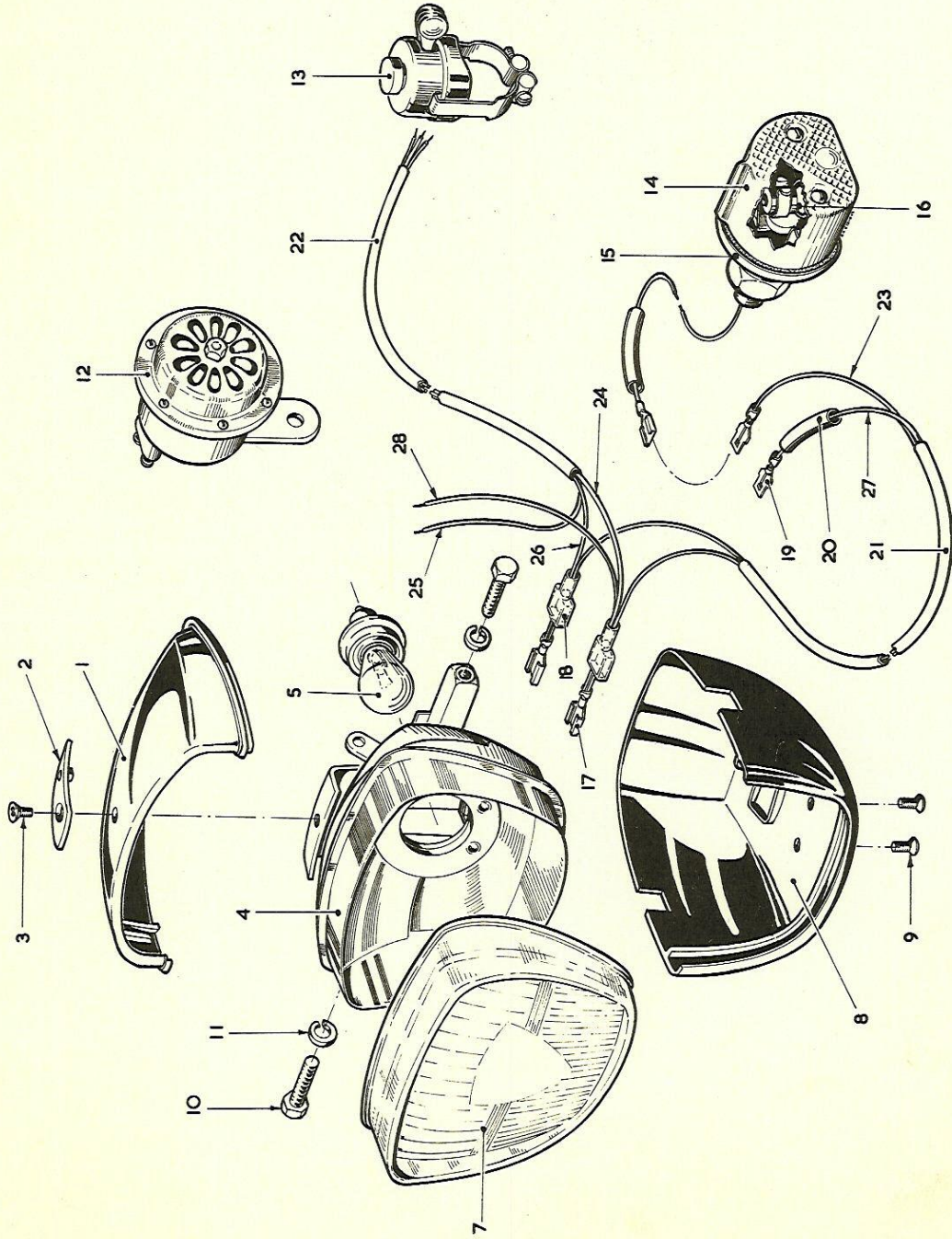

Item	Cat. No.	Title	No. Off	Remarks
1	B 4719	Headlamp Casing (top half)	1	
2	B 4720	Cap	1	
3	B 4721	Screw	1	
4	B 4722	Reflector Body	1	
5	B 4624	6 v. 15 w. Bulb	1	
6	-	-	-	
7	B 4723	Glass Front	1	
8	B 4724	Headlamp Casing (lower half)	1	
9	B 4725	Domed Screw	2	
10	B 4726	Hex. Screw	2	
11	B 4727	Spring Washer	2	
12	B 4359	Horn	1	
13	B 4360	Horn Button and Light switch	1	
14	B 4728	Rear Lamp Lens	1	Complete with 2 screws
15	B 4729	Rear Lamp Body	1	Complete with nut
16	B 4625	Bulb 6 v. 3 w.	1	
17	B 4566	Female Terminal	2	] Not available as separate items. See Electrical Harness Assembly.
18	B 4565	Insulator	2	
19	B 4534	Male Terminal	1	
20	B 4567	Sleeving	1	
21	B 4539	Sleeving	1	
22	B 4538	Sleeving	1	
23	4518/1	Rear Lamp Lead	1	
24	4518/2	Front Lamp Lead	1	
25	4518/3	Horn Lead	1	
26	4518/4	Front Lamp Lead	1	
27	4518/5	Generator Lead	1	
28	4518/6	Horn Lead	1	
		In addition to the individual components, the following Complete Assemblies are available.		
	B 4351	Headlamp		Complete including bulb
	B 4352	Rear Lamp		Complete including bulb
	4518	Electrical Harness		Complete Electrical wiring sleeving with attached terminals



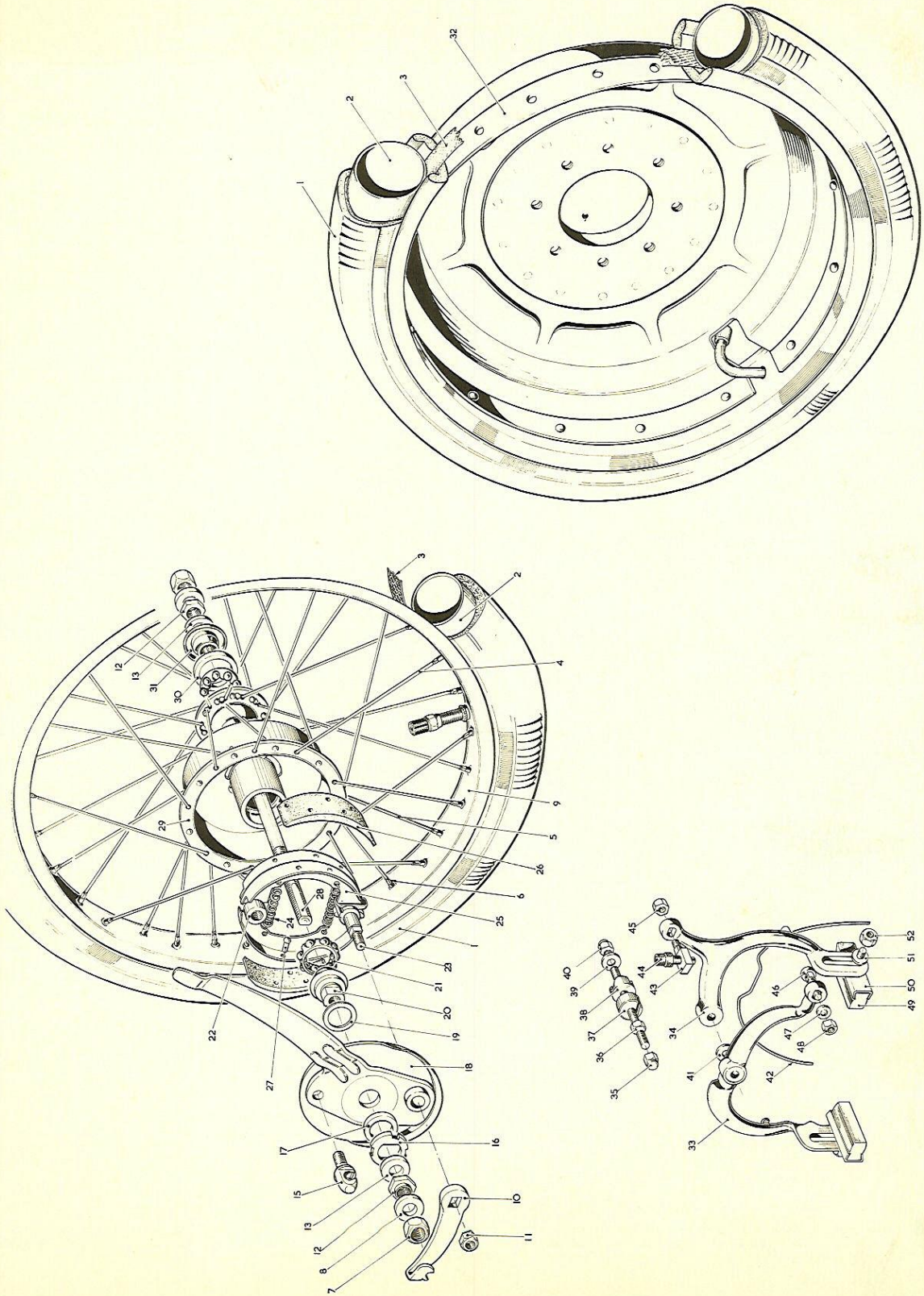

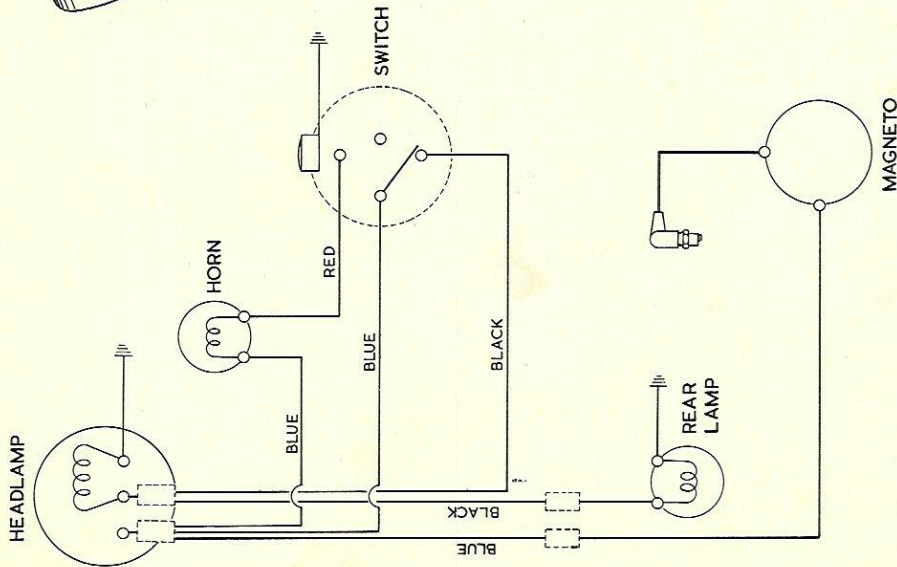
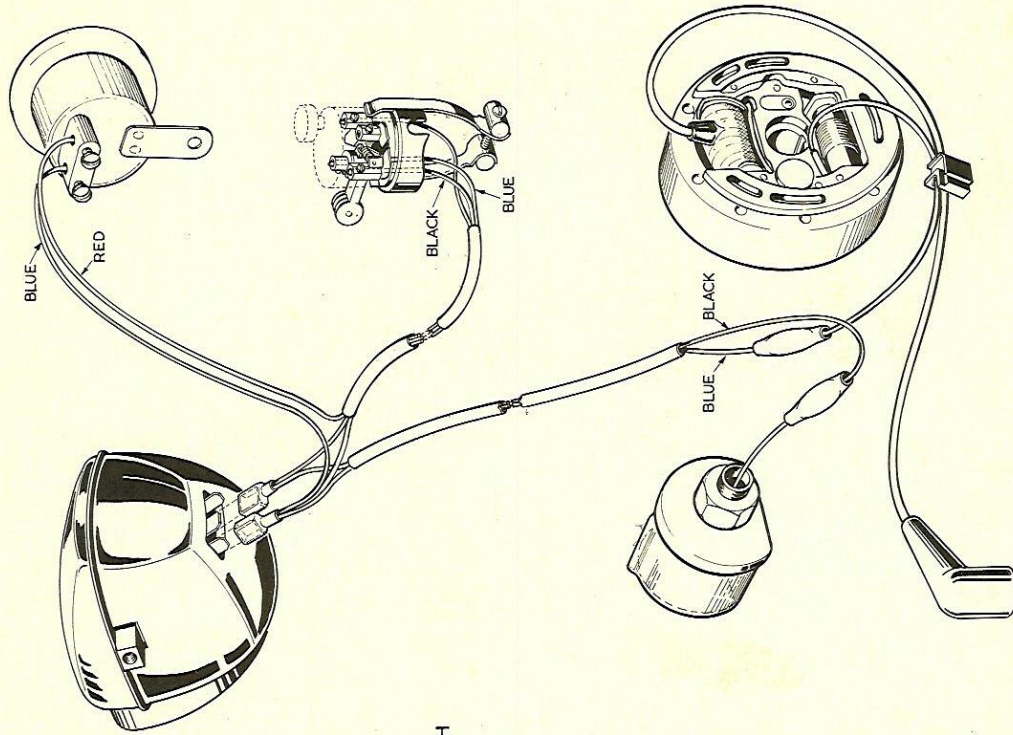

Electrical Circuit Diagram

Item	Cat.No.	Title	No. Off	Remarks
1	B 4511	Tyres	2	Avon can supply direct
2	B 4512	Tube	2	
3	B 4513	Rim Tape	2	
4	B 4607	Spoke 14g x 4 $\frac{7}{8}$ "	14	
5	B 4762	Spoke 14g x $5\frac{1}{2}$ "	14	
6	B 4763	Spoke Nipple 14g	28	
7	B 4484	$\frac{3}{8}$ " B.S.C.Hex.nuts	2	
8	B 984	$\frac{3}{8}$ " Washer	2	
9	4486	Wheel Rim	1	
10	B 4764	Cam Lever	1	
11	B 35	Nut	1	
12	B 4765	Adjusting Nut	2	
13	B 4766	Thick Washer	2	
14	-	-	-	
15	B 4767	Cable Guide	1	
16	B 4768	Notched Washer	1	
17	B 4769	Distance Washer	1	
18	B 4770	Cover Plate	1	
19	B 4771	Thin Washer	1	
20	B 4772	Cone Nut L. H.	1	
21	B 4773	Ball Race	2	
22	B 4774	Fulcrum Sleeve	1	
23	B 4775	Camshaft	1	
24	B 4776	Spring	2	
25	B 4777	Brake Shoe	1 pr.	
26	B 4778	Brake Lining	2	
27	B 4779	Rivets	10	
28	B 4780	Spindle	1	
29	B 4781	Brake Drum	1	
30	B 4782	Retaining Ring	1	
31	B 4783	Cone Nut R. H.	1	
32	4510	Rear Wheel	1	
33	B 4784	Left Stirrup	1	
34	B 4785	Right Stirrup	1	
35	B 4786	Dome Nut	1	
36	B 4787	Locknut	1	
37	B 4788	Pivot Bolt	1	
38	B 4789	Profile Washer	1	
39	B 4790	Washer	1	

2/3/68

Wheels and Brakes

CLARK SCAMP MOPED

Item	Cat. No.	Title	No. Off	Remarks
40	B 4791	Nut	1	
41	B 4792	Distance Washer	1	
42	B 4793	Spring	1	
43	B 4794	T. Barrel	1	
44	B 4795	Adjuster	1	
45	B 4796	Nut	1	
46	B 4797	Cable Clamp Bolt	1	
47	B 4798	Washer	1	
48	B 4799	Nut	1	
49	B 4800	Brake Block	2	
50	B 4801	Brake Shoe	2	
51	B 4802	Washer	2	
52	B 4803	Nut	2	
		In addition to the individual components the following complete assemblies are available.		
	4585	Front Wheel Complete		Including Drum Brake Assembly
	B 4597	Rear Caliper Brake Assembly		
	K 4804	Replacement Shoe set for front brake		With linings fitted.

2/3/68

Wheels and Brakes

CLARK SCAMP MOPED

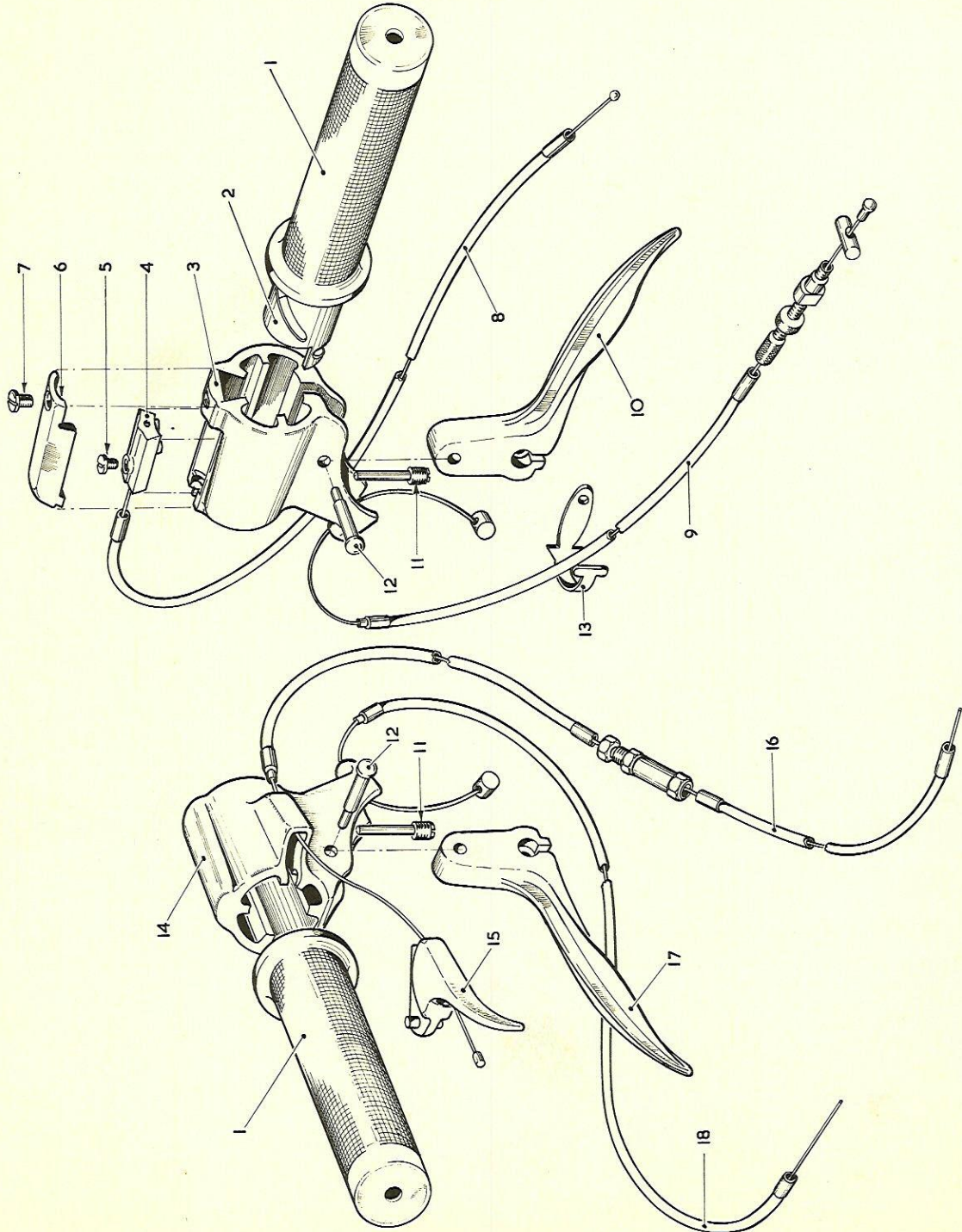

Item	Cat. No.	Title	No. Off	Remarks
1	B 4805	Rubber Grip	2	
2	B 4806	Twist Grip Tube	1	
3	B 4807	Twist Grip Body	1	
4	B 4808	Throttle Shuttle	1	
5	B 4809	Shuttle Screw	1	
6	B 4810	Hood	1	
7	B 4811	Hood Screw	1	
8	4508	Throttle Cable Complete	1	
9	4584	Front Brakes Cable Complete	1	
10	B 4812	Front Brake Lever	1	
11	B 4813	Body Fixing Screw	2	
12	B 4814	Lever Shouldered Rivet	2	
13	B 4381	Cable Clip	12	
14	B 4815	Brake/Decompression Lever Body	1	
15	B 4816	Decompressor Trigger	1	
16	4509	Decompressor Cable Complete	1	
17	B 4817	Rear Brake Lever	1	
18	4583 A	Rear Brake Cable Complete	1	
		In addition to the above components, the following assemblies are available:		
	B 4361	Twist Grip/Lever		
	B 4362	Grip Lever and Trigger Assembly		

2/3/68

Controls and Cables

CLARK SCAMP MOPED

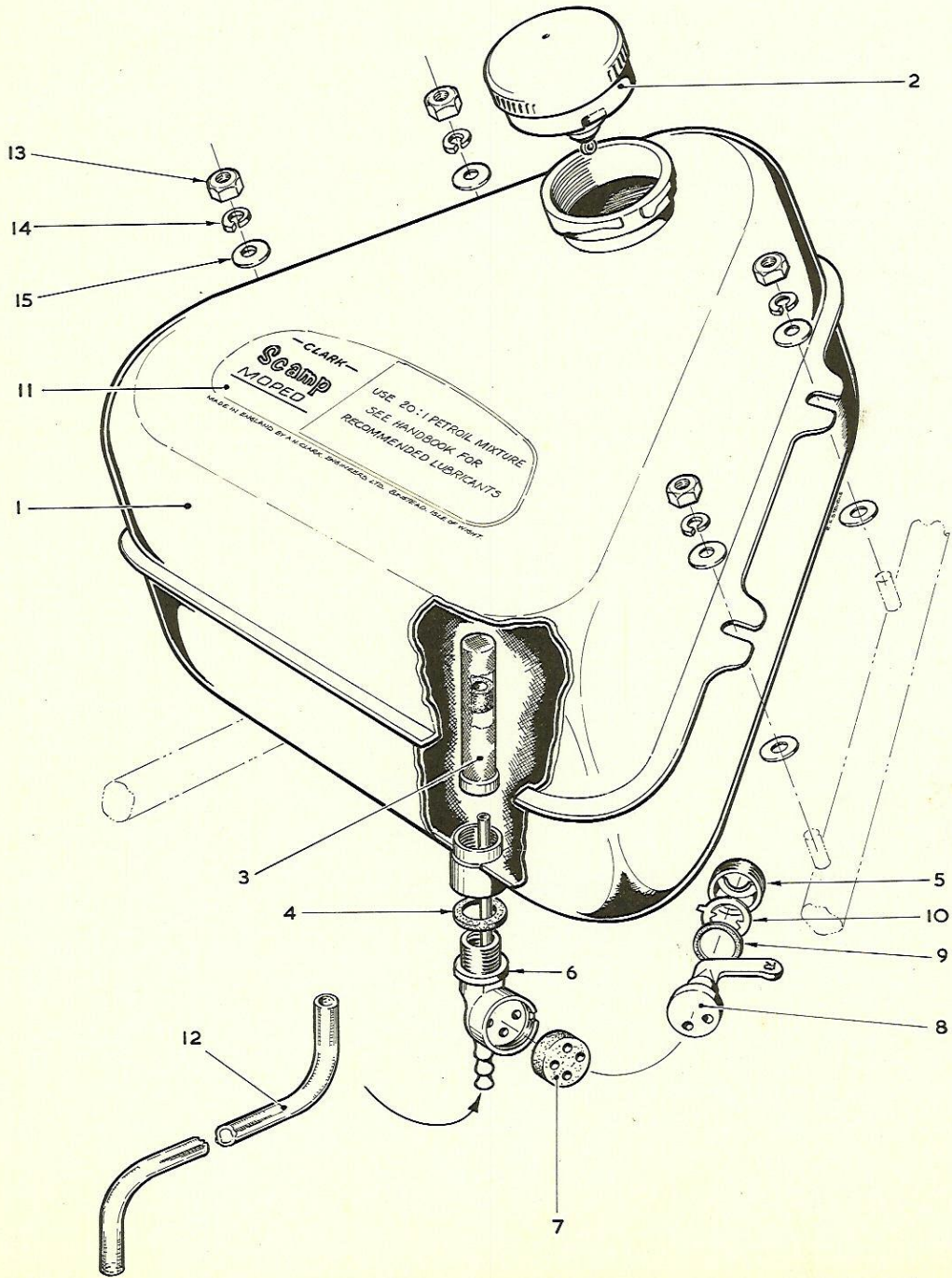

Item	Cat.No.	Title	No. Off	Remarks
1	4497	Fuel Tank	1	Has transfer (item 11) affixed.
2	B 4501	Filler Cap	1	
3	B 4755	Filter	1	
4	B 4517	Fibre Washer	1	Components of complete Fuel Tap B 4368
5	B 4756	Retaining Screw	1	
6	B 4757	Body	1	
7	B 4758	Cork Seating Washer	1	
8	B 4759	Tap	1	
9	B 4760	Fibre Washer	1	
10	B 4761	Seat Spring	1	
11	4522	Transfer	1	
12	4520	Fuel Pipe	1	
13	B 38	Nut	4	
14	B 635	Spring Washer	4	
15	B 43	Plain Washer	8	
		The following assemblies are also available.		
	B 4368	Fuel Tap complete		